

Evidence for the
Licensing Hearing for
The Minimarket
235-237 Lozells Road, Birmingham

RESTRICTED DOCUMENT



CONTENTS

Objection	Pg 3
Statement PCSO Capella	Pg 4
Photos	Pg 5-10
Licensing sub-com A decision notice	Pg 11-13
Gov website case law	Pg 14-17
Previous app (19/6/18 condensed)	Pg 18-29

Abdool Rohomon

From: bw licensing
Sent: 24 August 2018 13:39
To: 'Licensing@birmingham.gov.uk'
Subject: FW: New premises licence application for Minimarket 235-237 Lozells Road.
Attachments: Consent of DPS - The Minimarket, Lozells Road_Aug 2018.pdf; Plans - Lozells Road_August 2018.pdf; The Minmarket - Staff training, Operations Manual_August 2018_RVE.pdf; Passport PLH Lozells.docx; Signage - Please leave quietly.pdf; _Application -235 Lozells Rd_09. August 2018_LLL.pdf

Dear Licensing,

West Midlands police have reviewed the application for the above premises and wish to lodge an objection to the granting of this application on the prevention of crime & disorder and public nuisance licensing objectives.

The applicant and has very recently had a very similar application heard in front of the licensing committee which was refused, an extract from their decision is detailed below.

The Sub-Committee gave consideration to whether any measures could be taken to ensure that the licensing objectives were adequately promoted and that therefore the licence might be granted; however Members considered that neither modifying the conditions of the licence nor excluding any of the licensable activities from the scope of the licence would mitigate the concerns raised by those making representations.

This area is still a significant concern to West Midlands Police due the amount of alcohol fuelled crime and alcohol fuelled anti-social behaviour which has not diminished since the last application, despite the continual and on-going efforts of the local neighbourhood policing team. The area is complex with many vulnerable residents living near to the premises with either addiction problems, mental health issues or both. It is the view of West Midlands Police that the demand and threat through alcohol related crime and ASB is significant. Another premises is likely to add to these problems / issues and as such whatever that is proposed will be insufficient to meet both the concerns and real life issues identified by West Midlands Police.

Many thanks

Regards

Chris Jones 55410

Birmingham Central Licensing Team

West Midlands Police HQ
Lloyd House
Colmore Circus
Birmingham
B4 6NQ

(Sat nav postcode B4 6AT)

Contact us on 999 in an emergency or for all other matters please visit [WMPolice Online](#)

WITNESS STATEMENT

Criminal Procedure Rules, r 27.2; Criminal Justice Act 1967, s. 9; Magistrates' Courts Act 1980, s.5B

Crime No. URN

Statement of ROBERT CAPELLA

Age if under 18 OVER (if over 18 insert "over 18")

Occupation POLICE Community Support Officer 30415

This statement (consisting of page(s) each signed by me) is true to the best of my knowledge and belief and I make it knowing that, if it is tendered in evidence, I shall be liable to prosecution if I have wilfully stated in it anything which I know to be false, or do not believe to be true.

Signature: (witness) _____

Date 12/07/18

Tick if witness evidence is visually recorded ☐ (supply witness details on rear)

I am Police Community Support Officer 30415 Rob Capella, I have been in this role for 12 years working on the Lozells and East Handsworth Neighbourhood Police Team. This is an impact statement in regards an application to open a licence shop at 235-237 Lozells Road selling 24hours a day. This application I feel will have a negative affect on the improving location in Lozells.

The shop at this time is called City Bargins and is opposite George Street and the New Testament Church of God 240 Lozells Road which runs a soup kitchen once a week to help homeless and drug dependant victims. Next to the shop is 243 Lozells Road , Care First Services, this organisation runs a number of support hostels in and around Handsworth for 16-21year old children who have spent their early life in care. The front of this building has trees and a grassed area which during the night and weekends is used by street drinkers as is hidden away . The area is always subject to empty drinks cans ,broken bottles and rubbish. Staff at the centre are always reporting moving drinkers away from the location and they also report that visitors to the centre (Social Workers and children) comment on the rubbish and empty drinks cans/bottles. This area has been an area for drinkers for a long time and the Neighbourhood Team have been working for a long time to remove this sort of behaviour from the area with some success and reported crime in the location has been dropping over the last few years. Community members fear that with another shop selling drink will have an affect of attracting more drinkers to the location, increasing the fear of crime ,crime itself ,increasing litter and an increase in anti social behaviour. I have been asked at community meeting if we the police can help reduce even more drinks shops to the location as they fear crime will return.

To the other side of the planned shop is Lozells Central Mosque which has regular worshipers numbering up to 1000 and has a boys madrassa every day between 1600hrs and 2000hrs where 600 boys from 10years old to 18 years old attend most walk past the location of the planned shop.

ENC. I enclose 6 photographs of the location.

Signature

Signature witnessed by

03/2016

OFFICIAL – (when complete)

(4)

235 - 237 102 ELLS ROAD

Types - Accessories

OFF LICENCE

M

ENGLISH - TURKISH - K

OF

OFF
LICENCE

Lycamobile

Call the world for less



OFF LICENCE



5

235 - 237 LOZELES ROAD



243 6026115 ROAD CARE FIRST SERVICES

(7)



243 LOZELLIS ROAD - GARDEN FRONT ENTRANCE.



243 LOZEILS ROAD - SIDE AREA



243 LOZEILS ROAD - SIDE AREA

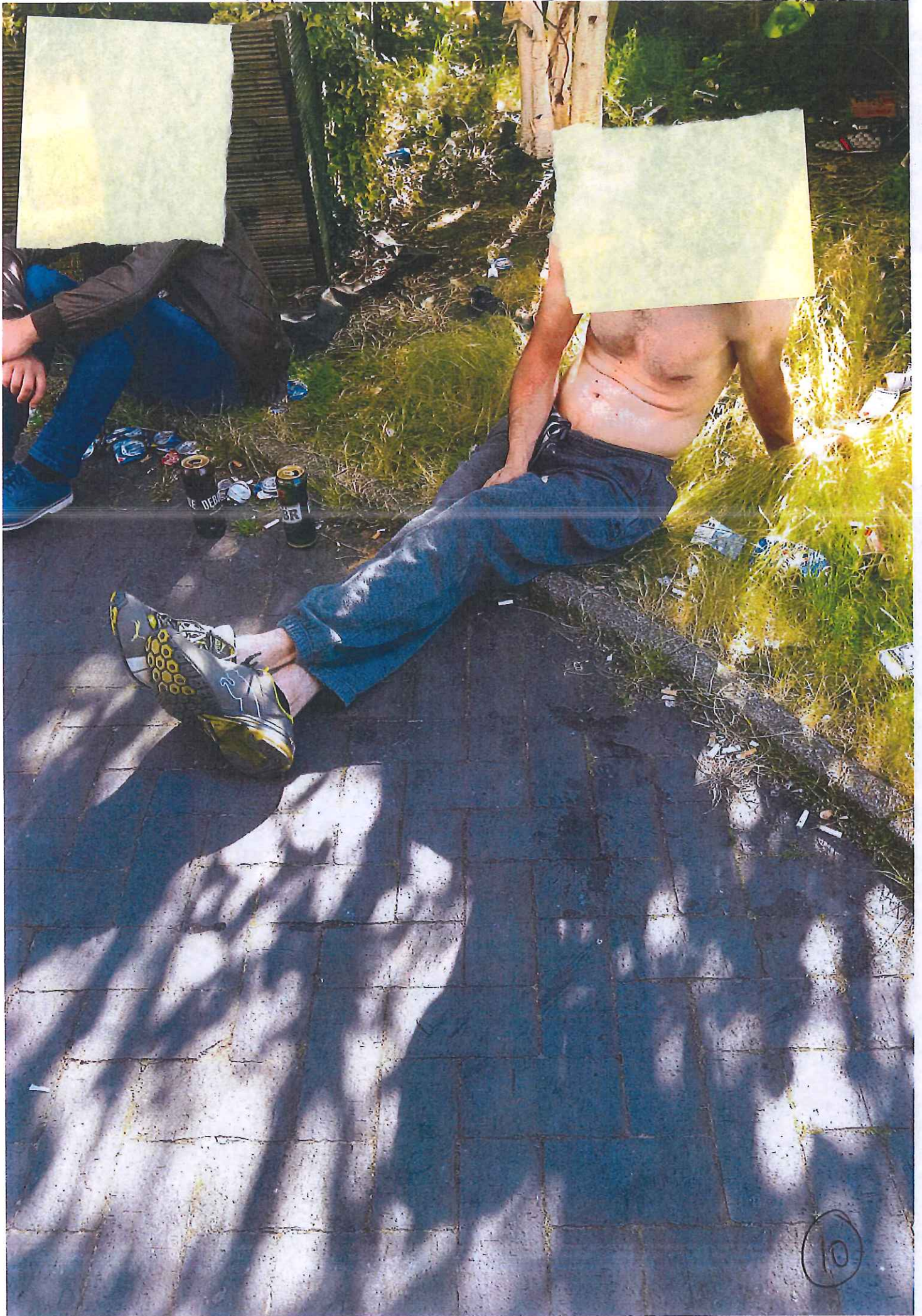



BIRMINGHAM CITY COUNCIL

LICENSING SUB-COMMITTEE A

6th AUGUST 2018

THE MINIMARKET, 235 – 237 LOZELLS ROAD, BIRMINGHAM B19 1RJ

That the application by Saman Jowhar Kahrahman for a premises licence in respect of The Minimarket, 235 – 237 Lozells Road, Birmingham B19 1RJ **BE REFUSED.**

The Sub-Committee's reasons for refusing this application for a premises licence are due to concerns expressed by West Midlands Police regarding the management of the proposed operation in what had for many years been a very difficult and challenging area for the neighbourhood Police team. In reaching this decision, the Sub-Committee was mindful of the promotion of the licensing objectives in the Act, particularly the prevention of crime and disorder and the protection of children from harm objectives.

The Sub-Committee paid particular attention to a statement submitted by the local PCSO which outlined the extensive problems of crime and anti-social behaviour in this part of Lozells and East Handsworth – caused in large part by street drinking and gang culture.

The Sub-Committee carefully considered the operating schedule put forward by the applicant, and the likely impact of the application, but were not persuaded that that the applicant and the proposed operation of the premises could promote the licensing objectives. Although it was accepted that the applicant had experience of running a similar type of shop in Telford, the Sub-Committee were not convinced that he fully understood the specific problems facing an alcohol retailer in the Lozells Road area.

West Midlands Police attended the meeting to confirm what the local PCSO had stated – that the area generated a huge amount of work for the neighbourhood Police team due to the numerous issues of crime, disorder and nuisance in and around Lozells Road. These issues were overwhelmingly created through irresponsible drinking; over the years it had been observed that the cause was the prevalence of street drinkers. The Police dealt constantly with drunkenness and extremely high levels of litter & refuse all over the area. Photographs were submitted - one showed two men sitting on the ground surrounded by alcohol; other photographs showed the extent of the severe litter problem in the area. The level of antisocial behaviour was high; the long-term demand on Police resources had been, and continued to be, significant.

The Police recommended that successful operation in Telford should not necessarily be seen as a reliable indicator of how the applicant would operate in the Lozells Road area, due to the specific problems seen in Lozells Road, as

illustrated by the PCSO's statement and photographs. Any proposal that would increase the availability of alcohol in an area already plagued by street drinkers required the applicant to have had experience of selling alcohol in this type of 'difficult' neighbourhood – otherwise, an increase in crime and disorder would be the likely result.

The Police stated that they were not confident that the applicant would be capable of promoting the licensing objectives. The Police considered that neither the applicant nor the operating schedule showed sufficient understanding of the Lozells Road environment. The Sub-Committee accepted this; given that alcohol-fuelled crime and disorder around Lozells Road was already a major problem for the neighbourhood Police, any additional licensed premises could place the licensing objectives at risk, unless the applicant was experienced in selling alcohol in this type of environment.

Another person also attended the meeting, represented by a solicitor, to address the Sub-Committee. This person was a local shopkeeper; he ran the premises adjacent to The Minimarket. His premises was a convenience shop licensed to sell alcohol by retail. The neighbouring shopkeeper had operated for a number of years, and therefore had a good understanding of the Lozells Road area.

The neighbouring shopkeeper confirmed that Lozells Road was exactly as described by the PCSO, with drunkenness, disorder, litter and nuisance all seen regularly. He stated that gangs and drugs had also become a feature of the area. He stated to the Sub-Committee that as a result of what he had directly observed whilst trading in his own shop, he shared the view of the Police – namely that Lozells Road was plagued by alcohol-fuelled crime and antisocial behaviour 'at such a level that it was difficult for licence holders to operate safely unless they were familiar with the area, or a similarly troubled area.

He explained that at the start of 2018 his shop had been subjected to a robbery in which a knife had been brandished; both cash and alcohol had been stolen from his shop. In another episode, there had been an attempt to rob the in-store cashpoint machine whilst it was being filled. The Sub-Committee noted that this shop was directly next door to The Minimarket, and therefore anybody proposing to operate in the premises would need to be prepared for these types of problems.

The neighbouring shopkeeper went on to explain that, as a result of these incidents, he had had to retrain his staff for their own safety, such that they understood what to do in 'conflict situations'. He had also had to adjust his staffing arrangements for safety reasons, ensuring that three members of staff would always be on duty.

All in all the neighbouring shopkeeper felt that the area was 'difficult', and therefore what was required was a person familiar with operation either in Lozells Road or in a comparable type of 'difficult' area. It was the opinion of the neighbouring shopkeeper that the applicant could not understand problems such as knife crime, gangs or drugs, as the applicant was not familiar with Lozells Road, and therefore would only understand trading in terms of the Telford area. (The Sub-Committee noted that the applicant had confirmed that he lived in Telford).

The Sub-Committee gave consideration to whether any measures could be taken

to ensure that the licensing objectives were adequately promoted and that therefore the licence might be granted; however Members considered that neither modifying the conditions of the licence nor excluding any of the licensable activities from the scope of the licence would mitigate the concerns raised by those making representations. The evidence of the Police and the neighbouring shopkeeper had shown that the area was indeed 'difficult', and therefore that any increased availability of alcohol would have to be very carefully managed by an experienced person. The instant applicant had experience of trading in Telford, but that was not a suitable comparator when considering Lozells and East Handsworth. The Sub-Committee had doubts that either the applicant, or the operating schedule, would be capable of upholding the licensing objectives in an area which already had significant problems of crime, disorder and nuisance. Accordingly the Sub-Committee resolved to refuse the application.

The Sub-Committee has given due consideration to the City Council's Statement of Licensing Policy, the Guidance issued under Section 182 of the Licensing Act 2003 by the Secretary of State, the information contained in the application, the written representations received and the submissions made at the hearing by the applicant, their adviser, and those making representations.

All parties are reminded that under the provisions contained within Schedule 5 to the Licensing Act 2003, there is the right of appeal against the decision of the Licensing Authority to the Magistrates' Court, such an appeal to be made within twenty-one days of the date of notification of the decision.

Published 13 March 2017

Contents

1. 1. Case law and the Licensing Act
[REDACTED]
3. 3. Hope and Glory Public House v City of Westminster Magistrates' Court and Others
4. 4. Daniel Thwaites plc v Wirral Magistrates' Court and Others
[REDACTED]

1. Case law and the Licensing Act

The Licensing Act 2003 is the Act of Parliament that establishes the statutory framework for regulating licensable activities in England and Wales. When cases are brought before the courts, the decisions can help us to interpret the Act.

When a case is decided by the courts the decision can provide an example of the interpretation of the Act. This can then be used to guide other committees and courts when they are making decisions on cases with similar facts.

It can be helpful for public health teams contributing to a new case to look at previous decisions and to understand the judgments that have been passed down. This can help you to make a more convincing case.

As a rule, the higher the court, the more weight a judgment carries. For example, a decision in a magistrates' court may be persuasive but a decision in the Court of Appeal will be binding. This means that another committee or court can consider the judgment from the magistrates' court and decide differently, but they must follow the decision of the Court of Appeal.

When you are relying on the decision in a particular case it is important to refer to the judgment itself rather than commentary, because commentators can interpret the judgment in different ways – it is always best to quote what the judge actually said.

Case names will be set out as 'the name of the party that brought the claim' versus 'the name of the party that the claim was against', followed by the year, then the court it was brought to and the case number. This is known as a 'neutral citation', and will help you find the judgment.

For example, R (on application of Hope and Glory Public House Ltd) v City of Westminster Magistrates' Court and Others (2011) EWCA Civ 31 indicates that in 2011 Hope and Glory Public House Ltd brought a claim against Westminster Magistrates' Court which was heard in the Civil Division of the Court of Appeal of England and Wales, and was the 31st case of the year.

There have been many cases decided by the courts since the Act came into force, but those described below are most frequently relied on.

3. Hope and Glory Public House v City of Westminster Magistrates' Court and Others

R (on application of Hope and Glory Public House Ltd) v City of Westminster Magistrates' Court and Others (2011) EWCA Civ 312

This case, referred to as 'Hope and Glory', is essential reading for Responsible Authorities and licensing committees. It is relevant to most hearings.

The decision is important because it:

- illustrates that licensed premises, and the activities that take place in those premises, exist in a dynamic environment and should not be looked at entirely in isolation
- confirms that this can include the impact that licensable activities have on a range of factors such as crime, the quality of life for residents and visitors to the area, and demand for licensed premises

- sets out the approach that should be taken when making licensing decisions

Lord Justice Toulson said:

Licensing decisions often involve weighing a variety of competing considerations: the demand for licensed establishments, the economic benefit to the proprietor and to the locality by drawing in visitors and stimulating the demand, the effect on law and order, the impact on the lives of those who live and work in the vicinity, and so on. Sometimes a licensing decision may involve narrower questions, such as whether noise, noxious smells or litter coming from premises amount to a public nuisance.

Although such questions are in a sense questions of fact, they are not questions of the 'heads or tails' variety. They involve an evaluation of what is to be regarded as reasonably acceptable in the particular location. In any case, deciding what (if any) conditions should be attached to a licence as necessary and proportionate to the promotion of the statutory licensing objectives is essentially a matter of judgment rather than a matter of pure fact.

Responsible Authorities should be encouraged by this decision to make representations so that their information can be taken into account, and appropriate measures put in place for the licensing objectives to be promoted.

The full judgment is available from the [British and Irish Legal Information Institute](#).

4. Daniel Thwaites plc v Wirral Magistrates' Court and Others

R (on application of Daniel Thwaites plc) v Wirral Magistrates' Court and Others (2008) EWHC 838 (Admin)

This case, referred to as 'the Thwaites case', is important because it emphasises the important role that Responsible Authorities have in providing information to decision makers to contextualise the issue before them.

This case is sometimes misconstrued as requiring decisions to be based on 'real evidence', and that conditions cannot be imposed until problems have actually occurred. This is wrong. The purpose of the Act is to prevent problems from happening. Decisions can and should be based on well-informed common sense. The case recognises that Responsible Authorities are experts in their fields, and that weight should be attached to their representations. It is most relevant when opposing grant applications.

The Honourable Mrs Justice Black said:

[D]rawing on local knowledge, at least the local knowledge of local licensing authorities, is an important feature of the Act's approach. There can be little doubt that local magistrates are also entitled to take into account their own knowledge but, in my judgment, they must measure their own views against the evidence presented to them. In some cases, the evidence presented will require them to adjust their own impression. This is particularly likely to be so where it is given by a Responsible Authority such as the police.

The approved judgment is available from [Guildford Council](#).

Appendix 3

Birmingham City Council, Licensing Section, P.O. Box 17013, Birmingham, B6 9ES

Application for a premises licence to be granted under the Licensing Act 2003

PLEASE READ THE FOLLOWING INSTRUCTIONS FIRST

Before completing this form please read the guidance notes at the end of the form. If you are completing this form by hand please write legibly in block capitals. In all cases ensure that your answers are inside the boxes and written in black ink. Use additional sheets if necessary.

You may wish to keep a copy of the completed form for your records.

I/We Saman Jowhar Kahrahman

(Insert name(s) of applicant)

apply for a premises licence under section 17 of the Licensing Act 2003 for the premises described in Part 1 below (the premises) and I/we are making this application to you as the relevant licensing authority in accordance with section 12 of the Licensing Act 2003

Part 1 – Premises Details		BCC REGULATION & ENFORCEMENT LICENSING SECTION	
Postal address of premises or, if none, or description		DATE RECEIVED 19 JUN 2018	
The Minimarket 235-237 Lozells Road		REF NO 009487/000612 INITIALS LW - £100.00	
Post town	Birmingham	Postcode	B19 1RJ

Telephone number at premises (if any)	Via Agent
Non-domestic rateable value of premises	£4,150

Part 2 - Applicant Details

Please state whether you are applying for a premises licence as

Please tick as appropriate

- | | |
|---|---|
| a) an individual or individuals * | <input checked="" type="checkbox"/> please complete section (A) |
| b) a person other than an individual * | |
| i. as a limited company | <input type="checkbox"/> please complete section (B) |
| ii. as a partnership | <input type="checkbox"/> please complete section (B) |
| iii. as an unincorporated association or | <input type="checkbox"/> please complete section (B) |
| iv. other (for example a statutory corporation) | <input type="checkbox"/> please complete section (B) |
| c) a recognised club | <input type="checkbox"/> please complete section (B) |
| d) a charity | <input type="checkbox"/> please complete section (B) |

- c) the proprietor of an educational establishment ☐ please complete section (B)
- f) a health service body ☐ please complete section (B)
- g) a person who is registered under Part 2 of the Care Standards Act 2000 (c14) in respect of an independent hospital in Wales ☐ please complete section (B)
- ga) a person who is registered under Chapter 2 of Part 1 of the Health and Social Care Act 2008 (within the meaning of that Part) in an independent hospital in England ☐ please complete section (B)
- h) the chief officer of police of a police force in England and Wales ☐ please complete section (B)

* If you are applying as a person described in (a) or (b) please confirm:

Please tick yes

I am carrying on or proposing to carry on a business which involves the use of the premises for licensable activities; or ☒

I am making the application pursuant to a

statutory function or ☐

a function discharged by virtue of Her Majesty's prerogative ☐

(A) INDIVIDUAL APPLICANTS (fill in as applicable)

Mr <input checked="" type="checkbox"/>	Mrs <input type="checkbox"/>	Miss <input type="checkbox"/>	Ms <input type="checkbox"/>	Other Title (for example, Rev)	
Surname Kahraman			First names Saman Jowhar		
I am 18 years old or over				<input checked="" type="checkbox"/> Please tick yes	
Current postal address if different from premises address					
Post town		Postcode			
Daytime contact telephone number		Via agent			
E-mail address (optional)					

SECOND INDIVIDUAL APPLICANT (if applicable)

Mr <input type="checkbox"/>	Mrs <input type="checkbox"/>	Miss <input type="checkbox"/>	Ms <input type="checkbox"/>	Other Title (for example, Rev)	
Surname			First names		
I am 18 years old or over				<input type="checkbox"/> Please tick yes	
Current postal address if different from premises address					
Post town				Postcode	
Daytime contact telephone number					
E-mail address (optional)					

(B) OTHER APPLICANTS

Please provide name and registered address of applicant in full. Where appropriate please give any registered number. In the case of a partnership or other joint venture (other than a body corporate), please give the name and address of each party concerned.

Name
Address
Registered number (where applicable)
Description of applicant (for example, partnership, company, unincorporated association etc.)
Telephone number (if any)
E-mail address (optional)

Part 3 Operating Schedule

When do you want the premises licence to start? **ASAP**

DD	MM	YYYY

If you wish the licence to be valid only for a limited period, when do you want it to end?

DD	MM	YYYY

Please give a general description of the premises (please read guidance note 1)

This premises is located on a busy main road and shopping area, it will offer a full selection of food and drink items, serving the local community. Its aim will always be to serve the community and give a full service to all of its customers.

The premises will have a positive impact on the community, which includes suppliers, employees, customers, the environment and the people of the local area.

If 5,000 or more people are expected to attend the premises at any one time, please state the number expected to attend.

--

What licensable activities do you intend to carry on from the premises?

(Please see sections 1 and 14 of the Licensing Act 2003 and Schedules 1 and 2 to the Licensing Act 2003)

Provision of regulated entertainment

Please tick any that apply

- | | |
|---|--------------------------|
| a) plays (if ticking yes, fill in box A) | <input type="checkbox"/> |
| b) films (if ticking yes, fill in box B) | <input type="checkbox"/> |
| c) indoor sporting events (if ticking yes, fill in box C) | <input type="checkbox"/> |
| d) boxing or wrestling entertainment (if ticking yes, fill in box D) | <input type="checkbox"/> |
| e) live music (if ticking yes, fill in box E) | <input type="checkbox"/> |
| f) recorded music (if ticking yes, fill in box F) | <input type="checkbox"/> |
| g) performances of dance (if ticking yes, fill in box G) | <input type="checkbox"/> |
| h) anything of a similar description to that falling within (e), (f) or (g) (if ticking yes, fill in box H) | <input type="checkbox"/> |

Provision of late night refreshment (if ticking yes, fill in box I)

☐

Supply of alcohol (if ticking yes, fill in box J)

☒

In all cases complete boxes K, L and M

A

J

Supply of alcohol Standard days and timings (please read guidance note 6)			Will the supply of alcohol be for consumption – please tick (please read guidance note 7)	On the premises	<input type="checkbox"/>
				Off the premises	<input checked="" type="checkbox"/>
Day	Start	Finish	Both <input type="checkbox"/>		
Mon	0730	0000	State any seasonal variations for the supply of alcohol (please read guidance note 4)		
Tue	0730	0000			
Wed	0730	0000			
Thurs	0730	0000	Non standard timings. Where you intend to use the premises for the supply of alcohol at different times to those listed in the column on the left, please list (please read guidance note 5)		
Fri	0730	0000			
Sat	0730	0000			
Sun	0730	0000			

State the name and details of the individual whom you wish to specify on the licence as designated premises supervisor:

Name.	
Saman Jowhar Kahraman	
Address	
Postcode	
Personal licence number (if known)	
Issuing licensing authority (if known)	

K

Please highlight any adult entertainment or services, activities, other entertainment or matters ancillary to the use of the premises that may give rise to concern in respect of children (please read guidance note 8).

N/A

L

Hours premises are open to the public Standard days and timings (please read guidance note 6)			State any seasonal variations (please read guidance note 4)
Day	Start	Finish	<u>Non standard timings. Where you intend the premises to be open to the public at different times from those listed in the column on the left, please list</u> (please read guidance note 5)
Mon	0730	0000	
Tue	0730	0000	
Wed	0730	0000	
Thurs	0730	0000	
Fri	0730	0000	
Sat	0730	0000	
Sun	0730	0000	

M

Describe the steps you intend to take to promote the four licensing objectives:

a) General – all four licensing objectives (b, c, d and e) (please read guidance note 9)

The premises will be professionally supervised by the PLH/DPS at all times.

Staff training will be both comprehensive and reviewed on a regular basis, with records being retained at the premises; available for inspection by any Responsible Authority at reasonable notice. This training will be delivered by an appropriate qualified trainer; with all new members of staff will be trained within 2 months of starting employment.

The Premises Licence Holder shall ensure that the premises use a refusals log, which will be signed off on a regular basis by the PLH/DPS.

b) The prevention of crime and disorder

The Premises Licence Holder will ensure that CCTV is installed on the premises and WM Police will be afforded full access to any recorded images. The Licence Holder shall ensure that the CCTV will be fitted correctly and that images will be held up to 31 days and these images will be made available upon request to any responsible authority.

The premises licence holder shall ensure the CCTV system is recording whenever the premises is open for licensable activities. CCTV will also be used to show the external area of the premises.

A refusals log will be kept at the premises and completed on any occasion an incident occurs, this will be made available to all Responsible Authorities on request.

c) Public safety

In accordance with the Licensing Act 2003, any person who appears drunk or heavily under the influence of alcohol will not be served.

The Premises Licence Holder shall ensure that all entrances, exits and passageways will be kept clear of debris or furniture, for ease of exiting the premises in the case of an emergency.

d) The prevention of public nuisance

The premises Licence Holder shall ensure that sufficient signage is displayed requesting customers to have regard for residents when leaving the premises.

The PLH and staff will ensure that regular litter picks take place at the frontage of the property, to ensure no debris is left as litter by customers.

e) The protection of children from harm

A "challenge 25" policy will be used for age verification, meaning any person who appears to be under 25 will be asked for approved proof of age when attempting to purchase alcohol.

Staff will be diligent in observing those who attempt to make proxy purchases on behalf of underage persons and alert the DPS should this occur.

Checklist:

Please tick to indicate agreement

- I have made or enclosed payment of the fee. ☒
- I have enclosed the plan of the premises. ☒
- I have sent copies of this application and the plan to responsible authorities and others where applicable. ☒
- I have enclosed the consent form completed by the individual I wish to be designated premises supervisor, if applicable. ☒
- I understand that I must now advertise my application. ☒
- I understand that if I do not comply with the above requirements my application will be rejected. ☒
- [Applicable to all individual applicants, including those in a partnership which is not a limited liability partnership, but not companies or limited liability partnerships] I have included documents demonstrating my entitlement to work in the United Kingdom (please read note 15). ☒

IT IS AN OFFENCE, LIABLE ON SUMMARY CONVICTION TO A FINE NOT EXCEEDING LEVEL 5 ON THE STANDARD SCALE, UNDER SECTION 158 OF THE LICENSING ACT 2003, TO MAKE A FALSE STATEMENT IN OR IN CONNECTION WITH THIS APPLICATION.

Part 4 – Signatures (please read guidance note 10)

Signature of applicant or applicant's solicitor or other duly authorised agent (see guidance note 11).

If signing on behalf of the applicant, please state in what capacity.

Signature	
Date	18 June 2018
Capacity	Agent for and on behalf of the applicant

For joint applications, signature of 2nd applicant or 2nd applicant's solicitor or other authorised agent (please read guidance note 12). If signing on behalf of the applicant, please state in what capacity.

Signature			
Date			
Capacity			
Contact name (where not previously given) and postal address for correspondence associated with this application (please read guidance note 13) Robert V Edge Licence Leader Ltd :			
Post town		Postcode	
Telephone number (if any)			
If you would prefer us to correspond with you by e-mail, your e-mail address (optional)			

235-237 Lozells Road
B19 1RJ

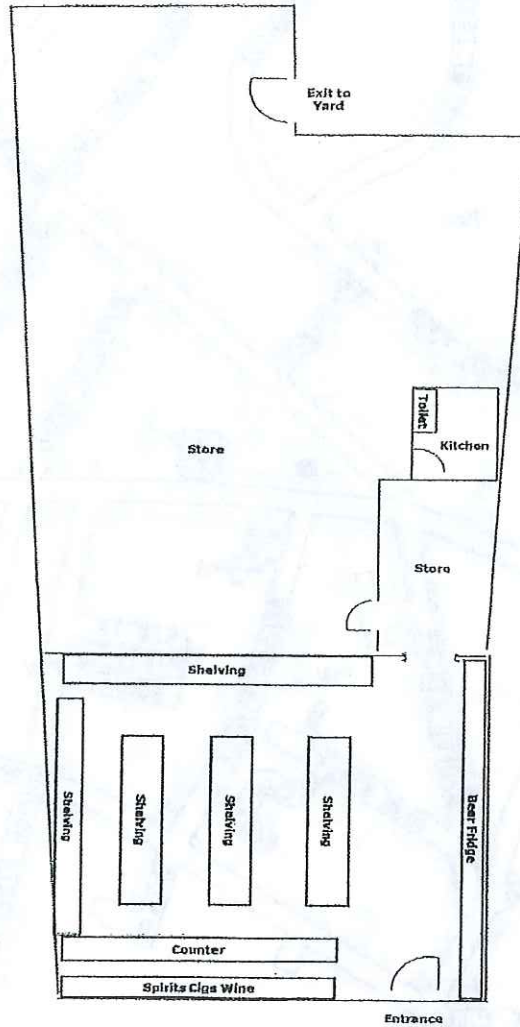

Licence Leader Ltd
www.licence-leader.co.uk

Version 01 – June 2018

Measurements supplied by owner
1:100

Appendix 4

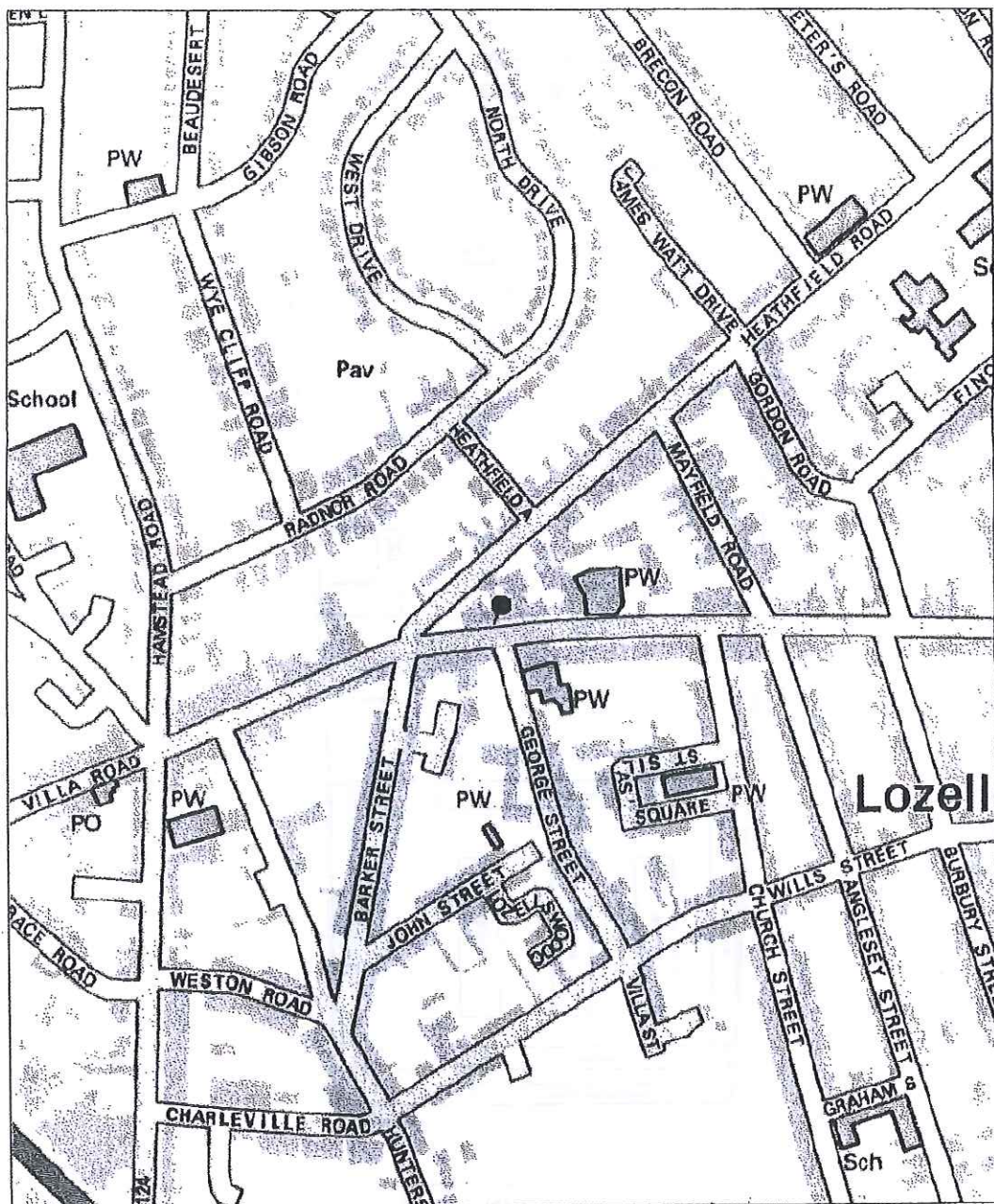

Map Created By:

Notes

Date of Map Creation: 24/07/2018



Scale:
1:4,000

(c) Crown copyright. All rights reserved. Birmingham City Council 100021326 (2016).
You are not permitted to copy, sub-licence, distribute or sell any of this data to third parties in any form.
(c) GeoPerspectives, supplied by Bluesky International Ltd
Cities Revealed® copyright by The GeoInformation® Group, 2014 and Crown Copyright © All right reserved

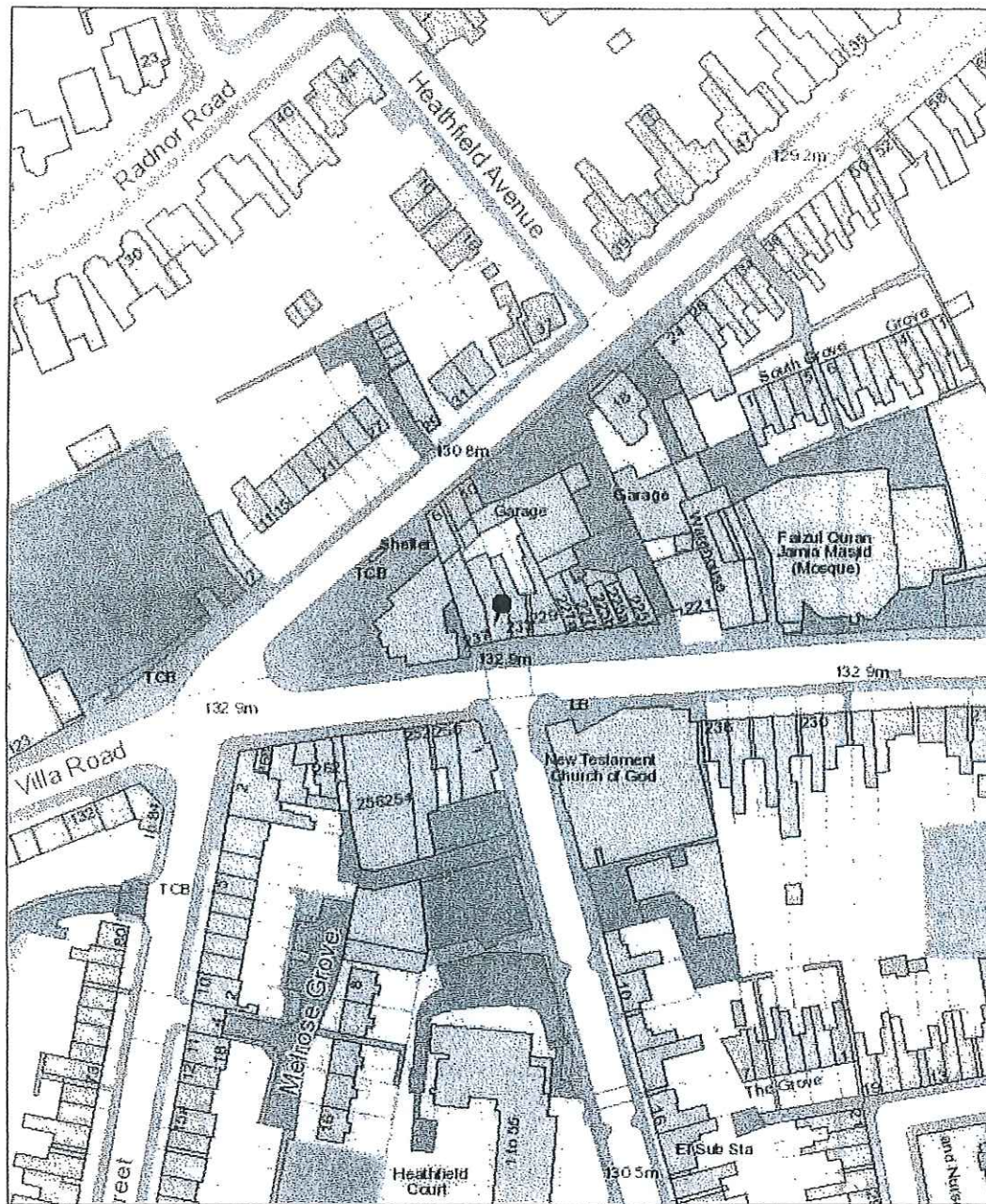

Birmingham City Council Map Created By:

Notes

Date of Map Creation: 24/07/2018



Scale:
1:1,250

(c) Crown copyright. All rights reserved. Birmingham City Council 100021326 (2016).
You are not permitted to copy, sub-licence, distribute or sell any of this data to third parties in any form.
(c) GeoPerspectives, supplied by Bluesky International Ltd
Cities Revealed© copyright by The GeoInformation® Group, 2014 and Crown Copyright © All right reserved

