

BIRMINGHAM CITY COUNCIL

PUBLIC REPORT

Report to:	Licensing Sub Committee C
Report of:	Interim Assistant Director of Regulation & Enforcement
Date of Meeting:	Wednesday 11th August 2021
Subject:	Licensing Act 2003 Premises Licence – Grant
Premises:	Al-Uruba Café, 391a Coventry Road, Small Heath, Birmingham, B10 0SP
Ward affected:	Bordesley Green
Contact Officer:	Shaid Yasser, Senior Licensing Officer licensing@birmingham.gov.uk

1. Purpose of report:

To consider representations that have been made in respect of an application for a Premises Licence which seeks to permit the provision of Late Night Refreshment, to operate indoors only, from 11:00pm until 5:00am (Monday to Sunday).

Premises to remain open to the public 24hours (Monday to Sunday).

2. Recommendation:

To consider the representations that have been made and to determine the application.

3. Brief Summary of Report:

An application for a Premises Licence was received on 21st June 2021 in respect of Al-Uruba Café, 391a Coventry Road, Small Heath, Birmingham, B10 0SP.

Representations have been received from Planning as a responsible authority, and from other persons.

4. Compliance Issues:

4.1 Consistency with relevant Council Policies, Plans or Strategies:

The report complies with the City Council's Statement of Licensing Policy and the Council's Corporate Plan to improve the standard of all licensed persons, premises and vehicles in the City.

5. Relevant background/chronology of key events:

Al-Uruba Cafe Limited applied on 21st June 2021 for the grant of a Premises Licence for Al-Uruba Café, 391a Coventry Road, Small Heath, Birmingham, B10 0SP.

A representation has been received from Planning as a responsible authority. See Appendix 1.

A representation has been received from other persons, which is attached at Appendix 2.

The application is attached at Appendix 3.

Conditions have been agreed with West Midlands Police and the applicant, which are attached at Appendix 4.

Site Location Plans at Appendix 5.

When carrying out its licensing functions, a licensing authority must have regard to Birmingham City Council's Statement of Licensing Policy and the Guidance issued by the Secretary of State under s182 of the Licensing Act 2003. The Licensing Authority is also required to take such steps as it considers appropriate for the promotion of the licensing objectives, which are:-

- a. The prevention of crime and disorder;
- b. Public safety;
- c. The prevention of public nuisance; and
- d. The protection of children from harm.

6. List of background documents:

Copy of the representations as detailed in Appendices 1 & 2
Application Form, Appendix 3
Conditions agreed with West Midlands Police, Appendix 4
Site Location Plans, Appendix 5

7. Options available

To Grant the licence in accordance with the application.

To Reject the application.

To Grant the licence subject to conditions modified to such an extent as considered appropriate.

Exclude from the licence any of the licensable activities to which the application relates.

From: Vajid Mahmood
Sent: 12 July 2021 13:50
To: Licensing Online
Subject: Re: Licensing Consultation - Al-Uruba Cafe, 391A Coventry Road, Birmingham, B10 0SP

Dear Licensing,

I am emailing you in relation to the above licensing enquiry under reference 2021/001580/ENQ. I have reviewed the planning history for this site and can advise that there is a planning condition placed on this site by Regulatory Services restricting the hours of operations. The condition states the following:

"Limits the hours of operation

The uses hereby approved shall only take place between the hours of 0900-2300 daily.

Reason: In order to define the permission and safeguard the amenities of occupiers of premises/dwellings in the vicinity in accordance with Paragraphs 3.8 and 3.10 of the Birmingham UDP 2005 and the National Planning Policy Framework. "

Based on the above condition by Regulatory Services restricting the hours of operation I can confirm that the planning department **objects** to the proposed use operating 24 hours 7 days a week and a license should not be issued on this basis.

If you require any further information please do not hesitate to contact me.

Kind Regards,

Vajid

From: Waste Warriors 0121
Sent: 19 July 2021 20:41
To: Licensing
Subject: Refusal of License of Al Aruba Cafe

Hi BCC

We like to refuse any license to these shops on Coventry rd due to the continuous fly tipping and litter issues we having. We have been out numerous times with little help and have had locals and mosques such as Zaid Al Sunnah opposite Al Aruba cafe to clean up during the Ramadan events of outside illegal camp stalls. We even had a article on Birmingham Mail

<https://www.birminghammail.co.uk/news/midlands-news/probe-illegal-after-dark-street-20558235>

So as your BBC you may make money from these shops but there is alot of waste issues daily and dont allow them anything else. This goes out to all of these shops using pavements for their business when it should be for pedestrians. You give them q hand they will take a arm. Than it becomes difficult later on as permission has been granted therefore a zero tolerance on all Coventry road shops of expansion of their business due to waste and health and saftey for pedestrians and car drivers. Check our facebook page

<facebook.com/WASTEWARRIORS0121>

Of work we have done and helping council always.

Waste Warriors Management
Wastewarriors0121

* required information

Section 1 of 21

You can save the form at any time and resume it later. You do not need to be logged in when you resume.

System reference This is the unique reference for this application generated by the system.

Your reference You can put what you want here to help you track applications if you make lots of them. It is passed to the authority.

Are you an agent acting on behalf of the applicant?
☒ Yes ☐ No Put "no" if you are applying on your own behalf or on behalf of a business you own or work for.

Applicant Details

* First name

* Family name

* E-mail

Main telephone number Include country code.

Other telephone number

☐ Indicate here if the applicant would prefer not to be contacted by telephone

Is the applicant:
☒ Applying as a business or organisation, including as a sole trader A sole trader is a business owned by one person without any special legal structure. Applying as an individual means the applicant is applying so the applicant can be employed, or for some other personal reason, such as following a hobby.
☐ Applying as an individual

Applicant Business

Is the applicant's business registered in the UK with Companies House? ☒ Yes ☐ No Note: completing the Applicant Business section is optional in this form.

Registration number

Business name If the applicant's business is registered, use its registered name.

VAT number Put "none" if the applicant is not registered for VAT.

Legal status

Continued from previous page...

Applicant's position in the business

Director

Home country

United Kingdom

The country where the applicant's headquarters are.

Registered Address

Address registered with Companies House.

Building number or name

391a

Street

Coventry Road

District

City or town

Birmingham

County or administrative area

Postcode

B10 0SP

Country

United Kingdom

Agent Details

* First name

Mr Gulraiz

* Family name

Siddique

* E-mail

Main telephone number

Include country code.

Other telephone number

☐ Indicate here if you would prefer not to be contacted by telephone

Are you:

☒ An agent that is a business or organisation, including a sole trader

A sole trader is a business owned by one person without any special legal structure.

☐ A private individual acting as an agent

Agent Business

Is your business registered in the UK with Companies House?

☒ Yes

☐ No

Note: completing the Applicant Business section is optional in this form.

Registration number

10900109

Business name

Architecture & Interior Design Ltd

If your business is registered, use its registered name.

VAT number

- 291029803

Put "none" if you are not registered for VAT.

Legal status

Private Limited Company

Continued from previous page...

Your position in the business	<input type="text" value="Director"/>	
Home country	<input type="text" value="United Kingdom"/>	The country where the headquarters of your business is located.
Agent Registered Address		Address registered with Companies House.
Building number or name	<input type="text"/>	
Street	<input type="text"/>	
District	<input type="text"/>	
City or town	<input type="text"/>	
County or administrative area	<input type="text"/>	
Postcode	<input type="text"/>	
Country	<input type="text"/>	

Section 2 of 21

PREMISES DETAILS

I/we, as named in section 1, apply for a premises licence under section 17 of the Licensing Act 2003 for the premises described in section 2 below (the premises) and I/we are making this application to you as the relevant licensing authority in accordance with section 12 of the Licensing Act 2003.

Premises Address

Are you able to provide a postal address, OS map reference or description of the premises?

☒ Address ☐ OS map reference ☐ Description

Postal Address Of Premises

Building number or name	<input type="text" value="Al-Uruba Cafe 391a"/>
Street	<input type="text" value="Coventry Road"/>
District	<input type="text"/>
City or town	<input type="text" value="Birmingham"/>
County or administrative area	<input type="text"/>
Postcode	<input type="text" value="B10 0SP"/>
Country	<input type="text" value="United Kingdom"/>

Further Details

Telephone number	<input type="text"/>
Non-domestic rateable value of premises (£)	<input type="text" value="9,500"/>

Section 3 of 21**APPLICATION DETAILS**

In what capacity are you applying for the premises licence?

- ☐ An individual or individuals
- ☒ A limited company / limited liability partnership
- ☐ A partnership (other than limited liability)
- ☐ An unincorporated association
- ☐ Other (for example a statutory corporation)
- ☐ A recognised club
- ☐ A charity
- ☐ The proprietor of an educational establishment
- ☐ A health service body
- ☐ A person who is registered under part 2 of the Care Standards Act 2000 (c14) in respect of an independent hospital in Wales
- ☐ A person who is registered under Chapter 2 of Part 1 of the Health and Social Care Act 2008 in respect of the carrying on of a regulated activity (within the meaning of that Part) in an independent hospital in England
- ☐ The chief officer of police of a police force in England and Wales

Confirm The Following

- ☒ I am carrying on or proposing to carry on a business which involves the use of the premises for licensable activities
- ☐ I am making the application pursuant to a statutory function
- ☐ I am making the application pursuant to a function discharged by virtue of Her Majesty's prerogative

Section 4 of 21**NON INDIVIDUAL APPLICANTS**

Provide name and registered address of applicant in full. Where appropriate give any registered number. In the case of a partnership or other joint venture (other than a body corporate), give the name and address of each party concerned.

Non Individual Applicant's Name

Name

AL-URUBA CAFE LIMITED

Details

Registered number (where applicable)

12373977

Description of applicant (for example partnership, company, unincorporated association etc)

Continued from previous page...

company

Address

Building number or name
Street
District
City or town
County or administrative area
Postcode
Country

Contact Details

E-mail
Telephone number
Other telephone number

* Date of birth / /

* Nationality

[Documents that demonstrate entitlement to work in the UK](#)

Section 5 of 21

OPERATING SCHEDULE

When do you want the premises licence to start? / /
dd mm yyyy

If you wish the licence to be valid only for a limited period, when do you want it to end / /
dd mm yyyy

Provide a general description of the premises

For example the type of premises, its general situation and layout and any other information which could be relevant to the licensing objectives. Where your application includes off-supplies of alcohol and you intend to provide a place for consumption of these off- supplies you must include a description of where the place will be and its proximity to the premises.

THE PREMISES IS A DOUBLE STOREY TYPE COMMERCIAL PROPERTY WHICH HAS A DINING AND KITCHEN/PREPERATION AREA ON THE GROUND FLOOR AND STORAGE TO THE REAR. THE PREMISES CURRENTLY SELLS BREAKFAST AND REFRESHMENTS.
INDOOR SEATING IS PROVIDED SHOULD CUSTOMERS WISH TO EAT INSIDE THE PREMISES.

<p><i>Continued from previous page...</i></p> <p>If 5,000 or more people are expected to attend the premises at any one time, state the number expected to attend</p> <div style="border: 1px solid black; width: 80px; height: 20px; margin-left: 100px;"></div>
Section 6 of 21
PROVISION OF PLAYS
<p>See guidance on regulated entertainment</p> <p>Will you be providing plays?</p> <p> <input type="radio"/> Yes <input checked="" type="radio"/> No </p>
Section 7 of 21
PROVISION OF FILMS
<p>See guidance on regulated entertainment</p> <p>Will you be providing films?</p> <p> <input type="radio"/> Yes <input checked="" type="radio"/> No </p>
Section 8 of 21
PROVISION OF INDOOR SPORTING EVENTS
<p>See guidance on regulated entertainment</p> <p>Will you be providing indoor sporting events?</p> <p> <input type="radio"/> Yes <input checked="" type="radio"/> No </p>
Section 9 of 21
PROVISION OF BOXING OR WRESTLING ENTERTAINMENTS
<p>See guidance on regulated entertainment</p> <p>Will you be providing boxing or wrestling entertainments?</p> <p> <input type="radio"/> Yes <input checked="" type="radio"/> No </p>
Section 10 of 21
PROVISION OF LIVE MUSIC
<p>See guidance on regulated entertainment</p> <p>Will you be providing live music?</p> <p> <input type="radio"/> Yes <input checked="" type="radio"/> No </p>
Section 11 of 21
PROVISION OF RECORDED MUSIC
<p>See guidance on regulated entertainment</p> <p>Will you be providing recorded music?</p> <p> <input type="radio"/> Yes <input checked="" type="radio"/> No </p>
Section 12 of 21
PROVISION OF PERFORMANCES OF DANCE
<p>See guidance on regulated entertainment</p> <p>Will you be providing performances of dance?</p>

Continued from previous page...

Section 13 of 21

PROVISION OF ANYTHING OF A SIMILAR DESCRIPTION TO LIVE MUSIC, RECORDED MUSIC OR PERFORMANCES OF DANCE

[See guidance on regulated entertainment](#)

Will you be providing anything similar to live music, recorded music or performances of dance?

☐ Yes ☒ No

Section 14 of 21

LATE NIGHT REFRESHMENT

Will you be providing late night refreshment?

☒ Yes ☐ No

Standard Days And Timings

MONDAY

Start

End

Start

End

Give timings in 24 hour clock.
(e.g., 16:00) and only give details for the days
of the week when you intend the premises
to be used for the activity.

TUESDAY

Start

End

Start

End

WEDNESDAY

Start

End

Start

End

THURSDAY

Start

End

Start

End

FRIDAY

Start

End

Start

End

SATURDAY

Start

End

Start

End

SUNDAY

Start

End

Start

End

Continued from previous page...

Will the provision of late night refreshment take place indoors or outdoors or both?

☒ Indoors
 ☐ Outdoors
 ☐ Both
 Where taking place in a building or other structure tick as appropriate. Indoors may include a tent.

State type of activity to be authorised, if not already stated, and give relevant further details, for example (but not exclusively) whether or not music will be amplified or unamplified.

PROVISION OF FOOD AND REFRESHMENT.

THERE IS NO ADULT ENTERTAINMENT OR SERVICES, ACTIVITIES, GAMBLING AND OTHER ENTERTAINMENT PROVIDED.

State any seasonal variations

For example (but not exclusively) where the activity will occur on additional days during the summer months.

Non-standard timings. Where the premises will be used for the supply of late night refreshments at different times from those listed in the column on the left, list below

For example (but not exclusively), where you wish the activity to go on longer on a particular day e.g. Christmas Eve.

Section 15 of 21

SUPPLY OF ALCOHOL

Will you be selling or supplying alcohol?

☐ Yes
 ☒ No

PROPOSED DESIGNATED PREMISES SUPERVISOR CONSENT

How will the consent form of the proposed designated premises supervisor be supplied to the authority?

☒ Electronically, by the proposed designated premises supervisor
 ☐ As an attachment to this application

Reference number for consent form (if known) If the consent form is already submitted, ask the proposed designated premises supervisor for its 'system reference' or 'your reference'.

Section 16 of 21

ADULT ENTERTAINMENT



Birmingham
Application for a premises licence
Licensing Act 2003

For help contact
licensingonline@birmingham.gov.uk
 Telephone: 0121 303 9896

* required information

Section 16 of 21

ADULT ENTERTAINMENT

Highlight any adult entertainment or services, activities, or other entertainment or matters ancillary to the use of the premises that may give rise to concern in respect of children

Give information about anything intended to occur at the premises or ancillary to the use of the premises which may give rise to concern in respect of children, regardless of whether you intend children to have access to the premises, for example (but not exclusively) nudity or semi-nudity, films for restricted age groups etc gambling machines etc.

THERE IS NO ADULT ENTERTAINMENT OR SERVICES, ACTIVITIES, GAMBLING AND OTHER ENTERTAINMENT PROVIDED.

Section 17 of 21

HOURS PREMISES ARE OPEN TO THE PUBLIC

Standard Days And Timings

MONDAY

Start 00:00

End 23:59

Start

End

Give timings in 24 hour clock.
(e.g., 16:00) and only give details for the days
of the week when you intend the premises
to be used for the activity.

TUESDAY

Start 00:00

End 23:59

Start

End

WEDNESDAY

Start 00:00

End 23:59

Start

End

THURSDAY

Start 00:00

End 23:59

Start

End

FRIDAY

Start 00:00

End 23:59

Start

End

SATURDAY

Start 00:00

End 23:59

Start

End

SUNDAY

Start 00:00

End 23:59

Start

End

State any seasonal variations

For example (but not exclusively) where the activity will occur on additional days during the summer months.

Continued from previous page...

--

Non standard timings. Where you intend to use the premises to be open to the members and guests at different times from those listed in the column on the left, list below

For example (but not exclusively), where you wish the activity to go on longer on a particular day e.g. Christmas Eve.

--

Section 18 of 21

LICENSING OBJECTIVES

Describe the steps you intend to take to promote the four licensing objectives:

a) General – all four licensing objectives (b,c,d,e)

List here steps you will take to promote all four licensing objectives together.

CRIME, DISORDER, PUBLIC SAFETY AND PUBLIC NUISANCE WILL BE CONTAINED BY TRAINED MEMBERS OF STAFF SHOULD ANY INCIDENT HAPPEN THE RESPONSIBLE AUTHORITY WILL BE NOTIFIED. CCTV IS IN OPERATION 24/7 WITH NOTICES/SIGNS CONTAINING WARNINGS TO USERS. THE CAFE WILL ALSO HAVE AT LEAST 1NO. MEMBER OF STAFF WHO WILL BE TRAINED FOR FIRST AID.

b) The prevention of crime and disorder

SIGNAGE WILL BE PUT UP TO STATE ANY PERSONS TO CAUSE A NUISANCE, FIGHTING OR ANY DRUG RELATED OFFENCES WILL BE BANNED FROM THE PREMISES. SHOULD ANY SERIOUS INCIDENCES OCCUR MEMBERS OF STAFF WILL NOTIFY THE RESPONSIBLE AUTHORITY. CCTV WILL BE INSTALLED TO THE SATISFACTION OF WEST MIDLANDS POLICE. THIS WILL BE IN OPERATION WHENEVER THE PREMISES IS OPEN TO MEMBERS OF THE PUBLIC. IT WILL MAINTAIN RECORDINGS FOR 28 DAYS. THE RECORDINGS OF WHICH WILL BE MADE AVAILABLE IMMEDIATELY BY A MEMBER OF STAFF ON REASONABLE REQUEST OF A RESPONSIBLE AUTHORITY.

c) Public safety

THERE WILL BE AT LEAST ONE MEMBER OF STAFF WHO HAS FIRST AID TRAINING AT ANY ONE TIME. SHOULD ANY INCIDENTS HAPPEN; THE TRAINED MEMBER OF STAFF WILL ASSESS THE SITUATION AND CALL EMERGENCY SERVICES WHEN APPROPRIATE. ALL INCIDENCES WILL BE LOGGED BY ALL STAFF.

d) The prevention of public nuisance

SHOULD TROUBLE/PUBLIC NUISANCE OCCUR OUTSIDE THE PREMISES STAFF WILL INFORM THE APPROPRIATE AUTHORITY AND WILL WORK WITH ANY AUTHORITIES INVOLVED IF REQUIRED TO CONTROL A SITUATION. ALL MEMBERS OF STAFF ARE GIVEN TRAINING FOR DIFFERENT SITUATIONS.

e) The protection of children from harm

NO ADULT SERVICES, ACTIVITIES OR ENTERTAINMENT TO BE PROVIDED ON THE PREMISES AT ANY TIME. ALL TRAINING RECORDS FOR ALL STAFF, IN REGARD TO DRUNKENNESS, AND FOR THE PROTECTION FROM HARM FOR CHILDREN TO BE MAINTAINED AND TO BE AVAILABLE UPON REQUEST FROM ANY REGULATORY BODY.

Section 19 of 21

NOTES ON DEMONSTRATING ENTITLEMENT TO WORK IN THE UK

Entitlement to work/Immigration status for Individual applicants and applications from partnerships which are not limited liability partnerships:

A licence may not be held by an individual or an individual in a partnership who is resident in the UK who:

- does not have the right to live and work in the UK; or
- is subject to a condition preventing him or her from doing work relating to the carrying on of a licensable activity.

Any premises licence issued in respect of an application made on or after 6 April 2017 will become invalid if the holder ceases to be entitled to work in the UK.

Applicants must demonstrate that they have an entitlement to work in the UK and are not subject to a condition preventing them from doing work relating to the carrying on of a licensable activity. They do this in one of two ways: 1) by providing with this application copies or scanned copies of the documents listed below (which do not need to be certified), or 2) by providing their 'share code' to enable the licensing authority to carry out a check using the Home Office online right to work checking service (see below).

Documents which demonstrate entitlement to work in the UK

- An expired or current passport showing the holder, or a person named in the passport as the child of the holder, is A British citizen or a citizen of the UK and Colonies having the right of abode in the UK [please see note below about which sections of the passport to copy].
- An expired or current passport or national identity card showing the holder, or a person named in the passport as the child of the holder, is a national of a European Economic Area country or Switzerland.
- A Registration Certificate or document certifying permanent residence issued by the Home Office to a national of a European Economic Area country or Switzerland.
- A Permanent Residence Card issued by the Home Office to the family member of a national of a European Economic Area country or Switzerland.
- A **current** Biometric Immigration Document (Biometric Residence Permit) issued by the Home Office to the holder indicating that the person named is allowed to stay indefinitely in the UK, or has no time limit on their stay in the UK.
- A **current** passport endorsed to show that the holder is exempt from immigration control, is allowed to stay indefinitely in the UK, has the right of abode in the UK, or has no time limit on their stay in the UK.
- A **current** Immigration Status Document issued by the Home Office to the holder with an endorsement indicating that the named person is allowed to stay indefinitely in the UK or has no time limit on their stay in the UK, **when produced in combination with** an official document giving the person's permanent National Insurance number and their name issued by a Government agency or a previous employer.
- A birth or adoption certificate issued in the UK, **when produced in combination with** an official document giving the person's permanent National Insurance number and their name issued by a Government agency or a previous employer.
- A birth or adoption certificate issued in the Channel Islands, the Isle of Man or Ireland **when produced in combination with** an official document giving the person's permanent National Insurance number and their name issued by a Government agency or a previous employer.
- A certificate of registration or naturalisation as a British citizen, **when produced in combination with** an official document giving the person's permanent National Insurance number and their name issued by a Government agency or a previous employer.

Continued from previous page...

- A **current** passport endorsed to show that the holder is allowed to stay in the UK and is currently allowed to work and is not subject to a condition preventing the holder from doing work relating to the carrying on of a licensable activity.
- A **current** Biometric Immigration Document (Biometric Residence Permit) issued by the Home Office to the holder which indicates that the named person can currently stay in the UK and is allowed to work relation to the carrying on of a licensable activity.
- A **current** Residence Card issued by the Home Office to a person who is not a national of a European Economic Area state or Switzerland but who is a family member of such a national or who has derivative rights or residence.
- A **current** Immigration Status Document containing a photograph issued by the Home Office to the holder with an endorsement indicating that the named person may stay in the UK, and is allowed to work and is not subject to a condition preventing the holder from doing work relating to the carrying on of a licensable activity **when produced in combination with** an official document giving the person's permanent National Insurance number and their name issued by a Government agency or a previous employer.
- A Certificate of Application, **less than 6 months old**, issued by the Home Office under regulation 18(3) or 20(2) of the Immigration (European Economic Area) Regulations 2016, to a person who is not a national of a European Economic Area state or Switzerland but who is a family member of such a national or who has derivative rights of residence.
- Reasonable evidence that the person has an outstanding application to vary their permission to be in the UK with the Home Office such as the Home Office acknowledgement letter or proof of postage evidence, or reasonable evidence that the person has an appeal or administrative review pending on an immigration decision, such as an appeal or administrative review reference number.
- Reasonable evidence that a person who is not a national of a European Economic Area state or Switzerland but who is a family member of such a national or who has derivative rights of residence in exercising treaty rights in the UK including:-
 - evidence of the applicant's own identity – such as a passport,
 - evidence of their relationship with the European Economic Area family member – e.g. a marriage certificate, civil partnership certificate or birth certificate, and
 - evidence that the European Economic Area national has a right of permanent residence in the UK or is one of the following if they have been in the UK for more than 3 months:
 - (i) working e.g. employment contract, wage slips, letter from the employer,
 - (ii) self-employed e.g. contracts, invoices, or audited accounts with a bank,
 - (iii) studying e.g. letter from the school, college or university and evidence of sufficient funds; or
 - (iv) self-sufficient e.g. bank statements.

Family members of European Economic Area nationals who are studying or financially independent must also provide evidence that the European Economic Area national and any family members hold comprehensive sickness insurance in the UK. This can include a private medical insurance policy, an EHIC card or an S1, S2 or S3 form.

Original documents must not be sent to licensing authorities. If the document copied is a passport, a copy of the following pages should be provided:-

- (i) any page containing the holder's personal details including nationality;
- (ii) any page containing the holder's photograph;
- (iii) any page containing the holder's signature;
- (iv) any page containing the date of expiry; and
- (v) any page containing information indicating the holder has permission to enter or remain in the UK and is permitted to work.

Continued from previous page...

If the document is not a passport, a copy of the whole document should be provided.

Your right to work will be checked as part of your licensing application and this could involve us checking your immigration status with the Home Office. We may otherwise share information with the Home Office. Your licence application will not be determined until you have complied with this guidance.

Home Office online right to work checking service

As an alternative to providing a copy of the documents listed above, applicants may demonstrate their right to work by allowing the licensing authority to carry out a check with the Home Office online right to work checking service.

To demonstrate their right to work via the Home Office online right to work checking service, applicants should include in this application their 9-digit share code (provided to them upon accessing the service at <https://www.gov.uk/prove-right-to-work>) which, along with the applicant's date of birth (provided within this application), will allow the licensing authority to carry out the check.

In order to establish the applicant's right to work, the check will need to indicate that the applicant is allowed to work in the United Kingdom and is not subject to a condition preventing them from doing work relating to the carrying on of a licensable activity.

An online check will not be possible in all circumstances because not all applicants will have an immigration status that can be checked online. The Home Office online right to work checking service sets out what information and/or documentation applicants will need in order to access the service. Applicants who are unable to obtain a share code from the service should submit copy documents as set out above.

Section 20 of 21

NOTES ON REGULATED ENTERTAINMENT

Continued from previous page...

In terms of specific **regulated entertainments** please note that:

- Plays: no licence is required for performances between 08:00 and 23:00 on any day, provided that the audience does not exceed 500.
- Films: no licence is required for 'not-for-profit' film exhibition held in community premises between 08:00 and 23:00 on any day provided that the audience does not exceed 500 and the organiser (a) gets consent to the screening from a person who is responsible for the premises; and (b) ensures that each such screening abides by age classification ratings.
- Indoor sporting events: no licence is required for performances between 08:00 and 23:00 on any day, provided that the audience does not exceed 1000.
- Boxing or Wrestling Entertainment: no licence is required for a contest, exhibition or display of Greco-Roman wrestling, or freestyle wrestling between 08:00 and 23:00 on any day, provided that the audience does not exceed 1000. Combined fighting sports – defined as a contest, exhibition or display which combines boxing or wrestling with one or more martial arts – are licensable as a boxing or wrestling entertainment rather than an indoor sporting event.
- Live music: no licence permission is required for:
 - o a performance of unamplified live music between 08:00 and 23:00 on any day, on any premises.
 - o a performance of amplified live music between 08:00 and 23:00 on any day on premises authorised to sell alcohol for consumption on those premises, provided that the audience does not exceed 500.
 - o a performance of amplified live music between 08:00 and 23:00 on any day, in a workplace that is not licensed to sell alcohol on those premises, provided that the audience does not exceed 500.
 - o a performance of amplified live music between 08:00 and 23:00 on any day, in a church hall, village hall, community hall, or other similar community premises, that is not licensed by a premises licence to sell alcohol, provided that (a) the audience does not exceed 500, and (b) the organiser gets consent for the performance from a person who is responsible for the premises.
 - o a performance of amplified live music between 08:00 and 23:00 on any day, at the non-residential premises of (i) a local authority, or (ii) a school, or (iii) a hospital, provided that (a) the audience does not exceed 500, and (b) the organiser gets consent for the performance on the relevant premises from: (i) the local authority concerned, or (ii) the school or (iii) the health care provider for the hospital.
- Recorded Music: no licence permission is required for:
 - o any playing of recorded music between 08:00 and 23:00 on any day on premises authorised to sell alcohol for consumption on those premises, provided that the audience does not exceed 500.
 - o any playing of recorded music between 08:00 and 23:00 on any day, in a church hall, village hall, community hall, or other similar community premises, that is not licensed by a premises licence to sell alcohol, provided that (a) the audience does not exceed 500, and (b) the organiser gets consent for the performance from a person who is responsible for the premises.
 - o any playing of recorded music between 08:00 and 23:00 on any day, at the non-residential premises of (i) a local authority, or (ii) a school, or (iii) a hospital, provided that (a) the audience does not exceed 500, and (b) the organiser gets consent for the performance on the relevant premises from: (i) the local authority concerned, or (ii) the school proprietor or (iii) the health care provider for the hospital.

Continued from previous page...

- Dance: no licence is required for performances between 08.00 and 23.00 on any day, provided that the audience does not exceed 500. However, a performance which amounts to adult entertainment remains licensable.
- Cross activity exemptions: no licence is required between 08.00 and 23.00 on any day, with no limit on audience size for:
 - o any entertainment taking place on the premises of the local authority where the entertainment is provided by or on behalf of the local authority;
 - o any entertainment taking place on the hospital premises of the health care provider where the entertainment is provided by or on behalf of the health care provider;
 - o any entertainment taking place on the premises of the school where the entertainment is provided by or on behalf of the school proprietor; and
 - o any entertainment (excluding films and a boxing or wrestling entertainment) taking place at a travelling circus, provided that (a) it takes place within a moveable structure that accommodates the audience, and (b) that the travelling circus has not been located on the same site for more than 28 consecutive days.

Section 21 of 21

PAYMENT DETAILS

This fee must be paid to the authority. If you complete the application online, you must pay it by debit or credit card.

Premises Licence Fees are determined by the non domestic rateable value of the premises.

To find out a premises non domestic rateable value go to the Valuation Office Agency site at <https://www.tax.service.gov.uk/business-rates-find/search>

Band A - No RV to £4300 - £100.00

Band B - £4301 to £33000 - £190.00

Band C - £33001 to £87000 - £315.00

Band D - £87001 to £125000 - £450.00*

Band E - £125001 and over - £635.00*

*If the premises rateable value is in Bands D or E and the premises is primarily used for the consumption of alcohol on the premises then you are required to pay a higher fee

Band D - £87001 to £125000 - £900.00

Band E - £125001 and over - £1,905.00

There is an exemption from the payment of fees in relation to the provision of regulated entertainment at church halls, chapel halls or premises of a similar nature, village halls, parish or community halls, or other premises of a similar nature. The costs associated with these licences will be met by central Government. If, however, the licence also authorises the use of the premises for the supply of alcohol or the provision of late night refreshment, a fee will be required.

Schools and sixth form colleges are exempt from the fees associated with the authorisation of regulated entertainment where the entertainment is provided by and at the school or college and for the purposes of the school or college.

If you operate a large event you are subject to ADDITIONAL fees based upon the number in attendance at any one time

Capacity 5000-9999 - £1,000.00

Capacity 10000-14999 - £2,000.00

Capacity 15000-19999 - £4,000.00

Capacity 20000-29999 - £8,000.00

Capacity 30000-39999 - £16,000.00

Capacity 40000-49999 - £24,000.00

Capacity 50000-59999 - £32,000.00

Capacity 60000-69999 - £40,000.00

Capacity 70000-79999 - £48,000.00

Capacity 80000-89999 - £56,000.00

Capacity 90000 and over - £64,000.00

* Fee amount (£)

190.00

DECLARATION

Continued from previous page...

[APPLICABLE TO INDIVIDUAL APPLICANTS ONLY, INCLUDING THOSE IN A PARTNERSHIP WHICH IS NOT A LIMITED LIABILITY PARTNERSHIP] I UNDERSTAND I AM NOT ENTITLED TO BE ISSUED WITH A LICENCE IF I DO NOT HAVE THE

- * ENTITLEMENT TO LIVE AND WORK IN THE UK (OR IF I AM SUBJECT TO A CONDITION PREVENTING ME FROM DOING WORK RELATING TO THE CARRYING ON OF A LICENSABLE ACTIVITY) AND THAT MY LICENCE WILL BECOME INVALID IF I CEASE TO BE ENTITLED TO LIVE AND WORK IN THE UK (PLEASE READ GUIDANCE NOTE 15).

THE DPS NAMED IN THIS APPLICATION FORM IS ENTITLED TO WORK IN THE UK (AND IS NOT SUBJECT TO CONDITIONS

- * PREVENTING HIM OR HER FROM DOING WORK RELATING TO A LICENSABLE ACTIVITY) AND I HAVE SEEN A COPY OF HIS OR HER PROOF OF ENTITLEMENT TO WORK, IF APPROPRIATE (PLEASE SEE NOTE 15).

☒ Ticking this box indicates you have read and understood the above declaration

This section should be completed by the applicant, unless you answered "Yes" to the question "Are you an agent acting on behalf of the applicant?"

* Full name

* Capacity

* Date / /
dd mm yyyy

[Add another signatory](#)

Once you're finished you need to do the following:

1. Save this form to your computer by clicking file/save as...
2. Go back to <https://www.gov.uk/apply-for-a-licence/premises-licence/birmingham/apply-1> to upload this file and continue with your application.

Don't forget to make sure you have all your supporting documentation to hand.

IT IS AN OFFENCE LIABLE TO SUMMARY CONVICTION TO A FINE OF ANY AMOUNT UNDER SECTION 158 OF THE LICENSING ACT 2003, TO MAKE A FALSE STATEMENT IN OR IN CONNECTION WITH THIS APPLICATION

IT IS AN OFFENCE UNDER SECTION 24B OF THE IMMIGRATION ACT 1971 FOR A PERSON TO WORK WHEN THEY KNOW, OR HAVE REASONABLE CAUSE TO BELIEVE, THAT THEY ARE DISQUALIFIED FROM DOING SO BY REASON OF THEIR IMMIGRATION STATUS. THOSE WHO EMPLOY AN ADULT WITHOUT LEAVE OR WHO IS SUBJECT TO CONDITIONS AS TO EMPLOYMENT WILL BE LIABLE TO A CIVIL PENALTY UNDER SECTION 15 OF THE IMMIGRATION, ASYLUM AND NATIONALITY ACT 2006 AND PURSUANT TO SECTION 21 OF THE SAME ACT, WILL BE COMMITTING AN OFFENCE WHERE THEY DO SO IN THE KNOWLEDGE, OR WITH REASONABLE CAUSE TO BELIEVE, THAT THE EMPLOYEE IS DISQUALIFIED

The contractor is responsible for checking dimensions, tolerances and materials. Any discrepancy is to be notified with the Architect before proceeding with the work.

Where an item is covered by drawings is different scales the larger scale drawing is to be adopted.

Do not scale drawing. Figure dimensions to be indicated in all cases.

- FLV C** FLYCATCHER
- HD** HAND DRYER FOR TOILETS
- OST HEATER** OVER DOOR HEATER
- L** ALARM SENSOR PIR/DOOR DUAL TECH
- > BT 1** TELEPHONE LINE 1
- > BT 2** TELEPHONE LINE 2
- CONV** ALARM DOOR CONTACT
- NET** CCTV QUANTITY AND LOCATIONS TO BE COMPARED WITH CLIENT NETWORK POINTS X2
- HI** FIRE ALARM SOUNDER BEACON
- SO** HIGH TEMPERATURE HEAT DETECTOR
- EL** SMOKE DETECTOR
- ← E** EMERGENCY LIGHTING ABOVE DOOR
- E** EMERGENCY EXIT DIRECTION SIGN
- EX** FIRE EXIT SIGN
- EX** BREAK GLASS
- EL33S** FIRE/ALARM CONTROL PANEL
- FE** 30mm SELF CLOSING FIRE DOOR WITH SMOKE SEALS AND INTUMESCENT STRIPS
- FPE** FIRE EXTINGUISHER
- G** FPM FOAM FIRE EXTINGUISHER
- CT** EMERGENCY GAS SWITCH OFF
- L** CHANGEPART 13A Double socket
- TH** Low Watt 10A Double socket
- TH** Table heater 600mm 13A Double socket with usb ports
- T** Proposed table right refreshment license activity

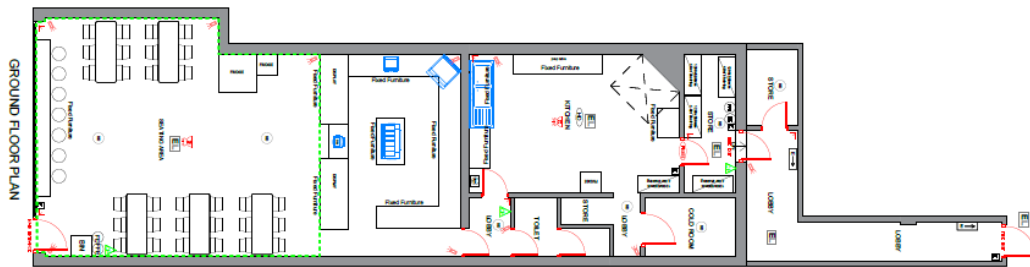

GROUND FLOOR PLAN

Project of record PLANNING		371 Coventry Road Birmingham B10 0SP	
Drawing No. 2021-0127-002		Drawing EXISTING PLANS	
Client: GL	Designer:	Scale: 1:1000A3	Date: 14 JUL 2021
			

From: Mohammed Sultan
Sent: 18 June 2021 10:35
To: Mark Swallow
Subject: [External]: RE: Al-Uruba Cafe, Coventry Road, Small Heath. B10 0SB.

CAUTION: This email originated from outside of West Midlands Police. Do not click links or open attachments unless you are sure the content is safe.

Dear Mark

The client has accepted the below conditions see attached revised application form as the timings were incorrect.

Should you require additional information please do not hesitate to contact us

Regards,

Mohammed Sultan Malik (MArch)
Architecture & Interior Design

From: Mark Swallow
Sent: 17 June 2021 15:13
To: Mohammed Sultan
Subject: Al-Uruba Cafe, Coventry Road, Small Heath. B10 0SB.

Gulraiz,

I am in receipt of the above application. Could you forward me please the home address of the applicant in order that I can complete the checks into the application.

In order to promote the licensing objectives can you discuss please with your client the following conditions to be added to the license. If they are acceptable please forward this to me at the above email address and I will progress the matter with the local authority. If there are any issues please either contact me on the above email address or phone

Mark Swallow.
West Midlands Police
Birmingham Central Licensing Team.

1. Staff are to be trained in their responsibilities under the Licensing Act 2003 prior to being allowed to work in the cafe. All training is to be documented and signed by the Premises License Holder and the trainee. All training records are to be made available to any of the responsible authorities on request.
2. Staff are to receive documented refresher training every six months. These records are to be made available to any of the responsible authorities on request.
3. Between the hours of 2300 and 0500 no persons under the age of 18 years will be allowed into the premises unless accompanied by a person aged 18 years or older.
4. CCTV that is approved by West Midlands police will be fitted in the premises. Images will be retained for a period of at least 31 days and will be made available to any of the responsible authorities to view or copies produced on request. If for any reason the CCTV hard drive needs

to be replaced the previous / old hard drive will be kept on site for a minimum of 31 days and made immediately available to any of the responsible authorities on request.

5. The premises will maintain an incident log and a refusals register. Both will be made available to any of the responsible authorities on request,

6. No alcohol will be either supplied, sold or consumed on the premises.

