

# BIRMINGHAM CITY COUNCIL

## PUBLIC REPORT

<b>Report to:</b>	<b>Licensing Sub Committee C</b>
<b>Report of:</b>	<b>Interim Assistant Director of Regulation &amp; Enforcement</b>
<b>Date of Meeting:</b>	<b>Wednesday 19<sup>th</sup> August 2020</b>
<b>Subject:</b>	<b>Licensing Act 2003 Premises Licence – Grant</b>
<b>Premises:</b>	<b>Circle Fish Bar, 9 Kettlehouse Road, Kingstanding, Birmingham, B44 9JH</b>
<b>Ward affected:</b>	<b>Oscott</b>
<b>Contact Officer:</b>	<b>David Kennedy, Principal Licensing Officer, <a href="mailto:licensing@birmingham.gov.uk">licensing@birmingham.gov.uk</a></b>

### 1. Purpose of report:

To consider a representation that has been made in respect of an application for a Premises Licence which seeks to permit the Sale of Alcohol (for consumption off the premises only) to operate from 12:00midday until 4:00am (Monday to Sunday).

The sale of alcohol will be an online delivery service only with hot food orders.

To permit the provision of Late Night Refreshment, to operate outdoors only, from 11:00pm until 4:00am (Monday to Sunday).

Due to the nature of the application hot food will be available for takeaway or delivery until 12:00midnight (Sunday to Thursday) and until 2:00am (Friday and Saturday), with an online delivery service available until 4:00am (Monday to Sunday).

The premises is to remain open to the public from 12:00midday until 12:00midnight (Sunday to Thursday) and 12:00midday until 2:00am (Friday and Saturday).

### 2. Recommendation:

To consider the representation that has been made and to determine the application.

### 3. Brief Summary of Report:

An application for a Premises Licence was received on 6<sup>th</sup> July 2020 in respect of Circle Fish Bar, 9 Kettlehouse Road, Kingstanding, Birmingham, B44 9JH.

A representation has been received from West Midlands Police as a responsible authority.

### 4. Compliance Issues:

#### 4.1 Consistency with relevant Council Policies, Plans or Strategies:

The report complies with the City Council's Statement of Licensing Policy and the Council's Corporate Plan to improve the standard of all licensed persons, premises and vehicles in the City.

<p><b>5. Relevant background/chronology of key events:</b></p> <p>Mohammed Shahnawaz applied on 6<sup>th</sup> July 2020 for the grant of a Premises Licence for Circle Fish Bar, 9 Kettlehouse Road, Kingstanding, Birmingham, B44 9JH.</p> <p>A representation has been received from West Midlands Police as a responsible authority. See Appendix 1.</p> <p>The application is attached at Appendix 2.</p> <p>Site Location Plans at Appendix 3.</p> <p>When carrying out its licensing functions, a licensing authority must have regard to Birmingham City Council's Statement of Licensing Policy and the Guidance issued by the Secretary of State under s182 of the Licensing Act 2003. The Licensing Authority is also required to take such steps as it considers appropriate for the promotion of the licensing objectives, which are:-</p> <ul style="list-style-type: none"> <li>a. The prevention of crime and disorder;</li> <li>b. Public safety;</li> <li>c. The prevention of public nuisance; and</li> <li>d. The protection of children from harm.</li> </ul>
<p><b>6. List of background documents:</b></p> <p>Copy of the representation as detailed in Appendix 1  Application Form, Appendix 2  Site Location Plans, Appendix 3</p>
<p><b>7. Options available</b></p> <p>To Grant the licence in accordance with the application.  To Reject the application.  To Grant the licence subject to conditions modified to such an extent as considered appropriate.  Exclude from the licence any of the licensable activities to which the application relates.  Refuse to specify a person in the licence as the premises supervisor.</p>

**From:** bw licensing  
**Sent:** 03 August 2020 15:31  
**To:** Licensing Online  
**Subject:** RE: [External]: GRANT-CIRCLE FISH BAR, 9 KETTLEHOUSE ROAD, BIRMINGHAM, B44 9JH

THE CIRCLE FISH BAR. 9 KETTLEHOUSE ROAD, KINGSTANDING, BIRMINGHAM. B44 9JH.  
APPLICATION FOR PREMISES LICENSE.

Good Afternoon Licensing,

With reference to the above application this is an application made by a fish bar wishing to trade from the shop selling food till midnight Sunday to Thursday and till 0200 on Friday and Saturday. The business is also wishes to commence an on line delivery service from Monday till Sunday between the times of 1200 hours and 0400 hours.

The control of alcohol is difficult to maintain. This is particularly true in a situation where the order takes place online and therefore there is no face to face contact between vendor and purchaser at the time of the order. The only physical contact takes place at the point of delivery and this can be both short and uninformative. This contact is further devalued when it takes place later in the night due to adverse lighting conditions.

The lateness of the time that the applicant seeks for this application means that the problems above are an issue with this application. There is an increased potential for persons already under the influence of drink being served further alcohol and due to identities being more difficult to establish that vulnerable persons will obtain alcohol.

I have attempted to resolve this issue by agreeing a time with the applicant that would nullify these issues. This has not been possible to achieve. I would therefore wish to object to the application on the grounds that the licensing objectives are not being promoted in particular:

- (1) The prevention of crime and disorder,
- (2) The protection of children from harm.

THANK-YOU,

Mark Swallow.

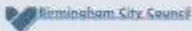
**Birmingham**  
**Application for a premises licence**  
**Licensing Act 2003**

For help contact  
[licensingonline@birmingham.gov.uk](mailto:licensingonline@birmingham.gov.uk)  
Telephone: 0121 303 9896

\* required information

**Form errors**

Some data entered into this form is invalid. Please resolve before continuing.

**Section 1 of 21**

You can save the form at any time and resume it later. You do not need to be logged in when you resume.

System reference

Not Currently In Use

This is the unique reference for this application generated by the system.

Your reference

You can put what you want here to help you track applications if you make lots of them. It is passed to the authority.

Are you an agent acting on behalf of the applicant?

☒ Yes ☐ No

Put "no" if you are applying on your own behalf or on behalf of a business you own or work for.

**Applicant Details**

\* First name

Mohammed

\* Family name

Shahnawaz

\* E-mail

Main telephone number

Include country code.

Other telephone number

☐ Indicate here if the applicant would prefer not to be contacted by telephone

Is the applicant:

☐ Applying as a business or organisation, including as a sole trader

☒ Applying as an individual

A sole trader is a business owned by one person without any special legal structure. Applying as an individual means the applicant is applying so the applicant can be employed, or for some other personal reason, such as following a hobby.

4

Continued from previous page...

### Address

* Building number or name	<input type="text" value=""/>
* Street	<input type="text" value=""/>
District	<input type="text" value=""/>
* City or town	<input type="text" value=""/>
County or administrative area	<input type="text" value=""/>
* Postcode	<input type="text" value=""/>
* Country	<input type="text" value=""/>

### Agent Details

* First name	<input type="text" value="Patrick"/>	
* Family name	<input type="text" value="Burke"/>	
* E-mail	<input type="text" value=""/>	
Main telephone number	<input type="text" value=""/>	Include country code.
Other telephone number	<input type="text" value=""/>	

☐ Indicate here if you would prefer not to be contacted by telephone

Are you:

- ☒ An agent that is a business or organisation, including a sole trader  
☐ A private individual acting as an agent

A sole trader is a business owned by one person without any special legal structure.

### Agent Business

Is your business registered in the UK with Companies House? ☐ Yes ☒ No

Note: completing the Applicant Business section is optional in this form.

Is your business registered outside the UK? ☐ Yes ☒ No

Business name	<input type="text" value="PMB Licensing"/>	If your business is registered, use its registered name.
VAT number	<input type="text" value="-"/>	Put "none" if you are not registered for VAT.
Legal status	<input type="text" value="Sole Trader"/>	
Your position in the business	<input type="text" value="Proprietor"/>	
Home country	<input type="text" value="United Kingdom"/>	The country where the headquarters of your business is located.



Continued from previous page...

**Agent Business Address**

If you have one, this should be your official address - that is an address required of you by law for receiving communications.

Building number or name	<input type="text" value="The Clock House"/>
Street	<input type="text" value="361 High St"/>
District	<input type="text"/>
City or town	<input type="text" value="West Bromwich"/>
County or administrative area	<input type="text"/>
Postcode	<input type="text" value="B70 9QL"/>
Country	<input type="text" value="United Kingdom"/>

**Section 2 of 21**

**PREMISES DETAILS**

I/we, as named in section 1, apply for a premises licence under section 17 of the Licensing Act 2003 for the premises described in section 2 below (the premises) and I/we are making this application to you as the relevant licensing authority in accordance with section 12 of the Licensing Act 2003.

**Premises Address**

Are you able to provide a postal address, OS map reference or description of the premises?

☒ Address    ☐ OS map reference    ☐ Description

**Postal Address Of Premises**

Building number or name	<input type="text" value="Circle Fish Bar"/>
Street	<input type="text" value="9 Kettlehouse Rd"/>
District	<input type="text"/>
City or town	<input type="text" value="Birmingham"/>
County or administrative area	<input type="text"/>
Postcode	<input type="text" value="B44 9JH"/>
Country	<input type="text" value="United Kingdom"/>

**Further Details**

Telephone number	<input type="text"/>
Non-domestic rateable value of premises (£)	<input type="text" value="5,000"/>

### Section 3 of 21

#### APPLICATION DETAILS

In what capacity are you applying for the premises licence?

- ☒ An individual or individuals
- ☐ A limited company / limited liability partnership
- ☐ A partnership (other than limited liability)
- ☐ An unincorporated association
- ☐ Other (for example a statutory corporation)
- ☐ A recognised club
- ☐ A charity
- ☐ The proprietor of an educational establishment
- ☐ A health service body
- ☐ A person who is registered under part 2 of the Care Standards Act 2000 (c14) in respect of an independent hospital in Wales
- ☐ A person who is registered under Chapter 2 of Part 1 of the Health and Social Care Act 2008 in respect of the carrying on of a regulated activity (within the meaning of that Part) in an independent hospital in England
- ☐ The chief officer of police of a police force in England and Wales

#### Confirm The Following

- ☒ I am carrying on or proposing to carry on a business which involves the use of the premises for licensable activities
- ☐ I am making the application pursuant to a statutory function
- ☐ I am making the application pursuant to a function discharged by virtue of Her Majesty's prerogative

### Section 4 of 21

#### INDIVIDUAL APPLICANT DETAILS

##### Applicant Name

Is the name the same as (or similar to) the details given in section one?

☒ Yes

☐ No

If "Yes" is selected you can re-use the details from section one, or amend them as required. Select "No" to enter a completely new set of details.

First name

Mohammed

Family name

Shahnawaz

Is the applicant 18 years of age or older?

☒ Yes

☐ No

Continued from previous page...

### Current Residential Address

Is the address the same as (or similar to) the address given in section one?

☒ Yes

☐ No

If "Yes" is selected you can re-use the details from section one, or amend them as required. Select "No" to enter a completely new set of details.

Building number or name	<input type="text"/>
Street	<input type="text"/>
District	<input type="text"/>
City or town	<input type="text"/>
County or administrative area	<input type="text"/>
Postcode	<input type="text"/>
Country	<input type="text"/>

### Applicant Contact Details

Are the contact details the same as (or similar to) those given in section one?

☒ Yes

☐ No

If "Yes" is selected you can re-use the details from section one, or amend them as required. Select "No" to enter a completely new set of details.

E-mail	<input type="text"/>
Telephone number	<input type="text"/>
Other telephone number	<input type="text"/>
* Date of birth	<input type="text"/>
	dd mm yyyy
* Nationality	<input type="text"/>

Documents that demonstrate entitlement to work in the UK

Add another applicant

### Section 5 of 21

#### OPERATING SCHEDULE

When do you want the premises licence to start?  03 /  08 /  2020  
dd mm yyyy

If you wish the licence to be valid only for a limited period, when do you want it to end  /  /   
dd mm yyyy

Provide a general description of the premises

For example the type of premises, its general situation and layout and any other information which could be relevant to the licensing objectives. Where your application includes off-supplies of alcohol and you intend to provide a place for consumption of these off-supplies you must include a description of where the place will be and its proximity to the premises.

This is a Chip shop we which to sell alcohol for delivery with food orders on line and for late night refreshment



Continued from previous page...

--

If 5,000 or more people are expected to attend the premises at any one time, state the number expected to attend

--

**Section 6 of 21**

**PROVISION OF PLAYS**

See guidance on regulated entertainment

Will you be providing plays?

☐ Yes

☒ No

**Section 7 of 21**

**PROVISION OF FILMS**

See guidance on regulated entertainment

Will you be providing films?

☐ Yes

☒ No

**Section 8 of 21**

**PROVISION OF INDOOR SPORTING EVENTS**

See guidance on regulated entertainment

Will you be providing indoor sporting events?

☐ Yes

☒ No

**Section 9 of 21**

**PROVISION OF BOXING OR WRESTLING ENTERTAINMENTS**

See guidance on regulated entertainment

Will you be providing boxing or wrestling entertainments?

☐ Yes

☒ No

**Section 10 of 21**

**PROVISION OF LIVE MUSIC**

See guidance on regulated entertainment

Will you be providing live music?

☐ Yes

☒ No

**Section 11 of 21**

**PROVISION OF RECORDED MUSIC**

See guidance on regulated entertainment

Will you be providing recorded music?

☐ Yes

☒ No

**Section 12 of 21**

**PROVISION OF PERFORMANCES OF DANCE**

Continued from previous page...

[See guidance on regulated entertainment](#)

Will you be providing performances of dance?

☐ Yes

☒ No

#### Section 13 of 21

#### PROVISION OF ANYTHING OF A SIMILAR DESCRIPTION TO LIVE MUSIC, RECORDED MUSIC OR PERFORMANCES OF DANCE

[See guidance on regulated entertainment](#)

Will you be providing anything similar to live music, recorded music or performances of dance?

☐ Yes

☒ No

#### Section 14 of 21

#### LATE NIGHT REFRESHMENT

Will you be providing late night refreshment?

☒ Yes

☐ No

#### Standard Days And Timings

MONDAY

Start

End

Start

End

Give timings in 24 hour clock.  
(e.g., 16:00) and only give details for the days  
of the week when you intend the premises  
to be used for the activity.

TUESDAY

Start

End

Start

End

WEDNESDAY

Start

End

Start

End

THURSDAY

Start

End

Start

End

FRIDAY

Start

End

Start

End

SATURDAY

Start

End

Start

End

Continued from previous page...

SUNDAY

Start 23:00

End 04:00

Start

End

Will the provision of late night refreshment take place indoors or outdoors or both?

☐ Indoors ☒ Outdoors ☐ Both

Where taking place in a building or other structure tick as appropriate. Indoors may include a tent.

State type of activity to be authorised, if not already stated, and give relevant further details, for example (but not exclusively) whether or not music will be amplified or unamplified.

This is a traditional Fish and Chip shop we wish to sell hot food for takeaway or delivery until 00:00 Sun - Thurs and until 02:00 Friday and Saturday with an online delivery only service available until 04:00 Monday - Sunday

State any seasonal variations

For example (but not exclusively) where the activity will occur on additional days during the summer months.

Non-standard timings. Where the premises will be used for the supply of late night refreshments at different times from those listed in the column on the left, list below

For example (but not exclusively), where you wish the activity to go on longer on a particular day e.g. Christmas Eve.

## Section 15 of 21

### SUPPLY OF ALCOHOL

Will you be selling or supplying alcohol?

☒ Yes ☐ No

#### Standard Days And Timings

MONDAY

Start 12:00

End 04:00

Start

End

Give timings in 24 hour clock.  
(e.g., 16:00) and only give details for the days  
of the week when you intend the premises  
to be used for the activity.



Continued from previous page...

TUESDAY

Start 12:00

End 04:00

Start

End

WEDNESDAY

Start 12:00

End 04:00

Start

End

THURSDAY

Start 12:00

End 04:00

Start

End

FRIDAY

Start 12:00

End 04:00

Start

End

SATURDAY

Start 12:00

End 04:00

Start

End

SUNDAY

Start 12:00

End 04:00

Start

End

Will the sale of alcohol be for consumption:

- ☐ On the premises ☒ Off the premises ☐ Both

If the sale of alcohol is for consumption on the premises select on, if the sale of alcohol is for consumption away from the premises select off. If the sale of alcohol is for consumption on the premises and away from the premises select both.

State any seasonal variations

For example (but not exclusively) where the activity will occur on additional days during the summer months.

we wish to sell Alcohol with hot food on line delivery only service available until 04:00 Monday - Sunday

Non-standard timings. Where the premises will be used for the supply of alcohol at different times from those listed in the column on the left, list below

For example (but not exclusively), where you wish the activity to go on longer on a particular day e.g. Christmas Eve.

none



Continued from previous page...

State the name and details of the individual whom you wish to specify on the licence as premises supervisor

**Name**

First name

Family name

Date of birth

**Enter the contact's address**

Building number or name

Street

District

City or town

County or administrative area

Postcode

Country

Personal Licence number (if known)

Issuing licensing authority (if known)

**PROPOSED DESIGNATED PREMISES SUPERVISOR CONSENT**

How will the consent form of the proposed designated premises supervisor be supplied to the authority?

- ☐ Electronically, by the proposed designated premises supervisor
- ☒ As an attachment to this application

Reference number for consent form (if known)

If the consent form is already submitted, ask the proposed designated premises supervisor for its 'system reference' or 'your reference'.

**Section 16 of 21**

**ADULT ENTERTAINMENT**

Highlight any adult entertainment or services, activities, or other entertainment or matters ancillary to the use of the premises that may give rise to concern in respect of children

Give information about anything intended to occur at the premises or ancillary to the use of the premises which may give rise to concern in respect of children, regardless of whether you intend children to have access to the premises, for example (but not exclusively) nudity or semi-nudity, films for restricted age groups etc gambling machines etc.

Continued from previous page...

Section 17 of 21

HOURS PREMISES ARE OPEN TO THE PUBLIC

Standard Days And Timings

MONDAY

Start 12:00

End 00:00

Start

End

Give timings in 24 hour clock.  
(e.g., 16:00) and only give details for the days  
of the week when you intend the premises  
to be used for the activity.

TUESDAY

Start 12:00

End 00:00

Start

End

WEDNESDAY

Start 12:00

End 00:00

Start

End

THURSDAY

Start 12:00

End 00:00

Start

End

FRIDAY

Start 12:00

End 02:00

Start

End

SATURDAY

Start 12:00

End 02:00

Start

End

SUNDAY

Start 12:00

End 00:00

Start

End

State any seasonal variations

For example (but not exclusively) where the activity will occur on additional days during the summer months.

None



*Continued from previous page...*

Non standard timings. Where you intend to use the premises to be open to the members and guests at different times from those listed in the column on the left, list below

For example (but not exclusively), where you wish the activity to go on longer on a particular day e.g. Christmas Eve.

None

## Section 18 of 21

### LICENSING OBJECTIVES

Describe the steps you intend to take to promote the four licensing objectives:

a) General – all four licensing objectives (b,c,d,e)

List here steps you will take to promote all four licensing objectives together.

Alcohol will only be sold with on line food orders  
Deliveries of Alcohol will be made by direct employees only  
Where alcohol sales take place, the delivery driver must ensure that the recipient of the order is the same as the person who authorised the sale and purchased the food. No deliveries of alcohol will be made to persons under 18.  
No alcohol will be delivered to any customer who is intoxicated.  
• Drivers will ask the recipient of an order to produce their acceptable ID on delivery.  
• Acceptable ID will be either a valid passport, photo card driving licence or recognised proof of age  
Drivers delivering alcohol will be fitted with body cams and the recordings kept for 28 days

No alcohol or tobacco will ever be purchased from sellers calling at the premise. Exceptions to the condition would be purchases made from authorised representatives who have made prior appointments to visit the store.  
☒ All alcohol and tobacco products sold at the premises shall have the relevant UK duty paid.  
☒ Foreign tobacco, which does not comply with relevant UK legislation, shall not be stored and/or sold at the premise.  
☒ Invoices, or copies of invoices, for all alcohol and tobacco purchases for the sale at the premises, will be retained and kept at the premises, and made available to officers from ALL RA UPON REQUEST  
☒ If any tobacco products purchased for or on behalf of the business does not have UK Duty Paid fiscal mark or are otherwise suspicious, the licensee and/or designated premises supervisor shall notify the supplier to Birmingham City Council Trading Standards and HMRC as soon as possible.

Protecting Children from Harm  
All persons involved in the sale of alcohol, who are not personal licence holders, will receive initial and subsequent 6 monthly refresher training by the Designated Premises Supervisor or an appropriately accredited training provider with regards to the law in relation to the sale of alcohol. This will be recorded in a staff training register and will include, signature of the member of staff, the DPS or an appropriately accredited training provider together with the date. TRAINING RECORDS WILL BE MAINTAINED AT THE PREMISES AND MADE AVAILABLE TO ALL RESPONSIBLE AUTHORITIES ON REQUEST

b) The prevention of crime and disorder

1. The CCTV system must be installed and operate internally to cover all areas that licensable activities take place and where alcohol is displayed within any public area.
2. The CCTV unit shall be positioned in a secure part of the licensed premise. Access to the system should be allowed immediately to ALL RESPONSIBLE AUTHORITIES upon request.
3. A competent trained person in the use of and operation of the CCTV will be in attendance at the premises at all times that licensable activities take place and be able to fully operate the CCTV system to be able to down load in a recognised format any information requested ALL RESPONSIBLE AUTHORITIES
4. The CCTV system clock should be set correctly and maintained (taking account of GMT and BST).
5. A facility will be available for the Police to remove from the CCTV system a copy of any material relevant to any ongoing Police investigation.



Continued from previous page...

6. All CCTV images will be retained for a period of not less than 31 day
  7. An incident register of all occurrences and ejections from the premises will be maintained at the premises and all details of public order offences will be recorded and MADE AVAILABLE TO ALL RESPONSIBLE AUTHORITIES ON REQUEST
  9. At any time when there is no Personal License holder on the premises there must be at least one member of staff on duty inside the premise who has been authorised by the DPS. Any such person should have seen, read and be fully aware of the conditions of the premise licence and take all steps to ensure that such conditions are adhered to whilst they have responsibility for the premise.
  10. A record should be kept detailing, the name and address relative to the person left in charge of the premise and the times and dates when the authority to cover exists, in writing.
  11. These should be individual entries covering short periods of time only and should not exceed more than a three week period.
  12. The authorised person should also sign on each occasion that he/she has physically seen inspected and is fully aware of all the conditions attached to the premise licence. The DPS should sign to acknowledge that they agree to the authorised person being in charge of the premise for any times specified. The records of these matters should be kept fully updated at all times.
- All Records shall be retained at the premises for a period of no less than 12 months and made available to responsible authorities on request.

c) Public safety

PROMINENT SIGNS WILL BE DISPLAYED REQUESTING CUSTOMERS TO HAVE REGARD FOR LOCAL RESIDENTS WHEN LEAVING THE PREMISES  
ADEQUATE BINS ARE AVAILABLE FOR CUSTOMERS TO DISPOSE OF LITTER

d) The prevention of public nuisance

A risk assessment will be carried out and updated on an annual basis

e) The protection of children from harm

- ☒ A Challenge 25 policy will be adopted in order to reduce the potential for underage sales of age restricted products including alcohol. If a customer appears to be under 25 years of age and cannot prove that they are eligible to purchase the age restricted item with a valid UK or Ireland Photocard Driving Licence, a valid Passport or PASS accredited proof of age scheme card, they will be refused service.
- ☒ Challenge 25 posters will be displayed at the premises to reinforce this policy. Posters will be placed at; each till, each area alcohol is stocked and at the point of entry into the store. The posters will be displayed prominently and in sight of customers and staff.
- ☒ A Refusals Register is to be used to record all incidents when a sale is refused. The register is to be kept in the store at all times unless it is requested by authorised officers of responsible authorities. The Refusal/Challenge Register is to be checked and signed off by the Designated Premises Supervisor every two weeks.
- ☒ All staff, WHO ARE NOT PERSONAL LICENSE HOLDERS, working at the premises involved in the sale of age restricted products including alcohol will receive on-going training and will be refreshed at least every 6 months. This will be recorded in a staff training register and will also include a written test of knowledge. The Training records must be made available to



Continued from previous page...

authorised officers of responsible authorities on request. Records shall be retained at the premises.

#### Section 19 of 21

#### NOTES ON DEMONSTRATING ENTITLEMENT TO WORK IN THE UK

##### Entitlement to work/immigration status for individual applicants and applications from partnerships which are not limited liability partnerships:

A licence may not be held by an individual or an individual in a partnership who is resident in the UK who:

- does not have the right to live and work in the UK; or
- is subject to a condition preventing him or her from doing work relating to the carrying on of a licensable activity.

Any premises licence issued in respect of an application made on or after 6 April 2017 will become invalid if the holder ceases to be entitled to work in the UK.

Applicants must demonstrate that they have an entitlement to work in the UK and are not subject to a condition preventing them from doing work relating to the carrying on of a licensable activity. They do this by providing with this application copies or scanned copies of the following documents (which do not need to be certified).

##### Documents which demonstrate entitlement to work in the UK

- An expired or current passport showing the holder, or a person named in the passport as the child of the holder, is a British citizen or a citizen of the UK and Colonies having the right of abode in the UK [please see note below about which sections of the passport to copy].
- An expired or current passport or national identity card showing the holder, or a person named in the passport as the child of the holder, is a national of a European Economic Area country or Switzerland.
- A Registration Certificate or document certifying permanent residence issued by the Home Office to a national of a European Economic Area country or Switzerland.
- A Permanent Residence Card issued by the Home Office to the family member of a national of a European Economic Area country or Switzerland.
- A **current** Biometric Immigration Document (Biometric Residence Permit) issued by the Home Office to the holder indicating that the person named is allowed to stay indefinitely in the UK, or has no time limit on their stay in the UK.
- A **current** passport endorsed to show that the holder is exempt from immigration control, is allowed to stay indefinitely in the UK, has the right of abode in the UK, or has no time limit on their stay in the UK.
- A **current** Immigration Status Document issued by the Home Office to the holder with an endorsement indicating that the named person is allowed to stay indefinitely in the UK or has no time limit on their stay in the UK, **when produced in combination with** an official document giving the person's permanent National Insurance number and their name issued by a Government agency or a previous employer.
- A **full** birth or adoption certificate issued in the UK which includes the name(s) of at least one of the holder's parents or adoptive parents, **when produced in combination with** an official document giving the person's permanent National Insurance number and their name issued by a Government agency or a previous employer.
- A birth or adoption certificate issued in the Channel Islands, the Isle of Man or Ireland **when produced in combination with** an official document giving the person's permanent National Insurance number and their name issued by a Government agency or a previous employer.
- A certificate of registration or naturalisation as a British citizen, **when produced in combination with** an official document giving the person's permanent National Insurance number and their name issued by a Government agency or a previous employer.
- A **current** passport endorsed to show that the holder is allowed to stay in the UK and is currently allowed to work and is not subject to a condition preventing the holder from doing work relating to the carrying on of a licensable activity.



*Continued from previous page...*

- A **current** Biometric Immigration Document (Biometric Residence Permit) issued by the Home Office to the holder which indicates that the named person can currently stay in the UK and is allowed to work relation to the carrying on of a licensable activity.
- A **current** Residence Card issued by the Home Office to a person who is not a national of a European Economic Area state or Switzerland but who is a family member of such a national or who has derivative rights or residence.
- A **current** Immigration Status Document containing a photograph issued by the Home Office to the holder with an endorsement indicating that the named person may stay in the UK, and is allowed to work and is not subject to a condition preventing the holder from doing work relating to the carrying on of a licensable activity **when produced in combination with** an official document giving the person's permanent National Insurance number and their name issued by a Government agency or a previous employer.
- A Certificate of Application, **less than 6 months old**, issued by the Home Office under regulation 17(3) or 18A (2) of the Immigration (European Economic Area) Regulations 2006, to a person who is not a national of a European Economic Area state or Switzerland but who is a family member of such a national or who has derivative rights of residence.
- Reasonable evidence that the person has an outstanding application to vary their permission to be in the UK with the Home Office such as the Home Office acknowledgement letter or proof of postage evidence, or reasonable evidence that the person has an appeal or administrative review pending on an immigration decision, such as an appeal or administrative review reference number.
- Reasonable evidence that a person who is not a national of a European Economic Area state or Switzerland but who is a family member of such a national or who has derivative rights of residence in exercising treaty rights in the UK including:-
  - evidence of the applicant's own identity – such as a passport,
  - evidence of their relationship with the European Economic Area family member – e.g. a marriage certificate, civil partnership certificate or birth certificate, and
  - evidence that the European Economic Area national has a right of permanent residence in the UK or is one of the following if they have been in the UK for more than 3 months:
    - (i) working e.g. employment contract, wage slips, letter from the employer,
    - (ii) self-employed e.g. contracts, invoices, or audited accounts with a bank,
    - (iii) studying e.g. letter from the school, college or university and evidence of sufficient funds; or
    - (iv) self-sufficient e.g. bank statements.

Family members of European Economic Area nationals who are studying or financially independent must also provide evidence that the European Economic Area national and any family members hold comprehensive sickness insurance in the UK. This can include a private medical insurance policy, an EHIC card or an S1, S2 or S3 form.

**Original documents must not be sent to licensing authorities.** If the document copied is a passport, a copy of the following pages should be provided:-

- (i) any page containing the holder's personal details including nationality;
- (ii) any page containing the holder's photograph;
- (iii) any page containing the holder's signature;
- (iv) any page containing the date of expiry; and
- (v) any page containing information indicating the holder has permission to enter or remain in the UK and is permitted to work.

If the document is not a passport, a copy of the whole document should be provided.

Your right to work will be checked as part of your licensing application and this could involve us checking your immigration status with the Home Office. We may otherwise share information with the Home Office. Your licence application will not be determined until you have complied with this guidance.

---

#### **Section 20 of 21**

---

#### **NOTES ON REGULATED ENTERTAINMENT**

---



*Continued from previous page...*

In terms of specific **regulated entertainments** please note that:

- Plays: no licence is required for performances between 08:00 and 23:00 on any day, provided that the audience does not exceed 500.
- Films: no licence is required for 'not-for-profit' film exhibition held in community premises between 08:00 and 23:00 on any day provided that the audience does not exceed 500 and the organiser (a) gets consent to the screening from a person who is responsible for the premises; and (b) ensures that each such screening abides by age classification ratings.
- Indoor sporting events: no licence is required for performances between 08:00 and 23:00 on any day, provided that the audience does not exceed 1000.
- Boxing or Wrestling Entertainment: no licence is required for a contest, exhibition or display of Greco-Roman wrestling, or freestyle wrestling between 08:00 and 23:00 on any day, provided that the audience does not exceed 1000. Combined fighting sports – defined as a contest, exhibition or display which combines boxing or wrestling with one or more martial arts – are licensable as a boxing or wrestling entertainment rather than an indoor sporting event.
- Live music: no licence permission is required for:
  - o a performance of unamplified live music between 08:00 and 23:00 on any day, on any premises.
  - o a performance of amplified live music between 08:00 and 23:00 on any day on premises authorised to sell alcohol for consumption on those premises, provided that the audience does not exceed 500.
  - o a performance of amplified live music between 08:00 and 23:00 on any day, in a workplace that is not licensed to sell alcohol on those premises, provided that the audience does not exceed 500.
  - o a performance of amplified live music between 08:00 and 23:00 on any day, in a church hall, village hall, community hall, or other similar community premises, that is not licensed by a premises licence to sell alcohol, provided that (a) the audience does not exceed 500, and (b) the organiser gets consent for the performance from a person who is responsible for the premises.
  - o a performance of amplified live music between 08:00 and 23:00 on any day, at the non-residential premises of (i) a local authority, or (ii) a school, or (iii) a hospital, provided that (a) the audience does not exceed 500, and (b) the organiser gets consent for the performance on the relevant premises from: (i) the local authority concerned, or (ii) the school or (iii) the health care provider for the hospital.
- Recorded Music: no licence permission is required for:
  - o any playing of recorded music between 08:00 and 23:00 on any day on premises authorised to sell alcohol for consumption on those premises, provided that the audience does not exceed 500.
  - o any playing of recorded music between 08:00 and 23:00 on any day, in a church hall, village hall, community hall, or other similar community premises, that is not licensed by a premises licence to sell alcohol, provided that (a) the audience does not exceed 500, and (b) the organiser gets consent for the performance from a person who is responsible for the premises.
  - o any playing of recorded music between 08:00 and 23:00 on any day, at the non-residential premises of (i) a local authority, or (ii) a school, or (iii) a hospital, provided that (a) the audience does not exceed 500, and (b) the organiser gets consent for the performance on the relevant premises from: (i) the local authority concerned, or (ii) the school proprietor or (iii) the health care provider for the hospital.

Continued from previous page...

**Address**

Building number or name	<input type="text"/>
Street	<input type="text"/>
District	<input type="text"/>
City or town	<input type="text"/>
County or administrative area	<input type="text"/>
Postcode	<input type="text"/>
Country	<input type="text" value="United Kingdom"/>

**DECLARATION**

[APPLICABLE TO INDIVIDUAL APPLICANTS ONLY, INCLUDING THOSE IN A PARTNERSHIP WHICH IS NOT A LIMITED LIABILITY PARTNERSHIP] I UNDERSTAND I AM NOT ENTITLED TO BE ISSUED WITH A LICENCE IF I DO NOT HAVE THE  
\* ENTITLEMENT TO LIVE AND WORK IN THE UK (OR IF I AM SUBJECT TO A CONDITION PREVENTING ME FROM DOING WORK RELATING TO THE CARRYING ON OF A LICENSABLE ACTIVITY) AND THAT MY LICENCE WILL BECOME INVALID IF I CEASE TO BE ENTITLED TO LIVE AND WORK IN THE UK (PLEASE READ GUIDANCE NOTE 15).

**You must check the box for this declaration**

THE DPS NAMED IN THIS APPLICATION FORM IS ENTITLED TO WORK IN THE UK (AND IS NOT SUBJECT TO CONDITIONS  
\* PREVENTING HIM OR HER FROM DOING WORK RELATING TO A LICENSABLE ACTIVITY) AND I HAVE SEEN A COPY OF HIS OR HER PROOF OF ENTITLEMENT TO WORK, IF APPROPRIATE (PLEASE SEE NOTE 15).

**You must check the box for this declaration**

☒ Ticking this box indicates you have read and understood the above declaration

This section should be completed by the applicant, unless you answered "Yes" to the question "Are you an agent acting on behalf of the applicant?"

* Full name	<input type="text" value="REDACTED"/>
* Capacity	<input type="text" value="AGENT FOR THE APPLICANT"/>
Date (dd/mm/yyyy)	<input type="text" value="06-07-20"/>

Once you're finished you need to do the following:

1. Save this form to your computer by clicking file/save as...
2. Go back to <https://www.gov.uk/apply-for-a-licence/premises-licence/birmingham/apply-1> to upload this file and continue with your application.

Don't forget to make sure you have all your supporting documentation to hand.



*Continued from previous page...*

IT IS AN OFFENCE LIABLE TO SUMMARY CONVICTION TO A FINE OF ANY AMOUNT UNDER SECTION 158 OF THE LICENSING ACT 2003, TO MAKE A FALSE STATEMENT IN OR IN CONNECTION WITH THIS APPLICATION

IT IS AN OFFENCE UNDER SECTION 24B OF THE IMMIGRATION ACT 1971 FOR A PERSON TO WORK WHEN THEY KNOW, OR HAVE REASONABLE CAUSE TO BELIEVE, THAT THEY ARE DISQUALIFIED FROM DOING SO BY REASON OF THEIR IMMIGRATION STATUS. THOSE WHO EMPLOY AN ADULT WITHOUT LEAVE OR WHO IS SUBJECT TO CONDITIONS AS TO EMPLOYMENT WILL BE LIABLE TO A CIVIL PENALTY UNDER SECTION 15 OF THE IMMIGRATION, ASYLUM AND NATIONALITY ACT 2006 AND PURSUANT TO SECTION 21 OF THE SAME ACT, WILL BE COMMITTING AN OFFENCE WHERE THEY DO SO IN THE KNOWLEDGE, OR WITH REASONABLE CAUSE TO BELIEVE, THAT THE EMPLOYEE IS DISQUALIFIED

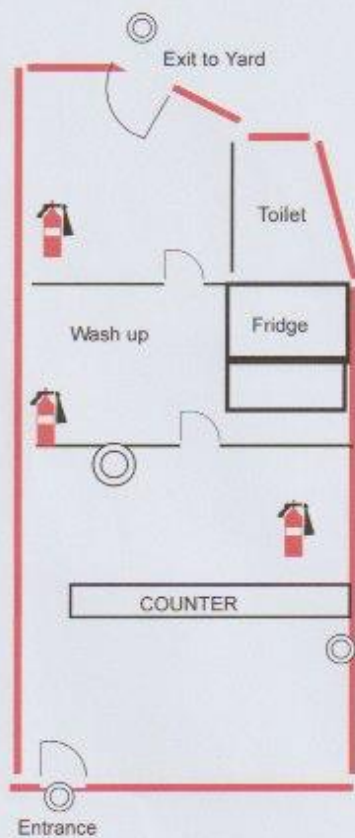

Licensing Plan  
 Circle Fish Bar  
 9 Kettle house Rd  
 Birmingham  
 B44 9JH

Scale 1:100

Licensable Activities 

Fire Extinguisher 

CCTV 