

BIRMINGHAM CITY COUNCIL

PUBLIC REPORT

Report to:	Licensing Sub Committee A
Report of:	Acting Director of Regulation & Enforcement
Date of Meeting:	Monday 25th June 2018
Subject:	Licensing Act 2003 Premises Licence – Grant
Premises:	Royal City Takeaway, 103 Blandford Road, Quinton, Birmingham, B32 2LT
Ward affected:	Harborne
Contact Officer:	Bhapinder Nandhra, Senior Licensing Officer, 0121 303 9896, licensing@birmingham.gov.uk

1. Purpose of report:

To consider a relevant representation that has been made in respect of an application for a Premises Licence which seeks to permit the Sale of Alcohol (for consumption both on and off the premises) to operate from 5:00pm until 11:00pm (Monday to Sunday).

Premises to remain open to the public from 5:00pm until 11:00pm (Monday to Sunday).

2. Recommendation:

To consider the representation that has been made and to determine the application.

3. Brief Summary of Report:

An application for a Premises Licence was received on 27th April 2018, in respect of the Royal City Takeaway, 103 Blandford Road, Quinton, Birmingham, B32 2LT.

A representation has been received from other persons.

4. Compliance Issues:

4.1 Consistency with relevant Council Policies, Plans or Strategies:

The report complies with the City Council's Statement of Licensing Policy and the Council's Corporate Plan to improve the standard of all licensed persons, premises and vehicles in the City.

5. Relevant background/chronology of key events:

L & Y Chinese Takeaway Ltd applied on 27th April 2018 for the grant of a Premises Licence for the Royal City Takeaway, 103 Blandford Road, Quinton, Birmingham, B32 2LT.

A representation has been received from other persons. See Appendix 1.

The application is attached at Appendix 2.

Conditions have been agreed with West Midlands Police and the applicant, which are attached at Appendix 3.

Site Location Plans at Appendix 4.

When carrying out its licensing functions, a licensing authority must have regard to Birmingham City Council's Statement of Licensing Policy and the Guidance issued by the Secretary of State under s182 of the Licensing Act 2003. The Licensing Authority is also required to take such steps as it considers appropriate for the promotion of the licensing objectives, which are:-

- a. The prevention of crime and disorder;
- b. Public safety;
- c. The prevention of public nuisance; and
- d. The protection of children from harm.

6. List of background documents:

Copy of the representation as detailed in Appendix 1
Application Form, Appendix 2
Conditions agreed with West Midlands Police, Appendix 3
Site Location Plans, Appendix 4

7. Options available

To Grant the licence in accordance with the application.

To Reject the application.

To Grant the licence subject to conditions modified to such an extent as considered appropriate.

Exclude from the licence any of the licensable activities to which the application relates.

Refuse to specify a person in the licence as the premises supervisor.

Appendix 1

Entered
21

From:
Sent: 25 May 2018 21:03
To: Licensing
Subject: objection to on/ off licence

I am writing this e-mail as an objection to the proposal of an on/off licence to be given to 103 blandford road. L & y Chinese takeaway.

I'm shocked that we have not received and paperwork in the post or that the signage has been correctly displayed for all local residents to see.

There is already a problem with youths in the area. I live directly opposite the shop and we are plagued with young lads causing havoc. They originally began by hanging around the current off licence (hence why do we need a second one????) But the owners have banned all of the troublemakers and they never hang around the shop anymore.

What they do now is stand in or around the Chinese takeaway. How a proposal would ever be considered by yourselves is beyond me and if this licence is granted i will attend the next ward meeting to discuss the lack of information that we available to the local area to object to this application

Blandford Road.
B32

Appendix 2

 Birmingham Application for a premises licence Licensing Act 2003	For help contact licensingonline@birmingham.gov.uk Telephone: 0121 303 9896
---	--

* required information

Section 1 of 21

You can save the form at any time and resume it later. You do not need to be logged in when you resume.

System reference This is the unique reference for this application generated by the system.

Your reference You can put what you want here to help you track applications if you make lots of them. It is passed to the authority.

Are you an agent acting on behalf of the applicant?

☒ Yes ☐ No

Put "no" if you are applying on your own behalf or on behalf of a business you own or work for.

BCC
REGULATION & ENFORCEMENT
LICENSING SECTION
DATE RECEIVED

Applicant Details

* First name

* Family name

* E-mail

Main telephone number

Other telephone number

☐ Indicate here if the applicant would prefer not to be contacted by telephone

REF NO.

INITIALS

Include country code.

Is the applicant:

☒ Applying as a business or organisation, including as a sole trader

☐ Applying as an individual

A sole trader is a business owned by one person without any special legal structure. Applying as an individual means the applicant is applying so the applicant can be employed, or for some other personal reason, such as following a hobby.

Applicant Business

Is the applicant's business registered in the UK with Companies House? ☒ Yes ☐ No

Note: completing the Applicant Business section is optional in this form.

Registration number

Business name

If the applicant's business is registered, use its registered name.

VAT number

Put "none" if the applicant is not registered for VAT.

Legal status

Continued from previous page...

Applicant's position in the business

Home country

The country where the applicant's headquarters are.

Registered Address

Address registered with Companies House.

Building number or name

Street

District

City or town

County or administrative area

Postcode

Country

Agent Details

* First name

* Family name

* E-mail

Main telephone number

Include country code.

Other telephone number

☐ Indicate here if you would prefer not to be contacted by telephone

Are you:

☒ An agent that is a business or organisation, including a sole trader

A sole trader is a business owned by one person without any special legal structure.

☐ A private individual acting as an agent

Agent Business

Is your business registered in the UK with Companies House? ☒ Yes ☐ No

Note: completing the Applicant Business section is optional in this form.

Registration number

Business name

If your business is registered, use its registered name.

VAT number

Put "none" if you are not registered for VAT.

Legal status

Continued from previous page...

Your position in the business

Home country

The country where the headquarters of your business is located.

Agent Registered Address

Address registered with Companies House.

Building number or name

Street

District

City or town

County or administrative area

Postcode

Country

Section 2 of 21

PREMISES DETAILS

I/we, as named in section 1, apply for a premises licence under section 17 of the Licensing Act 2003 for the premises described in section 2 below (the premises) and I/we are making this application to you as the relevant licensing authority in accordance with section 12 of the Licensing Act 2003.

Premises Address

Are you able to provide a postal address, OS map reference or description of the premises?

☒ Address ☐ OS map reference ☐ Description

Postal Address Of Premises

Building number or name

Street

District

City or town

County or administrative area

Postcode

Country

Further Details

Telephone number

Non-domestic rateable value of premises (£)

Section 3 of 21	
APPLICATION DETAILS	
In what capacity are you applying for the premises licence?	
<input type="checkbox"/> An individual or individuals <input checked="" type="checkbox"/> A limited company / limited liability partnership <input type="checkbox"/> A partnership (other than limited liability) <input type="checkbox"/> An unincorporated association <input type="checkbox"/> Other (for example a statutory corporation) <input type="checkbox"/> A recognised club <input type="checkbox"/> A charity <input type="checkbox"/> The proprietor of an educational establishment <input type="checkbox"/> A health service body <input type="checkbox"/> A person who is registered under part 2 of the Care Standards Act 2000 (c14) in respect of an independent hospital in Wales <input type="checkbox"/> A person who is registered under Chapter 2 of Part 1 of the Health and Social Care Act 2008 in respect of the carrying on of a regulated activity (within the meaning of that Part) in an independent hospital in England <input type="checkbox"/> The chief officer of police of a police force in England and Wales	
Confirm The Following	
<input checked="" type="checkbox"/> I am carrying on or proposing to carry on a business which involves the use of the premises for licensable activities <input type="checkbox"/> I am making the application pursuant to a statutory function <input type="checkbox"/> I am making the application pursuant to a function discharged by virtue of Her Majesty's prerogative	
Section 4 of 21	
NON INDIVIDUAL APPLICANTS	
Provide name and registered address of applicant in full. Where appropriate give any registered number. In the case of a partnership or other joint venture (other than a body corporate), give the name and address of each party concerned.	
Non Individual Applicant's Name	
Name	L & Y CHINESE TAKEAWAY LTD
Details	
Registered number (where applicable)	11110215
Description of applicant (for example partnership, company, unincorporated association etc)	

Continued from previous page...

PRIVATE LIMITED COMPANY

Address

Building number or name
Street
District
City or town
County or administrative area
Postcode
Country

Contact Details

E-mail
Telephone number
Other telephone number
* Date of birth / /

* Nationality

Documents that demonstrate entitlement to work in the UK

Section 5 of 21

OPERATING SCHEDULE

When do you want the premises licence to start? / /
dd mm yyyy

If you wish the licence to be valid only for a limited period, when do you want it to end / /
dd mm yyyy

Provide a general description of the premises

For example the type of premises, its general situation and layout and any other information which could be relevant to the licensing objectives. Where your application includes off-supplies of alcohol and you intend to provide a place for consumption of these off- supplies you must include a description of where the place will be and its proximity to the premises.

The applicant currently operates a chinese takeaway from 103 Blandford Road.

The premises is situated in a row of retails shops beneath living accommodation.

The applicant is seeking to supply a small selection of oriental beers & wines from the premises to customers who purchase

<p>Continued from previous page...</p> <p>a meal, either by attending in person at the premises or by delivery service. Alcohol will not be on display to the public. A 'Challenge 25' policy will be in place at the premises, and to include when delivery is made to customers abode. Alcohol will not be visible to the public. Regular Training will be given to all staff with the responsibility of delivering alcohol . Training will incorporate the 'challenge 25' Policy. This training will be recorded.</p>
<p>If 5,000 or more people are expected to attend the premises at any one time, state the number expected to attend</p> <div style="border: 1px solid black; width: 100px; height: 20px; margin-left: 200px;"></div>
<p>Section 6 of 21</p>
<p>PROVISION OF PLAYS</p>
<p>See guidance on regulated entertainment</p> <p>Will you be providing plays?</p> <p><input type="radio"/> Yes <input checked="" type="radio"/> No</p>
<p>Section 7 of 21</p>
<p>PROVISION OF FILMS</p>
<p>See guidance on regulated entertainment</p> <p>Will you be providing films?</p> <p><input type="radio"/> Yes <input checked="" type="radio"/> No</p>
<p>Section 8 of 21</p>
<p>PROVISION OF INDOOR SPORTING EVENTS</p>
<p>See guidance on regulated entertainment</p> <p>Will you be providing indoor sporting events?</p> <p><input type="radio"/> Yes <input checked="" type="radio"/> No</p>
<p>Section 9 of 21</p>
<p>PROVISION OF BOXING OR WRESTLING ENTERTAINMENTS</p>
<p>See guidance on regulated entertainment</p> <p>Will you be providing boxing or wrestling entertainments?</p> <p><input type="radio"/> Yes <input checked="" type="radio"/> No</p>
<p>Section 10 of 21</p>
<p>PROVISION OF LIVE MUSIC</p>
<p>See guidance on regulated entertainment</p> <p>Will you be providing live music?</p> <p><input type="radio"/> Yes <input checked="" type="radio"/> No</p>
<p>Section 11 of 21</p>
<p>PROVISION OF RECORDED MUSIC</p>
<p>See guidance on regulated entertainment</p>

Continued from previous page...

Will you be providing recorded music?

☐ Yes

☒ No

Section 12 of 21

PROVISION OF PERFORMANCES OF DANCE

See guidance on regulated entertainment

Will you be providing performances of dance?

☐ Yes

☒ No

Section 13 of 21

PROVISION OF ANYTHING OF A SIMILAR DESCRIPTION TO LIVE MUSIC, RECORDED MUSIC OR PERFORMANCES OF DANCE

See guidance on regulated entertainment

Will you be providing anything similar to live music, recorded music or performances of dance?

☐ Yes

☒ No

Section 14 of 21

LATE NIGHT REFRESHMENT

Will you be providing late night refreshment?

☐ Yes

☒ No

Section 15 of 21

SUPPLY OF ALCOHOL

Will you be selling or supplying alcohol?

☒ Yes

☐ No

Standard Days And Timings

MONDAY

Start

End

Start

End

TUESDAY

Start

End

Start

End

WEDNESDAY

Start

End

Start

End

THURSDAY

Start

End

Start

End

Give timings in 24 hour clock.
(e.g., 16:00) and only give details for the days
of the week when you intend the premises
to be used for the activity.

Continued from previous page...

FRIDAY

Start 17:00

End 23:00

Start

End

SATURDAY

Start 17:00

End 23:00

Start

End

SUNDAY

Start 17:00

End 23:00

Start

End

Will the sale of alcohol be for consumption:

☐ On the premises ☐ Off the premises ☒ Both

If the sale of alcohol is for consumption on the premises select on, if the sale of alcohol is for consumption away from the premises select off. If the sale of alcohol is for consumption on the premises and away from the premises select both.

State any seasonal variations

For example (but not exclusively) where the activity will occur on additional days during the summer months.

--

Non-standard timings. Where the premises will be used for the supply of alcohol at different times from those listed in the column on the left, list below

For example (but not exclusively), where you wish the activity to go on longer on a particular day e.g. Christmas Eve.

--

State the name and details of the individual whom you wish to specify on the licence as premises supervisor

Name

First name

LAN

Family name

ZHANG

Date of birth

/ /
dd mm yyyy

Continued from previous page...

Enter the contact's address

Building number or name	<input type="text"/>
Street	<input type="text"/>
District	<input type="text"/>
City or town	<input type="text"/>
County or administrative area	<input type="text"/>
Postcode	<input type="text"/>
Country	<input type="text"/>
Personal Licence number (if known)	<input type="text"/>
Issuing licensing authority (if known)	<input type="text" value="BIRMINGHAM CITY COUNCIL"/>

PROPOSED DESIGNATED PREMISES SUPERVISOR CONSENT

How will the consent form of the proposed designated premises supervisor be supplied to the authority?

- ☐ Electronically, by the proposed designated premises supervisor
- ☒ As an attachment to this application

Reference number for consent form (if known)

If the consent form is already submitted, ask the proposed designated premises supervisor for its 'system reference' or 'your reference'.

Section 16 of 21

ADULT ENTERTAINMENT

Highlight any adult entertainment or services, activities, or other entertainment or matters ancillary to the use of the premises that may give rise to concern in respect of children

Give information about anything intended to occur at the premises or ancillary to the use of the premises which may give rise to concern in respect of children, regardless of whether you intend children to have access to the premises, for example (but not exclusively) nudity or semi-nudity, films for restricted age groups etc gambling machines etc.

NON

Section 17 of 21

HOURS PREMISES ARE OPEN TO THE PUBLIC

Standard Days And Timings

MONDAY

Start

End

Start

End

Give timings in 24 hour clock.
(e.g., 16:00) and only give details for the days
of the week when you intend the premises
to be used for the activity.

Continued from previous page...

TUESDAY

Start	<input type="text" value="17:00"/>	End	<input type="text" value="23:00"/>
Start	<input type="text"/>	End	<input type="text"/>

WEDNESDAY

Start	<input type="text" value="17:00"/>	End	<input type="text" value="23:00"/>
Start	<input type="text"/>	End	<input type="text"/>

THURSDAY

Start	<input type="text" value="17:00"/>	End	<input type="text" value="23:00"/>
Start	<input type="text"/>	End	<input type="text"/>

FRIDAY

Start	<input type="text" value="17:00"/>	End	<input type="text" value="23:00"/>
Start	<input type="text"/>	End	<input type="text"/>

SATURDAY

Start	<input type="text" value="17:00"/>	End	<input type="text" value="23:00"/>
Start	<input type="text"/>	End	<input type="text"/>

SUNDAY

Start	<input type="text" value="17:00"/>	End	<input type="text" value="23:00"/>
Start	<input type="text"/>	End	<input type="text"/>

State any seasonal variations

For example (but not exclusively) where the activity will occur on additional days during the summer months.

Non standard timings. Where you intend to use the premises to be open to the members and guests at different times from those listed in the column on the left, list below

For example (but not exclusively), where you wish the activity to go on longer on a particular day e.g. Christmas Eve.

Section 18 of 21

LICENSING OBJECTIVES

Describe the steps you intend to take to promote the four licensing objectives:

a) General – all four licensing objectives (b,c,d,e)

Continued from previous page...

List here steps you will take to promote all four licensing objectives together.

No adult entertainment or services, activities, other entertainment or matters ancillary to the use of the premises that may give rise to concern in respect of children.

The Premises License holder will ensure that there is a responsible member of the management team present on the premises at all times.

Management will ensure all staff receive adequate training on a regular basis, relating to the four licensing objectives, general licensing regulations/Conditions including Fire regulations.

A record of the training will be kept by the management

b) The prevention of crime and disorder

Management will ensure that CCTV is installed on the premises to the satisfaction of the West Midlands Police and will ensure that CCTV footage is available to any responsible authority upon request.

Customers will not be permitted to carry open bottles or glasses beyond the licensed area.

c) Public safety

Management will ensure that the external areas of the premises are monitored to prevent any anti-social behaviour, public nuisance and ensure litter caused by the premises is kept to a minimum.

A Health and Safety risk assessment is to be carried out regularly.

Electrics, gas services and any relevant equipment are to be checked and maintained in working order and tested annually.

d) The prevention of public nuisance

A zero tolerance policy towards drunken or anti-social behaviour is to be in operation on the premises at all times.

The License Holder is to provide responsible management at all times.

When necessary advice will be given to such patrons not to do anything which may cause annoyance or disturbance to local community.

e) The protection of children from harm

The premises will adopt the Challenge 25 Policy for anyone appearing under 25 years of age. This is to include at point of delivery if away from premises. Only three recognised forms of ID will be accepted: - photo card driving license; - passport, or; - pass card for over 18's. this will also be adopted when alcohol is ordered over the phone to be delivered to a customer. Photographic ID will be asked for at point of supply.

The license holder will ensure staff are provided with training on appropriate behaviour to protect children from harm.

Continued from previous page...

Section 19 of 21

NOTES ON DEMONSTRATING ENTITLEMENT TO WORK IN THE UK

Entitlement to work/immigration status for individual applicants and applications from partnerships which are not limited liability partnerships:

A licence may not be held by an individual or an individual in a partnership who is resident in the UK who:

- does not have the right to live and work in the UK; or
- is subject to a condition preventing him or her from doing work relating to the carrying on of a licensable activity.

Any premises licence issued in respect of an application made on or after 6 April 2017 will become invalid if the holder ceases to be entitled to work in the UK.

Applicants must demonstrate that they have an entitlement to work in the UK and are not subject to a condition preventing them from doing work relating to the carrying on of a licensable activity. They do this by providing with this application copies or scanned copies of the following documents (which do not need to be certified).

Documents which demonstrate entitlement to work in the UK

- An expired or current passport showing the holder, or a person named in the passport as the child of the holder, is a British citizen or a citizen of the UK and Colonies having the right of abode in the UK [please see note below about which sections of the passport to copy].
- An expired or current passport or national identity card showing the holder, or a person named in the passport as the child of the holder, is a national of a European Economic Area country or Switzerland.
- A Registration Certificate or document certifying permanent residence issued by the Home Office to a national of a European Economic Area country or Switzerland.
- A Permanent Residence Card issued by the Home Office to the family member of a national of a European Economic Area country or Switzerland.
- A **current** Biometric Immigration Document (Biometric Residence Permit) issued by the Home Office to the holder indicating that the person named is allowed to stay indefinitely in the UK, or has no time limit on their stay in the UK.
- A **current** passport endorsed to show that the holder is exempt from Immigration control, is allowed to stay indefinitely in the UK, has the right of abode in the UK, or has no time limit on their stay in the UK.
- A **current** Immigration Status Document issued by the Home Office to the holder with an endorsement indicating that the named person is allowed to stay indefinitely in the UK or has no time limit on their stay in the UK, **when produced in combination with** an official document giving the person's permanent National Insurance number and their name issued by a Government agency or a previous employer.
- A **full** birth or adoption certificate issued in the UK which includes the name(s) of at least one of the holder's parents or adoptive parents, **when produced in combination with** an official document giving the person's permanent National Insurance number and their name issued by a Government agency or a previous employer.
- A birth or adoption certificate issued in the Channel Islands, the Isle of Man or Ireland **when produced in combination with** an official document giving the person's permanent National Insurance number and their name issued by a Government agency or a previous employer.
- A certificate of registration or naturalisation as a British citizen, **when produced in combination with** an official document giving the person's permanent National Insurance number and their name issued by a Government agency or a previous employer.
- A **current** passport endorsed to show that the holder is allowed to stay in the UK and is currently allowed to work and is not subject to a condition preventing the holder from doing work relating to the carrying on of a licensable activity.

Continued from previous page...

- A **current** Biometric Immigration Document (Biometric Residence Permit) issued by the Home Office to the holder which indicates that the named person can currently stay in the UK and is allowed to work relation to the carrying on of a licensable activity.
- A **current** Residence Card issued by the Home Office to a person who is not a national of a European Economic Area state or Switzerland but who is a family member of such a national or who has derivative rights of residence.
- A **current** Immigration Status Document containing a photograph issued by the Home Office to the holder with an endorsement indicating that the named person may stay in the UK, and is allowed to work and is not subject to a condition preventing the holder from doing work relating to the carrying on of a licensable activity **when produced in combination with** an official document giving the person's permanent National Insurance number and their name issued by a Government agency or a previous employer.
- A Certificate of Application, **less than 6 months old**, issued by the Home Office under regulation 17(3) or 18A (2) of the Immigration (European Economic Area) Regulations 2006, to a person who is not a national of a European Economic Area state or Switzerland but who is a family member of such a national or who has derivative rights of residence.
- Reasonable evidence that the person has an outstanding application to vary their permission to be in the UK with the Home Office such as the Home Office acknowledgement letter or proof of postage evidence, or reasonable evidence that the person has an appeal or administrative review pending on an immigration decision, such as an appeal or administrative review reference number.
- Reasonable evidence that a person who is not a national of a European Economic Area state or Switzerland but who is a family member of such a national or who has derivative rights of residence in exercising treaty rights in the UK including:-
 - evidence of the applicant's own identity – such as a passport,
 - evidence of their relationship with the European Economic Area family member – e.g. a marriage certificate, civil partnership certificate or birth certificate, and
 - evidence that the European Economic Area national has a right of permanent residence in the UK or is one of the following if they have been in the UK for more than 3 months:
 - (i) working e.g. employment contract, wage slips, letter from the employer,
 - (ii) self-employed e.g. contracts, invoices, or audited accounts with a bank,
 - (iii) studying e.g. letter from the school, college or university and evidence of sufficient funds; or
 - (iv) self-sufficient e.g. bank statements.

Family members of European Economic Area nationals who are studying or financially independent must also provide evidence that the European Economic Area national and any family members hold comprehensive sickness insurance in the UK. This can include a private medical insurance policy, an EHIC card or an S1, S2 or S3 form.

Original documents must not be sent to licensing authorities. If the document copied is a passport, a copy of the following pages should be provided:-

- (i) any page containing the holder's personal details including nationality;
- (ii) any page containing the holder's photograph;
- (iii) any page containing the holder's signature;
- (iv) any page containing the date of expiry; and
- (v) any page containing information indicating the holder has permission to enter or remain in the UK and is permitted to work.

If the document is not a passport, a copy of the whole document should be provided.

Your right to work will be checked as part of your licensing application and this could involve us checking your immigration status with the Home Office. We may otherwise share information with the Home Office. Your licence application will not be determined until you have complied with this guidance.

Section 20 of 21

NOTES ON REGULATED ENTERTAINMENT

Continued from previous page...

In terms of specific **regulated entertainments** please note that:

- Plays: no licence is required for performances between 08:00 and 23:00 on any day, provided that the audience does not exceed 500.
- Films: no licence is required for 'not-for-profit' film exhibition held in community premises between 08:00 and 23:00 on any day provided that the audience does not exceed 500 and the organiser (a) gets consent to the screening from a person who is responsible for the premises; and (b) ensures that each such screening abides by age classification ratings.
- Indoor sporting events: no licence is required for performances between 08:00 and 23:00 on any day, provided that the audience does not exceed 1000.
- Boxing or Wrestling Entertainment: no licence is required for a contest, exhibition or display of Greco-Roman wrestling, or freestyle wrestling between 08:00 and 23:00 on any day, provided that the audience does not exceed 1000. Combined fighting sports – defined as a contest, exhibition or display which combines boxing or wrestling with one or more martial arts – are licensable as a boxing or wrestling entertainment rather than an indoor sporting event.
- Live music: no licence permission is required for:
 - o a performance of unamplified live music between 08:00 and 23:00 on any day, on any premises.
 - o a performance of amplified live music between 08:00 and 23:00 on any day on premises authorised to sell alcohol for consumption on those premises, provided that the audience does not exceed 500.
 - o a performance of amplified live music between 08:00 and 23:00 on any day, in a workplace that is not licensed to sell alcohol on those premises, provided that the audience does not exceed 500.
 - o a performance of amplified live music between 08:00 and 23:00 on any day, in a church hall, village hall, community hall, or other similar community premises, that is not licensed by a premises licence to sell alcohol, provided that (a) the audience does not exceed 500, and (b) the organiser gets consent for the performance from a person who is responsible for the premises.
 - o a performance of amplified live music between 08:00 and 23:00 on any day, at the non-residential premises of (i) a local authority, or (ii) a school, or (iii) a hospital, provided that (a) the audience does not exceed 500, and (b) the organiser gets consent for the performance on the relevant premises from: (i) the local authority concerned, or (ii) the school or (iii) the health care provider for the hospital.
- Recorded Music: no licence permission is required for:
 - o any playing of recorded music between 08:00 and 23:00 on any day on premises authorised to sell alcohol for consumption on those premises, provided that the audience does not exceed 500.
 - o any playing of recorded music between 08:00 and 23:00 on any day, in a church hall, village hall, community hall, or other similar community premises, that is not licensed by a premises licence to sell alcohol, provided that (a) the audience does not exceed 500, and (b) the organiser gets consent for the performance from a person who is responsible for the premises.
 - o any playing of recorded music between 08:00 and 23:00 on any day, at the non-residential premises of (i) a local authority, or (ii) a school, or (iii) a hospital, provided that (a) the audience does not exceed 500, and (b) the organiser gets consent for the performance on the relevant premises from: (i) the local authority concerned, or (ii) the school proprietor or (iii) the health care provider for the hospital.

Continued from previous page...

- Dance: no licence is required for performances between 08.00 and 23.00 on any day, provided that the audience does not exceed 500. However, a performance which amounts to adult entertainment remains licensable.
- Cross activity exemptions: no licence is required between 08.00 and 23.00 on any day, with no limit on audience size for:
 - o any entertainment taking place on the premises of the local authority where the entertainment is provided by or on behalf of the local authority;
 - o any entertainment taking place on the hospital premises of the health care provider where the entertainment is provided by or on behalf of the health care provider;
 - o any entertainment taking place on the premises of the school where the entertainment is provided by or on behalf of the school proprietor; and
 - o any entertainment (excluding films and a boxing or wrestling entertainment) taking place at a travelling circus, provided that (a) it takes place within a moveable structure that accommodates the audience, and (b) that the travelling circus has not been located on the same site for more than 28 consecutive days.

Section 21 of 21

PAYMENT DETAILS

This fee must be paid to the authority. If you complete the application online, you must pay it by debit or credit card.

Premises Licence Fees are determined by the non domestic rateable value of the premises.

To find out a premises non domestic rateable value go to the Valuation Office Agency site at <https://www.tax.service.gov.uk/business-rates-find/search>

Band A - No RV to £4300 - £100.00

Band B - £4301 to £33000 - £190.00

Band C - £33001 to £87000 - £315.00

Band D - £87001 to £125000 - £450.00*

Band E - £125001 and over - £635.00*

*If the premises rateable value is in Bands D or E and the premises is primarily used for the consumption of alcohol on the premises then you are required to pay a higher fee

Band D - £87001 to £125000 - £900.00

Band E - £125001 and over - £1,905.00

There is an exemption from the payment of fees in relation to the provision of regulated entertainment at church halls, chapel halls or premises of a similar nature, village halls, parish or community halls, or other premises of a similar nature. The costs associated with these licences will be met by central Government. If, however, the licence also authorises the use of the premises for the supply of alcohol or the provision of late night refreshment, a fee will be required.

Schools and sixth form colleges are exempt from the fees associated with the authorisation of regulated entertainment where the entertainment is provided by and at the school or college and for the purposes of the school or college.

If you operate a large event you are subject to ADDITIONAL fees based upon the number in attendance at any one time

Capacity 5000-9999 - £1,000.00

Capacity 10000-14999 - £2,000.00

Capacity 15000-19999 - £4,000.00

Capacity 20000-29999 - £8,000.00

Capacity 30000-39999 - £16,000.00

Capacity 40000-49999 - £24,000.00

Capacity 50000-59999 - £32,000.00

Capacity 60000-69999 - £40,000.00

Capacity 70000-79999 - £48,000.00

Capacity 80000-89999 - £56,000.00

Capacity 90000 and over - £64,000.00

* Fee amount (£)

190.00

DECLARATION

Continued from previous page...

[APPLICABLE TO INDIVIDUAL APPLICANTS ONLY, INCLUDING THOSE IN A PARTNERSHIP WHICH IS NOT A LIMITED LIABILITY PARTNERSHIP] I UNDERSTAND I AM NOT ENTITLED TO BE ISSUED WITH A LICENCE IF I DO NOT HAVE THE

* ENTITLEMENT TO LIVE AND WORK IN THE UK (OR IF I AM SUBJECT TO A CONDITION PREVENTING ME FROM DOING WORK RELATING TO THE CARRYING ON OF A LICENSABLE ACTIVITY) AND THAT MY LICENCE WILL BECOME INVALID IF I CEASE TO BE ENTITLED TO LIVE AND WORK IN THE UK (PLEASE READ GUIDANCE NOTE 15).

THE DPS NAMED IN THIS APPLICATION FORM IS ENTITLED TO WORK IN THE UK (AND IS NOT SUBJECT TO CONDITIONS

* PREVENTING HIM OR HER FROM DOING WORK RELATING TO A LICENSABLE ACTIVITY) AND I HAVE SEEN A COPY OF HIS OR HER PROOF OF ENTITLEMENT TO WORK, IF APPROPRIATE (PLEASE SEE NOTE 15).

☒ Ticking this box indicates you have read and understood the above declaration

This section should be completed by the applicant, unless you answered "Yes" to the question "Are you an agent acting on behalf of the applicant?"

* Full name

* Capacity

* Date / /
dd mm yyyy

Once you're finished you need to do the following:

1. Save this form to your computer by clicking file/save as...
2. Go back to <https://www.gov.uk/apply-for-a-licence/premises-licence/birmingham/apply-1> to upload this file and continue with your application.

Don't forget to make sure you have all your supporting documentation to hand.

IT IS AN OFFENCE LIABLE TO SUMMARY CONVICTION TO A FINE OF ANY AMOUNT UNDER SECTION 158 OF THE LICENSING ACT 2003, TO MAKE A FALSE STATEMENT IN OR IN CONNECTION WITH THIS APPLICATION

IT IS AN OFFENCE UNDER SECTION 24B OF THE IMMIGRATION ACT 1971 FOR A PERSON TO WORK WHEN THEY KNOW, OR HAVE REASONABLE CAUSE TO BELIEVE, THAT THEY ARE DISQUALIFIED FROM DOING SO BY REASON OF THEIR IMMIGRATION STATUS. THOSE WHO EMPLOY AN ADULT WITHOUT LEAVE OR WHO IS SUBJECT TO CONDITIONS AS TO EMPLOYMENT WILL BE LIABLE TO A CIVIL PENALTY UNDER SECTION 15 OF THE IMMIGRATION, ASYLUM AND NATIONALITY ACT 2006 AND PURSUANT TO SECTION 21 OF THE SAME ACT, WILL BE COMMITTING AN OFFENCE WHERE THEY DO SO IN THE KNOWLEDGE, OR WITH REASONABLE CAUSE TO BELIEVE, THAT THE EMPLOYEE IS DISQUALIFIED

Blandford Road

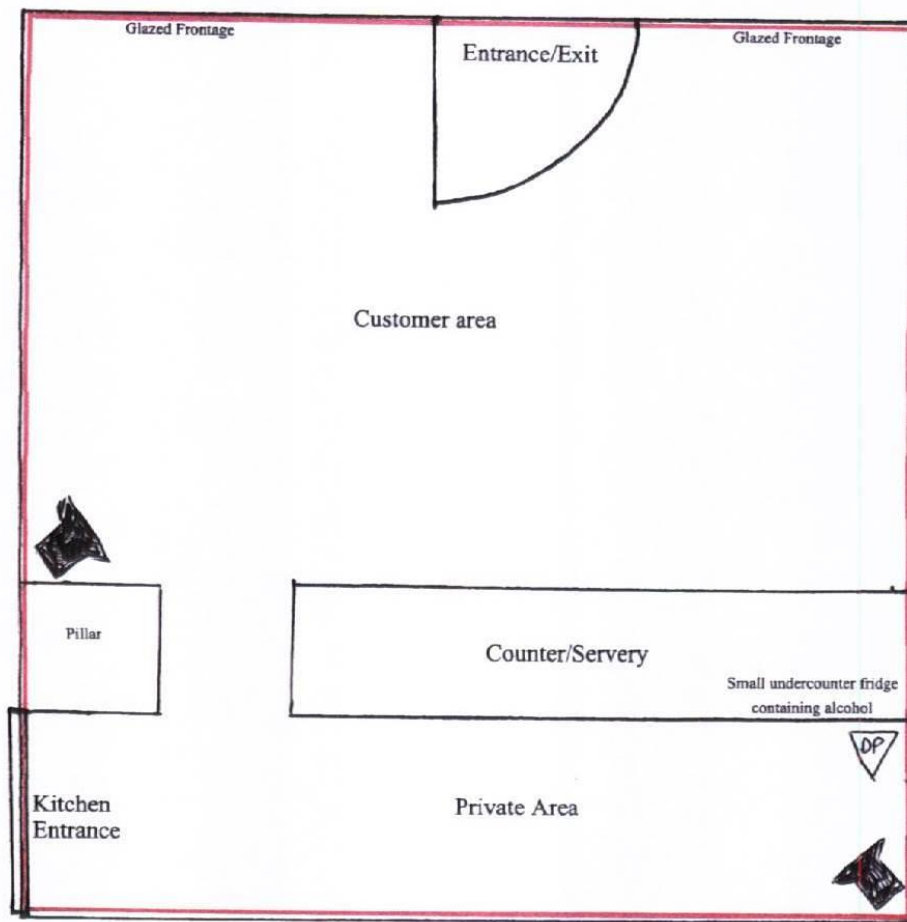

 Within red line is the Licensed area

 Fire Extinguisher

 CCTV Cameras

Licensing Plan of
Royal City Takeaway
103 Blandford Road
Quinton
Birmingham
B32 2LT
Scale 1:100
Application for a New
Premises License

Appendix 3

From: bw licensing < >
Sent: 11 May 2018 09:20
To: Licensing
Cc: Carl Moore (< >)
Subject: Premises Licence - Royal City takeaway 103 Blandford Rd. Quinton. B32 2LT

Good Morning Licensing,

With regard to the premises licence application for Royal City Takeaway, 103 Blandford Rd, Quinton. B32 2LT'

West Midlands Police have reviewed this application and are happy that if the below conditions are added to the premises licence then the licensing objectives will be met and promoted.

The below conditions have been agreed with the applicant, via their solicitor as per below email chain who is copied into this email.

- **Challenge 25 signage will be prominently displayed service / order area.**
- **Alcohol will only be served to customers who have ordered a meal.**
- **Alcohol sold with delivery orders will be paid for by 'card payment' at the time of order. No cash or card payment 'on the door.' Delivery drivers will only deliver alcohol to the person who is named on the card and confirmed by photographic ID. (Customers will be made aware of this procedure at time of order to avoid any confusion.) This condition will be displayed on any website / social media or flyer used to advertise the premises and also apply to on line orders.**
- **Staff will received training in their responsibilities of the Licensing Act, challenge 25 policy and premises operating conditions. All training will be documented and signed by both the trainer and trainee. This documented training will be made immediately available to any of the responsible authorities on request. No staff to work at the premises while it is carrying out licensable activity without this training, with the exception of personal licence holders.**
- **CCTV to be fitted / updated to the specifications and recommendations of West Midlands Police. CCTV to record throughout the whole of the licensable activity, display the correct time and date stamp and be stored for a minimum of 14 days. CCTV will be downloadable and made immediately available to any of the responsible authorities on request. There will be a member of staff on duty who is capable of operating the CCTV system as required.**

If these above conditions are imposed onto the licence then West Midlands police have no objection to this application.

Regards

Chris Jones 55410
Birmingham Central Licensing Team

West Midlands Police HQ
Lloyd House
Colmore Circus
Birmingham
B4 6NQ



From: Carl Moore
Sent: 10 May 2018 11:08
To: Christopher Jones
Cc: bw licensing
Subject: Fw: Proposed Conditions From West Midlands Police

Morning Chris,

I have gone through each of the conditions with my client and she full understands them. She is also in receipt of the conditions.

My client as shown is happy to accept the proposed conditions on the premises license.

Regards

carl

Carl Moore
Director
C.N.A. Risk Management Ltd

This document is strictly confidential and is intended only for use by the addressee. If you are not the intended recipient, any disclosure, copying, distribution or other action taken in reliance of the information contained in this e-mail is strictly prohibited. Any views expressed by the sender of this message are not necessarily those of C.N.A.Risk Management Limited. If you have received this transmission in error, please use the reply function to tell us and then permanently delete what you have received.

Please note: Incoming and outgoing e-mail messages are routinely monitored for compliance with our policy on the use of electronic communications.

Appendix 4

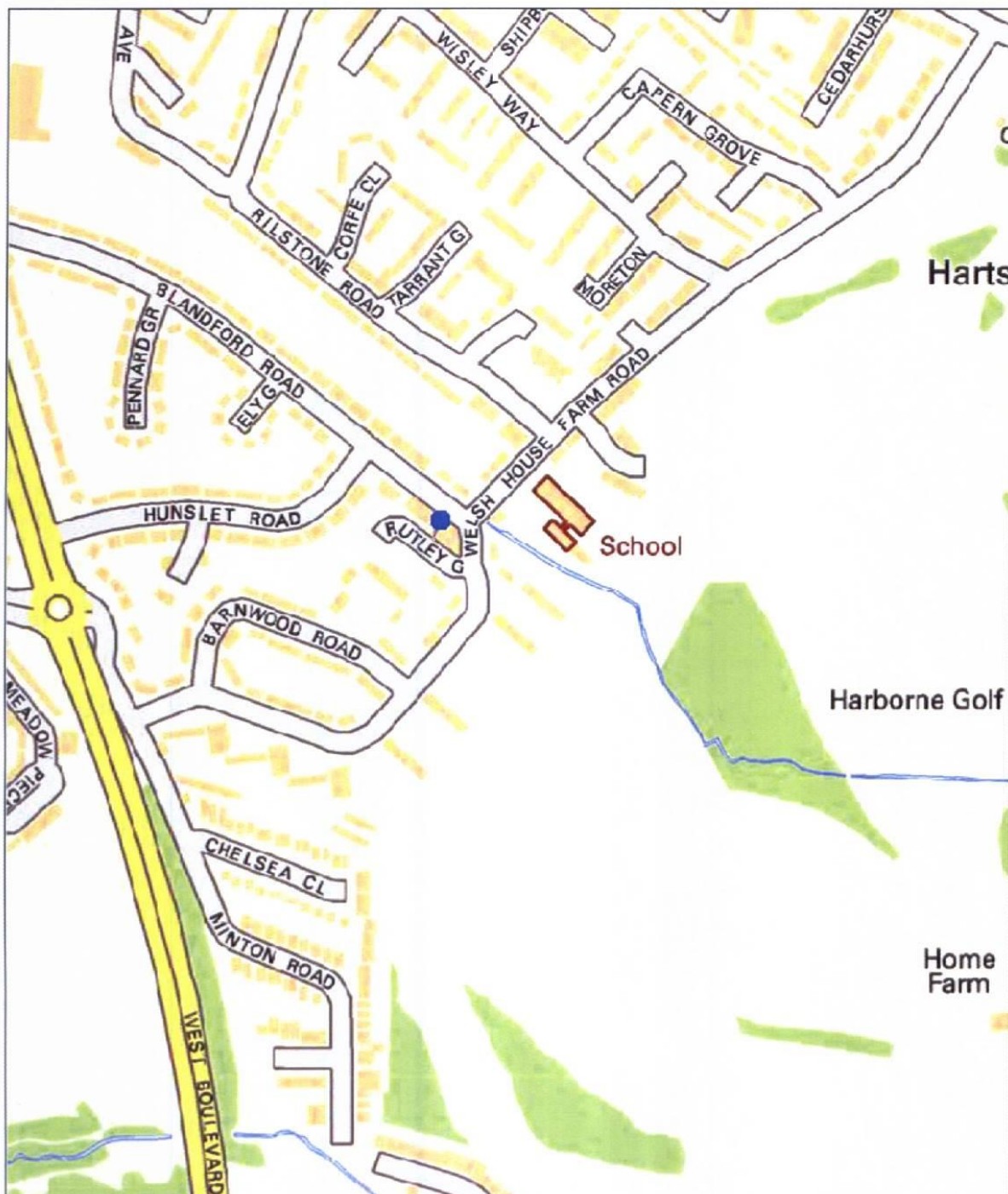

Birmingham City Council Map Created By:

Date of Map Creation: 30/05/2018

Notes



Scale:
1:4,000

(c) Crown copyright. All rights reserved. Birmingham City Council 100021326 (2016).
You are not permitted to copy, sub-licence, distribute or sell any of this data to third parties in any form.
(c) GeoPerspectives, supplied by Bluesky International Ltd
Cities Revealed® copyright by The GeoInformation® Group, 2014 and Crown Copyright © All right reserved

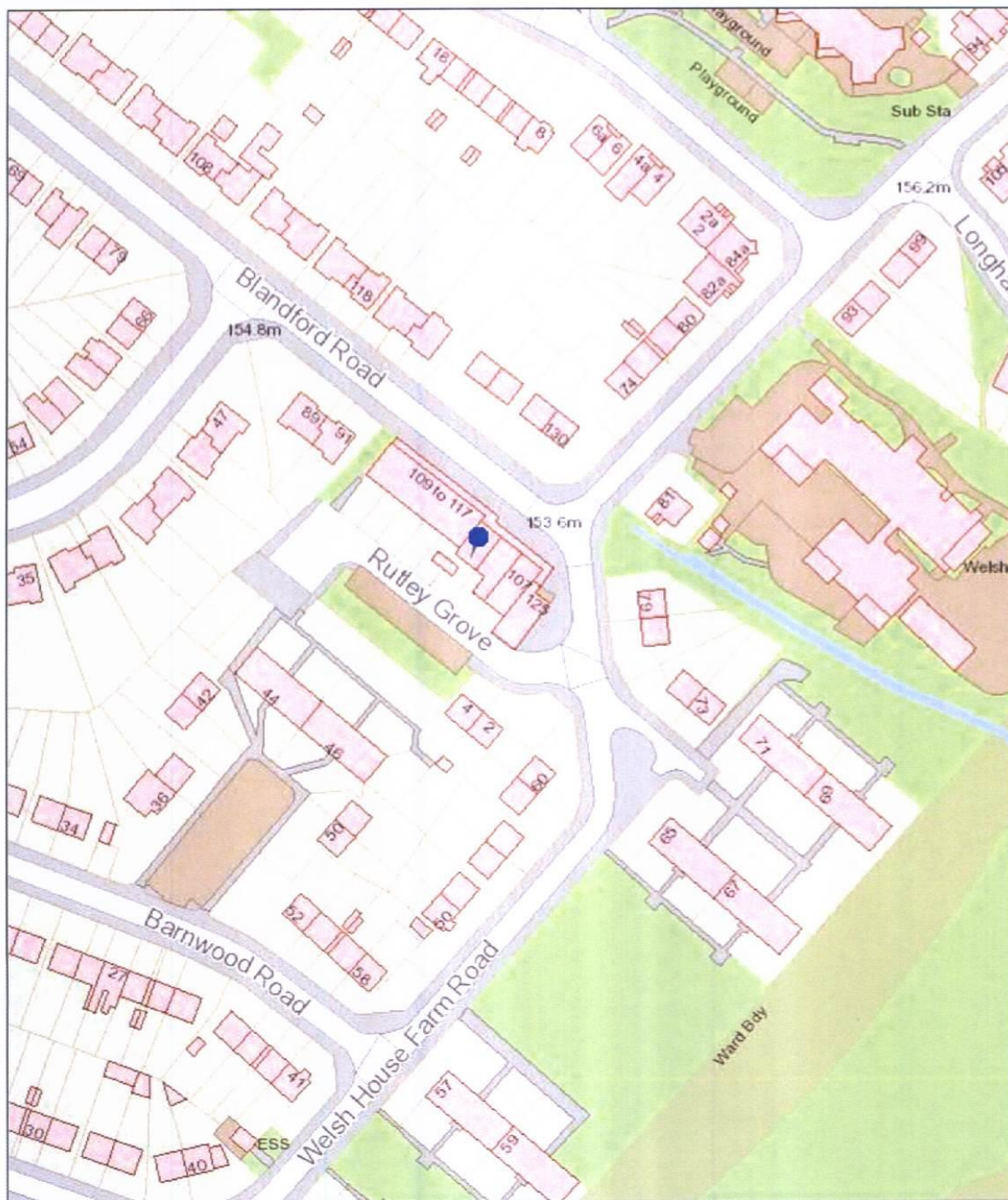

Birmingham City Council

Map Created By:

Date of Map Creation: 30/05/2018

Notes



Scale:
1:1,250

(c) Crown copyright. All rights reserved. Birmingham City Council 100021326 (2016).
You are not permitted to copy, sub-licence, distribute or sell any of this data to third parties in any form.

(c) GeoPerspectives, supplied by Bluesky International Ltd

Cities Revealed® copyright by The GeoInformation® Group, 2014 and Crown Copyright © All right reserved