

Members are reminded that they must declare all relevant pecuniary and non-pecuniary interests relating to any items of business to be discussed at this meeting

BIRMINGHAM CITY COUNCIL

LICENSING SUB-COMMITTEE C

WEDNESDAY, 06 SEPTEMBER 2017 AT 09:30 HOURS
IN COMMITTEE ROOM 1, COUNCIL HOUSE, VICTORIA SQUARE,
BIRMINGHAM, B1 1BB

Please note a short break will be taken approximately 90 minutes from the start of the meeting and a 30 minute break will be taken at 1300 hours.

A G E N D A

1 NOTICE OF RECORDING

Chairman to advise meeting to note that members of the press/public may record and take photographs except where there are confidential or exempt items.

2 APOLOGIES AND NOTIFICATION OF NOMINEE MEMBERS

3 - 44

3 LICENSING ACT 2003 PREMISES LICENCE – GRANT THE DIGBY, 911 CHESTER ROAD, ERDINGTON, BIRMINGHAM, B24 0HJ

Report of the Acting Director of Regulation and Enforcement.
N.B. Application scheduled to be heard at 09:30am

4 OTHER URGENT BUSINESS

To consider any items of business by reason of special circumstances (to be specified) that in the opinion of the Chairman are matters of urgency.

BIRMINGHAM CITY COUNCIL

PUBLIC REPORT

Report to:	Licensing Sub Committee C
Report of:	Acting Director of Regulation & Enforcement
Date of Meeting:	Wednesday 6th September 2017
Subject:	Licensing Act 2003 Premises Licence – Grant
Premises:	The Digby, 911 Chester Road, Erdington, Birmingham, B24 0HJ
Ward affected:	Erdington
Contact Officer:	Bhapinder Nandhra, Senior Licensing Officer, 0121 303 9896, licensing@birmingham.gov.uk

1. Purpose of report:

To consider relevant representations that have been made in respect of an application for a Premises Licence which seeks to permit the Sale of Alcohol (for consumption both on and off the premises) to operate from 10:00am until 12:00midnight (Monday to Sunday).

To permit the provision of Regulated Entertainment consisting of films to operate from 10:00am until 12:00midnight (Monday to Sunday) and Recorded music to operate 24hours (Monday to Sunday). Both activities to operate indoors only.

To permit the provision of Late Night Refreshment to operate from 11:00pm until 12:00midnight (Monday to Sunday).

Premises to remain open to the public from 08:00am until 12:30am (Monday to Sunday).

Other dates and times as specified in the application form.

2. Recommendation:

To consider the representations that have been made and to determine the application.

3. Brief Summary of Report:

An application for a Premises Licence was received on 14th July 2017 in respect of The Digby, 911 Chester Road, Erdington, Birmingham, B24 0HJ.

Representations have been received from other persons.

4. Compliance Issues:

4.1 Consistency with relevant Council Policies, Plans or Strategies:

The report complies with the City Council's Statement of Licensing Policy and the Council's Corporate Plan to improve the standard of all licensed persons, premises and vehicles in the City.

5. Relevant background/chronology of key events:

Stonegate Pub Company Limited applied on 14th July 2017 for the grant of a Premises Licence for The Digby, 911 Chester Road, Erdington, Birmingham B24 0HJ.

Representations have been received from other persons, which are attached at Appendices 1 – 3.

The application is attached at Appendix 4.

It should be noted that Stonegate Pub Company Limited currently have a Premises Licence in force for the venue which permits all of the licensable activities being sought by this application to take place during the already permitted hours including the non-standard timings / days stated in the application form.

A copy of the current Premises Licence is attached at Appendix 5.

Stonegate Pub Company Limited have applied for the grant of a new Premises Licence due to the increase in the size of the internal area to be licensed and to update the operating schedule conditions volunteered in the new application.

Site Location Plans at Appendix 6.

When carrying out its licensing functions, a licensing authority must have regard to Birmingham City Council's Statement of Licensing Policy and the Guidance issued by the Secretary of State under s182 of the Licensing Act 2003. The Licensing Authority is also required to take such steps as it considers appropriate for the promotion of the licensing objectives, which are:-

- a. The prevention of crime and disorder;
- b. Public safety;
- c. The prevention of public nuisance; and
- d. The protection of children from harm.

6. List of background documents:

Copy of the representations as detailed in Appendices 1 – 3
Application Form, Appendix 4
Existing Premises Licence 5
Site Location Plans, Appendix 6

7. Options available

To Grant the licence in accordance with the application.

To Reject the application.

To Grant the licence subject to conditions modified to such an extent as considered appropriate.

Exclude from the licence any of the licensable activities to which the application relates.

Refuse to specify a person in the licence as the premises supervisor.

Appendix 1

Entered
R

From:
Sent: 11 August 2017 21:24
To: Licensing
Subject: Fw: Fwd: RE Representation to the amendment on the licensing agreement for the Digby Public House, Chester Road, Erdington, Birmingham, B24 0HJ.

Subject: RE Representation to the amendment on the licensing agreement for the Digby Public House, Chester Road, Erdington, Birmingham, B24 0HJ.

RE Representation to the amendment on the licensing agreement for the Digby Public House, Chester Road, Erdington, Birmingham, B24 0HJ.

I, _____ of Birch Croft, Erdington B24 _____ oppose the above application.

The nature of this application is of great concern to me as I feel it is not in the best interest of the local area. This area is a residential area, predominantly populated by families and senior citizens and this application is more in keeping with a city centre night time destination.

I feel that the Digby pub has made no effort to attract local residents, and that this application will further ostracize the local residents, thus relying on customers commuting to and from the pub increasing the risk of accidents related to drink driving.

The current licensing agreement allows for extended drinking on bank holidays, this results in excessive noise long after last orders, with customer remaining at the premises for up to 2 hours after the licensing agreement creating excess noise.

The application for the allowance of recorded music to be played at this venue is questionable as the venue sporadically hosts "disco" style evenings within it's current licensing. These evenings cause great distress to my family and I as the music can be clearly heard from my child's bedroom as we try to settle him for the night. Again the nature of this activity is not in keeping with the local area and therefore forms part of my representation.

Additionally, the Digby pub currently causes excessive light pollution by floodlighting it's entire car park throughout the night and fails to secure it's car park outside of its business hours resulting in further

nuisance behaviour by drivers skidding and wheel-spinning around it's vast car park outside the current licensing agreement.

I have also had to inform the police on several occasions due to violent affray occurring within the pub's premises.

Please can you ensure I am made aware of any further application made by this establishment, as this application was only identified at the 11th hour. And previous application have gone unchallenged.

Regards

Appendix 2

Entered
on

From:
Sent: 11 August 2017 21:03
To: Licensing
Cc:
Subject: RE Representation to the amendment on the licensing agreement for the Digby Public House, Chester Road, Erdington, Birmingham, B24 0HJ.

RE Representation to the amendment on the licensing agreement for the Digby Public House, Chester Road, Erdington, Birmingham, B24 0HJ.

I, [redacted] of [redacted] Birch Croft, Erdington B24 [redacted] oppose the above application.

The nature of this application is of great concern to me as I feel it is not in the best interest of the local area. This area is a residential area, predominantly populated by families and senior citizens and this application is more in keeping with a city centre night time destination.

I feel that the Digby pub has made no effort to attract local residents, and that this application will further ostracize the local residents, thus relying on customers commuting to and from the pub increasing the risk of accidents related to drink driving.

The current licensing agreement allows for extended drinking on bank holidays, this results in excessive noise long after last orders, with customer remaining at the premises for up to 2 hours after the licensing agreement creating excess noise.

The application for the allowance of recorded music to be played at this venue is questionable as the venue sporadically hosts "disco" style evenings within it's current licensing. These evenings cause great distress to my family and I as the music can be clearly heard from my child's bedroom as we try to settle him for the night. Again the nature of this activity is not in keeping with the local area and therefore forms part of my representation.

Additionally, the Digby pub currently causes excessive light pollution by floodlighting it's entire car park throughout the night and fails to secure it's car park outside of its business hours resulting in further nuisance behaviour by drivers skidding and wheel-spinning around it's vast car park outside the current licensing agreement.

I have also had to inform the police on several occasions due to violent affray occurring within the pub's premises.

Please can you ensure I am made aware of any further application made by this establishment, as this application was only identified at the 11th hour. And previous application have gone unchallenged.

Regards

Entered

From: info@digby.co.uk
Sent: 11 August 2017 21:57
To: Licensing
Subject: RE Representation to the amendment on the licensing agreement for the Digby Public House, Chester Road, Erdington, Birmingham, B24 0HJ

RE Representation to the amendment on the licensing agreement for the Digby Public House, Chester Road, Erdington, Birmingham, B24 0HJ.

We, _____ and _____ of _____ Birch Croft, Erdington B24 _____ oppose the above application.

The nature of this application is of great concern to us, as we feel it is not in the best interest of the local area. This area is a residential area, predominantly populated by families and senior citizens and this application is more in keeping with a city centre night time destination.

We feel that the Digby pub has made no effort to attract local residents, and that this application will further ostracize the local residents, thus relying on customers commuting to and from the pub increasing the risk of accidents related to drink driving.

The current licensing agreement allows for extended drinking on bank holidays, this results in excessive noise long after last orders, with customers remaining at the premises for up to 2 hours after the licensing agreement creating excess noise.

The application for the allowance of recorded music to be played at this venue is questionable as the venue sporadically hosts "disco" style evenings within it's current licensing. Again the nature of this activity is not in keeping with the local area and therefore forms part of my representation.

Additionally, the Digby pub currently causes excessive light pollution by floodlighting it's entire car park throughout the night and fails to secure it's car park outside of its business hours resulting in further nuisance behaviour by drivers skidding and wheel-spinning around it's vast car park outside the current licensing agreement.

Please can you ensure we are made aware of any further application made by this establishment, as this application was only identified at the 11th hour. And previous application have gone unchallenged.

Regards

Birmingham
Application for a premises licence
Licensing Act 2003

For help contact
 licensingonline@birmingham.gov.uk
 Telephone: 0121 303 9896

* required information

Section 1 of 21

You can save the form at any time and resume it later. You do not need to be logged in when you resume.

System reference This is the unique reference for this application generated by the system.

Your reference You can put what you want here to help you track applications if you make lots of them. It is passed to the authority.

Are you an agent acting on behalf of the applicant?
☒ Yes ☐ No

Put "none" if you are applying on your own behalf or on behalf of a business you own or work for.

BCC
 REGULATION & ENFORCEMENT
 LICENSING SECTION
 DATE RECEIVED
 14 JUL 2017

REF NO.

INITIALS

Applicant Details* First name * Family name * E-mail Main telephone number Include country code.Other telephone number
☐ Indicate here if the applicant would prefer not to be contacted by telephone

Is the applicant:

☒ Applying as a business or organisation, including as a sole trader

☐ Applying as an individual

A sole trader is a business owned by one person without any special legal structure. Applying as an individual means the applicant is applying so the applicant can be employed, or for some other personal reason, such as following a hobby.

Applicant Business

Is the applicant's business registered in the UK with Companies House?
☒ Yes ☐ No

Note: completing the Applicant Business section is optional in this form.

Registration number Business name

If the applicant's business is registered, use its registered name.

VAT number

Put "none" if the applicant is not registered for VAT.

Legal status

Continued from previous page...

Applicant's position in the business

Home country

The country where the applicant's headquarters are.

Registered Address

Address registered with Companies House.

Building number or name

Street

District

City or town

County or administrative area

Postcode

Country

Agent Details

* First name

* Family name

* E-mail

Main telephone number

Include country code.

Other telephone number

☐ Indicate here if you would prefer not to be contacted by telephone

Are you:

☒ An agent that is a business or organisation, including a sole trader

A sole trader is a business owned by one person without any special legal structure.

☐ A private individual acting as an agent

Agent Business

Is your business registered in the UK with Companies House? ☐ Yes ☒ No

Note: completing the Applicant Business section is optional in this form.

Is your business registered outside the UK? ☐ Yes ☒ No

Business name

If your business is registered, use its registered name.

VAT number

Put "none" if you are not registered for VAT.

Legal status

Continued from previous page...

Your position in the business

Home country

The country where the headquarters of your business is located.

Agent Business Address

If you have one, this should be your official address - that is an address required of you by law for receiving communications.

Building number or name

Street

District

City or town

County or administrative area

Postcode

Country

Section 2 of 21

PREMISES DETAILS

I/we, as named in section 1, apply for a premises licence under section 17 of the Licensing Act 2003 for the premises described in section 2 below (the premises) and I/we are making this application to you as the relevant licensing authority in accordance with section 12 of the Licensing Act 2003.

Premises Address

Are you able to provide a postal address, OS map reference or description of the premises?

☒ Address ☐ OS map reference ☐ Description

Postal Address Of Premises

Building number or name

Street

District

City or town

County or administrative area

Postcode

Country

Further Details

Telephone number

Non-domestic rateable value of premises (£)

Section 3 of 21**APPLICATION DETAILS**

In what capacity are you applying for the premises licence?

- ☐ An individual or individuals
- ☒ A limited company / limited liability partnership
- ☐ A partnership (other than limited liability)
- ☐ An unincorporated association
- ☐ Other (for example a statutory corporation)
- ☐ A recognised club
- ☐ A charity
- ☐ The proprietor of an educational establishment
- ☐ A health service body
- ☐ A person who is registered under part 2 of the Care Standards Act 2000 (c14) in respect of an independent hospital in Wales
- ☐ A person who is registered under Chapter 2 of Part 1 of the Health and Social Care Act 2008 in respect of the carrying on of a regulated activity (within the meaning of that Part) in an independent hospital in England
- ☐ The chief officer of police of a police force in England and Wales

Confirm The Following

- ☒ I am carrying on or proposing to carry on a business which involves the use of the premises for licensable activities
- ☐ I am making the application pursuant to a statutory function
- ☐ I am making the application pursuant to a function discharged by virtue of Her Majesty's prerogative

Section 4 of 21**NON INDIVIDUAL APPLICANTS**

Provide name and registered address of applicant in full. Where appropriate give any registered number. In the case of a partnership or other joint venture (other than a body corporate), give the name and address of each party concerned.

Non Individual Applicant's Name

Name

Details

Registered number (where applicable)

Description of applicant (for example partnership, company, unincorporated association etc)

Continued from previous page...

Limited Company

Address

Building number or name

Street

District

City or town

County or administrative area

Postcode

Country

Contact Details

E-mail

Telephone number

Other telephone number

* Date of birth / /
dd mm yyyy

* Nationality

Documents that demonstrate entitlement to work in the UK

Section 5 of 21

OPERATING SCHEDULE

When do you want the premises licence to start? / /
dd mm yyyy

If you wish the licence to be valid only for a limited period, when do you want it to end / /
dd mm yyyy

Provide a general description of the premises

For example the type of premises, its general situation and layout and any other information which could be relevant to the licensing objectives. Where your application includes off-supplies of alcohol and you intend to provide a place for consumption of these off-supplies you must include a description of where the place will be and its proximity to the premises.

This is an existing Licensed premises, which is a proper pub brand, a traditional pub style operation with a traditional food offering. There is an existing external area for customer use.

Continued from previous page...

If 5,000 or more people are expected to attend the premises at any one time, state the number expected to attend

Section 6 of 21

PROVISION OF PLAYS

See guidance on regulated entertainment

Will you be providing plays?

☐ Yes

☒ No

Section 7 of 21

PROVISION OF FILMS

See guidance on regulated entertainment

Will you be providing films?

☒ Yes

☐ No

Standard Days And Timings

MONDAY

Start

End

Start

End

TUESDAY

Start

End

Start

End

WEDNESDAY

Start

End

Start

End

THURSDAY

Start

End

Start

End

FRIDAY

Start

End

Start

End

SATURDAY

Start

End

Start

End

Give timings in 24 hour clock.
(e.g., 16:00) and only give details for the days
of the week when you intend the premises
to be used for the activity.

Continued from previous page...

SUNDAY

Start 10:00

End 00:00

Start

End

Will the exhibition of films take place indoors or outdoors or both?

☒ Indoors

☐ Outdoors

☐ Both

Where taking place in a building or other structure tick as appropriate. Indoors may include a tent.

State type of activity to be authorised, if not already stated, and give relevant further details, for example (but not exclusively) whether or not music will be amplified or unamplified.

Amplified music video, sport, entertainment programs and any entertainment of a like kind (nothing of an adult nature)

State any seasonal variations for the exhibition of film

For example (but not exclusively) where the activity will occur on additional days during the summer months.

n/a

Non standard timings. Where the premises will be used for the exhibition of film at different times from those listed in the column on the left, list below

For example (but not exclusively), where you wish the activity to go on longer on a particular day e.g. Christmas Eve.

A further additional 2 hours every Christmas Eve

A further additional hour into the morning every Friday, Saturday, Sunday & Monday for each May, Spring/Whit & August Bank Holiday weekend and every Friday, Saturday, Sunday & Monday for Easter Weekend.

A further additional hour into the morning every New Years Day, Valentines Night, Burns Night, St Davids Day, St Patricks Day, Halloween, Boxing Day, 27th, 28th & 30th December.

New Years Eve - from the end of permitted hours to commencement of permitted hours New Years Day

In the event of a transmission of any recognised international sporting event which falls outside the current permitted hours to permit the activity. Commencing 1 hour before the start of the event and ending 1 hour after the event has ended. Details of activity to be notified to the police 21 days beforehand.

The event will not proceed if the police serve 7 days prior to the event written notification upon the designated premises supervisor. The event will not proceed after the 7 day period if the police have intelligence that disorder is likely to occur and they notify the designated premises supervisor.

Section 8 of 21

PROVISION OF INDOOR SPORTING EVENTS

See guidance on regulated entertainment

Will you be providing indoor sporting events?

☐ Yes

☒ No

Section 9 of 21

PROVISION OF BOXING OR WRESTLING ENTERTAINMENTS

Continued from previous page...

See guidance on regulated entertainment

Will you be providing boxing or wrestling entertainments?

☐ Yes

☒ No

Section 10 of 21

PROVISION OF LIVE MUSIC

See guidance on regulated entertainment

Will you be providing live music?

☐ Yes

☒ No

Section 11 of 21

PROVISION OF RECORDED MUSIC

See guidance on regulated entertainment

Will you be providing recorded music?

☒ Yes

☐ No

Standard Days And Timings

MONDAY

Start

End

Start

End

TUESDAY

Start

End

Start

End

WEDNESDAY

Start

End

Start

End

THURSDAY

Start

End

Start

End

FRIDAY

Start

End

Start

End

SATURDAY

Start

End

Start

End

Give timings in 24 hour clock.
(e.g., 16:00) and only give details for the days
of the week when you intend the premises
to be used for the activity.

Continued from previous page...

SUNDAY

Start 00:00

End 23:59

Start

End

Will the playing of recorded music take place indoors or outdoors or both?

☒ Indoors

☐ Outdoors

☐ Both

Where taking place in a building or other structure tick as appropriate. Indoors may include a tent.

State type of activity to be authorised, if not already stated, and give relevant further details, for example (but not exclusively) whether or not music will be amplified or unamplified.

Amplified music played through an in house sound system

State any seasonal variations for playing recorded music

For example (but not exclusively) where the activity will occur on additional days during the summer months.

n/a

Non-standard timings. Where the premises will be used for the playing of recorded music at different times from those listed in the column on the left, list below

For example (but not exclusively), where you wish the activity to go on longer on a particular day e.g. Christmas Eve.

A further additional 2 hours every Christmas Eve

A further additional hour into the morning every Friday, Saturday, Sunday & Monday for each May, Spring/Whit & August Bank Holiday weekend and every Friday, Saturday, Sunday & Monday for Easter Weekend.

A further additional hour into the morning every New Years Day, Valentines Night, Burns Night, St Davids Day, St Patricks Day, Halloween, Boxing Day, 27th, 28th & 30th December.

New Years Eve - from the end of permitted hours to commencement of permitted hours New Years Day

In the event of a transmission of any recognised international sporting event which falls outside the current permitted hours to permit the activity. Commencing 1 hour before the start of the event and ending 1 hour after the event has ended. Details of activity to be notified to the police 21 days beforehand.

The event will not proceed if the police serve 7 days prior to the event written notification upon the designated premises supervisor. The event will not proceed after the 7 day period if the police have intelligence that disorder is likely to occur and they notify the designated premises supervisor.

Section 12 of 21

PROVISION OF PERFORMANCES OF DANCE

See guidance on regulated entertainment

Will you be providing performances of dance?

☐ Yes

☒ No

Section 13 of 21

Continued from previous page...

PROVISION OF ANYTHING OF A SIMILAR DESCRIPTION TO LIVE MUSIC, RECORDED MUSIC OR PERFORMANCES OF DANCE

See guidance on regulated entertainment

Will you be providing anything similar to live music, recorded music or performances of dance?

☐ Yes

☒ No

Section 14 of 21

LATE NIGHT REFRESHMENT

Will you be providing late night refreshment?

☒ Yes

☐ No

Standard Days And Timings

MONDAY

Start

End

Start

End

Give timings in 24 hour clock.
(e.g., 16:00) and only give details for the days
of the week when you intend the premises
to be used for the activity.

TUESDAY

Start

End

Start

End

WEDNESDAY

Start

End

Start

End

THURSDAY

Start

End

Start

End

FRIDAY

Start

End

Start

End

SATURDAY

Start

End

Start

End

SUNDAY

Start

End

Start

End

Continued from previous page...

Will the provision of late night refreshment take place indoors or outdoors or both?

☐ Indoors

☐ Outdoors

☒ Both

Where taking place in a building or other structure tick as appropriate. Indoors may include a tent.

State type of activity to be authorised, if not already stated, and give relevant further details, for example (but not exclusively) whether or not music will be amplified or unamplified.

Hot food and drink provided as and when required including functions or events

State any seasonal variations

For example (but not exclusively) where the activity will occur on additional days during the summer months.

n/a

Non-standard timings. Where the premises will be used for the supply of late night refreshments at different times from those listed in the column on the left, list below

For example (but not exclusively), where you wish the activity to go on longer on a particular day e.g. Christmas Eve.

A further additional 2 hours every Christmas Eve

A further additional hour into the morning every Friday, Saturday, Sunday & Monday for each May, Spring/Whit & August Bank Holiday weekend and every Friday, Saturday, Sunday & Monday for Easter Weekend.

A further additional hour into the morning every New Years Day, Valentines Night, Burns Night, St Davids Day, St Patricks Day, Halloween, Boxing Day, 27th, 28th & 30th December.

New Years Eve - from the end of permitted hours to commencement of permitted hours New Years Day

In the event of a transmission of any recognised international sporting event which falls outside the current permitted hours to permit the activity. Commencing 1 hour before the start of the event and ending 1 hour after the event has ended. Details of activity to be notified to the police 21 days beforehand.

The event will not proceed if the police serve 7 days prior to the event written notification upon the designated premises supervisor. The event will not proceed after the 7 day period if the police have intelligence that disorder is likely to occur and they notify the designated premises supervisor.

Section 15 of 21

SUPPLY OF ALCOHOL

Will you be selling or supplying alcohol?

☒ Yes

☐ No

Standard Days And Timings

Continued from previous page...

MONDAY

Start 10:00

End 00:00

Start

End

Give timings in 24 hour clock.
(e.g., 16:00) and only give details for the days
of the week when you intend the premises
to be used for the activity.

TUESDAY

Start 10:00

End 00:00

Start

End

WEDNESDAY

Start 10:00

End 00:00

Start

End

THURSDAY

Start 10:00

End 00:00

Start

End

FRIDAY

Start 10:00

End 00:00

Start

End

SATURDAY

Start 10:00

End 00:00

Start

End

SUNDAY

Start 10:00

End 00:00

Start

End

Will the sale of alcohol be for consumption:

☐ On the premises ☐ Off the premises ☒ Both

If the sale of alcohol is for consumption on
the premises select on, if the sale of alcohol
is for consumption away from the premises
select off. If the sale of alcohol is for
consumption on the premises and away
from the premises select both.

State any seasonal variations

For example (but not exclusively) where the activity will occur on additional days during the summer months.

n/a

Non-standard timings. Where the premises will be used for the supply of alcohol at different times from those listed in the column on the left, list below

Continued from previous page...

For example (but not exclusively), where you wish the activity to go on longer on a particular day e.g. Christmas Eve.

A further additional 2 hours every Christmas Eve

A further additional hour into the morning every Friday, Saturday, Sunday & Monday for each May, Spring/Whit & August Bank Holiday weekend and every Friday, Saturday, Sunday & Monday for Easter Weekend.

A further additional hour into the morning every New Years Day, Valentines Night, Burns Night, St Davids Day, St Patricks Day, Halloween, Boxing Day, 27th, 28th & 30th December.

New Years Eve - from the end of permitted hours to commencement of permitted hours New Years Day

In the event of a transmission of any recognised international sporting event which falls outside the current permitted hours to permit the activity. Commencing 1 hour before the start of the event and ending 1 hour after the event has ended. Details of activity to be notified to the police 21 days beforehand.

The event will not proceed if the police serve 7 days prior to the event written notification upon the designated premises supervisor. The event will not proceed after the 7 day period if the police have intelligence that disorder is likely to occur and they notify the designated premises supervisor.

State the name and details of the individual whom you wish to specify on the licence as premises supervisor

Name

First name

Family name

Date of birth / /
dd mm yyyy

Enter the contact's address

Building number or name

Street

District

City or town

County or administrative area

Postcode

Country

Personal Licence number (if known)

Issuing licensing authority (if known)

PROPOSED DESIGNATED PREMISES SUPERVISOR CONSENT

How will the consent form of the proposed designated premises supervisor be supplied to the authority?

Continued from previous page...

- ☐ Electronically, by the proposed designated premises supervisor
- ☒ As an attachment to this application

Reference number for consent form (if known)

If the consent form is already submitted, ask the proposed designated premises supervisor for its 'system reference' or 'your reference'.

Section 16 of 21

ADULT ENTERTAINMENT

Highlight any adult entertainment or services, activities, or other entertainment or matters ancillary to the use of the premises that may give rise to concern in respect of children

Give information about anything intended to occur at the premises or ancillary to the use of the premises which may give rise to concern in respect of children, regardless of whether you intend children to have access to the premises, for example (but not exclusively) nudity or semi-nudity, films for restricted age groups etc gambling machines etc.

None

Section 17 of 21

HOURS PREMISES ARE OPEN TO THE PUBLIC

Standard Days And Timings

MONDAY

Start 08:00

End 00:30

Start

End

Give timings in 24 hour clock. (e.g., 16:00) and only give details for the days of the week when you intend the premises to be used for the activity.

TUESDAY

Start 08:00

End 00:30

Start

End

WEDNESDAY

Start 08:00

End 00:30

Start

End

THURSDAY

Start 08:00

End 00:30

Start

End

FRIDAY

Start 08:00

End 00:30

Start

End

Continued from previous page...

SATURDAY

Start 08:00

End 00:30

Start

End

SUNDAY

Start 08:00

End 00:30

Start

End

State any seasonal variations

For example (but not exclusively) where the activity will occur on additional days during the summer months.

n/a

Non standard timings. Where you intend to use the premises to be open to the members and guests at different times from those listed in the column on the left, list below

For example (but not exclusively), where you wish the activity to go on longer on a particular day e.g. Christmas Eve.

A further additional 2 hours every Christmas Eve

A further additional hour into the morning every Friday, Saturday, Sunday & Monday for each May, Spring/Whit & August Bank Holiday weekend and every Friday, Saturday, Sunday & Monday for Easter Weekend.

A further additional hour into the morning every New Years Day, Valentines Night, Burns Night, St Davids Day, St Patricks Day, Halloween, Boxing Day, 27th, 28th & 30th December.

New Years Eve - from the end of permitted hours to commencement of permitted hours New Years Day

In the event of a transmission of any recognised international sporting event which falls outside the current permitted hours to permit the activity. Commencing 1 hour before the start of the event and ending 1 hour after the event has ended. Details of activity to be notified to the police 21 days beforehand.

The event will not proceed if the police serve 7 days prior to the event written notification upon the designated premises supervisor. The event will not proceed after the 7 day period if the police have intelligence that disorder is likely to occur and they notify the designated premises supervisor.

Section 18 of 21

LICENSING OBJECTIVES

Describe the steps you intend to take to promote the four licensing objectives:

a) General – all four licensing objectives (b,c,d,e)

List here steps you will take to promote all four licensing objectives together.

The information provided in this box is solely for information only and not intended to be converted into conditions on the licence.

The premises currently has a Premises licence already in force, however following consultation with a Licensing officer, due to the nature of the works, a New licence application is required.

Once this licence is granted and works complete, we shall then be in a position to surrender the current licence in force
(141 / 3)

Continued from previous page...

As the licence is a replication of the current licence hours and activities, we do not consider further steps will be required to promote the licensing objectives however the operating schedule is outdated and includes obsolete conditions and therefore a new operating schedule is proposed and is set out below which we feel is appropriate and proportionate to promote the licensing objectives.

We also note Stonegate Pub Company Ltd is a well experienced licensed operator with nearly 700 sites across the country, and have in place an extensive licensing manual detailing both company policies, appropriate across the whole estate, along with procedures in place at a local level to ensure the premises operates to the highest standard and promote the licensing objectives. These include policies regarding social responsibility and underage sales, which promote responsible drinking and discourage drunkenness, as well as procedures to prevent crime and disorder, and public nuisance. The robust policies and procedures that are in place will continue to operate, if the application is granted.

Considering the above, we believe the New Premises licence application will not undermine the licensing objectives. The applicant believes that the measures in place, will ensure the premises continue to promote the licensing objectives and the measures are adequate and further conditions are not appropriate.

b) The prevention of crime and disorder

Please see box a) above. In addition, the following new condition is proposed in the event that the application sought is granted:-

1. A CCTV system shall be installed at the premises and maintained in good working order and used at all times when the premises are open for licensable activities. Any CCTV footage shall be held for at least 28 days and shall be made available to an officer of the Licensing Authority or Police on reasonable request. (Check whether premises has CCTV)
2. Where Pubwatch exists covering the area of which the premises is situated then the DPS or other nominated employee shall participate in Pubwatch.
3. The need for door supervisors will be assessed by way of risk assessment and cognisance will be taken of any police advice.
4. The premises shall maintain a written drugs policy, which shall be made available to the Police or an authorised officer of the Council upon request.
5. An incident log book (which may be electronic) shall be kept on the premises and made available on request to an authorised officer of the Council or Police which will record the following:-
 - a. Any incidents of disorder
 - b. Any seizures of drugs or offensive weapons
 - c. Any ejections of patrons
6. The premises shall maintain a written dispersal policy, which shall be made available to the Police or an authorised officer of the Council upon request.

c) Public safety

We understand our obligations under existing legislation and take our responsibilities seriously.

d) The prevention of public nuisance

Please see box a) above. In addition, the following new condition is proposed in the event that the application sought is granted:-

1. Reasonable steps will be taken to recognise the rights of local residents and notices will be displayed at the premises exits

Continued from previous page...

requesting customers to leave quietly and reminding them that they are in a residential area

e) The protection of children from harm

Please see box a) above. In addition, the following new condition is proposed in the event that the application sought is granted:-

1. A proof of age scheme such as Challenge 21 will be operated at the premises where the only acceptable forms of identification are photographic identification cards such as a driving licence or passport.
2. A log (which may be electronic) shall be kept detailing all refused sales of alcohol. The log shall include the date and time of the refusal and the name of the member of staff who refused the sale. A copy of the log or electronic report shall be made available to an authorised police officer and licensing authority officer upon request.
3. All bar staff to receive appropriate training in relation to alcohol sales prior to commencing their duties. This will include the premise licence conditions, underage sales policy and other relevant licensing matters. Training documents (which may be in an electronic format) shall be made available to an authorised police officer and licensing authority officer upon request.

Section 19 of 21

NOTES ON DEMONSTRATING ENTITLEMENT TO WORK IN THE UK

Continued from previous page...

Entitlement to work/immigration status for individual applicants and applications from partnerships which are not limited liability partnerships:

A licence may not be held by an individual or an individual in a partnership who is resident in the UK who:

- does not have the right to live and work in the UK; or
- is subject to a condition preventing him or her from doing work relating to the carrying on of a licensable activity.

Any premises licence issued in respect of an application made on or after 6 April 2017 will become invalid if the holder ceases to be entitled to work in the UK.

Applicants must demonstrate that they have an entitlement to work in the UK and are not subject to a condition preventing them from doing work relating to the carrying on of a licensable activity. They do this by providing with this application copies or scanned copies of the following documents (which do not need to be certified).

Documents which demonstrate entitlement to work in the UK

- An expired or current passport showing the holder, or a person named in the passport as the child of the holder, is a British citizen or a citizen of the UK and Colonies having the right of abode in the UK [please see note below about which sections of the passport to copy].
- An expired or current passport or national identity card showing the holder, or a person named in the passport as the child of the holder, is a national of a European Economic Area country or Switzerland.
- A Registration Certificate or document certifying permanent residence issued by the Home Office to a national of a European Economic Area country or Switzerland.
- A Permanent Residence Card issued by the Home Office to the family member of a national of a European Economic Area country or Switzerland.
- A **current** Biometric Immigration Document (Biometric Residence Permit) issued by the Home Office to the holder indicating that the person named is allowed to stay indefinitely in the UK, or has no time limit on their stay in the UK.
- A **current** passport endorsed to show that the holder is exempt from immigration control, is allowed to stay indefinitely in the UK, has the right of abode in the UK, or has no time limit on their stay in the UK.
- A **current** Immigration Status Document issued by the Home Office to the holder with an endorsement indicating that the named person is allowed to stay indefinitely in the UK or has no time limit on their stay in the UK, **when produced in combination with** an official document giving the person's permanent National Insurance number and their name issued by a Government agency or a previous employer.
- A **full** birth or adoption certificate issued in the UK which includes the name(s) of at least one of the holder's parents or adoptive parents, **when produced in combination with** an official document giving the person's permanent National Insurance number and their name issued by a Government agency or a previous employer.
- A birth or adoption certificate issued in the Channel Islands, the Isle of Man or Ireland **when produced in combination with** an official document giving the person's permanent National Insurance number and their name issued by a Government agency or a previous employer.
- A certificate of registration or naturalisation as a British citizen, **when produced in combination with** an official document giving the person's permanent National Insurance number and their name issued by a Government agency or a previous employer.
- A **current** passport endorsed to show that the holder is allowed to stay in the UK and is currently allowed to work and is not subject to a condition preventing the holder from doing work relating to the carrying on of a licensable activity.

Continued from previous page...

- A **current** Biometric Immigration Document (Biometric Residence Permit) issued by the Home Office to the holder which indicates that the named person can currently stay in the UK and is allowed to work relation to the carrying on of a licensable activity.
- A **current** Residence Card issued by the Home Office to a person who is not a national of a European Economic Area state or Switzerland but who is a family member of such a national or who has derivative rights or residence.
- A **current** Immigration Status Document containing a photograph issued by the Home Office to the holder with an endorsement indicating that the named person may stay in the UK, and is allowed to work and is not subject to a condition preventing the holder from doing work relating to the carrying on of a licensable activity **when produced in combination with** an official document giving the person's permanent National Insurance number and their name issued by a Government agency or a previous employer.
- A Certificate of Application, **less than 6 months old**, issued by the Home Office under regulation 17(3) or 18A (2) of the Immigration (European Economic Area) Regulations 2006, to a person who is not a national of a European Economic Area state or Switzerland but who is a family member of such a national or who has derivative rights of residence.
- Reasonable evidence that the person has an outstanding application to vary their permission to be in the UK with the Home Office such as the Home Office acknowledgement letter or proof of postage evidence, or reasonable evidence that the person has an appeal or administrative review pending on an immigration decision, such as an appeal or administrative review reference number.
- Reasonable evidence that a person who is not a national of a European Economic Area state or Switzerland but who is a family member of such a national or who has derivative rights of residence in exercising treaty rights in the UK including:-
 - evidence of the applicant's own identity – such as a passport,
 - evidence of their relationship with the European Economic Area family member – e.g. a marriage certificate, civil partnership certificate or birth certificate, and
 - evidence that the European Economic Area national has a right of permanent residence in the UK or is one of the following if they have been in the UK for more than 3 months:
 - (i) working e.g. employment contract, wage slips, letter from the employer,
 - (ii) self-employed e.g. contracts, invoices, or audited accounts with a bank,
 - (iii) studying e.g. letter from the school, college or university and evidence of sufficient funds; or
 - (iv) self-sufficient e.g. bank statements.

Family members of European Economic Area nationals who are studying or financially independent must also provide evidence that the European Economic Area national and any family members hold comprehensive sickness insurance in the UK. This can include a private medical insurance policy, an EHIC card or an S1, S2 or S3 form.

Original documents must not be sent to licensing authorities. If the document copied is a passport, a copy of the following pages should be provided:-

- (i) any page containing the holder's personal details including nationality;
- (ii) any page containing the holder's photograph;
- (iii) any page containing the holder's signature;
- (iv) any page containing the date of expiry; and
- (v) any page containing information indicating the holder has permission to enter or remain in the UK and is permitted to work.

If the document is not a passport, a copy of the whole document should be provided.

Your right to work will be checked as part of your licensing application and this could involve us checking your immigration status with the Home Office. We may otherwise share information with the Home Office. Your licence application will not be determined until you have complied with this guidance.

Section 20 of 21

NOTES ON REGULATED ENTERTAINMENT

Continued from previous page...

In terms of specific **regulated entertainments** please note that:

- Plays: no licence is required for performances between 08:00 and 23.00 on any day, provided that the audience does not exceed 500.
- Films: no licence is required for 'not-for-profit' film exhibition held in community premises between 08.00 and 23.00 on any day provided that the audience does not exceed 500 and the organiser (a) gets consent to the screening from a person who is responsible for the premises; and (b) ensures that each such screening abides by age classification ratings.
- Indoor sporting events: no licence is required for performances between 08.00 and 23.00 on any day, provided that the audience does not exceed 1000.
- Boxing or Wrestling Entertainment: no licence is required for a contest, exhibition or display of Greco-Roman wrestling, or freestyle wrestling between 08.00 and 23.00 on any day, provided that the audience does not exceed 1000. Combined fighting sports – defined as a contest, exhibition or display which combines boxing or wrestling with one or more martial arts – are licensable as a boxing or wrestling entertainment rather than an indoor sporting event.
- Live music: no licence permission is required for:
 - o a performance of unamplified live music between 08.00 and 23.00 on any day, on any premises.
 - o a performance of amplified live music between 08.00 and 23.00 on any day on premises authorised to sell alcohol for consumption on those premises, provided that the audience does not exceed 500.
 - o a performance of amplified live music between 08.00 and 23.00 on any day, in a workplace that is not licensed to sell alcohol on those premises, provided that the audience does not exceed 500.
 - o a performance of amplified live music between 08.00 and 23.00 on any day, in a church hall, village hall, community hall, or other similar community premises, that is not licensed by a premises licence to sell alcohol, provided that (a) the audience does not exceed 500, and (b) the organiser gets consent for the performance from a person who is responsible for the premises.
 - o a performance of amplified live music between 08.00 and 23.00 on any day, at the non-residential premises of (i) a local authority, or (ii) a school, or (iii) a hospital, provided that (a) the audience does not exceed 500, and (b) the organiser gets consent for the performance on the relevant premises from: (i) the local authority concerned, or (ii) the school or (iii) the health care provider for the hospital.
- Recorded Music: no licence permission is required for:
 - o any playing of recorded music between 08.00 and 23.00 on any day on premises authorised to sell alcohol for consumption on those premises, provided that the audience does not exceed 500.
 - o any playing of recorded music between 08.00 and 23.00 on any day, in a church hall, village hall, community hall, or other similar community premises, that is not licensed by a premises licence to sell alcohol, provided that (a) the audience does not exceed 500, and (b) the organiser gets consent for the performance from a person who is responsible for the premises.
 - o any playing of recorded music between 08.00 and 23.00 on any day, at the non-residential premises of (i) a local authority, or (ii) a school, or (iii) a hospital, provided that (a) the audience does not exceed 500, and (b) the organiser gets consent for the performance on the relevant premises from: (i) the local authority concerned, or (ii) the school proprietor or (iii) the health care provider for the hospital.

Continued from previous page...

- Dance: no licence is required for performances between 08.00 and 23.00 on any day, provided that the audience does not exceed 500. However, a performance which amounts to adult entertainment remains licensable.
- Cross activity exemptions: no licence is required between 08.00 and 23.00 on any day, with no limit on audience size for:
 - o any entertainment taking place on the premises of the local authority where the entertainment is provided by or on behalf of the local authority;
 - o any entertainment taking place on the hospital premises of the health care provider where the entertainment is provided by or on behalf of the health care provider;
 - o any entertainment taking place on the premises of the school where the entertainment is provided by or on behalf of the school proprietor; and
 - o any entertainment (excluding films and a boxing or wrestling entertainment) taking place at a travelling circus, provided that (a) it takes place within a moveable structure that accommodates the audience, and (b) that the travelling circus has not been located on the same site for more than 28 consecutive days.

Section 21 of 21

PAYMENT DETAILS

This fee must be paid to the authority. If you complete the application online, you must pay it by debit or credit card.

Premises Licence Fees are determined by the non-domestic rateable value of the premises.

To find out a premises non domestic rateable value go to the Valuation Office Agency site at http://www.voa.gov.uk/business_rates/index.htm

Band A - No RV to £4300 £100.00

Band B - £4301 to £33000 £190.00

Band C - £33001 to £87000 £315.00

Band D - £87001 to £125000 £450.00*

Band E - £125001 and over £635.00*

*If the premises rateable value is in Bands D or E and the premises is primarily used for the consumption of alcohol on the premises then you are required to pay a higher fee

Band D - £87001 to £125000 £900.00

Band E - £125001 and over £1,905.00

There is an exemption from the payment of fees in relation to the provision of regulated entertainment at church halls, chapel halls or premises of a similar nature, village halls, parish or community halls, or other premises of a similar nature. The costs associated with these licences will be met by central Government. If, however, the licence also authorises the use of the premises for the supply of alcohol or the provision of late night refreshment, a fee will be required.

Schools and sixth form colleges are exempt from the fees associated with the authorisation of regulated entertainment where the entertainment is provided by and at the school or college and for the purposes of the school or college.

If you operate a large event you are subject to ADDITIONAL fees based upon the number in attendance at any one time

Capacity 5000-9999 £1,000.00

Capacity 10000 -14999 £2,000.00

Capacity 15000-19999 £4,000.00

Capacity 20000-29999 £8,000.00

Capacity 30000-39999 £16,000.00

Capacity 40000-49999 £24,000.00

Capacity 50000-59999 £32,000.00

Capacity 60000-69999 £40,000.00

Capacity 70000-79999 £48,000.00

Capacity 80000-89999 £56,000.00

Capacity 90000 and over £64,000.00

* Fee amount (£)

315.00

DECLARATION

1

Continued from previous page...

I/WE UNDERSTAND IT IS AN OFFENCE, UNDER SECTION 158 OF THE LICENSING ACT 2003, TO MAKE A FALSE STATEMENT
* IN OR IN CONNECTION WITH THIS APPLICATION. THOSE WHO MAKE A FALSE STATEMENT MAY BE LIABLE ON SUMMARY
CONVICTION TO A FINE OF ANY AMOUNT.

I/WE UNDERSTAND IT IS AN OFFENCE UNDER SECTION 24B OF THE IMMIGRATION ACT 1971 FOR A PERSON TO WORK
WHEN THEY KNOW, OR HAVE REASONABLE CAUSE TO BELIEVE, THAT THEY ARE DISQUALIFIED FROM DOING SO BY
REASON OF THEIR IMMIGRATION STATUS. THOSE WHO EMPLOY AN ADULT WITHOUT LEAVE OR WHO IS SUBJECT TO
* CONDITIONS AS TO EMPLOYMENT WILL BE LIABLE TO A CIVIL PENALTY UNDER SECTION 15 OF THE IMMIGRATION,
ASYLUM AND NATIONALITY ACT 2006 AND PURSUANT TO SECTION 21 OF THE SAME ACT, WILL BE COMMITTING AN
OFFENCE WHERE THEY DO SO IN THE KNOWLEDGE, OR WITH REASONABLE CAUSE TO BELIEVE, THAT THE EMPLOYEE IS
DISQUALIFIED.

☒ Ticking this box indicates you have read and understood the above declaration

This section should be completed by the applicant, unless you answered "Yes" to the question "Are you an agent acting on behalf of the applicant?"

* Full name

* Capacity

* Date / /
dd mm yyyy

Once you're finished you need to do the following:

1. Save this form to your computer by clicking file/save as...
2. Go back to <https://www.gov.uk/apply-for-a-licence/premises-licence/birmingham/apply-1> to upload this file and continue with your application.

Don't forget to make sure you have all your supporting documentation to hand.

IT IS AN OFFENCE LIABLE TO SUMMARY CONVICTION TO A FINE OF ANY AMOUNT UNDER SECTION 158 OF THE LICENSING ACT 2003, TO MAKE A FALSE STATEMENT IN OR IN CONNECTION WITH THIS APPLICATION

IT IS AN OFFENCE UNDER SECTION 24B OF THE IMMIGRATION ACT 1971 FOR A PERSON TO WORK WHEN THEY KNOW, OR HAVE REASONABLE CAUSE TO BELIEVE, THAT THEY ARE DISQUALIFIED FROM DOING SO BY REASON OF THEIR IMMIGRATION STATUS. THOSE WHO EMPLOY AN ADULT WITHOUT LEAVE OR WHO IS SUBJECT TO CONDITIONS AS TO EMPLOYMENT WILL BE LIABLE TO A CIVIL PENALTY UNDER SECTION 15 OF THE IMMIGRATION, ASYLUM AND NATIONALITY ACT 2006 AND PURSUANT TO SECTION 21 OF THE SAME ACT, WILL BE COMMITTING AN OFFENCE WHERE THEY DO SO IN THE KNOWLEDGE, OR WITH REASONABLE CAUSE TO BELIEVE, THAT THE EMPLOYEE IS DISQUALIFIED

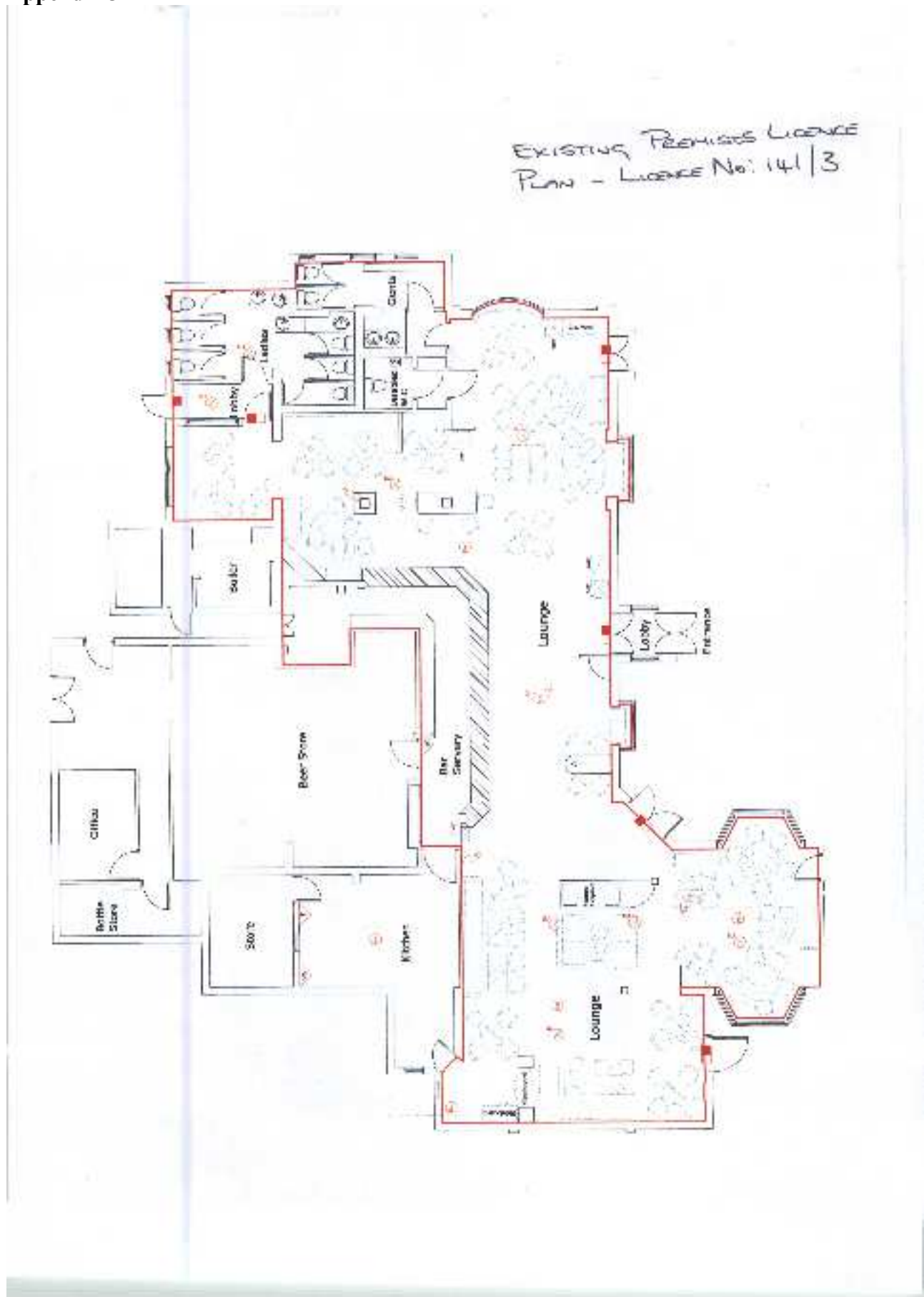

BIRMINGHAM CITY COUNCIL

LICENSING ACT 2003PREMISES LICENCE

Premises Licence Number:

141 / 3

Part 1 - Premises details:

Postal address of premises, or if none, Ordnance Survey map reference or description

The Digby
911 Chester Road
Edlington

Post town:

Birmingham

Post Code:

B24 0HJ

Telephone Number:

0121 303 4931

Where the licence is time limited the dates

N/A

Licensable activities authorised by the licence

B Time
F Recorded music
L Late night refreshment
M3 Sale of alcohol by retail (both on & off the premises)

The times the licence authorises the carrying out of licensable activities

Monday - Sunday	00:00 - 23:59	F
	10:00 - 00:00	B, M3
	23:00 - 00:00	

A further additional 2 hours every Christmas Eve

A1

A further additional hour into the morning every Friday, Saturday, Sunday & Monday for each May, Spring/Whit & August Bank Holiday weekend & every Friday, Saturday, Sunday & Monday for Easter weekend.

A1

A further additional hour into the morning every New Year's Day, Valentine's Night, Burns Night, St David's Day, St Patrick's Day, Halloween, Boxing Day, 27th, 28th & 30th December, New Year's Eve - from end of permitted hours to commencement of permitted hours New Year's Day.

A1

Page 1 of 2

Birmingham City Council, Licensing Section, P.O. Box 17013, Birmingham, B6 9EE

BIRMINGHAM CITY COUNCIL

<p>In the event of a transmission of any recognised international sporting event which falls outside the current permitted hours to permit the activity. Commencing 1 hour before the start of the event and ending 1 hour after the event has ended. Details of the activity to be notified to the police 21 days beforehand.</p>	<p>All</p>
<p>The event will not proceed if the police serve 7 days prior to the event when notification upon the designated premises supervisor. The event will not proceed after the 7 day period if the police have intelligence that disorder is likely to occur and may notify the designated premises supervisor</p>	<p>All</p>
<p>The opening hours of the premises</p> <p>Monday - Sunday 08.00 - 00.00</p> <p>N.B opening hours may be extended to reflect any such extension of the permitted times for licensable activities as are detailed above.</p>	
<p>Where the licence authorises supplies of alcohol whether these are on and/or off supplies</p> <p>On and Off Supplies</p>	

BIRMINGHAM CITY COUNCIL

Part 2

Name, (registered) address, telephone number and email (where relevant) of holder of premises licence Stringzoo Pub Company Limited Porter Inn House 500 Capability Green	
Post town: Lutter	Post Code: LU1 3LS
Telephone Number: Not Specified	
Email N/A	
Registered number of holder for example company number or charity number (where applicable) FC029633	
Name, address, telephone number of designated premises supervisor where the premises licence authorises for the supply of alcohol Yvonne Gillox The Digby 811 Chester Road	
Post town: Birmingham	Post Code: B24 3HL
Telephone Number: N/A	
Personal licence number and issuing authority of personal licence held by designated premises supervisor where the premises licence authorises for the supply of alcohol	
Licence Number 1842	Issuing Authority BIRMINGHAM CITY COUNCIL

Dated 14/12/2012



David Kennedy
 Principal Licensing Officer
 For Director of Regulation and Enforcement

Annex 1 – Mandatory Conditions

No supply of alcohol may be made under the premises licence (s) at a time when there is no designated premises supervisor in respect of the premises licence, or (b) at a time when the designated premises supervisor does not hold a personal licence or his personal licence is suspended.

Every retail sale or supply of alcohol made under this licence must be made or authorised by a person who holds a personal licence.

The responsible person must ensure that staff on relevant premises do not carry out, arrange or participate in any irresponsible promotions in relation to the premises. In this paragraph, an irresponsible promotion means any one or more of the following activities, or substantially similar activities, carried on for the purpose of encouraging the sale or supply of alcohol for consumption on the premises— (a) games or other activities which require or encourage, or are designed to require or encourage, individuals to— (i) drink a quantity of alcohol within a time limit (other than to drink alcohol sold or supplied on the premises before the cessation of the period in which the responsible person is authorised to sell or supply alcohol), or (ii) drink as much alcohol as possible (whether within a time limit or otherwise); (b) provision of unlimited or unspecified quantities of alcohol free or for a fixed or discounted fee to the public or to a group defined by a particular characteristic in a manner which carries a significant risk of undermining a licensing objective; (c) provision of free or discounted alcohol or any other thing as a prize to encourage or reward the purchase and consumption of alcohol over a period of 24 hours or less in a manner which carries a significant risk of undermining a licensing objective; (d) selling or supplying alcohol in association with promotional posters or flyers on, or in the vicinity of, the premises which can reasonably be considered to condone, encourage or glamorise anti-social behaviour or to refer to the effects of drunkenness in any favourable manner; (e) dispensing alcohol directly by one person into the mouth of another (other than where that other person is unable to drink without assistance by reason of disability).

The responsible person must ensure that free potable water is provided on request to customers where it is reasonably available.

The premises licence holder or club premises certificate holder must ensure that an age verification policy is adopted in respect of the premises in relation to the sale or supply of alcohol. The designated premises supervisor in relation to the premises licence must ensure that the supply of alcohol at the premises is carried on in accordance with the age verification policy. The policy must require individuals who appear to the responsible person to be under 18 years of age (or such older age as may be specified in the policy) to produce on request, before being served alcohol, identification bearing their photograph, date of birth and either— (a) a holographic mark, or (b) an ultraviolet feature.

The responsible person must ensure that— (a) where any of the following alcoholic drinks is sold or supplied for consumption on the premises (other than alcoholic drinks sold or supplied having been made up in advance ready for sale or supply in a securely closed container) it is available to customers in the following measures— (i) beer or cider, ½ pint; (ii) gin, rum, vodka or whisky, 25 ml or 35 ml; and (iii) still wine in a glass, 125 ml; (b) these measures are displayed in a menu, price list or other printed material which is available to customers on the premises; and (c) where a customer does not in relation to a sale of alcohol specify the quantity of alcohol to be sold, the customer is made aware that these measures are available.*

(1) A relevant person shall ensure that no alcohol is sold or supplied for consumption on or off the premises for a price which is less than the permitted price. (2) In this condition: (a) "permitted price" is the price found by applying the formula $P = D + (D \times V)$, where— (i) P is the permitted price, (ii) D is the amount of duty chargeable in relation to the alcohol as if the duty were charged on the date of the sale or supply of the alcohol, and (iii) V is the rate of value added tax chargeable in relation to the alcohol as if the value added tax were charged on the date of the sale or supply of the alcohol; (b) "duty" is to be construed in accordance with the Alcoholic Liquor Duties Act 1978; (c) "relevant person" means, in relation to premises in respect of which there is a premises licence— (i) the holder of the premises licence, (ii) the designated premises supervisor (if any) in respect of such a licence, or (iii) the personal licence holder who makes or authorises a supply of alcohol under such a licence; (d) "relevant person" means, in relation to premises in respect of which there is in force a club premises certificate, any member or officer of the club present on the premises in a capacity which enables the member or officer to prevent the supply in question; and (e) "value added tax" means value added tax charged in accordance with the Value Added Tax Act 1994. (3) Where

BIRMINGHAM CITY COUNCIL

the permitted price would not be a whole number of pence, the permitted price shall be taken to be the price rounded up to the nearest penny. (4) Where the permitted price on a day ("the first day") would be different from the permitted price on the next day ("the second day") as a result of a change to the rate of duty or value added tax, the permitted price which would apply on the first day applies to sales or supplies of alcohol which take place before the expiry of the period of 14 days beginning on the second day.

The admission of children under the age of 18 to film exhibitions permitted under the terms of the licence shall be restricted in accordance with any recommendation made: (a) By the British Board of Film Classification (BBFC) where the film has been classified by that Board; or (b) By the Licensing Authority where no classification certificate has been granted by the BBFC, or, where the licensing authority has notified the licence holder that section 20(3)(b) (s/4(3)(b) for clubs) of the Licensing Act 2003 applies to the film.

Each individual assigned to carrying out a security activity must be licensed by the Security Industry Agency.

BIRMINGHAM CITY COUNCIL

Annex 2 – Conditions consistent with operating schedule

2a) General conditions consistent with the operating schedule

Regulated entertainment is permitted to take place inside the premises only.

The licensee will ensure that staff are trained in the standards required by the relevant legislation and as required by company policy.

The voluntary closure policy for the operation of these premises is 30 minutes after the approved closure time for the supply of alcohol.

2b) Conditions consistent with, and to promote the prevention of crime and disorder

The pub manager is required to actively participate in and support the local Pubwatch scheme (where active).

The licensee will ensure that text and/or radio pagers, where already used will continue to be used on the premises during the hours of operation.

Existing CCTV system will continue to operate during the hours of operation.

The licensee will ensure that there will be no promotions that encourage illegal, irresponsible or immoderate consumption of alcohol.

2c) Conditions consistent with, and to promote, public safety

The licensee will extend existing policies to cover the increase in hours of operation.

The licensee will ensure internal health and safety due diligence and incident reporting system will continue to operate during the additional times.

2d) Conditions consistent with, and to promote the prevention of public nuisance

The licensee must where necessary implement reasonable steps to recognise the rights of local residents and encourage customers to leave the premises quietly.

The manager is required to liaise with local neighbours as part of their duties and resolve any reasonable concerns.

2e) Conditions consistent with, and to promote the protection of children from harm

The licensee will promote the protection of children from harm through a commitment to health and safety in the operation and maintenance of the premises.

The licensee will promote the protection of children from harm through an approach to managing the risk of under-age drinking.

No adult entertainment is permitted at the premises.

Staff are not allowed to be in sole supervision of children.

BIRMINGHAM CITY COUNCIL

Annex 3 - Conditions attached after hearing by licensing authority

3a) General committee conditions

N/A

3b) Committee conditions to promote the prevention of crime and disorder

N/A

3c) Committee conditions to promote public safety

N/A

3d) Committee conditions to promote the prevention of public nuisance

N/A

3e) Committee conditions to promote the protection of children from harm

N/A

BIRMINGHAM CITY COUNCIL

Annex 4 – Plans

The plan of the premises with reference number 78950-141/3 which is retained with the public register kept by Birmingham City Council and available free of charge for inspection by appointment only. Please ring the Licensing Section on 0121 353 6036 to book an appointment.

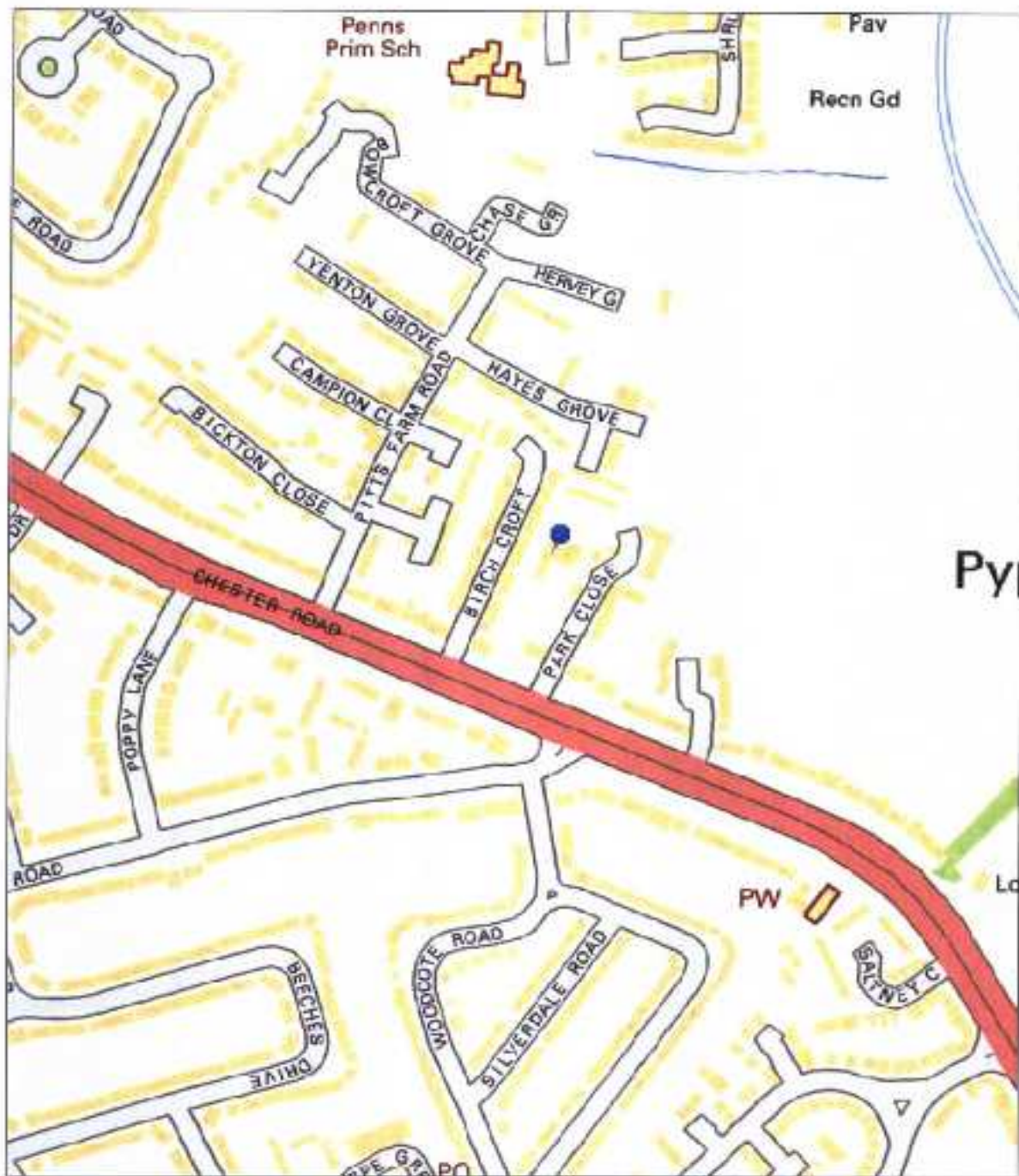

Birmingham City Council

Map Created By:

Notes

Date of Map Creation: 14/08/2017



Scale:
1:4,000

(c) Crown copyright. All rights reserved. Birmingham City Council 100321326 (2016).
You are not permitted to copy, sub-licence, distribute or sell any of this data to third parties in any form.
(c) GeoPerspectives, supplied by Bluesky International Ltd
Other Data used is provided to The GeoInformation Centre 2016 and Crown Copyright © All rights reserved.

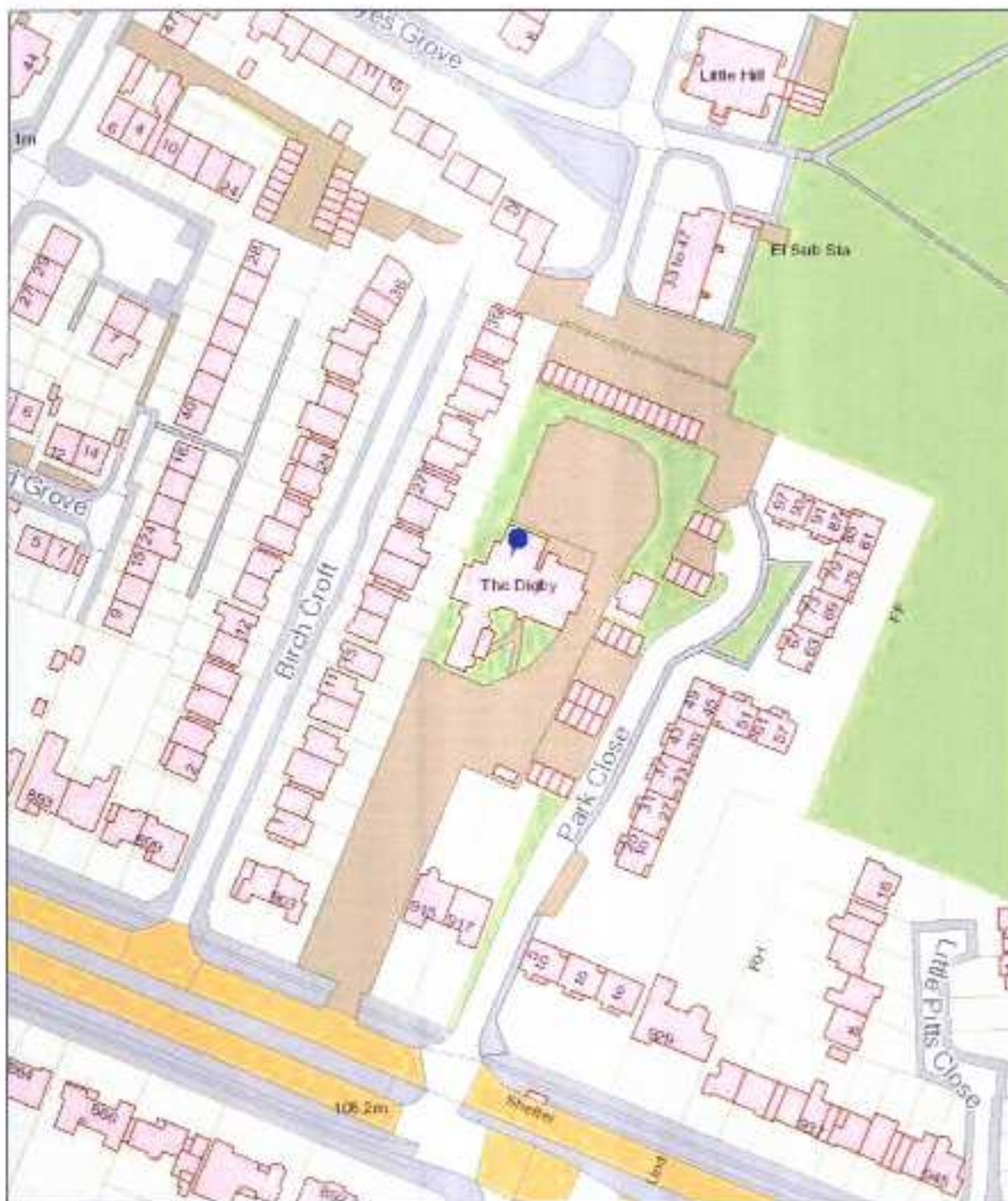

Birmingham City Council Map Created By:

Notes

Date of Map Creation: 14/08/2017



Scale:
1:1,250

(c) Crown copyright. All rights reserved. Birmingham City Council 100021326 (2016).
You are not permitted to copy, sub-licence, distribute or sell any of this data to third parties in any form.
(c) GeoPerspectives, supplied by Bluesky International Ltd
Other: Downloaded from copyright for The GeoInformation Group 2014 and Crown Copyright 2014. All rights reserved.

