

BIRMINGHAM CITY COUNCIL

PUBLIC REPORT

Report to:	Licensing Sub Committee B
Report of:	Acting Director of Regulation & Enforcement
Date of Meeting:	Tuesday 19th April 2016
Subject:	Licensing Act 2003 Premises Licence – Grant
Premises:	Euro Express, 1851b Pershore Road, Cotteridge, Birmingham, B30 3DJ
Ward affected:	Bournville
Contact Officer:	David Kennedy, Principal Licensing Officer, 0121 303 9896, licensing@birmingham.gov.uk

1. Purpose of report:

To consider relevant representations that have been made in respect of an application for a Premises Licence which initially sought to permit the Sale of Alcohol (for consumption off the premises only) to operate from 07:00am until 12:00midnight (Sunday to Thursday) and 07:00am until 01:00am (Friday and Saturday).

Premises to remain open to the public from 07:00am until 12:00midnight (Sunday to Thursday) and 07:00am until 01:00am (Friday and Saturday).

Following discussions with West Midlands Police the applicant has modified their application which now seeks to permit the Sale of Alcohol, to operate from 07:00am until 11:00pm (Monday to Sunday) and for the premises to remain open to the public from 07:00am until 11:00pm (Monday to Sunday).

2. Recommendation:

To consider the representations that have been made and to determine the application.

3. Brief Summary of Report:

An application for a Premises Licence was received on 19th February 2016 in respect of Euro Express, 1851b Pershore Road, Cotteridge, Birmingham B30 3DJ.

Representations have been received from other persons.

4. Compliance Issues:

4.1 Consistency with relevant Council Policies, Plans or Strategies:

The report complies with the City Council's Statement of Licensing Policy and the Council's Corporate Plan to improve the standard of all licensed persons, premises and vehicles in the City.

<p>5. Relevant background/chronology of key events:</p> <p>Alireza Nazmiyeh applied on 19th February 2016 for the grant of a Premises Licence for Euro Express, 1851b Pershore Road, Cotteridge, Birmingham B30 3DJ.</p> <p>Representations have been received from other persons. See Appendices 1 & 2.</p> <p>The application is attached at Appendix 3.</p> <p>Conditions have been agreed with West Midlands Police and the applicant, which are attached at Appendix 4.</p> <p>Conditions have been agreed with Birmingham City Council Licensing Enforcement and the applicant, which are attached at Appendix 5.</p> <p>Site Location Plans at Appendix 6.</p> <p>When carrying out its licensing functions, a licensing authority must have regard to Birmingham City Council's Statement of Licensing Policy and the Guidance issued by the Secretary of State under s182 of the Licensing Act 2003. The Licensing Authority is also required to take such steps as it considers appropriate for the promotion of the licensing objectives, which are:-</p> <ul style="list-style-type: none"> a. The prevention of crime and disorder; b. Public safety; c. The prevention of public nuisance; and d. The protection of children from harm.
<p>6. List of background documents:</p> <p>Copy of the representations as detailed in Appendices 1 & 2</p> <p>Application Form, Appendix 3</p> <p>Conditions agreed with West Midlands Police, Appendix 4</p> <p>Conditions agreed with Birmingham City Council Licensing Enforcement, Appendix 5</p> <p>Site Location Plans, Appendix 6</p>
<p>7. Options available</p> <p>To Grant the licence in accordance with the application.</p> <p>To Reject the application.</p> <p>To Grant the licence subject to conditions modified to such an extent as considered appropriate.</p> <p>Exclude from the licence any of the licensable activities to which the application relates.</p> <p>Refuse to specify a person in the licence as the premises supervisor.</p>

From:
Sent: 17 March 2016 23:26
To: Licensing
Cc:
Subject: Objection against application for license to sell alcohol by Euro Express, 1851b Pershore Road, Cotteridge, Birmingham, B30

Dear Sir/Madame,

My reasons are based on the personal experiences of myself, my family and tenants that I act as an agent for.

Since 2007 there has been over a **75% rise** in off-license premises in Cotteridge. During this period, I have witnessed a continued deterioration in the local environment as a direct result of easier access to alcohol. The situation was historically bad beforehand with the need to introduce an Alcohol Exclusion Zone in 2005 across a large swathe of Cotteridge.

There have been repeated acts of vandalism on the street I live in - much of it fuelled by alcohol. My own car was damaged in 2010, causing over £100 of damage that I had to pay for myself. I was later told that a couple of drunken men had walked the length of Midland Road kicking wing mirrors off cars, causing over £1000 worth of damage.

As an agent for properties in Cotteridge (Watford Road), I have had to repeatedly confront drunken men urinating at the rear of the properties. I most recently confronted a man in December 2015 who was drunk and urinating against a wall. He ignored my reasonable request and became abusive and threatening. All tenants, including tenants with young children, have complained to me about drunken men urinating in front of them. I have recently (26 February 2016) found bottles of urine left at the rear of the property with a bag of human faeces. We have food units operating from Watford Road and this presents a clear and present threat to public health in Cotteridge.

In December 2013 I witnessed a drunken man urinating against a flat doorway during daylight hours 20 metres away from 1851b Pershore Road when there were children around. Between March and September we have gangs openly drinking in Cotteridge centre throughout the week. I have also witnessed men lying unconscious near the Co-op store in Pershore Road (not customers of the Coop I may add). I was almost vomited on by a drunk holding a can of strong lager at 12.15pm on the 16 March 2014 at Kings Norton Station.

I am a parent of a 16 year old daughter and I do not feel comfortable with her walking through the area at any time of day now due to anti-social behaviour by men who have been drinking.

I have several photographs of discarded alcohol tins in bus shelters, broken and discarded glass bottles on the pavements and in the roads, vomit and occasionally blood on the ground. I witness this regularly on the way to work in the morning when children are walking to Cotteridge Junior and Infants School and other local schools; Cotteridge is a transport hub for several schools and colleges. Indeed, I walked through broken glass on the pavement at the end of Midland Road (junction with Pershore Road) this morning. With the proposed operating hour of 7am for 6 days of the week this proposed shop will act as a magnet to problem drinkers two hours before schools even open. In terms of underage drinking, I have personally witnessed adults buying alcohol for children in Cotteridge. My family also witnessed repeated underage drinking in Cotteridge Park during the summer of 2015 with young girls screaming and urinating at the bottom of our garden.

We have also had two benches removed from locations in Cotteridge in 2013 due to the congregation of people drinking and being abusive. One bench was removed from outside the former Neighbourhood Office and a bench was removed from Kings Norton Railway Station for the same reason. With many elderly and disabled people living in Cotteridge (a large sheltered housing scheme is located just 75 metres from 1851b Pershore Road) this has made the local area far less accessible. An increase in aggressive begging over the last three years has also made the local environment more threatening - particularly for vulnerable people. Many people begging in Cotteridge have alcohol problems.

I personally invite the Licensing Committee and Licensing staff to Cotteridge to show them at first hand the impact of easily available alcohol and to introduce them to people whose lives are being blighted by anti-social behaviour caused by alcohol abuse.

Kind regards

Midland Road
 Cotteridge
 Birmingham
 B30

Appendix 2

**The Ex Service Men's Memorial Institute
(Kings Norton Area) Ltd.**

Reg. Office: 1853a Pershore Road, Cotteridge, Birmingham, B30 3DJ

Reg. No. 8494 R. Wor.

Planning Application? 1851B Pershore road

I have been requested by the above management committee to submit our objections to planning application by Euro Express for the following reasons.

1 : For many years now we have had anti social behaviour with alcoholics' and drug users at the rear of these premises, after many complaints from residents of Midland road, the city council introduced 3 steel gates and fencing to try and reduce anti social behaviour and crime, suite keys have been issued to Midland road residents also ourselves. We still have problems with people drinking and syringes at the rear of William Hills 1855 Pershore road, resulting in community police being called at regular intervals.

2 : We have regular problems with parking on the entrance road to the above club resulting in club members – delivery vehicles - guests and visiting teams unable to gain access to the clubs car park, resulting in arguments – sometimes fighting resulting in the police being called because no parking available. At the times of opening times proposed by this application we have William Hill – Spice Exchange 1849 and Cotteridge Social customers opposite all struggling for parking spaces. So where would customers of this shop park and load their vehicles ?.

3 : Last but not least we have 5 alcohol dispensers already within 300 yards of this application. An outdoor 1825 Pershore Road – Spar (24 hr) – CO-Op supermarket - newsagents corner of Rowheath Road and the recently approved outlet next to the CO-OP store. Surely this is more than enough.

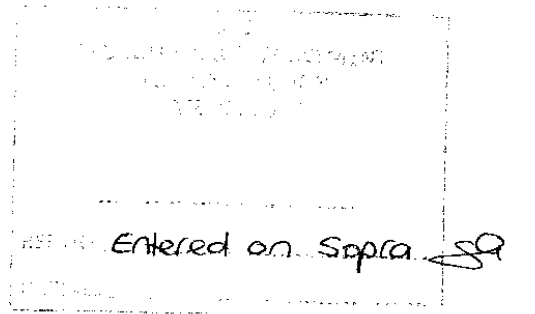

94965
19/2/16 - 18/3/16

Birmingham
Application for a premises licence
Licensing Act 2003

For help contact
licensingonline@birmingham.gov.uk
 Telephone: 0121 303 9896

* required information

Section 1 of 19

You can save the form at any time and resume it later. You do not need to be logged in when you resume.

System reference

Not Currently In Use

This is the unique reference for this application generated by the system.

Your reference

You can put what you want here to help you track applications if you make lots of them. It is passed to the authority.

Are you an agent acting on behalf of the applicant?

☒ Yes

☐ No

Put "no" if you are applying on your own behalf or on behalf of a business you own or work for.

Applicant Details

* First name

Alireza

* Family name

Nazmiyeh

* E-mail

pmblicensing

Main telephone number

Include country code.

Other telephone number

☐ Indicate here if the applicant would prefer not to be contacted by telephone

Is the applicant:

☐ Applying as a business or organisation, including as a sole trader

☒ Applying as an individual

A sole trader is a business owned by one person without any special legal structure. Applying as an individual means the applicant is applying so the applicant can be employed, or for some other personal reason, such as following a hobby.

Continued from previous page...

Address

* Building number or name	1851b
* Street	Pershore Road
District	
* City or town	Cotteridge
County or administrative area	
* Postcode	B30 3DJ
* Country	United Kingdom

Agent Details

* First name	PATRICK	
* Family name	BURKE	
* E-mail	pmblicensing	
Main telephone number		Include country code.
Other telephone number		

☐ Indicate here if you would prefer not to be contacted by telephone

Are you:

- ☒ An agent that is a business or organisation, including a sole trader
☐ A private individual acting as an agent

A sole trader is a business owned by one person without any special legal structure.

Agent Business

- * Is your business registered in the UK with Companies House? ☐ Yes ☒ No
* Is your business registered outside the UK? ☐ Yes ☒ No

* Business name	PMB LICENSING
* VAT number	- NONE
* Legal status	Sole Trader
* Your position in the business	PROPIETOR
Home country	United Kingdom

If your business is registered, use its registered name.

Put "none" if you are not registered for VAT.

The country where the headquarters of your business is located.

Continued from previous page...

Agent Business Address

If you have one, this should be your official address - that is an address required of you by law for receiving communications.

* Building number or name	DOG AND PARTRIDGE
* Street	136 HIGH STREET
District	BRIERLEY HILL
* City or town	DUDLEY
County or administrative area	WEST MIDLANDS
* Postcode	DY5 3BP
* Country	United Kingdom

Section 2 of 19

PREMISES DETAILS

I/we, as named in section 1, apply for a premises licence under section 17 of the Licensing Act 2003 for the premises described in section 2 below (the premises) and I/we are making this application to you as the relevant licensing authority in accordance with section 12 of the Licensing Act 2003.

Premises Address

Are you able to provide a postal address, OS map reference or description of the premises?

☒ Address ☐ OS map reference ☐ Description

Postal Address Of Premises

Building number or name	Euro Express
Street	1851b Pershore Road
District	
City or town	Cotteridge
County or administrative area	
Postcode	B30 3DJ
Country	United Kingdom

Further Details

Telephone number	
Non-domestic rateable value of premises (£)	5,300

Section 3 of 19**APPLICATION DETAILS**

In what capacity are you applying for the premises licence?

- ☒ An individual or individuals
- ☐ A limited company
- ☐ A partnership
- ☐ An unincorporated association
- ☐ A recognised club
- ☐ A charity
- ☐ The proprietor of an educational establishment
- ☐ A health service body
- ☐ A person who is registered under part 2 of the Care Standards Act 2000 (c14) in respect of an independent hospital in Wales
- ☐ A person who is registered under Chapter 2 of Part 1 of the Health and Social Care Act 2008 in respect of the carrying on of a regulated activity (within the meaning of that Part) in an independent hospital in England
- ☐ The chief officer of police of a police force in England and Wales
- ☐ Other (for example a statutory corporation)

Confirm The Following

- ☒ I am carrying on or proposing to carry on a business which involves the use of the premises for licensable activities
- ☐ I am making the application pursuant to a statutory function
- ☐ I am making the application pursuant to a function discharged by virtue of Her Majesty's prerogative

Section 4 of 19**INDIVIDUAL APPLICANT DETAILS****Applicant Name**

Is the name the same as (or similar to) the details given in section one?

☒ Yes

☐ No

If "Yes" is selected you can re-use the details from section one, or amend them as required. Select "No" to enter a completely new set of details.

First name

Alireza

Family name

Nazmiyeh

Is the applicant 18 years of age or older?

☒ Yes

☐ No

Continued from previous page...

Applicant Postal Address

Is the address the same as (or similar to) the address given in section one?

☒ Yes

☐ No

If "Yes" is selected you can re-use the details from section one, or amend them as required. Select "No" to enter a completely new set of details.

Building number or name	<input type="text" value="1851b"/>
Street	<input type="text" value="Persore Road"/>
District	<input type="text"/>
City or town	<input type="text" value="Cotteridge"/>
County or administrative area	<input type="text"/>
Postcode	<input type="text" value="B30 3DJ"/>
Country	<input type="text" value="United Kingdom"/>

Applicant Contact Details

Are the contact details the same as (or similar to) those given in section one?

☒ Yes

☐ No

If "Yes" is selected you can re-use the details from section one, or amend them as required. Select "No" to enter a completely new set of details.

E-mail	<input type="text" value="pmblicensing@"/>
Telephone number	<input type="text"/>
Other telephone number	<input type="text"/>

Section 5 of 19

OPERATING SCHEDULE

When do you want the premises licence to start?

<input type="text" value="19"/>	/	<input type="text" value="02"/>	/	<input type="text" value="2016"/>
dd		mm		yyyy

If you wish the licence to be valid only for a limited period, when do you want it to end

<input type="text"/>	/	<input type="text"/>	/	<input type="text"/>
dd		mm		yyyy

Provide a general description of the premises

For example the type of premises, its general situation and layout and any other information which could be relevant to the licensing objectives. Where your application includes off-supplies of alcohol and you intend to provide a place for consumption of these off-supplies you must include a description of where the place will be and its proximity to the premises.

IT IS A BRICK BUILT BUILDING WISH TO OPEN A STORE SELLING A VARIATE OF GOODS ALL OVER EUROPE.

<p><i>Continued from previous page...</i></p> <p>If 5,000 or more people are expected to attend the premises at any one time, state the number expected to attend</p> <div style="border: 1px solid black; width: 100px; height: 20px; margin-left: 100px;"></div>
Section 6 of 19
PROVISION OF PLAYS
<p>Will you be providing plays?</p> <p><input type="radio"/> Yes <input checked="" type="radio"/> No</p>
Section 7 of 19
PROVISION OF FILMS
<p>Will you be providing films?</p> <p><input type="radio"/> Yes <input checked="" type="radio"/> No</p>
Section 8 of 19
PROVISION OF INDOOR SPORTING EVENTS
<p>Will you be providing indoor sporting events?</p> <p><input type="radio"/> Yes <input checked="" type="radio"/> No</p>
Section 9 of 19
PROVISION OF BOXING OR WRESTLING ENTERTAINMENTS
<p>Will you be providing boxing or wrestling entertainments?</p> <p><input type="radio"/> Yes <input checked="" type="radio"/> No</p>
Section 10 of 19
PROVISION OF LIVE MUSIC
<p>Will you be providing live music?</p> <p><input type="radio"/> Yes <input checked="" type="radio"/> No</p>
Section 11 of 19
PROVISION OF RECORDED MUSIC
<p>Will you be providing recorded music?</p> <p><input type="radio"/> Yes <input checked="" type="radio"/> No</p>
Section 12 of 19
PROVISION OF PERFORMANCES OF DANCE
<p>Will you be providing performances of dance?</p> <p><input type="radio"/> Yes <input checked="" type="radio"/> No</p>
Section 13 of 19
PROVISION OF ANYTHING OF A SIMILAR DESCRIPTION TO LIVE MUSIC, RECORDED MUSIC OR PERFORMANCES OF DANCE
<p>Will you be providing anything similar to live music, recorded music or performances of dance?</p> <p><input type="radio"/> Yes <input checked="" type="radio"/> No</p>

Continued from previous page...

Section 14 of 19

LATE NIGHT REFRESHMENT

Will you be providing late night refreshment?

☐ Yes

☒ No

Section 15 of 19

SUPPLY OF ALCOHOL

Will you be selling or supplying alcohol?

☒ Yes

☐ No

Standard Days And Timings

MONDAY

Start

End

Start

End

Give timings in 24 hour clock.
(e.g., 16:00) and only give details for the days
of the week when you intend the premises
to be used for the activity.

TUESDAY

Start

End

Start

End

WEDNESDAY

Start

End

Start

End

THURSDAY

Start

End

Start

End

FRIDAY

Start

End

Start

End

SATURDAY

Start

End

Start

End

SUNDAY

Start

End

Start

End

Continued from previous page...

Will the sale of alcohol be for consumption:

☐ On the premises ☒ Off the premises ☐ Both

If the sale of alcohol is for consumption on the premises select on, if the sale of alcohol is for consumption away from the premises select off. If the sale of alcohol is for consumption on the premises and away from the premises select both.

State any seasonal variations

For example (but not exclusively) where the activity will occur on additional days during the summer months.

NONE

Non-standard timings. Where the premises will be used for the supply of alcohol at different times from those listed in the column on the left, list below

For example (but not exclusively), where you wish the activity to go on longer on a particular day e.g. Christmas Eve.

NONE

State the name and details of the individual whom you wish to specify on the licence as premises supervisor

Name

First name

Family name

Enter the contact's address

Building number or name

Street

District

City or town

County or administrative area

Postcode

Country

Personal Licence number (if known)

Issuing licensing authority (if known)

Continued from previous page...

PROPOSED DESIGNATED PREMISES SUPERVISOR CONSENT

How will the consent form of the proposed designated premises supervisor be supplied to the authority?

- ☐ Electronically, by the proposed designated premises supervisor
- ☒ As an attachment to this application

Reference number for consent form (if known)

If the consent form is already submitted, ask the proposed designated premises supervisor for its 'system reference' or 'your reference'.

Section 16 of 19

ADULT ENTERTAINMENT

Highlight any adult entertainment or services, activities, or other entertainment or matters ancillary to the use of the premises that may give rise to concern in respect of children

Give information about anything intended to occur at the premises or ancillary to the use of the premises which may give rise to concern in respect of children, regardless of whether you intend children to have access to the premises, for example (but not exclusively) nudity or semi-nudity, films for restricted age groups etc gambling machines etc.

NONE

Section 17 of 19

HOURS PREMISES ARE OPEN TO THE PUBLIC

Standard Days And Timings

MONDAY

Start

End

Start

End

Give timings in 24 hour clock.
(e.g., 16:00) and only give details for the days of the week when you intend the premises to be used for the activity.

TUESDAY

Start

End

Start

End

WEDNESDAY

Start

End

Start

End

THURSDAY

Start

End

Start

End

FRIDAY

Start

End

Start

End

Continued from previous page...

SATURDAY

Start 07:00

End 01:00

Start

End

SUNDAY

Start 07:00

End 00:00

Start

End

State any seasonal variations

For example (but not exclusively) where the activity will occur on additional days during the summer months.

NONE

Non standard timings. Where you intend to use the premises to be open to the members and guests at different times from those listed in the column on the left, list below

For example (but not exclusively), where you wish the activity to go on longer on a particular day e.g. Christmas Eve.

NONE

Section 18 of 19

LICENSING OBJECTIVES

Describe the steps you intend to take to promote the four licensing objectives:

a) General – all four licensing objectives (b,c,d,e)

List here steps you will take to promote all four licensing objectives together.

ALL STAFF WILL BE TRAINED WITH REDARDS TO THE LICENCING ACT 2003, THE SERVICE OF ALCOHOL AND TOBACCO. A RECORD WILL BE KEPT OF ALL ATENTIVE PURCHASES BY UNDER 18'S. WE WILL LIASE WITH THE LOCAL POLICE LICENSING OFFICER ON A REGULAR BASIS. ALL STAFF TRAINING RECORDS RELATING THE LICENSING ACT 2003 TO BE DOCUMENTED AND SIGNED BY BOTH THE TRAINER AND TRAINEE. RECORDS TO BE MADE IMMEDIATELY AVAILABLE TO ANY OF THE RESPONSIBLE AUTHORITIES ON REQUEST. ALL MEMBERS OF STAFF WILL RECEIVE TRAINING REGARDING THE:-
FOUR LICENSING PRINCIPLES CONTAINED IN THE LICENSING ACT 2003;
RESPONSIBLE RETAILING OF ALCOHOL, AND LAW REGARDING SALES OF ALCOHOL;
PROTECTION OF CHILDREN FROM HARM AND THIS MUST INCLUDE HOW TO COMPETENTLY CHECK CUSTOMERS' IDENTIFICATION WHERE NECESSARY;
PERMITTED HOURS DURING WHICH LICENSABLE ACTIVITIES CAN TAKE PLACE, AND THE CONDITIONS ATTACHED TO THE PREMISES LICENCE.
THE TRAINING PROVIDED TO STAFF WILL BE RECORDED AND EACH MEMBER OF STAFF WILL SIGN AND DATE THE TRAINING RECORDS TO CONFIRM THEY HAVE RECEIVED AND UNDERSTOOD THE TRAINING PROVIDED.
THE STAFF TRAINING RECORDS WILL BE KEPT AT THE PREMISES AND MADE AVAILABLE TO ANY RESPONSIBLE AUTHORITY UPON REQUEST.
ALL SPIRITS EXPOSED FOR SALE WILL BE DISPLAYED BEHIND THE COUNTER AND SUPERVISED AT ALL TIMES.

Continued from previous page...

b) The prevention of crime and disorder

PROMINENT SIGNS ARE DISPLAYED WITH REGARDS TO ALCOHOL AND TOBACCO SALES.
CCTV CAMERAS ARE INSTALLED AT THE PREMISES WITH THE SPECIFICATIONS AND RECOMMENDATIONS OF THE WEST MIDLANDS POLICE. CCTV RECORDINGS AND IMAGES TO BE DOWNLOADABLE KEPT FOR A MINIMUM OF 28 DAYS AND MADE IMMEDIATELY AVAILABLE TO ANY OF THE RESPONSIBLE AUTHORITIES.
A REFUSAL BOOK IS KEPT AT THE PREMISES AND TO BE MADE IMMEDIATELY AVAILABLE TO ANY OF THE RESPONSIBLE AUTHORITIES ON REQUEST AND SIGNED OFF WEEKLY BY THE DPS.

c) Public safety

ALL EMERGENCY LIGHTING WILL BE CHECKED WEEKLY.
ENTRANCES, EXITS AND PASSAGEWAYS ARE TO BE KEPT CLEAR

d) The prevention of public nuisance

PROMINENT SIGNS WILL BE DISPLAYED REQUESTING CUSTOMERS TO HAVE REGARD FOR LOCAL RESIDENTS WHEN LEAVING THE PREMISES. ADEQUATE BINS ARE AVAILABLE FOR CUSTOMERS TO DISPOSE OF LITTER
NO ALCOHOL ALLOWED ON THE PREMISES IN OPEN CONTAINERS.
NO ALCOHOL TO BE CONSUMED ON THE PREMISES.
A NOTICE MUST BE PROMINENTLY DISPLAYED IN THE PREMISES REQUESTING THAT CUSTOMERS RESPECT THE NEEDS OF LOCAL RESIDENTS AND OTHER BUSINESSES IN THE VICINITY AND TO LEAVE THE PREMISES QUIETLY.

e) The protection of children from harm

WILL OPERATE A CHALLENGE 25 POLICY AND CCTV SIGNAGE ON THE ENTRANCE DOOR AND POINT OF SALE.--
THE PREMISES LICENCE HOLDER WILL IMPLEMENT AND OPERATE A CHALLENGE 25 AGE VERIFICATION POLICY TO PREVENT THE SALE OR SUPPLY OF ALCOHOL TO PERSONS UNDER 18 YEARS OF AGE. A COPY OF THE WRITTEN AGE VERIFICATION POLICY MUST BE SIGNED BY ALL MEMBERS OF STAFF TO CONFIRM THEY HAVE READ AND UNDERSTAND THE POLICY AND THIS SIGNED COPY MUST BE MAINTAINED AT THE PREMISES AND AVAILABLE FOR INSPECTION BY ANY RESPONSIBLE AUTHORITY ON REQUEST. A NOTICE WILL BE DISPLAYED AT THE PREMISES AND CLEARLY VISIBLE TO CUSTOMERS INFORMING THEM THAT A CHALLENGE 25 POLICY IS IN OPERATION AT THE PREMISES. THE PREMISES LICENCE HOLDER WILL MAINTAIN A REFUSALS REGISTER (OR REFUSAL BUTTON ON EPOS -ELECTRONIC POINT OF SALE) ON THE PREMISES AND ENSURE IT IS COMPLETED WHENEVER A SALE IS REFUSED TO A PERSON WHO CANNOT PROVE THEY ARE OVER THE AGE OF 18. THE REFUSAL REGISTER OR RECORD OF TILL RECORDED REFUSALS MUST BE MADE AVAILABLE TO ANY RESPONSIBLE AUTHORITY ON REQUEST.

Section 19 of 19

PAYMENT DETAILS

This fee must be paid to the authority. If you complete the application online, you must pay it by debit or credit card.

Premises Licence Fees are determined by the non domestic rateable value of the premises.

To find out a premises non domestic rateable value go to the Valuation Office Agency site at http://www.voa.gov.uk/business_rates/index.htm

Band A - No RV to £4300	£100.00
Band B - £4301 to £33000	£190.00
Band C - £33001 to £87000	£315.00
Band D - £87001 to £125000	£450.00*
Band E - £125001 and over	£635.00*

*If the premises rateable value is in Bands D or E and the premises is primarily used for the consumption of alcohol on the premises then you are required to pay a higher fee

Band D - £87001 to £125000	£900.00
Band E - £125001 and over	£1,905.00

There is an exemption from the payment of fees in relation to the provision of regulated entertainment at church halls, chapel halls or premises of a similar nature, village halls, parish or community halls, or other premises of a similar nature. The

Continued from previous page...

costs associated with these licences will be met by central Government. If, however, the licence also authorises the use of the premises for the supply of alcohol or the provision of late night refreshment, a fee will be required.

Schools and sixth form colleges are exempt from the fees associated with the authorisation of regulated entertainment where the entertainment is provided by and at the school or college and for the purposes of the school or college.

If you operate a large event you are subject to ADDITIONAL fees based upon the number in attendance at any one time

Capacity 5000-9999	£1,000.00
Capacity 10000-14999	£2,000.00
Capacity 15000-19999	£4,000.00
Capacity 20000-29999	£8,000.00
Capacity 30000-39999	£16,000.00
Capacity 40000-49999	£24,000.00
Capacity 50000-59999	£32,000.00
Capacity 60000-69999	£40,000.00
Capacity 70000-79999	£48,000.00
Capacity 80000-89999	£56,000.00
Capacity 90000 and over	£64,000.00

* Fee amount (£)

190.00

DECLARATION

* I/we understand it is an offence, liable on conviction to a fine up to level 5 on the standard scale, under section 158 of the licensing act 2003, to make a false statement in or in connection with this application.

☒ Ticking this box indicates you have read and understood the above declaration

This section should be completed by the applicant, unless you answered "Yes" to the question "Are you an agent acting on behalf of the applicant?"

* Full name

PMB LICENSING

* Capacity

AGENT

* Date

19 / 02 / 2016
dd mm yyyy

Add another signatory

Once you're finished you need to do the following:

1. Save this form to your computer by clicking file/save as...
2. Go back to <https://www.gov.uk/apply-for-a-licence/premises-licence/birmingham/apply-1> to upload this file and continue with your application.

Don't forget to make sure you have all your supporting documentation to hand.

IT IS AN OFFENCE, LIABLE ON SUMMARY CONVICTION TO A FINE NOT EXCEEDING LEVEL 5 ON THE STANDARD SCALE, UNDER SECTION 158 OF THE LICENSING ACT 2003, TO MAKE A FALSE STATEMENT IN OR IN CONNECTION WITH THIS APPLICATION

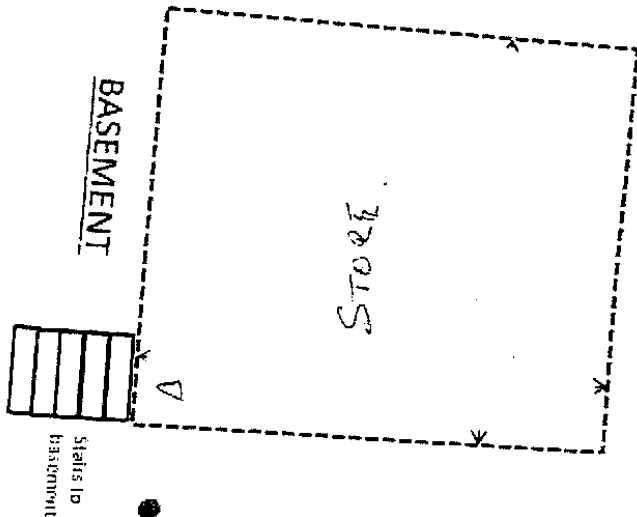

Scale 1: 100

~~Δ~~ F-1256 6/27/44 USMC

ACHSABIC Activity

17

Appendix 4

From: BS Licensing
Sent: 09 March 2016 11:57
To: Licensing
Cc: BS Licensing; pmblicensing
Subject: (FAO - WENDY)Euro Express, 1851b Pershore Road, Cotteridge, Birmingham, B30 3DJ

Licensing,

Please see the email below confirming the hours agreed between ourselves, West Midlands Police and the client & solicitor for the above premises.

In short the agreed hours are now as follows:

Sale of Alcohol: Mon-Sun 07:00 x 23:00

Opening Hours: Mon-Sun 07:00 x 23:00

Please can the hours be amended on the licence once it issued. There is no change to the conditions as stated in the application as WMP are happy with them as they stand.

Regards,

Hanna O'Malley
Planning / Licensing Officer
Birmingham South
Partnerships Office

Bournville Police Station
Bournville Lane
Birmingham B30 1QX

Twitter: [@SthBhamPartners](https://twitter.com/SthBhamPartners)

<http://www.bhamsouthcommunitysafety.co.uk>

From: pmblicensing
Sent: 08 March 2016 15:39
To: BS Licensing
Subject: Re: Fw: Online app - Grant: Euro Express REF 291078

Hanna

My client is happy with the reduction in hours
Patrick

Appendix 5

From: pmblicensing
Sent: 31 March 2016 15:25
To: Licensing
Subject: Re: FW: Re: Premises Licence application - Euro Express

Wendy
My client is happy for the suggested conditions to be included in the premise license application
Patrick

Sent from my Samsung Galaxy smartphone.
----- Original message -----
From: Licensing <licensing@birmingham.gov.uk>
Date: 31/03/2016 15:19 (GMT+00:00)
To: pmblicensing/
Cc: Teresa Wilding <Teresa.Wilding@birmingham.gov.uk>
Subject: FW: Re: Premises Licence application - Euro Express

Hi Patrick

Any update on the below email please.

Please respond at your earliest convenience.

Thank you

Wendy Gayle
Licensing Officer
Birmingham City Council
Licensing Section
P.O. Box 17013
Birmingham

B6 9ES

0121 303 9896

"Locally accountable and responsive fair regulation for all - achieving a safe, healthy, clean, green and fair trading city for residents, business and visitors"

From: Teresa Wilding
Sent: Tuesday, March 22, 2016 2:27 PM
To: [pmblicensing@birmingham.gov.uk](#)
Cc: [pmblicensing@birmingham.gov.uk](#)
Subject: FW: Re: Premises Licence application - Euro Express

Dear Mr Burke,

I do not seem to have had a response regarding my email below and attached conditions, can you please confirm that as the agent for the applicant that he is agreeable for the condition outlined in the attached document and highlighted in blue to be replaced with the conditions worded in black.

I would appreciate speedy response as the rep period ended on 18th March 2016 and this agreement will then form part of the Licensing Committee Report.

Yours sincerely,

Teresa Wilding

Licensing Enforcement Officer

Birmingham City Council Licensing

Ashted Lock,

Building 1-3, Ground Floor,

Birmingham Science Park Aston,

Dartmouth Middleway,

Aston,

General

The Premises Licence Holder shall ensure that all staff are trained regarding the Four Principles contained in the Licensing Act 2003. Training provided will be recorded and each staff member will sign and date the training records to confirm that they have received and understood the training provided.

All members of staff will receive training regarding the:-

- four licensing principles contained in the Licensing Act 2003;
- responsible retailing of alcohol;
- protection of children from harm and this must include how to competently check customers' identification where necessary;
- authorised hours for licensable activities and the conditions attached to the premises licence.

The training provided to staff will be recorded and each member of staff will sign and date the training records to confirm they have received and understood the training provided.

Protection of Children from Harm

The Premises Licence Holder shall ensure that a challenge 25 age verification policy will be implemented to prevent sale/supply of alcohol to persons under 18 year of age. A copy of the written age verification policy will be maintained at the premises and available for inspection to any Responsible Authority on request.

The premises will operate a strict Challenge 25 age verification policy – **No ID - No Sale**

The licence holder will have a written age verification policy (challenge 25).

A copy of the written age verification policy must be signed by all members of staff to confirm they have read and understand the policy in operation and this signed copy will be maintained at the premises and available for inspection by any Responsible Authority on request.

A notice will be displayed at the premises and clearly visible to customers advising a challenge 25 age verification policy is in operation at the premises.



Birmingham City Council Map Created By:

Date of Map Creation: 22/03/2016

Notes

(c) Crown copyright. All rights reserved. Birmingham City Council 100021326 (2016).
You are not permitted to copy, sub-licence, distribute or sell any of this data to third parties in any form.

(c) GeoPerspectives, supplied by Bluesky International Ltd

Cities Revealed® copyright by The GeoInformation® Group, 2014 and Crown Copyright © All right reserved



Scale:
1:2,500

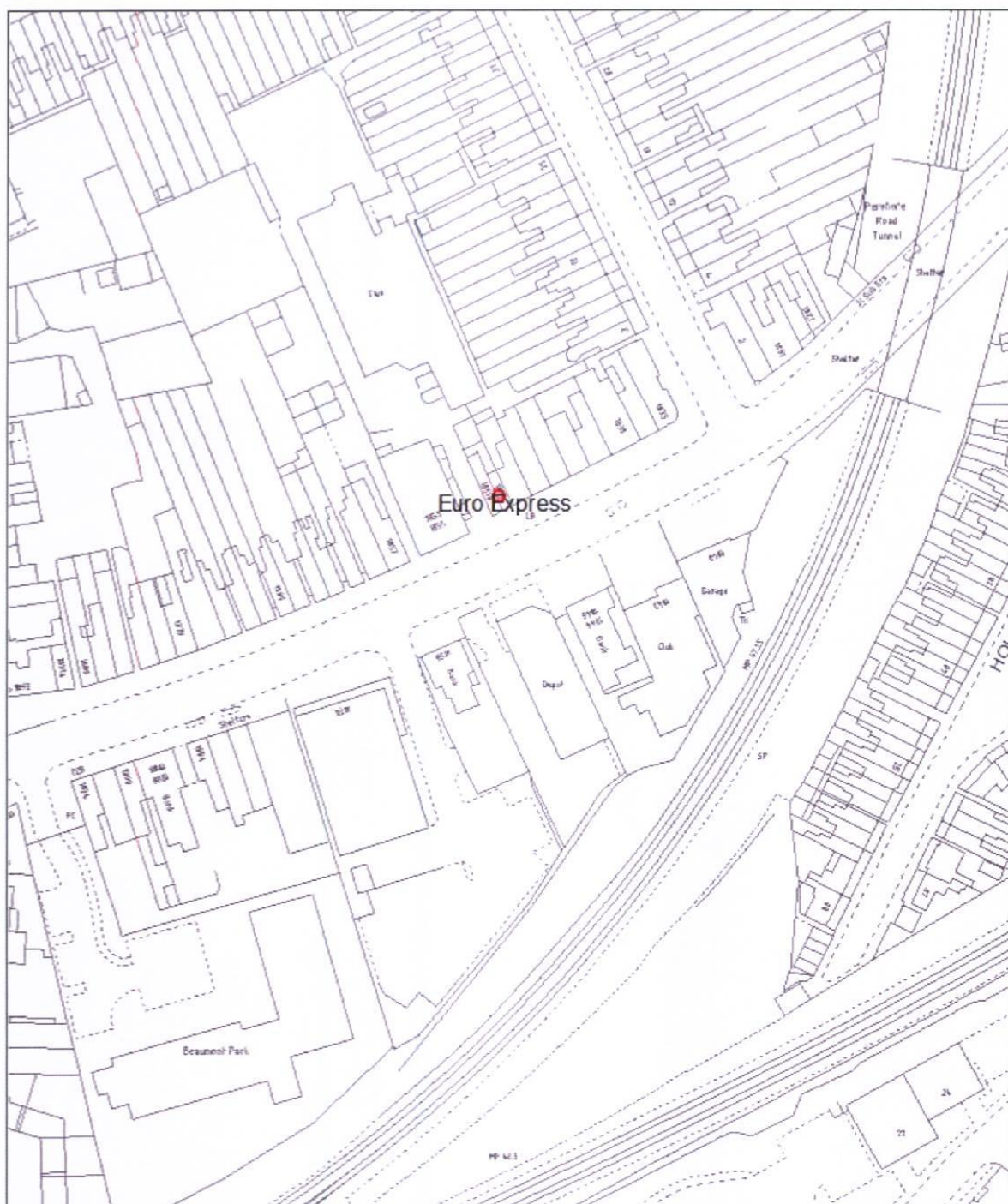

Birmingham City Council

Map Created By:

Notes

Date of Map Creation: 22/03/2016



Scale:
1:1,250

(c) Crown copyright. All rights reserved. Birmingham City Council 100021326 (2016).
You are not permitted to copy, sub-licence, distribute or sell any of this data to third parties in any form.
(c) GeoPerspectives, supplied by Bluesky International Ltd
Cities Revealed® copyright by The GeoInformation® Group, 2014 and Crown Copyright © All right reserved