

THE CONTRACTOR IS TO CAT SCAN THE AREA PRIOR TO ANY EXCAVATION.

- IF NO SERVICES ARE RECORDED THEN EXCAVATIONS CAN TAKE PLACE.
- FOLLOWING EXCAVATION IF A SERVICE IS DISCOVERED THEN THE CONTRACTOR CAN PROPOSE AN ALTERNATIVE FOUNDATION DESIGN.
- IF THE PRESENCE OF SERVICES IS IDENTIFIED THEN A SUITABLE LOCATION IS TO BE DISCUSSED WITH THE INSPECTOR TO ASCERTAIN THE NEAREST SUITABLE LOCATION IN ACCORDANCE WITH SETTING OUT DIMENSIONS SHOWN ON THE SIGNAGE DETAILS

REINSTATEMENT TO MATCH EXISTING

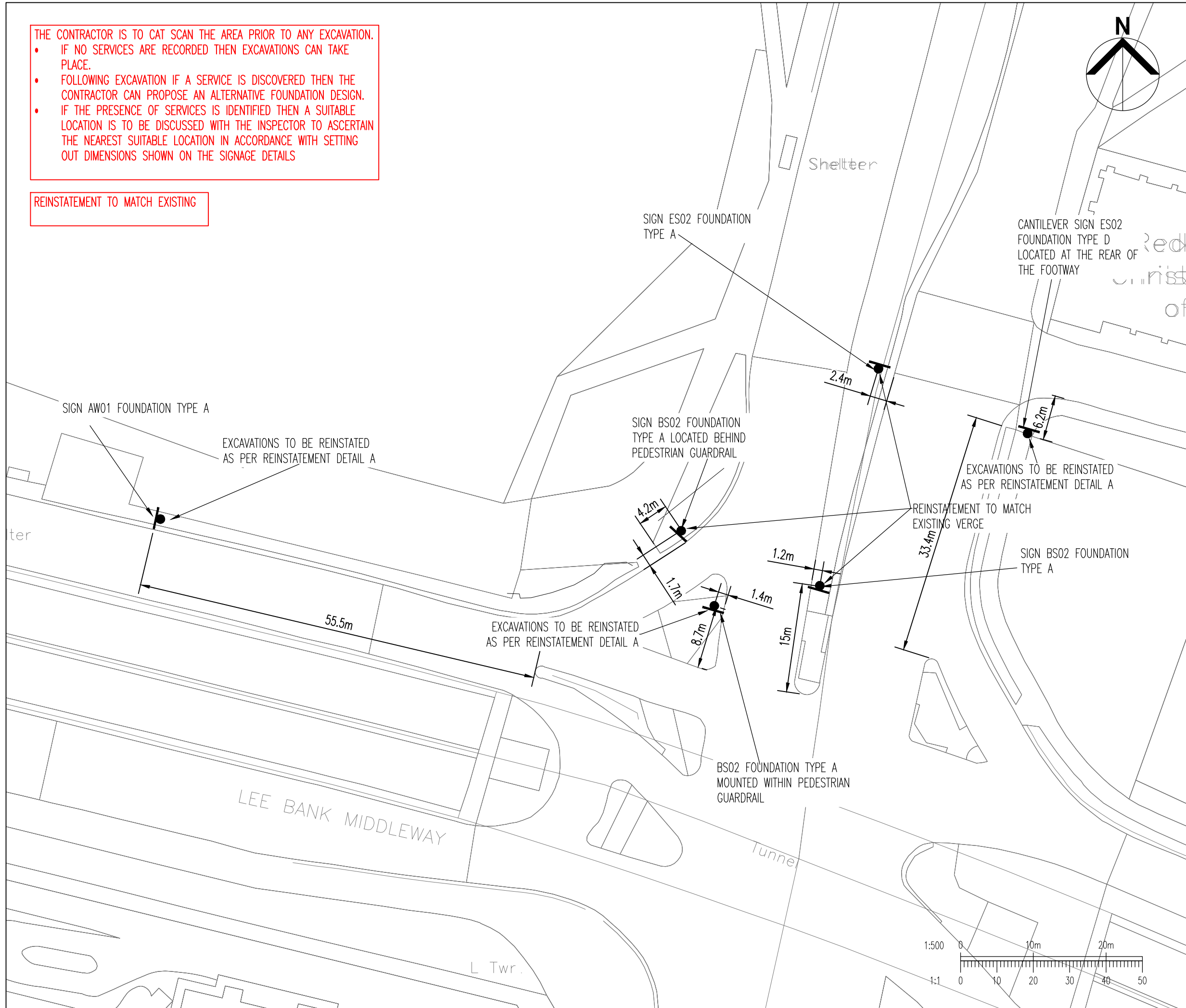

This drawing should not be scaled. Dimensions to be verified on site. Any discrepancies should be referred to the Engineer prior to work being put in hand.

This drawing is the property of Waterman Infrastructure & Environment Limited, and the drawing is issued on the condition that it is not copied reproduced, retained or disclosed to any unauthorised person, either wholly or in part without the consent in writing of Waterman Infrastructure & Environment Limited
Pickfords Wharf, Clink Street, London SE1 9DG t 020 7928 7888 f 03333 444 501

GENERAL NOTES

1. THIS DRAWING IS TO BE READ IN CONJUNCTION WITH ALL ENGINEER'S, ARCHITECT'S OR OTHER RELEVANT DRAWINGS AND SPECIFICATIONS.
2. ALL DIMENSIONS AND LEVELS ARE TO BE CHECKED ON SITE BY THE CONTRACTOR PRIOR TO PREPARING ANY WORKING DRAWINGS OR COMMENCING ON SITE.
3. THE CONTRACTOR MUST ENSURE AND WILL BE HELD RESPONSIBLE FOR THE OVERALL STABILITY OF THE BUILDING/STRUCTURE/EXCAVATION AT ALL STAGES OF THE WORK.
4. ALL WORK BY THE CONTRACTOR MUST BE CARRIED OUT IN SUCH A WAY THAT ALL REQUIREMENTS UNDER THE HEALTH AND SAFETY AT WORK ACT ARE SATISFIED.
5. ALL WORK IS TO BE CARRIED OUT IN COMPLIANCE WITH THE REQUIREMENTS OF THE RELEVANT STATUTORY AUTHORITIES AND REGULATIONS
6. REFER TO SIGNAGE DETAILS (1200 DRAWING NUMBER SERIES) FOR THE SIGN AND FOUNDATION DETAILS.
7. IF SERVICES ARE PRESENT EXACT LOCATION TO BE CONFIRMED ON SITE.
8. CANTILEVER SIGNS ARE ANNOTATED WHERE PROPOSED.
9. POST LOCATED TO ENSURE ADEQUATE SIGHT LINES EXACT LOCATION TO BE AGREED ON SITE FOLLOWING CAT SCAN.
10. REINSTATEMENT DETAILS AS PER DRAWING 15533-SA-90-2602.
11. FOR FURTHER DETAILS REFER TO WIE DOCUMENT "CIVILS SPECIFICATION".

E03	27.09.19	ISSUED FOR CONSTRUCTION	JG
E02	13.09.19	BCC COMMENTS INCORPORATED	NB
E01	07.08.19	ISSUED FOR CONSTRUCTION	JB

Rev	Date	Description	By
-----	------	-------------	----

Amendments

Project

BIRMINGHAM CAZ

Title

**BRISTOL STREET
JUNCTION 19
SIGNING LAYOUT
SHEET 1 OF 2**

Client

BIRMINGHAM CITY COUNCIL



5th Floor One Cornwall Street Birmingham B3 2DX

1 0121 212 7700 1 03333 444 501

mail@watermangroup.com

www.watermangroup.com

Drawing Status

CONSTRUCTION

Designed by JB Checked by DP Project No

15533

Drawn by JB Date JUNE 2019

Scales @ A3 work to figured dimensions only 1:500 15533-19-90-002 - Signing A38 Bristol Street - E03.dwg

Publisher Zone Category Number Revision

WIE

J19

90

002

E03