

AREA EDGED BLACK

0.19



HECTARES APPROX.

0.46

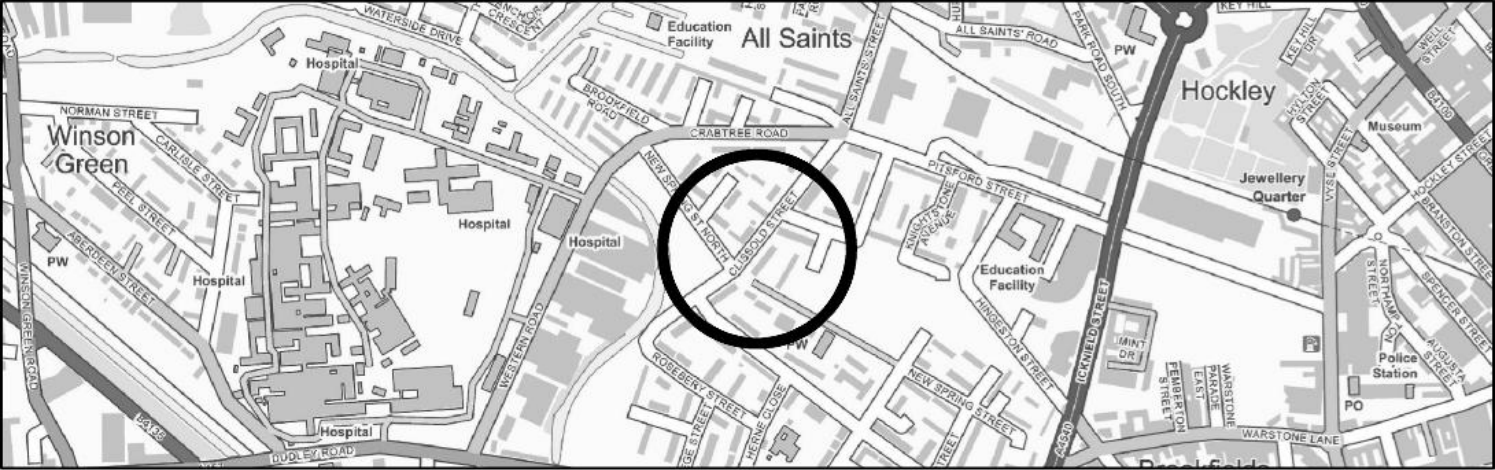
ACRES APPROX.



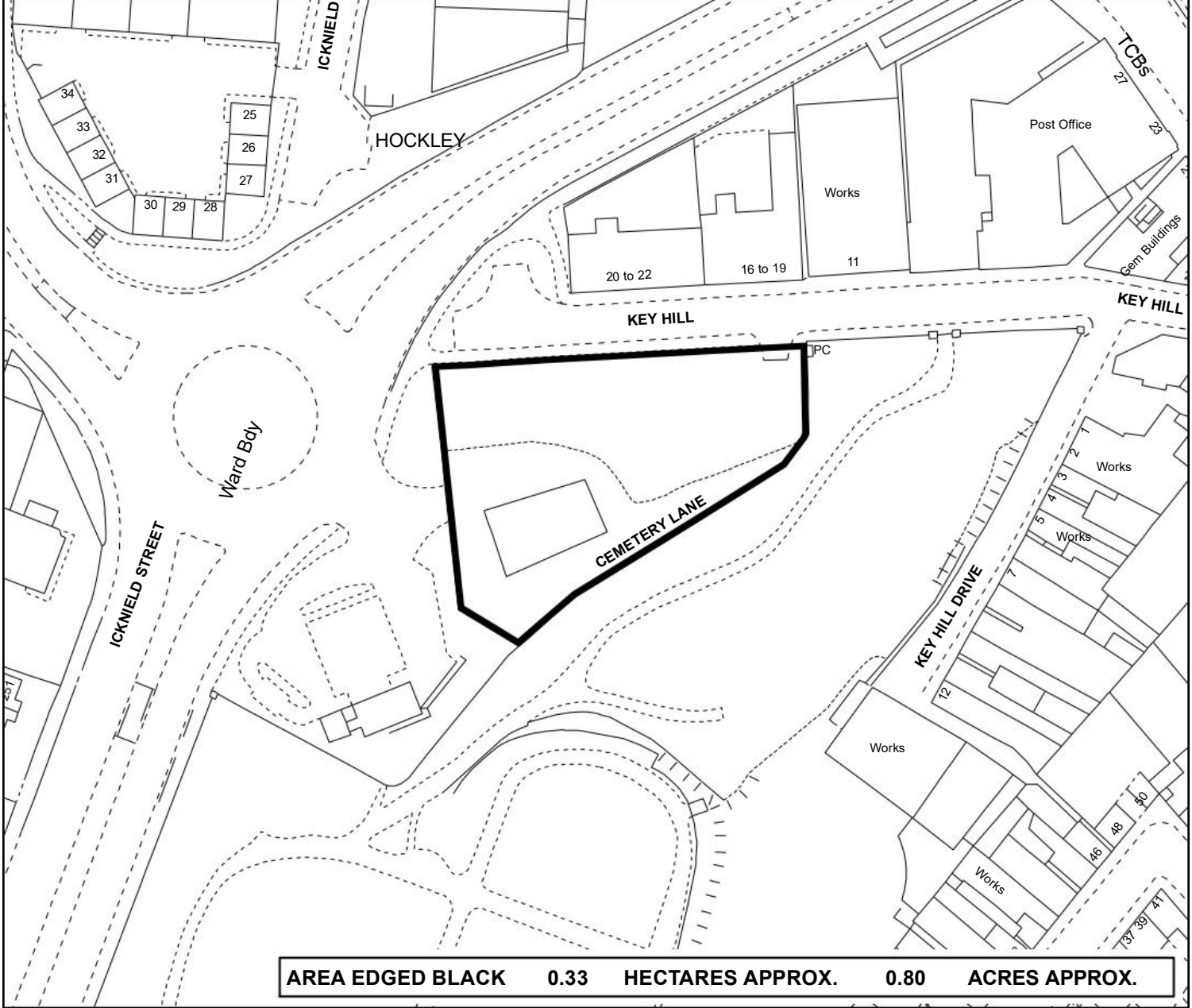

© Crown Copyright and database right 2022. Ordnance Survey 100021326.
You are not permitted to copy, sub-licence, distribute or sell any of this data to third parties in any form.

 Birmingham City Council		Kathryn James Assistant Director Property Place, Prosperity & Sustainability Directorate 10 Woodcock Street Birmingham, B7 4BG		
Former Childrens Home 63 Clissold Street Soho & Jewellery Quarter		Scale (Main Map)	Drawn	Date
		1:1,250	Bharat Patel	10/11/2022
		O.S.Ref SP0587NW		

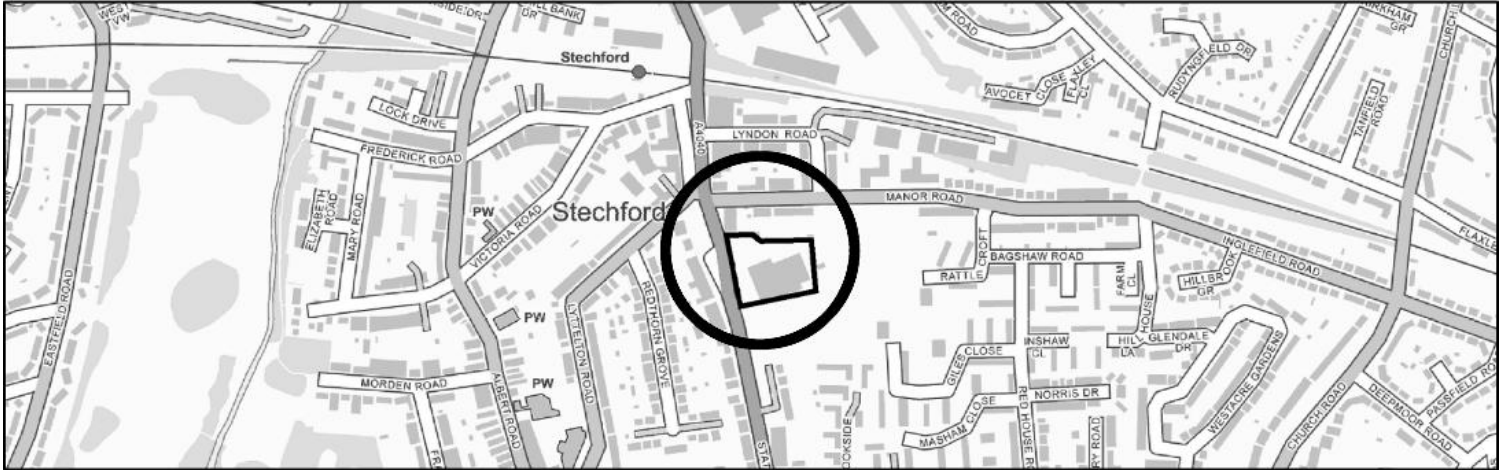
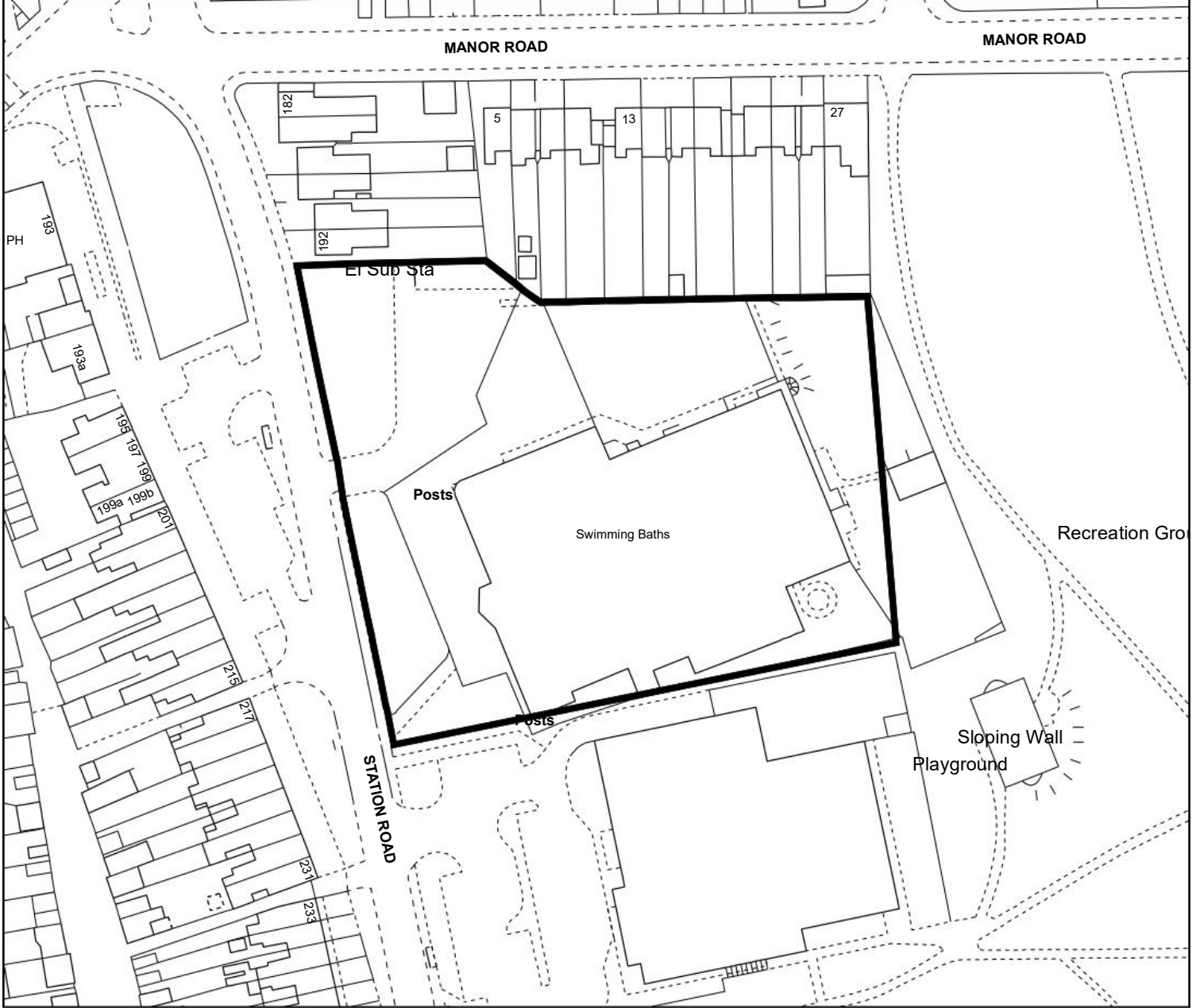



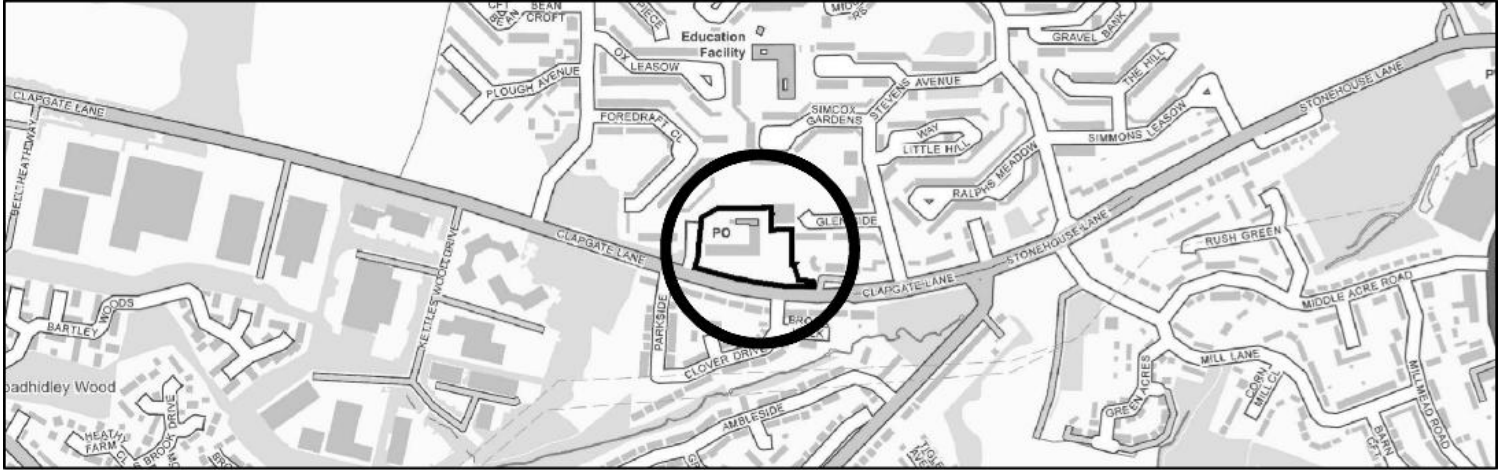
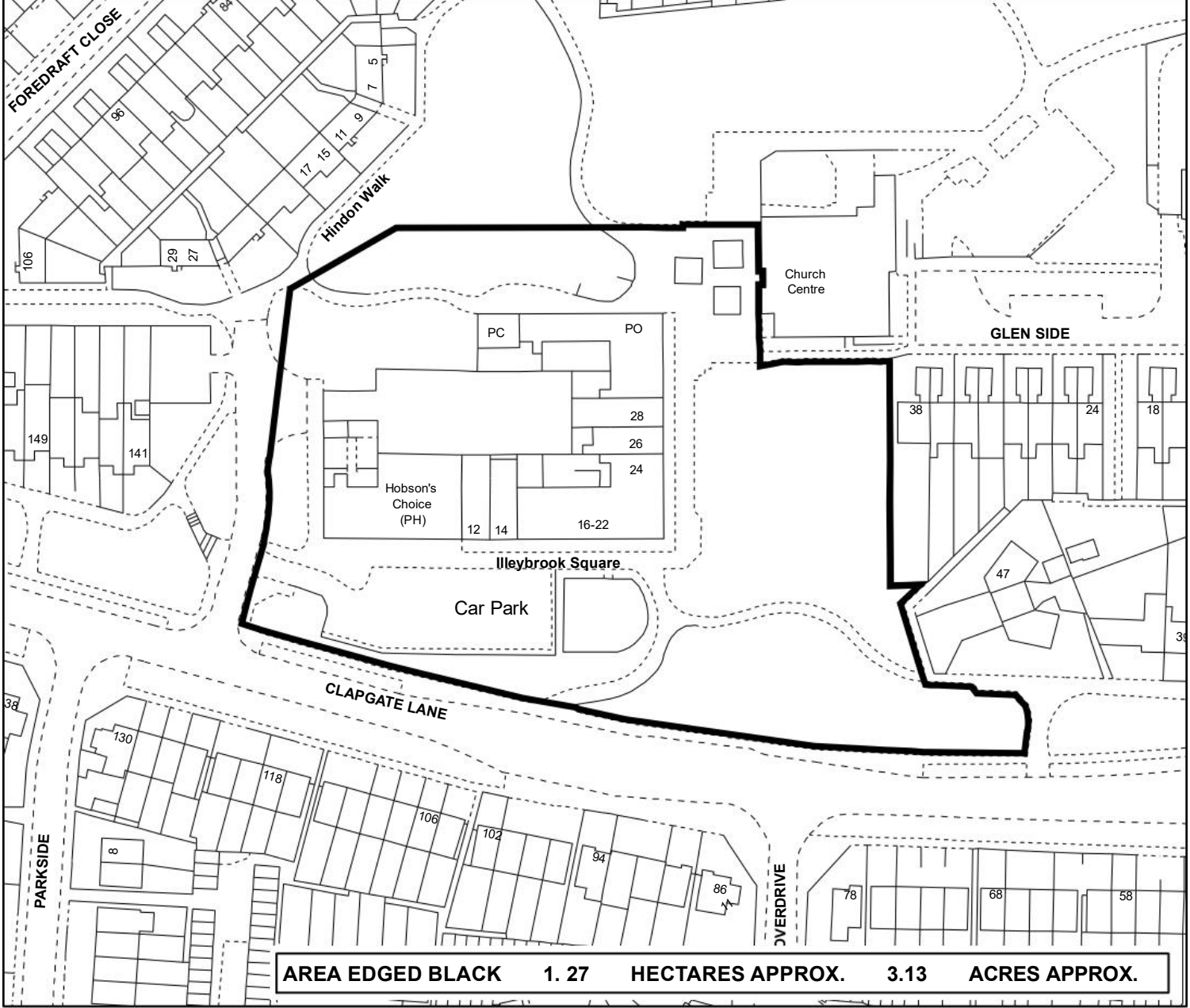

© Crown Copyright and database right 2022. Ordnance Survey 100021326.
You are not permitted to copy, sub-licence, distribute or sell any of this data to third parties in any form.

 Birmingham City Council		Kathryn James Assistant Director Property Place, Prosperity & Sustainability Directorate 10 Woodcock Street Birmingham, B7 4BG		
Land At Station Road Yardley East		Scale (Main Map)	Drawn	Date
		1:1,250	Bharat Patel	14/12/2022
		O.S.Ref SP1387SW		



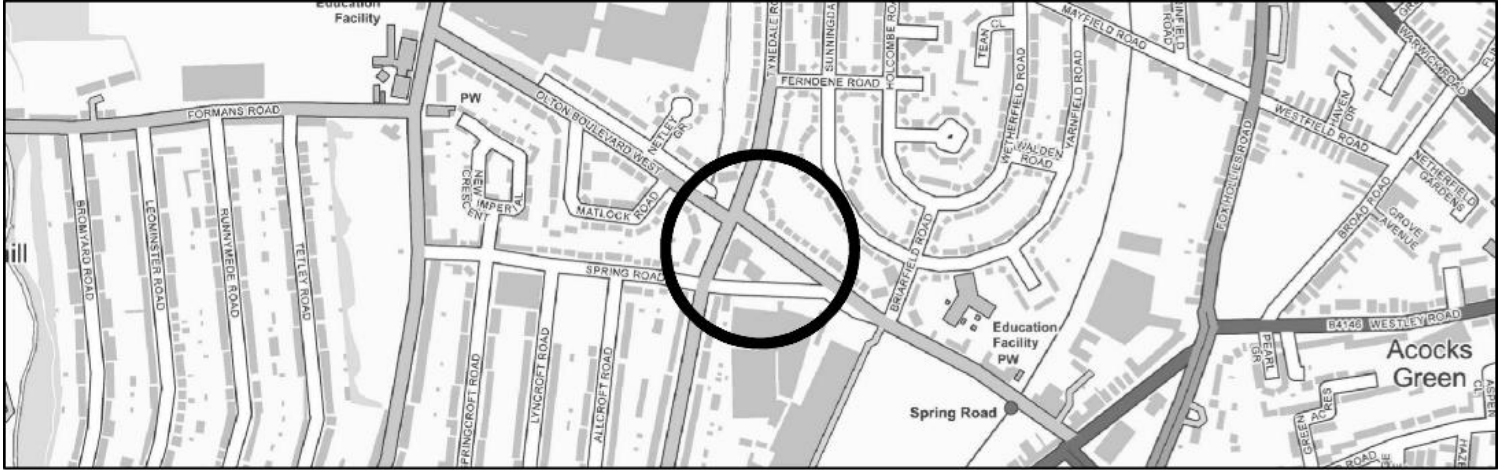
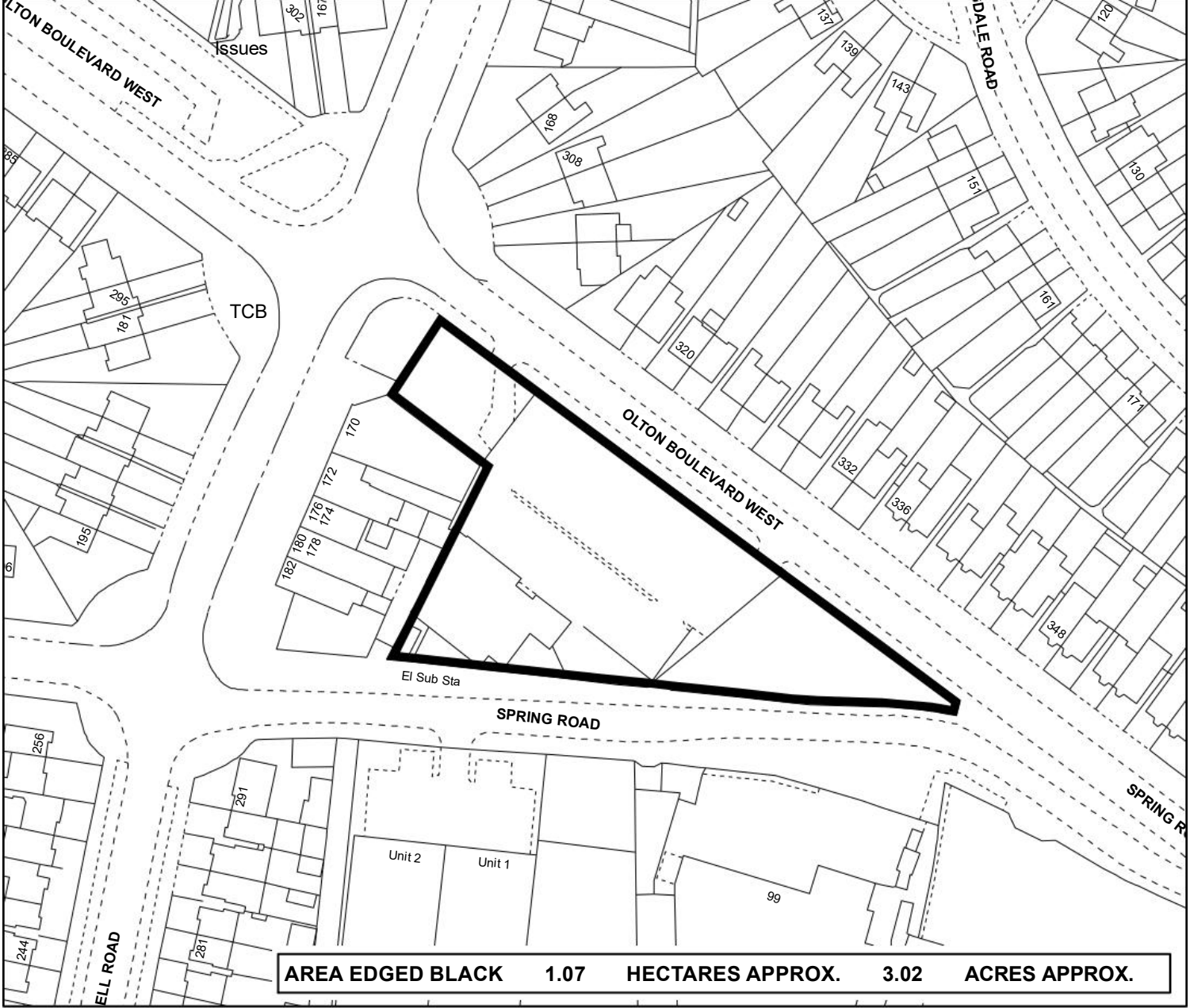

© Crown Copyright and database right 2022. Ordnance Survey 100021326.
You are not permitted to copy, sub-licence, distribute or sell any of this data to third parties in any form.

 Birmingham City Council		Kathryn James Assistant Director Property Place, Prosperity & Sustainability Directorate 10 Woodcock Street Birmingham, B7 4BG		
Illeybrook Square Bartley Green		Scale (Main Map)	Drawn	Date
		1:1,250	Bharat Patel	10/11/2022
		O.S.Ref SP0082NE		



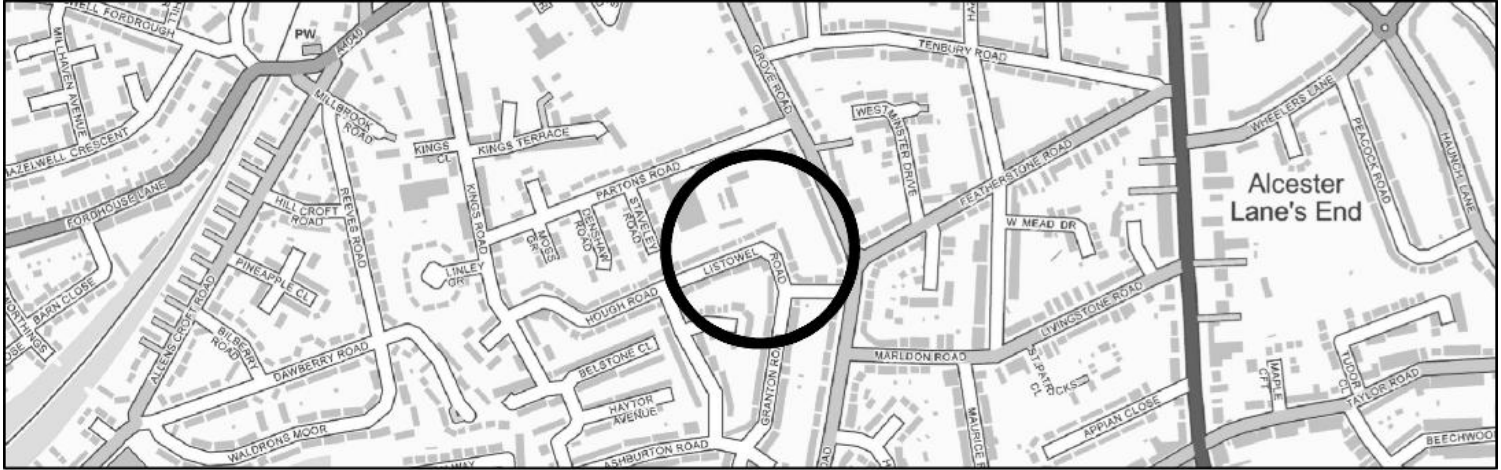
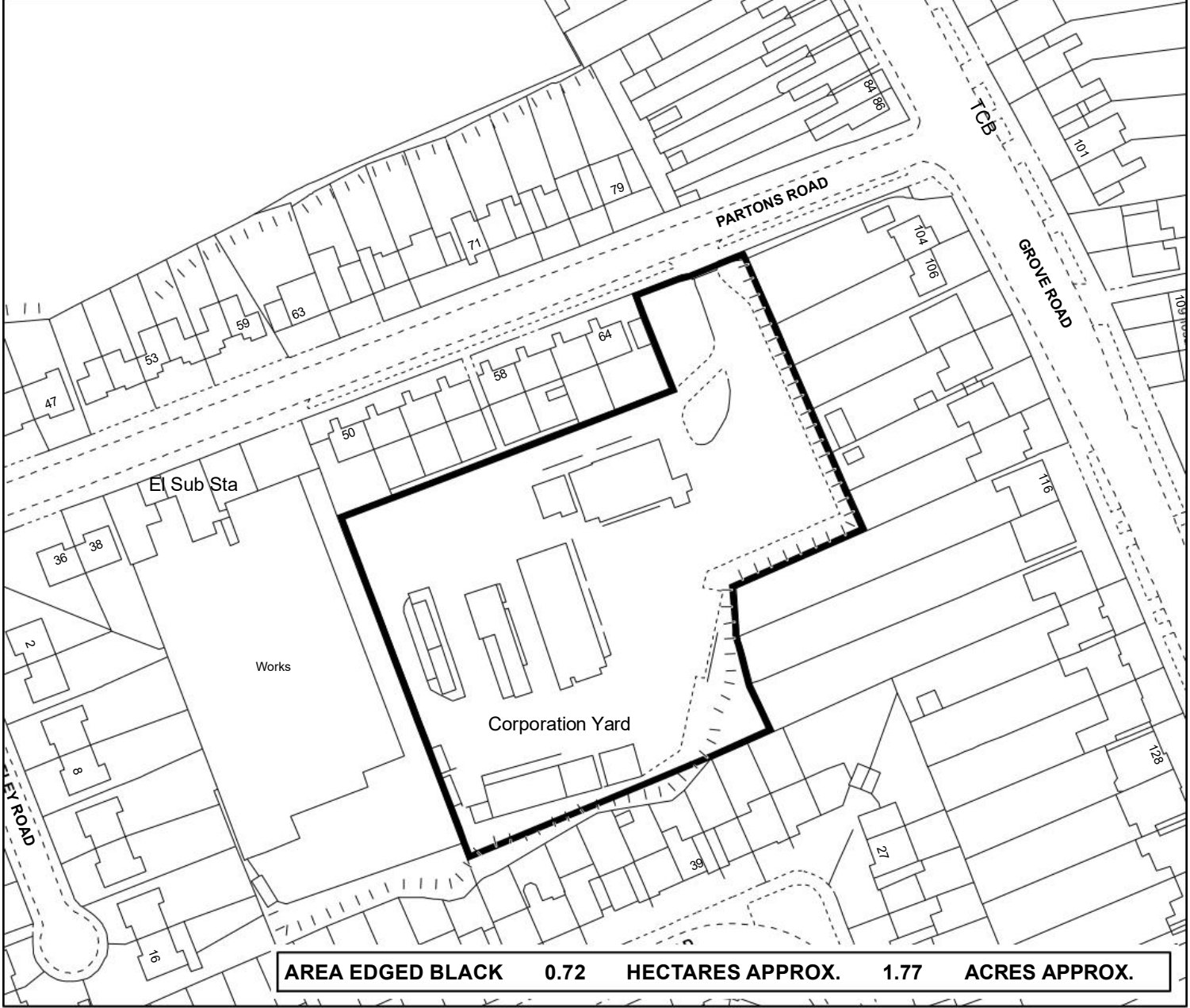

© Crown Copyright and database right 2022. Ordnance Survey 100021326.
You are not permitted to copy, sub-licence, distribute or sell any of this data to third parties in any form.

 Birmingham City Council		Kathryn James Assistant Director Property Place, Prosperity & Sustainability Directorate 10 Woodcock Street Birmingham, B7 4BG		
Land At Olton Boulevard West-Spring Road Tyseley & Hay Mills		Scale (Main Map)	Drawn	Date
		1:1,250	Bharat Patel	10/11/2022
		O.S.Ref SP1083SE		



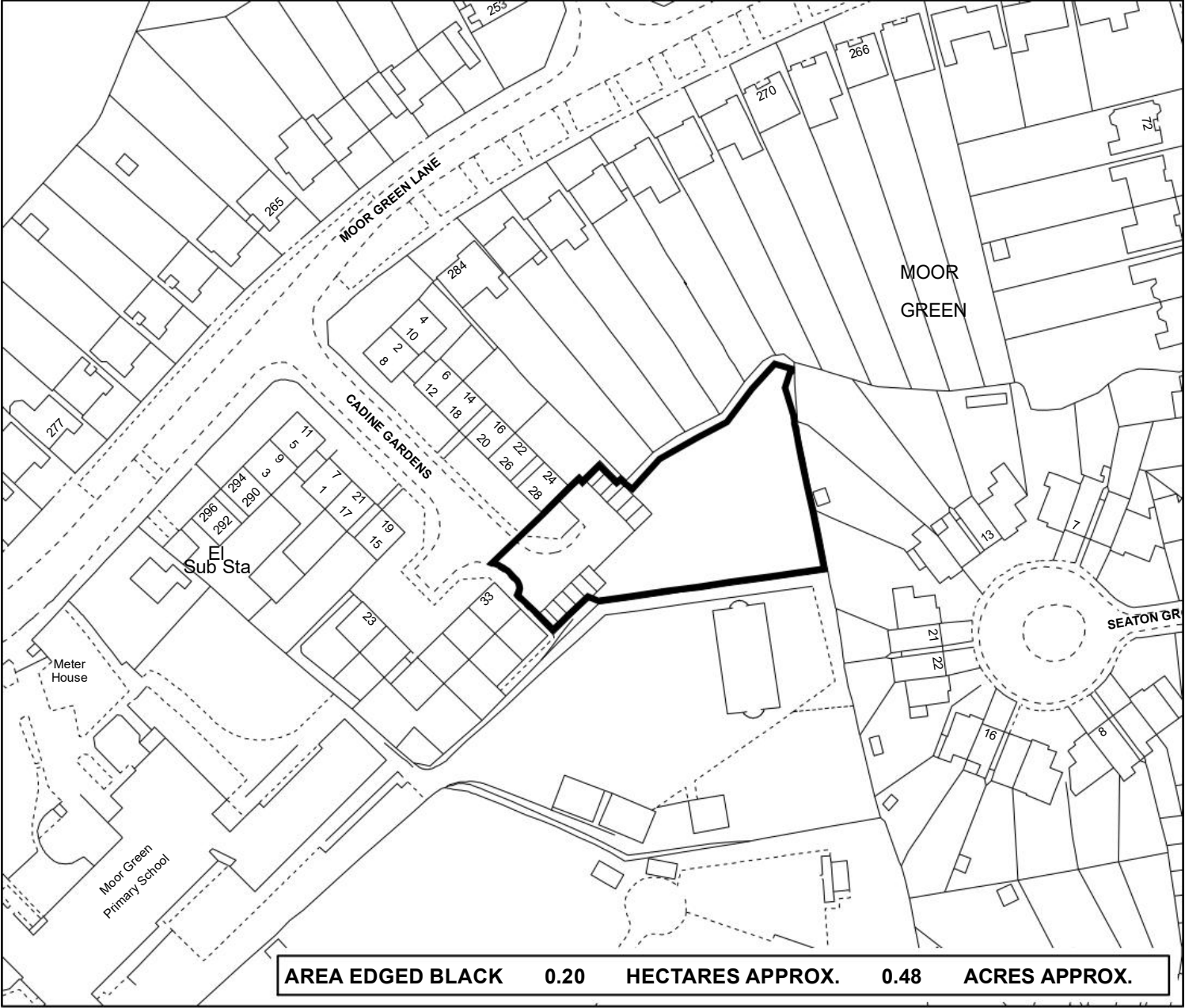

© Crown Copyright and database right 2022. Ordnance Survey 100021326.
You are not permitted to copy, sub-licence, distribute or sell any of this data to third parties in any form.

 Birmingham City Council		Kathryn James Assistant Director Property Place, Prosperity & Sustainability Directorate 10 Woodcock Street Birmingham, B7 4BG		
Site At Partons Road Brandwood & King's Heath		Scale (Main Map)	Drawn	Date
		1:1,250	Bharat Patel	10/11/2022
		O.S.Ref SP0680NE		



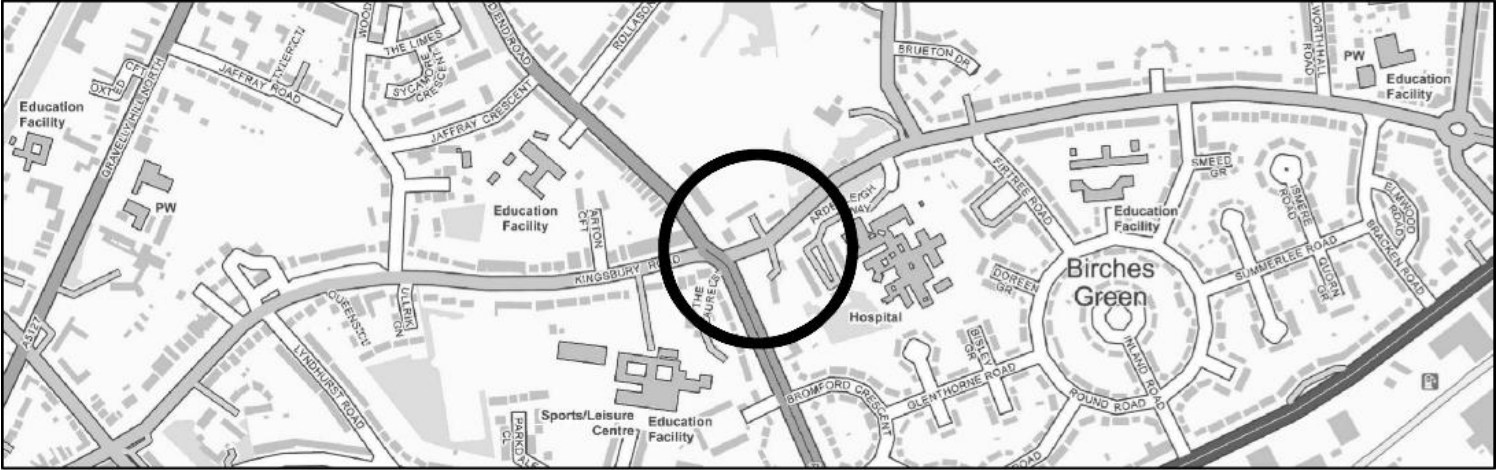
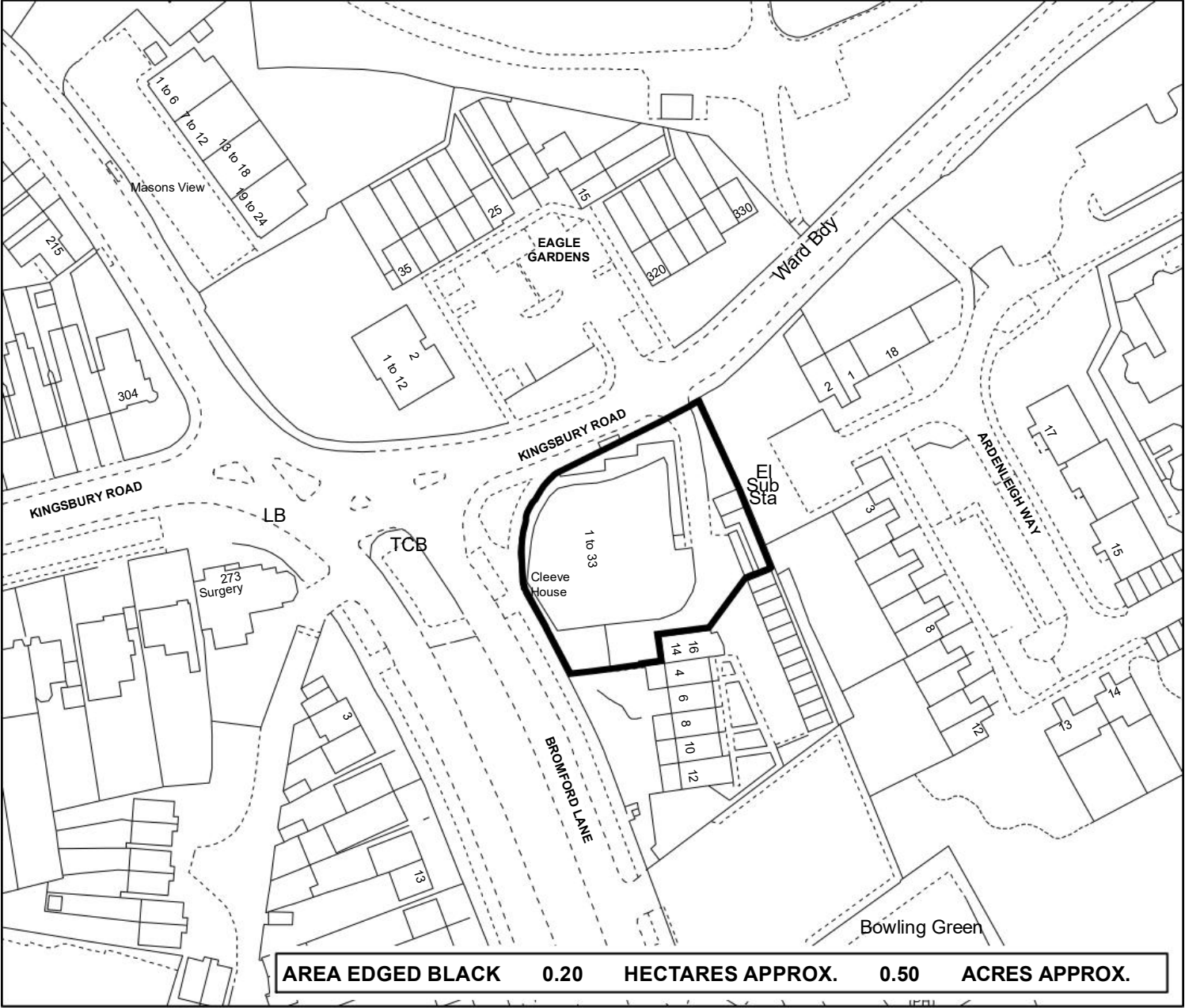

© Crown Copyright and database right 2022. Ordnance Survey 100021326.
You are not permitted to copy, sub-licence, distribute or sell any of this data to third parties in any form.

 Birmingham City Council		Kathryn James Assistant Director Property Place, Prosperity & Sustainability Directorate 10 Woodcock Street Birmingham, B7 4BG		
Cadine Gardens (Land to the rear of 276-284) Moor Green Lane Hall Green		Scale (Main Map)	Drawn	Date
		1:1,250	Bharat Patel	14/11/2022
		O.S.Ref. SP0682SW		



© Crown Copyright and database right 2022. Ordnance Survey 100021326.
You are not permitted to copy, sub-licence, distribute or sell any of this data to third parties in any form.

 Birmingham City Council		Kathryn James Assistant Director Property Place, Prosperity & Sustainability Directorate 10 Woodcock Street Birmingham, B7 4BG		
Site at Bromford Lane Erdington		Scale (Main Map)	Drawn	Date
		1:1,250	Bharat Patel	14/11/2022
		O.S.Ref. SP1190NW		