

BIRMINGHAM CITY COUNCIL

PUBLIC REPORT

Report to:	Licensing Sub Committee A
Report of:	Director of Regulation & Enforcement
Date of Meeting:	Monday 22nd January 2024
Subject:	Licensing Act 2003 Premises Licence – Grant
Premises:	Mo Wine Shop, 39 Horse Fair, Birmingham, B1 1DA
Ward affected:	Bordesley and Highgate
Contact Officer:	David Kennedy, Principal Licensing Officer, licensing@birmingham.gov.uk

1. Purpose of report:

To consider a representation that has been made in respect of an application for a Premises Licence which seeks to permit the Sale of Alcohol (for consumption off the premises) to operate from 07:00am until 12:00midnight (Monday to Sunday).

Premises to remain open to the public from 07:00am until 12:00midnight (Monday to Sunday).

2. Recommendation:

To consider the representation that has been made and to determine the application, having regard to:

- The submissions made by all parties
- The Statement of Licensing Policy
- The Public Sector Equality Duty
- The s182 Guidance

3. Brief Summary of Report:

An application for a Premises Licence was received on 22nd November 2023 in respect of Mo Wine Shop, 39 Horse Fair, Birmingham, B1 1DA.

A representation has been received from other persons.

4. Compliance Issues:

4.1 Consistency with relevant Council Policies, Plans or Strategies:

The report complies with the City Council's Statement of Licensing Policy and the Council's Corporate Plan to improve the standard of all licensed persons, premises and vehicles in the City.

5. Relevant background/chronology of key events:

Behzad Zarandi applied on 22nd November 2023 for the grant of a Premises Licence for Mo Wine Shop, 39 Horse Fair, Birmingham, B1 1DA.

A representation has been received from other persons, which is attached at Appendix 1.

The application is attached at Appendix 2.

Conditions have been agreed with West Midlands Police and the applicant, which are attached at Appendix 3.

Site Location Plans at Appendix 4.

When carrying out its licensing functions, a licensing authority must have regard to Birmingham City Council's Statement of Licensing Policy and the Guidance issued by the Secretary of State under s182 of the Licensing Act 2003. The Licensing Authority is also required to take such steps as it considers appropriate for the promotion of the licensing objectives, which are:-

- a. The prevention of crime and disorder;
- b. Public safety;
- c. The prevention of public nuisance; and
- d. The protection of children from harm.

6. List of background documents:

Copy of the representation as detailed in Appendix 1.
Application Form, Appendix 2.
Conditions agreed with West Midlands Police, Appendix 3.
Site Location Plans, Appendix 4.

7. Options available

To Grant the licence in accordance with the application.
To Reject the application.
To Grant the licence subject to conditions modified to such an extent as considered appropriate.
Exclude from the licence any of the licensable activities to which the application relates.
Refuse to specify a person in the licence as the premises supervisor.

From:

Sent: 24 November 2023 11:16

To: Licensing

Subject: For complaining

Hi,

Greetings of the day,

Hope you are doing well,

I am living in Birmingham, post code is-B11DA. Actually I want to tell that , here is already two to more off licence shops.

And I heard about one shop as well who will get licence for this kind of shop. The shop name is Mo Wine shop, post code is 39 Horse Fair, Birmingham.

So I just want to request to you that please don't allow them because it will make trouble for that people who living there. Because every-time they had issues and fights there. At nights, there were fighting that's big problem for us and our kids. In this kind of atmosphere we didn't feel safe.

So please look after about our situation. I hope you will sort it out. I will very thankful to you.

Thanks,

Application for a premises licence to be granted under the Licensing Act 2003

Please read the following instructions first

Before completing this form please read the guidance notes at the end of the form. If you are completing this form by hand please write legibly in block capitals. In all cases ensure that your answers are inside the boxes and written in black ink. Use additional sheets if necessary.

You may wish to keep a copy of the completed form for your records.

I Behzad Zarandi
(Insert name(s) of applicant)

apply for a premises licence under section 17 of the Licensing Act 2003 for the premises described in Part 1 below (the premises) and I/we are making this application to you as the relevant licensing authority in accordance with section 12 of the Licensing Act 2003

Part 1 – Premises details

Postal address of premises or, if none, ordnance survey map reference or description Mo Wine Shop 39 Horse Fair, Birmingham			
Post town	Birmingham	Postcode	B11DA
Telephone number at premises (if any)			
Non-domestic rateable value of premises		9,300	

Part 2 - Applicant details

Please state whether you are applying for a premises licence as **appropriate** Please tick as appropriate

a)	an individual or individuals *	<input checked="" type="checkbox"/>	please complete section (A)
b)	a person other than an individual *	<input type="checkbox"/>	
i	as a limited company/limited liability partnership	<input type="checkbox"/>	please complete section (B)
ii	as a partnership (other than limited liability)	<input type="checkbox"/>	please complete section (B)
iii	as an unincorporated association or	<input type="checkbox"/>	please complete section (B)
iv	other (for example a statutory corporation)	<input type="checkbox"/>	please complete section (B)
c)	a recognised club	<input type="checkbox"/>	please complete section (B)

d)	a charity		please complete section (B)
e)	the proprietor of an educational establishment		please complete section (B)
f)	a health service body		please complete section (B)
g)	a person who is registered under Part 2 of the Care Standards Act 2000 (c14) in respect of an independent hospital in Wales		please complete section (B)
ga)	a person who is registered under Chapter 2 of Part 1 of the Health and Social Care Act 2008 (within the meaning of that Part) in an independent hospital in England		please complete section (B)
h)	the chief officer of police of a police force in England and Wales		please complete section (B)

* If you are applying as a person described in (a) or (b) please confirm (by ticking yes to one box below):

- I am carrying on or proposing to carry on a business which involves the use of the premises for licensable activities; or
- I am making the application pursuant to a
- statutory function or
- a function discharged by virtue of Her Majesty's prerogative

(A) individual applicants (fill in as applicable)

Mr	Mrs	Miss	Ms	Other Title (for example, Rev)	
Surname Zarandi			First names Behzad		
Date of birth		I am 18 years old or over		yes	
Nationality		British			
Current residential address if different from premises address					
Post town				Postcode	
Daytime contact telephone number					
E-mail address (optional)					
Where applicable (if demonstrating a right to work via the Home Office online right to work checking service), the 'share code' provided to the applicant by that service (please see note 15 for information)					

Second individual applicant (if applicable)

Mr	Mrs	Miss	Ms	Other Title (for example, Rev)	
Surname			First names		
Date of birth or over		I am 18 years old		Please tick yes	
Nationality					
Current residential address if different from premises address					
Post town				Postcode	
Daytime contact telephone number					
E-mail address (optional)					
Where applicable (if demonstrating a right to work via the Home Office online right to work checking service), the 'share code' provided to the applicant by that service: (please see note 15 for information)					

(B) Other applicants

Please provide name and registered address of applicant in full. Where appropriate please give any registered number. In the case of a partnership or other joint venture (other than a body corporate), please give the name and address of each party concerned.

Name
Address:
Registered number (where applicable)

Description of applicant (for example, partnership, company, unincorporated association etc.)
Telephone number (if any)
E-mail address (optional)

Part 3 Operating Schedule

When do you want the premises licence to start?

DD	MM	YYYY
2	0	1 1 2 0 2 8

If you wish the licence to be valid only for a limited period, when do you want it to end?

DD	MM	YYYY

Please give a general description of the premises (please read guidance note 1)

Off licence- selling alcoholic and non-alcoholic beverages.

If 5,000 or more people are expected to attend the premises at any one time, please state the number expected to attend.

--

What licensable activities do you intend to carry on from the premises?

(please see sections 1 and 14 and Schedules 1 and 2 to the Licensing Act 2003)

Provision of regulated entertainment (please read guidance note 2)	Please tick all that apply
a) plays (if ticking yes, fill in box A)	
b) films (if ticking yes, fill in box B)	
c) indoor sporting events (if ticking yes, fill in box C)	
d) boxing or wrestling entertainment (if ticking yes, fill in box D)	
e) live music (if ticking yes, fill in box E)	
f) recorded music (if ticking yes, fill in box F)	
g) performances of dance (if ticking yes, fill in box G)	

h)	anything of a similar description to that falling within (e), (f) or (g) (if ticking yes, fill in box H)	
----	--	--

<u>Provision of late night refreshment</u> (if ticking yes, fill in box I)	
<u>Supply of alcohol</u> (if ticking yes, fill in box J)	X

In all cases complete boxes K, L and M

A

Plays Standard days and timings (please read guidance note 7)			Will the performance of a play take place indoors or outdoors or both – please tick (please read guidance note 3)	Indoors	
				Outdoors	
				Both	
Day	Start	Finish			
Mon			Please give further details here (please read guidance note 4)		
Tue					
Wed			State any seasonal variations for performing plays (please read guidance note 5)		
Thur					
Fri			Non standard timings. Where you intend to use the premises for the performance of plays at different times to those listed in the column on the left, please list (please read guidance note 6)		
Sat					
Sun					

B

Films Standard days and timings (please read guidance note 7)			Will the exhibition of films take place indoors or outdoors or both – please tick (please read guidance note 3)	Indoors	
				Outdoors	
				Both	
Day	Start	Finish			
Mon			Please give further details here (please read guidance note 4)		
Tue					
Wed			State any seasonal variations for the exhibition of films (please read guidance note 5)		
Thur					
Fri			Non standard timings. Where you intend to use the premises for the exhibition of films at different times to those listed in the column on the left, please list (please read guidance note 6)		
Sat					
Sun					

C

Indoor sporting events Standard days and timings (please read guidance note 7)			<u>Please give further details</u> (please read guidance note 4)
Day	Start	Finish	
Mon			
Tue			<u>State any seasonal variations for indoor sporting events</u> (please read guidance note 5)
Wed			
Thur			
Fri			<u>Non standard timings. Where you intend to use the premises for indoor sporting events at different times to those listed in the column on the left, please list</u> (please read guidance note 6)
Sat			
Sun			

D

Boxing or wrestling entertainments Standard days and timings (please read guidance note 7)			<u>Will the boxing or wrestling entertainment take place indoors or outdoors or both – please tick</u> (please read guidance note 3)	Indoors	
Day	Start	Finish		Outdoors	
Mon				Both	
Tue			<u>Please give further details here</u> (please read guidance note 4)		
Wed					
Thur			<u>State any seasonal variations for boxing or wrestling entertainment</u> (please read guidance note 5)		
Fri					
Sat			<u>Non standard timings. Where you intend to use the premises for boxing or wrestling entertainment at different times to those listed in the column on the left, please list</u> (please read guidance note 6)		
Sun					

E

Live music Standard days and timings (please read guidance note 7)			<u>Will the performance of live music take place indoors or outdoors or both – please tick</u> (please read guidance note 3)	Indoors	
				Outdoors	
				Both	
Day	Start	Finish	<u>Please give further details here</u> (please read guidance note 4)		
Mon					
Tue					
Wed			<u>State any seasonal variations for the performance of live music</u> (please read guidance note 5)		
Thur					
Fri			<u>Non standard timings. Where you intend to use the premises for the performance of live music at different times to those listed in the column on the left, please list</u> (please read guidance note 6)		
Sat					
Sun					

F

Recorded music Standard days and timings (please read guidance note 7)			<u>Will the playing of recorded music take place indoors or outdoors or both – please tick</u> (please read guidance note 3)	Indoors	
				Outdoors	
				Both	
Day	Start	Finish	<u>Please give further details here</u> (please read guidance note 4)		
Mon					
Tue					
Wed			<u>State any seasonal variations for the playing of recorded music</u> (please read guidance note 5)		
Thur					
Fri			<u>Non standard timings. Where you intend to use the premises for the playing of recorded music at different times to those listed in the column on the left, please list</u> (please read guidance note 6)		
Sat					
Sun					

G

Performances of dance Standard days and timings (please read guidance note 7)			Will the performance of dance take place indoors or outdoors or both – please tick (please read guidance note 3)	Indoors	
				Outdoors	
				Both	
Day	Start	Finish			
Mon			Please give further details here (please read guidance note 4)		
Tue					
Wed			State any seasonal variations for the performance of dance (please read guidance note 5)		
Thur					
Fri			Non standard timings. Where you intend to use the premises for the performance of dance at different times to those listed in the column on the left, please list (please read guidance note 6)		
Sat					
Sun					

H

Anything of a similar description to that falling within (e), (f) or (g) Standard days and timings (please read guidance note 7)			Please give a description of the type of entertainment you will be providing		
Day	Start	Finish	Will this entertainment take place indoors or outdoors or both – please tick (please read guidance note 3)	Indoors	
Mon				Outdoors	
				Both	
Tue			Please give further details here (please read guidance note 4)		
Wed					
Thur			State any seasonal variations for entertainment of a similar description to that falling within (e), (f) or (g) (please read guidance note 5)		
Fri					
Sat			Non standard timings. Where you intend to use the premises for the entertainment of a similar description to that falling within (e), (f) or (g) at different times to those listed in the column on the left, please list (please read guidance note 6)		
Sun					

Late night refreshment Standard days and timings (please read guidance note 7)			Will the provision of late night refreshment take place indoors or outdoors or both – please tick (please read guidance note 3)	Indoors	
				Outdoors	
Day	Start	Finish		Both	
Mon			<u>Please give further details here</u> (please read guidance note 4)		
Tue					
Wed			<u>State any seasonal variations for the provision of late night refreshment</u> (please read guidance note 5)		
Thur					
Fri			<u>Non standard timings. Where you intend to use the premises for the provision of late night refreshment at different times, to those listed in the column on the left, please list</u> (please read guidance note 6)		
Sat					
Sun					

J

Supply of alcohol Standard days and timings (please read guidance note 7)			Will the supply of alcohol be for consumption – please tick (please read guidance note 8)	On the premises		
				Off the premises	X	
				Both		
Day	Start	Finis h	State any seasonal variations for the supply of alcohol (please read guidance note 5)			
Mon	0700	2400				
Tue	0700	2400				
Wed	0700	2400				
Thur	0700	2400				Non standard timings. Where you intend to use the premises for the supply of alcohol at different times to those listed in the column on the left, please list (please read guidance note 8)
Fri	0700	2400				
Sat	0700	2400				
Sun	0700	2400				

State the name and details of the individual whom you wish to specify on the licence as designated premises supervisor (Please see declaration about the entitlement to work in the checklist at the end of the form):

Name Mahsa Delafkar	
Date of birth	
Address	
Postcode	
Personal licence number (if known) applied for 12578/1	
Issuing licensing authority (if known) Birmingham City Council	

K

Please highlight any adult entertainment or services, activities, other entertainment or matters ancillary to the use of the premises that may give rise to concern in respect of children (please read guidance note 9).

L

Hours premises are open to the public Standard days and timings (please read guidance note 7)			State any seasonal variations (please read guidance note 5)
Day	Start	Finish	
Mon	0700	2400	Non standard timings. Where you intend the premises to be open to the public at different times from those listed in the column on the left, please list (please read guidance note 6)
Tue	0700	2400	
Wed	0700	2400	
Thur	0700	2400	
Fri	0700	2400	
Sat	0700	2400	
Sun	0700	2400	

M

Describe the steps you intend to take to promote the four licensing objectives:

a) General – all four licensing objectives (b, c, d and e) (please read guidance note 10)

Staff would be given training on retail sale of alcohol and licensing objectives. CCTV shall be installed to Home Office Guidance standards and maintained in a good working condition and recordings shall be kept for 31 days and shall be made available to police and authorised Officers from Birmingham City Council upon request.

b) The prevention of crime and disorder

CCTV shall be installed to Home Office Guidance standards and maintained in a good working condition and recordings shall be kept for 31 days and shall be made available to police and authorised Officers from Council upon request.

An incident and refusals log shall be kept at the premises and made available for inspection on request to police or the council

- a) Any complaints received.
- b) Any incidents of disorder.
- c) Any faults in the CCTV system.
- d) Any refusal of the sale of alcohol.
- e) Any visit by a relevant authority or emergency service.

c) Public safety

Generic and fire risk assessments will be in place.

d) The prevention of public nuisance

None needed.

e) The protection of children from harm

<p>Challenge 25 policy will be in place. All service staff will get 'retail sale of alcohol' training.</p>
--

Checklist:

Please tick to indicate agreement

• I have made or enclosed payment of the fee.	x
• I have enclosed the plan of the premises.	x
• I have sent copies of this application and the plan to responsible authorities and others where applicable.	x
• I have enclosed the consent form completed by the individual I wish to be designated premises supervisor, if applicable.	x
• I understand that I must now advertise my application.	x
<ul style="list-style-type: none"> • I understand that if I do not comply with the above requirements my application will be rejected. • [Applicable to all individual applicants, including those in a partnership which is not a limited liability partnership, but not companies or limited liability partnerships] I have included documents demonstrating my entitlement to work in the United Kingdom or my share code issued by the Home Office online right to work checking service (please read note 15). 	x

It is an offence, under Section 158 of the Licensing Act 2003, to make a false statement in or in connection with this application. Those who make a false statement may be liable on summary conviction to a fine of any amount.

It is an offence under Section 24b of the Immigration Act 1971 for a person to work when they know, or have reasonable cause to believe, that they are disqualified from doing so by reason of their immigration status. Those who employ an adult without leave or who is subject to conditions as to employment will be liable to a civil penalty under section 15 of the Immigration, Asylum and Nationality Act 2006 and pursuant to Section 21 of the same act, will be committing an offence where they do so in the knowledge, or with reasonable cause to believe, that the employee is disqualified.

Part 4 – Signatures (please read guidance note 11)

Signature of applicant or applicant's solicitor or other duly authorised agent (see guidance note 12). If signing on behalf of the applicant, please state in what capacity

Declaration	<ul style="list-style-type: none"> • [Applicable to individual applicants only, including those in a partnership which is not a limited liability partnership] I understand I am not entitled to be issued with a licence if I do not have the entitlement to live and work in the UK (or if I am subject to a condition preventing me from doing work relating to the carrying on of a licensable activity) and that my licence will become invalid if I cease to be entitled to live and work in the UK (please read guidance note 15).
-------------	--

	<ul style="list-style-type: none"> The DPS named in this application form is entitled to work in the UK (and is not subject to conditions preventing him or her from doing work relating to a licensable activity) and I have seen a copy of his or her proof of entitlement to work, or have conducted an online right to work check using the Home Office online right to work checking service which confirmed their right to work (please see note 15)
Signature	
Date	20.11.2023
Capacity	Leaseholder

For joint applications, signature of 2nd applicant or 2nd applicant's solicitor or other authorised agent (please read guidance note 13). If signing on behalf of the applicant, please state in what capacity.

Signature	
Date	
Capacity	

Contact name (where not previously given) and postal address for correspondence associated with this application (please read guidance note 14)			
Post town		Postcode	
Telephone number (if any)			
If you would prefer us to correspond with you by e-mail, your e-mail address (optional)			



Floor Plan of 39 Horse Fair , Birmingham, B1 1DA

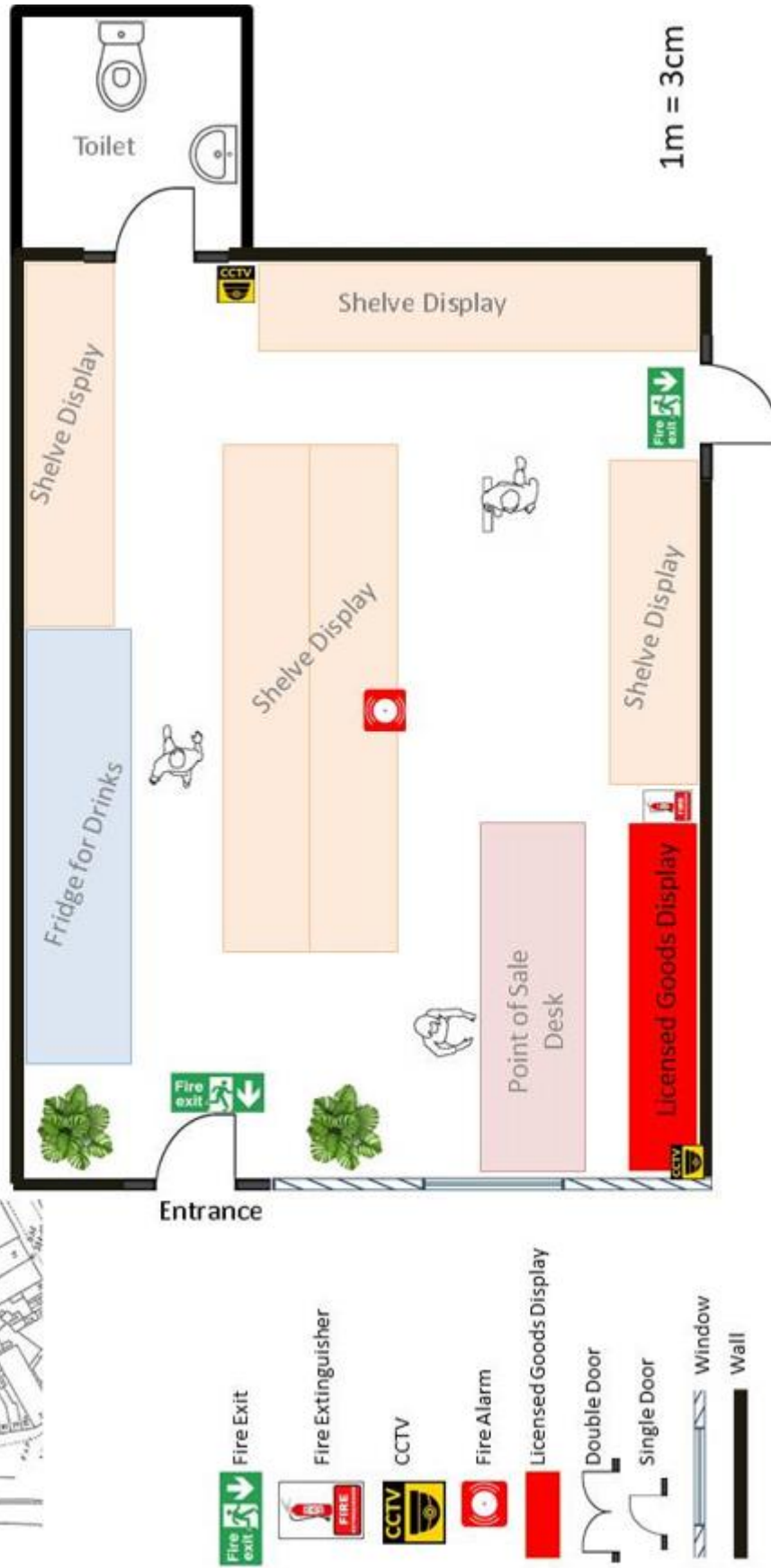

From: Mark Swallow <
Sent: 05 December 2023 08:42
To: 'Behzad'
Cc: Licensing
Subject: Grant Application: Mo Wine Shop: 39 Horse Fair, B1 1DA - 172800

Good Morning Licensing,

Reference the above application the applicants are happy for the additional conditions below to be added to the application.

West Midlands Police therefore with these additions have no objections to the application. I have copied the applicant into this email.

Mark Swallow.

From: Behzad
Sent: 04 December 2023 16:46
To: Mark Swallow
Subject: [External]: Mo wins

We confirm to adopt the proposed conditions in addition to the ones we mentioned in our application.

Thank you 🙏

Proposed Conditions:

An incident log and refusals log will be maintained at all times and will be checked and signed off by the DPS at regular intervals. These logs will be made available for inspection by any Responsible Authority, upon reasonable request.

No single cans/bottles of beer or cider will be sold at any time.

Receipts for all purchases from the wholesaler will be retained at the premises and made available for inspection by any Responsible Authority.

If the DPS / premises licence holder is not on site, there will be a member of staff left in charge of the premises who will have enough knowledge of the business to liaise with any of the responsible authorities as required.

The premises will not supply any form of drinking vessel to customers that are purchasing alcohol.

All off sales are only permitted in sealed containers No beer, lager cider or spirit mixtures over 5.5% ABV to be sold.

No miniature bottles of spirits to be sold Till prompts to be activated on all alcohol sales (Electronic or otherwise) As soon as possible, from the grant of this licence, the premises shall join the local Pubwatch, or other local crime reduction scheme approved by the police.

The Premises Licence Holder will ensure that the disturbance caused to the public is kept to a minimum, signage will be placed in a prominent place asking customers to respect our neighbours, and not to loiter at the front of the premises. This must be strictly controlled by the Premises Licence Holder at all times when the premises are open.

The premises staff will ensure that the frontage of the premises is checked regularly for litter and rubbish, clearing any debris away. No rubbish, including bottles, shall be moved, removed, or placed in outside areas between 2200 hours and 0800 hours.

All staff to be trained in the prevention of underage sales to a level commensurate with their duties. All such training to be updated as necessary, for instance when legislation changes, and should include training on how to deal with difficult customers. The training should be clearly documented and signed and dated by both the trainer and the member of staff receiving it. The documentation shall be available for inspection on request by any Responsible authority.

The premises licence holder or DPS will conduct pre-opening checks of the premises to ensure that there are no risks to patrons and that all safety precautions are in place.

The licence holder will ensure that all staff receive appropriate training. The licence holder would ensure that all staff are aware of their social and legal obligations and their responsibilities regarding the sale of alcohol. These training records will be retained at the premises, and staff training will take place twice per year.

All safety certificates and inspection reports will be kept on site and made available to Responsible Authorities upon request. A Fire Risk Assessment will be held by the Premises licence holder at the premises and made available for inspection at reasonable request.

Challenge 25 Signage shall be displayed prominently throughout the premises. A challenge 25 policy is in place and only recognised forms of ID will be accepted. {PASS accredited ID, passport, or photo driving licence}.

A minimum of two members of staff shall be on duty at the premises from 2200 hrs until the premises closes.

If for any reason the CCTV hard drive needs to be replaced the previous / old hard drive will be kept on site for a minimum of 31 days and made immediately available to any of the responsible authorities on request. The CCTV will be checked to ensure that it is working each week. This information will be stored for 12 weeks and made available to any of the responsible authorities on request.

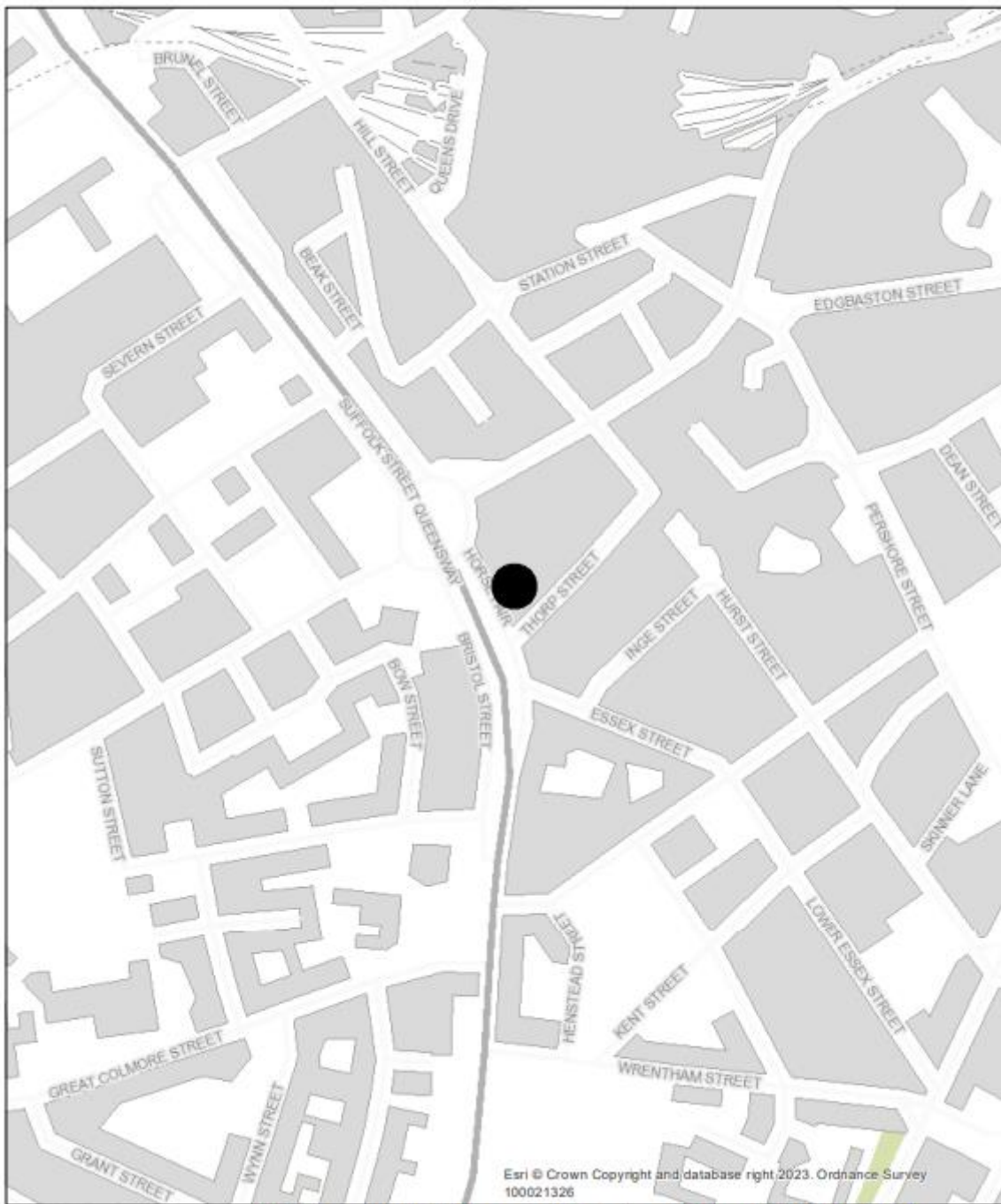

© Crown copyright. All rights reserved. Birmingham City Council 100021326 (2019)

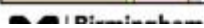

22