



Transport for  
**West Midlands**



**West  
Midlands**  
Rail Executive

# Delivering a Rail Revolution for Communities

Malcolm Holmes, Executive Director



**West  
Midlands  
Rail Executive**



**Transport for  
West Midlands**

# Birmingham AM Peak Modal Share

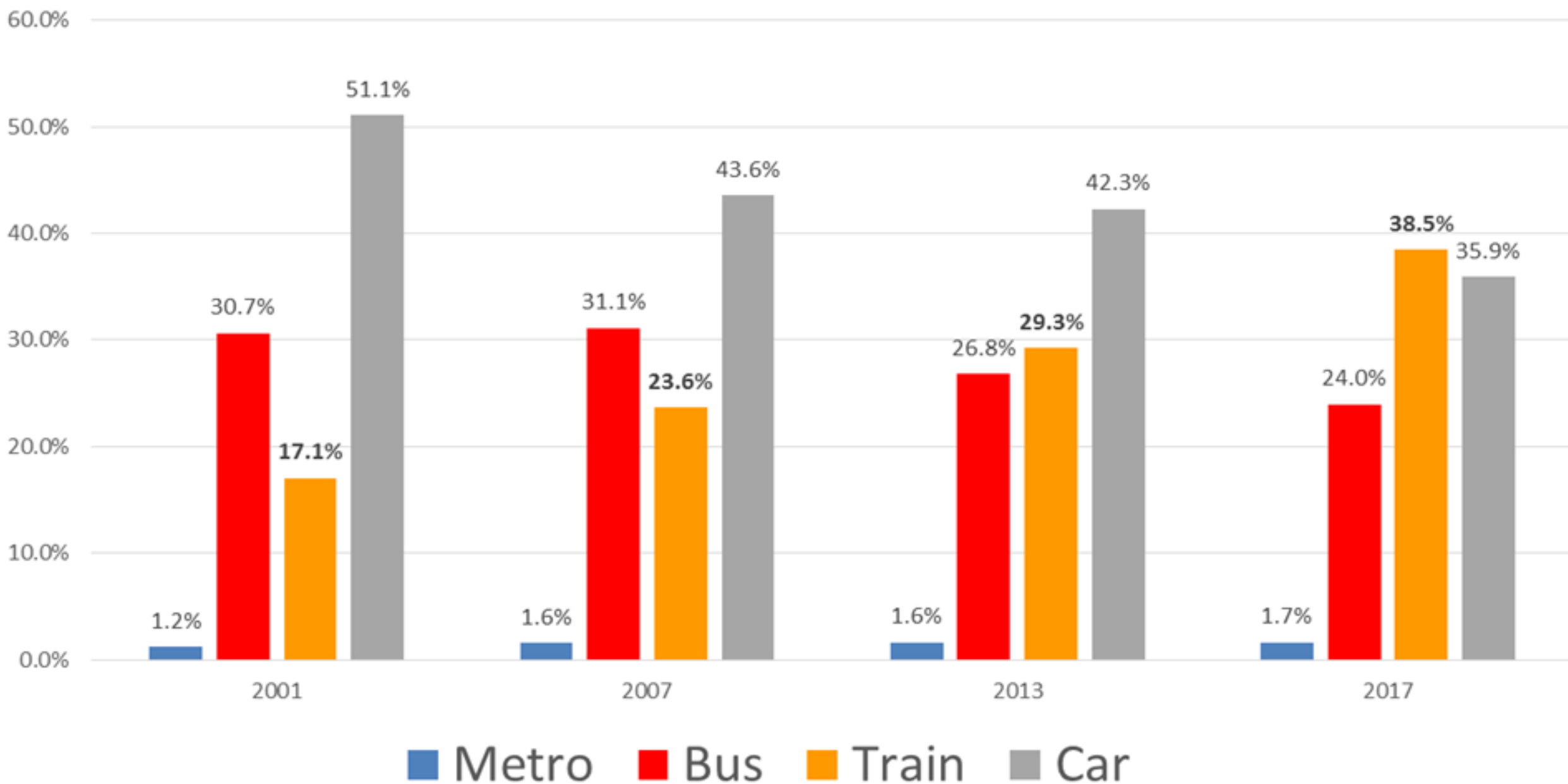







**West Midlands Rail Executive  
is a movement for change,  
driving a revolution in rail  
services for West Midlandsers**

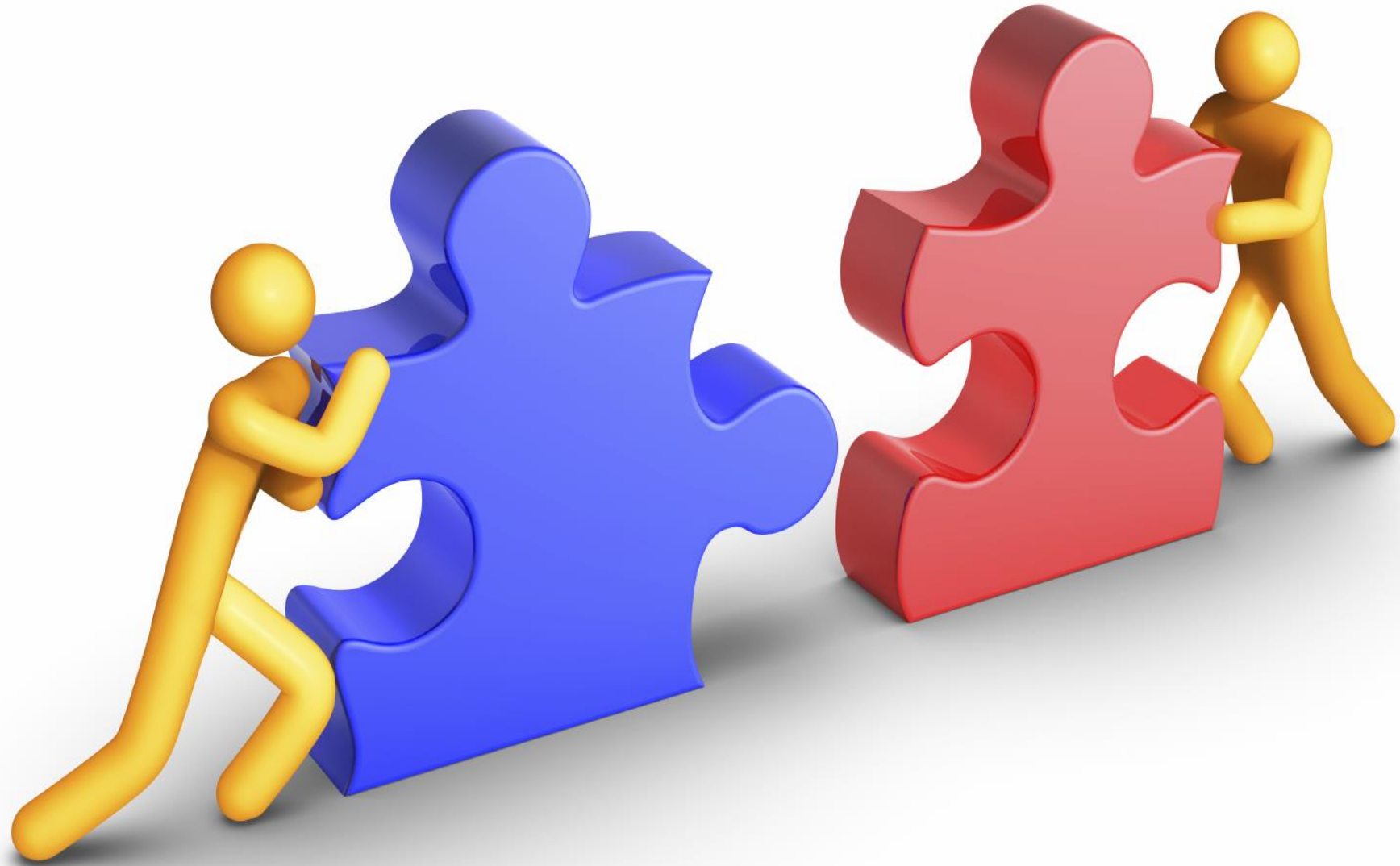

# WMRE Strategic Focus

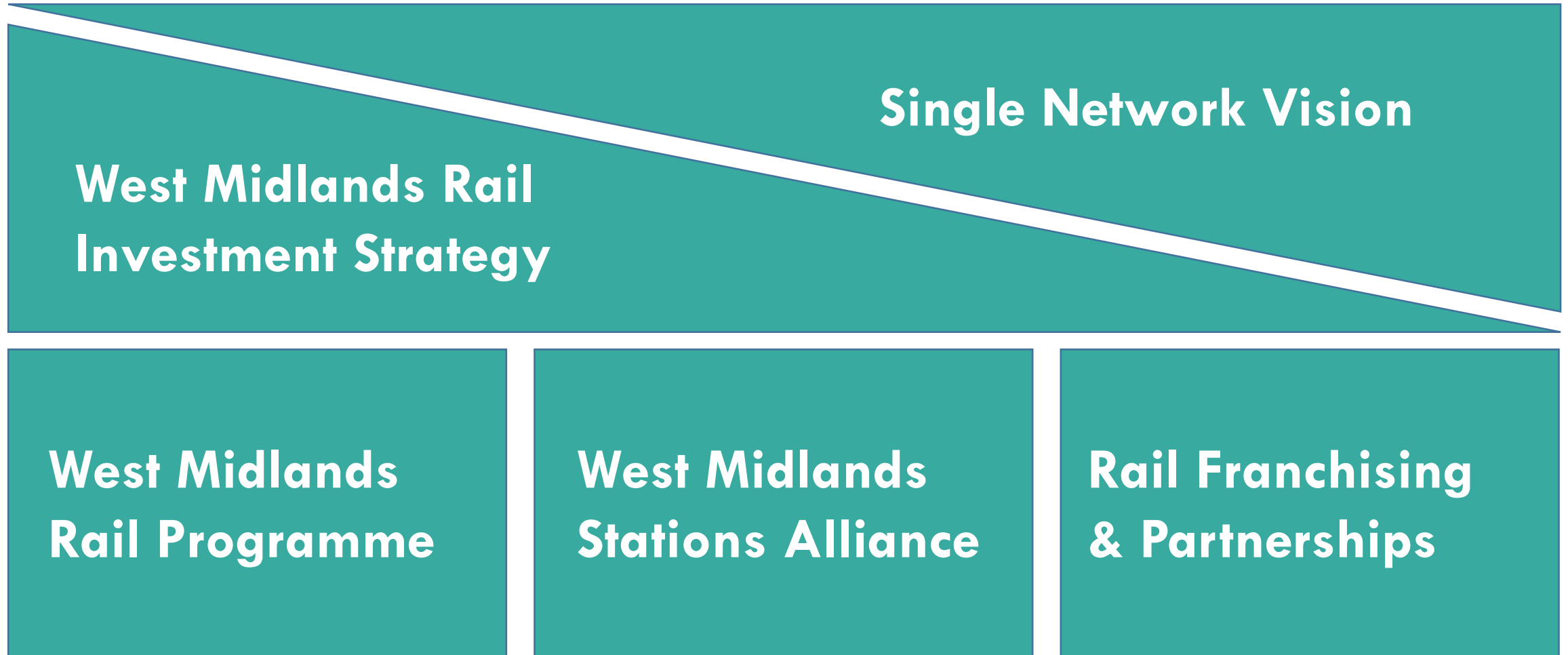



# WMRE Strategic Focus

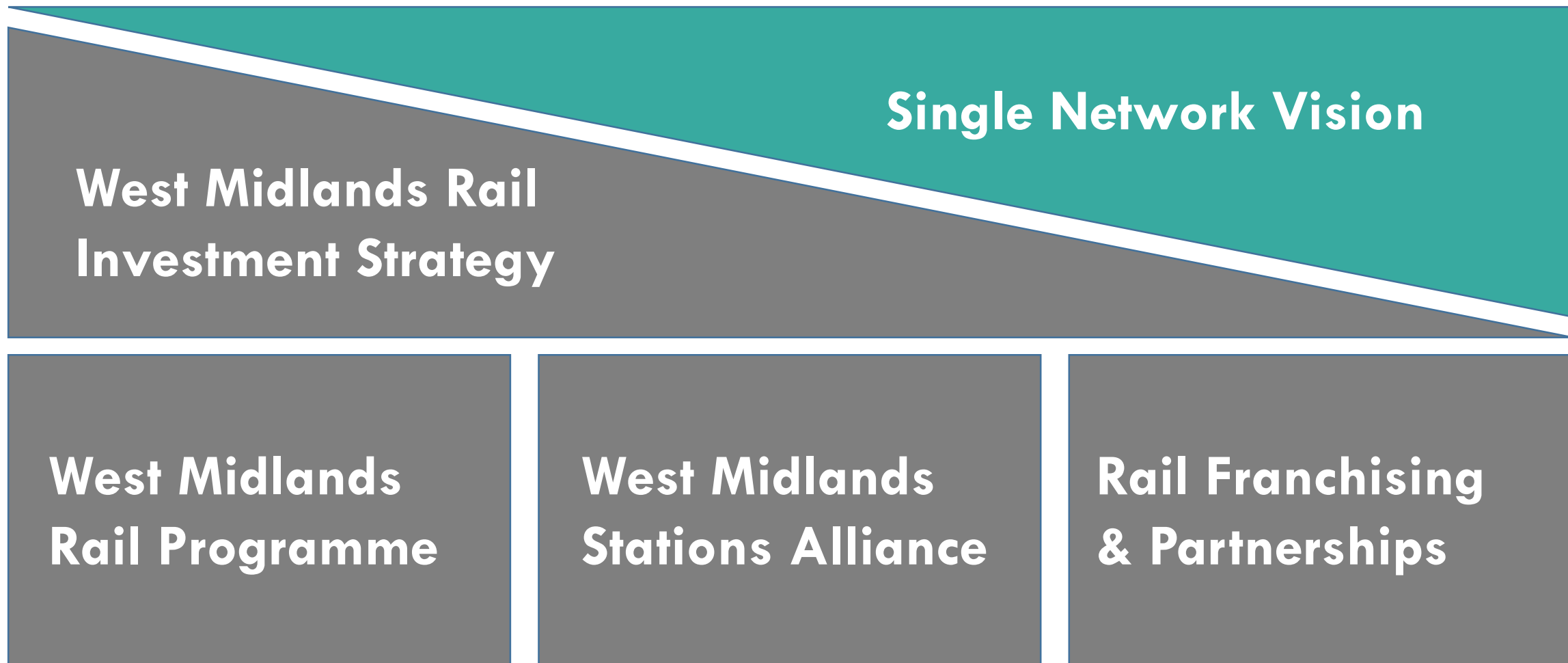



# Franchises in WMRE Area

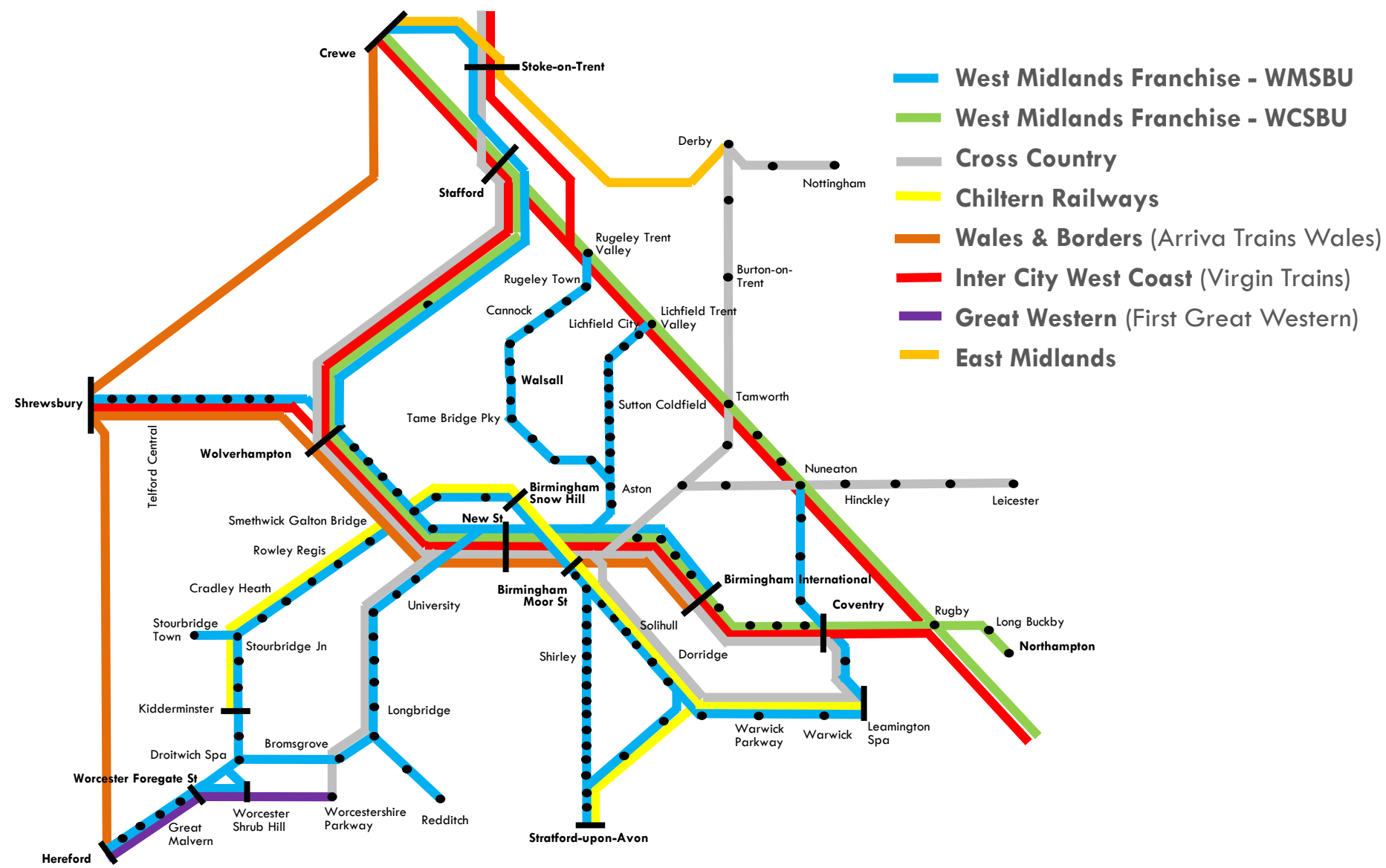

# WMRE Strategic Focus

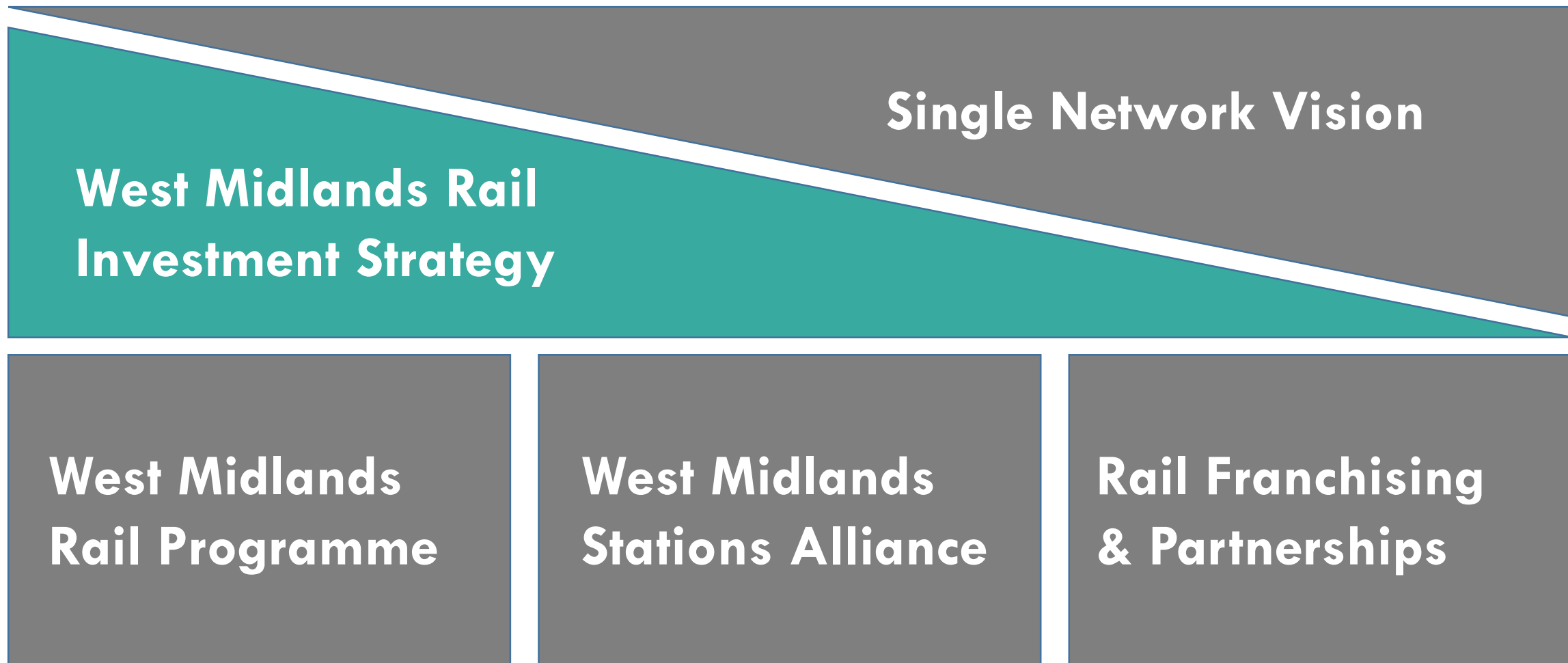

# Rail Investment Strategy

- 30-year strategy
- Consultation closed on Monday
- Outlines a line-by-line strategy for developing services based on economic evidence
- Will be adopted by both WMRE and TfWM

## A New Era for West Midlands Rail Travel

West Midlands Rail Executive

### A 30-year Rail Investment Strategy 2018-2047

Consultation Draft  
October 2018



1

**Deliver WMR  
Franchise  
Quick Wins**

2

**Implement  
6-4-2 tph  
frequency  
2018 - 2047**

3

**Support  
Midlands  
Rail Hub → 2032**

4

**Develop  
WMRE High  
Growth  
Corridors  
up to 2032**

5

**Support  
HS2**

6

**Consider  
radical  
change  
2033 - 2047**

7

**Integrate  
WMCA  
freight  
strategy**

# West Midlands Rail Investment Strategy 2018-2047: Overview

## A New Era for West Midlands Rail Travel

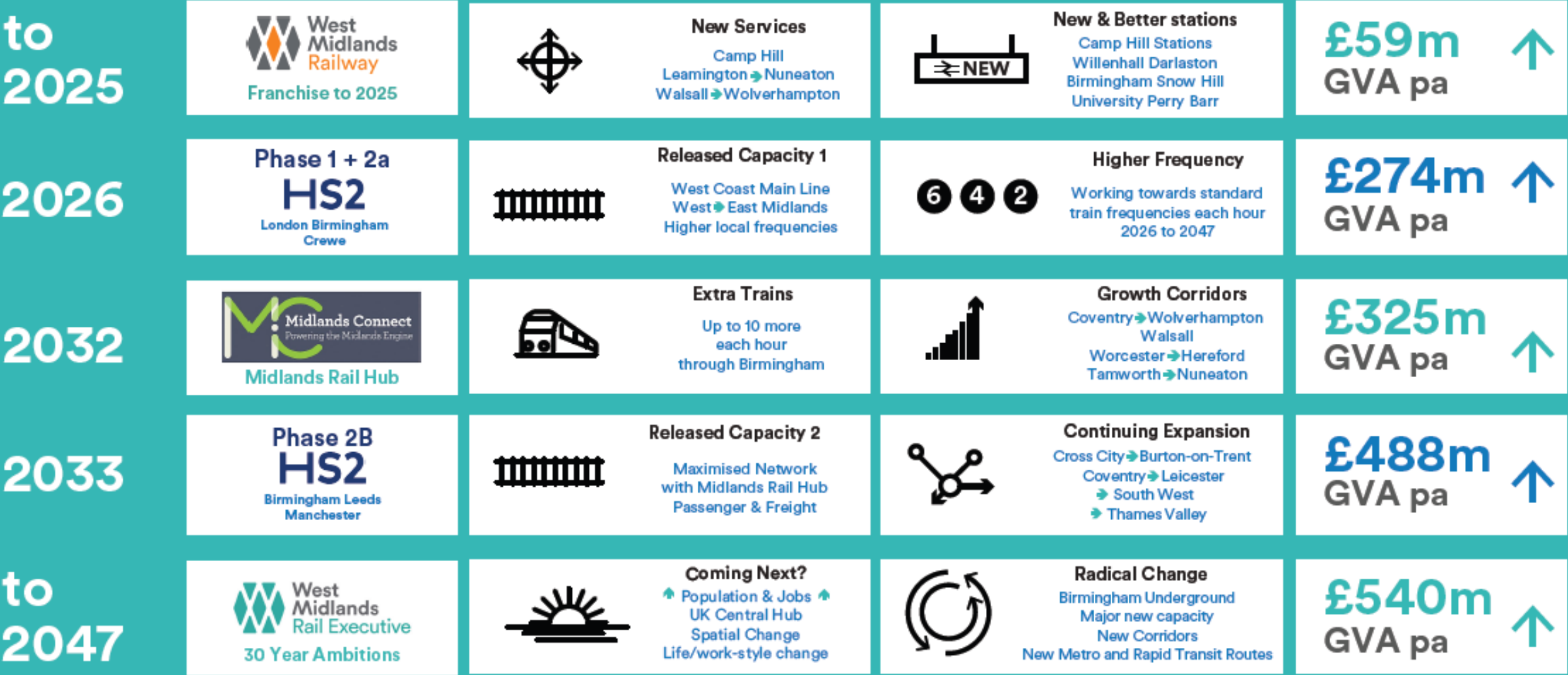
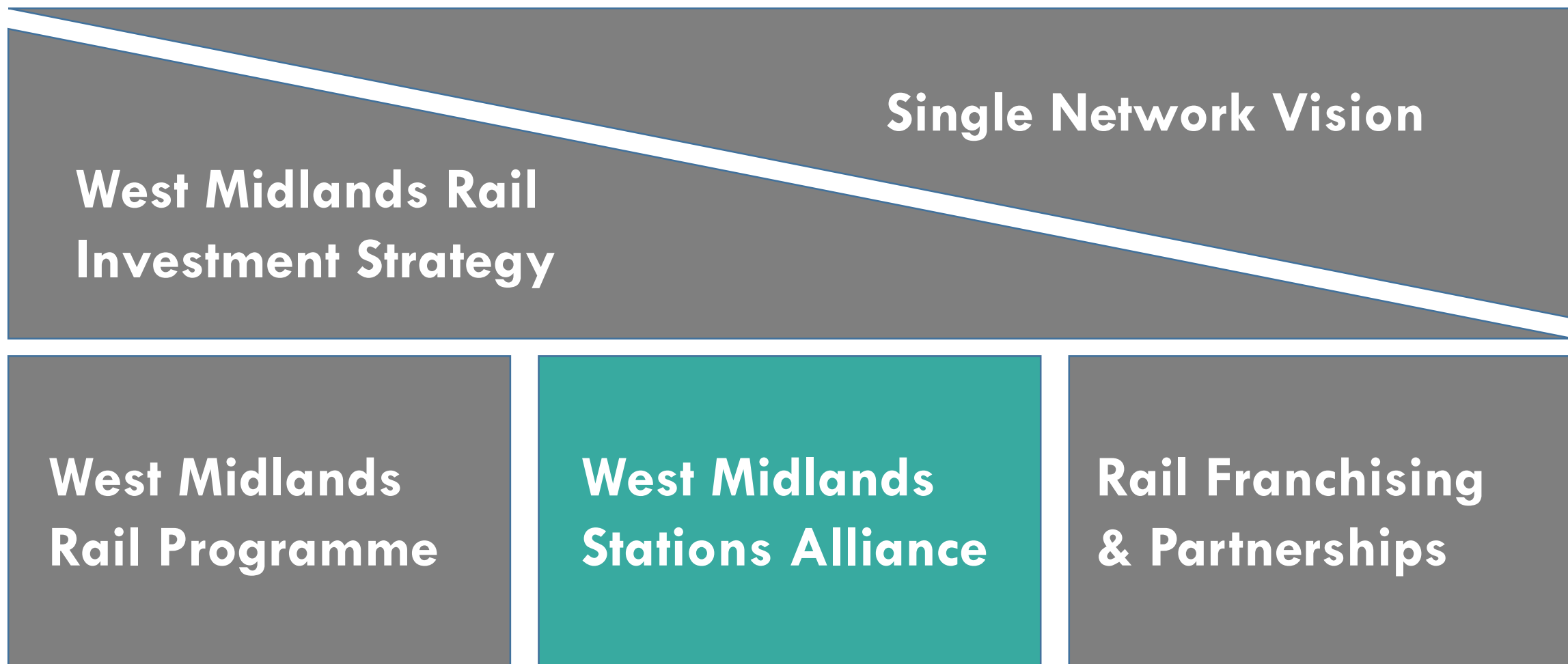

Figure 3 – West Midlands Rail Investment Strategy 2018-2047

# WMRE Strategic Focus







**West Midlands Stations Alliance**







# WMRE Strategic Focus

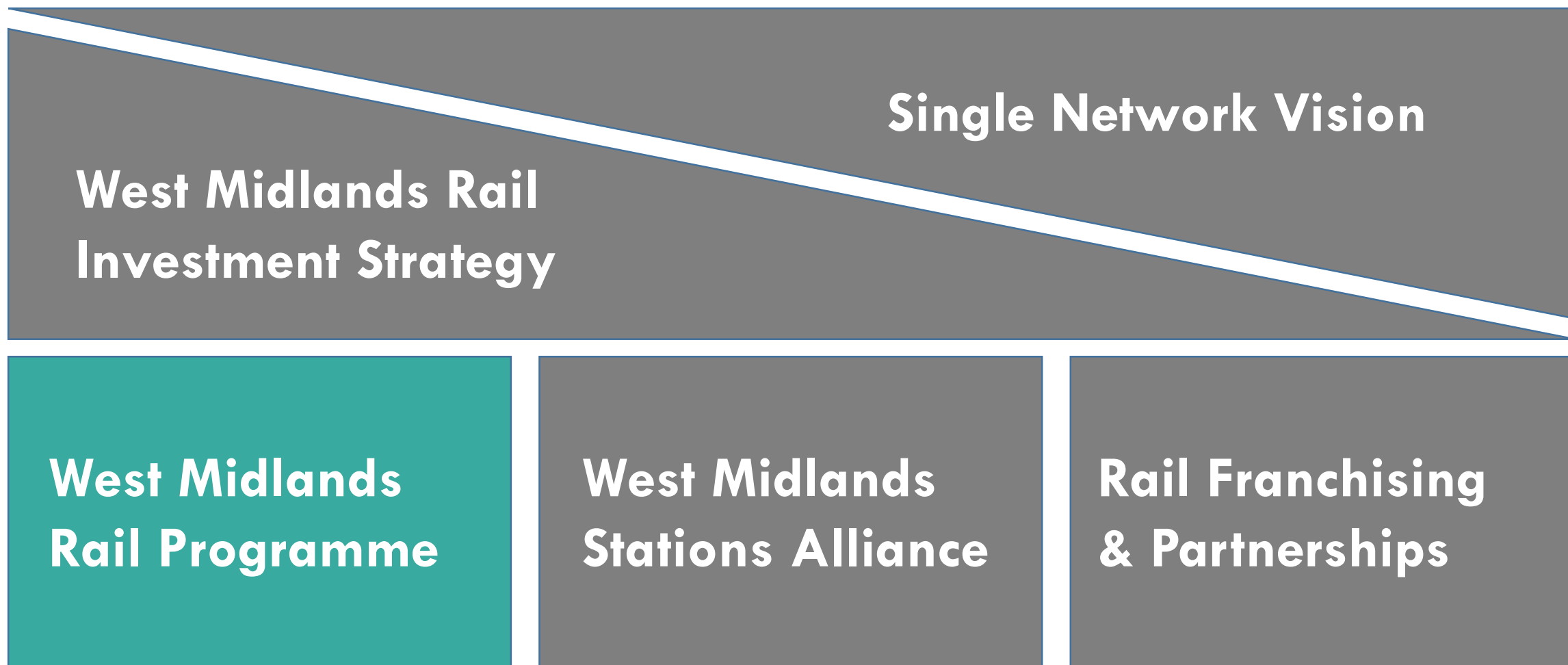

# Overview of West Midlands Station Investment Proposals

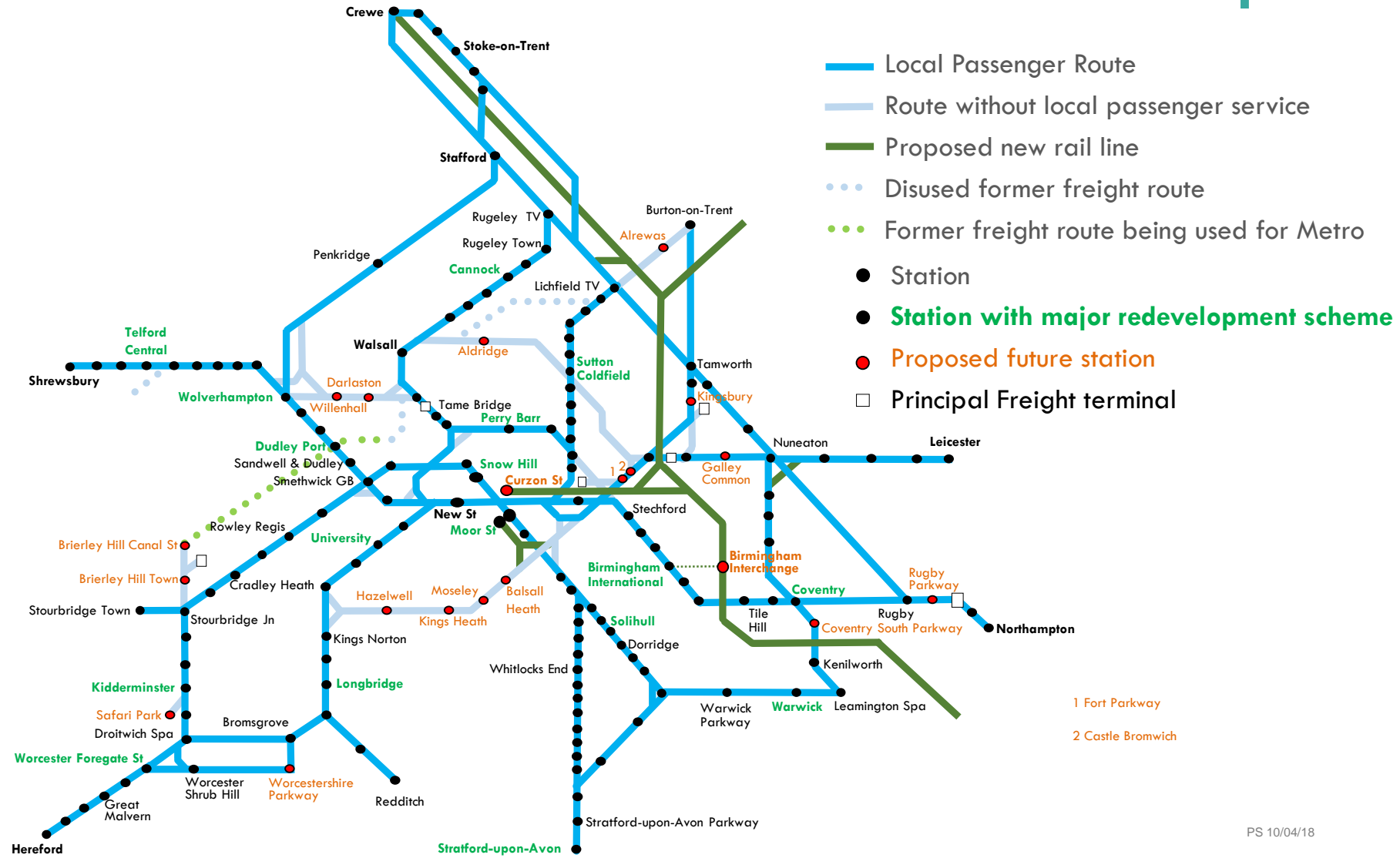

# New Stations – Package 2

- Camp Hill Line
  - New stations at Moseley, Kings Heath and Hazelwell
  - On a highly congested road corridor into Birmingham but an underutilised rail line
  - Significant commuting into Birmingham by car and bus currently which could transfer to rail.
  - No car parking provision
- Current programmes indicate delivery in 2021/22
- Active development work on train services to serve stations underway

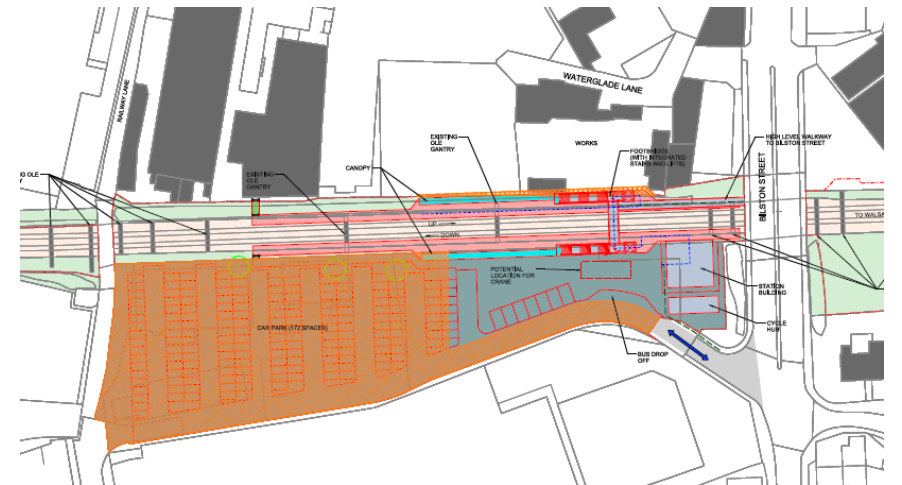











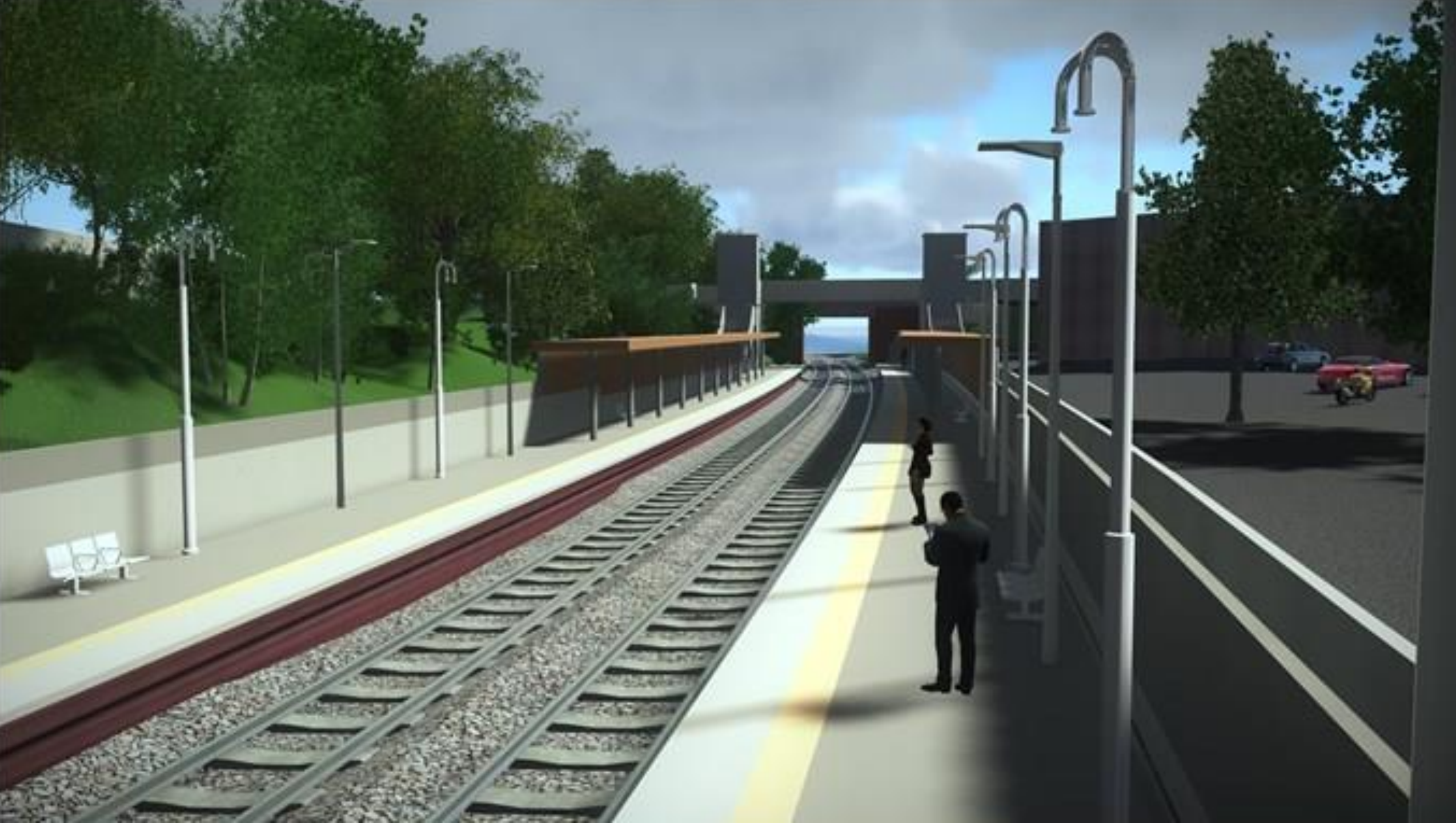



# University Station

- Current station cannot handle growth
- Major rebuild planned
- Links with UoB regeneration and Commonwealth Games



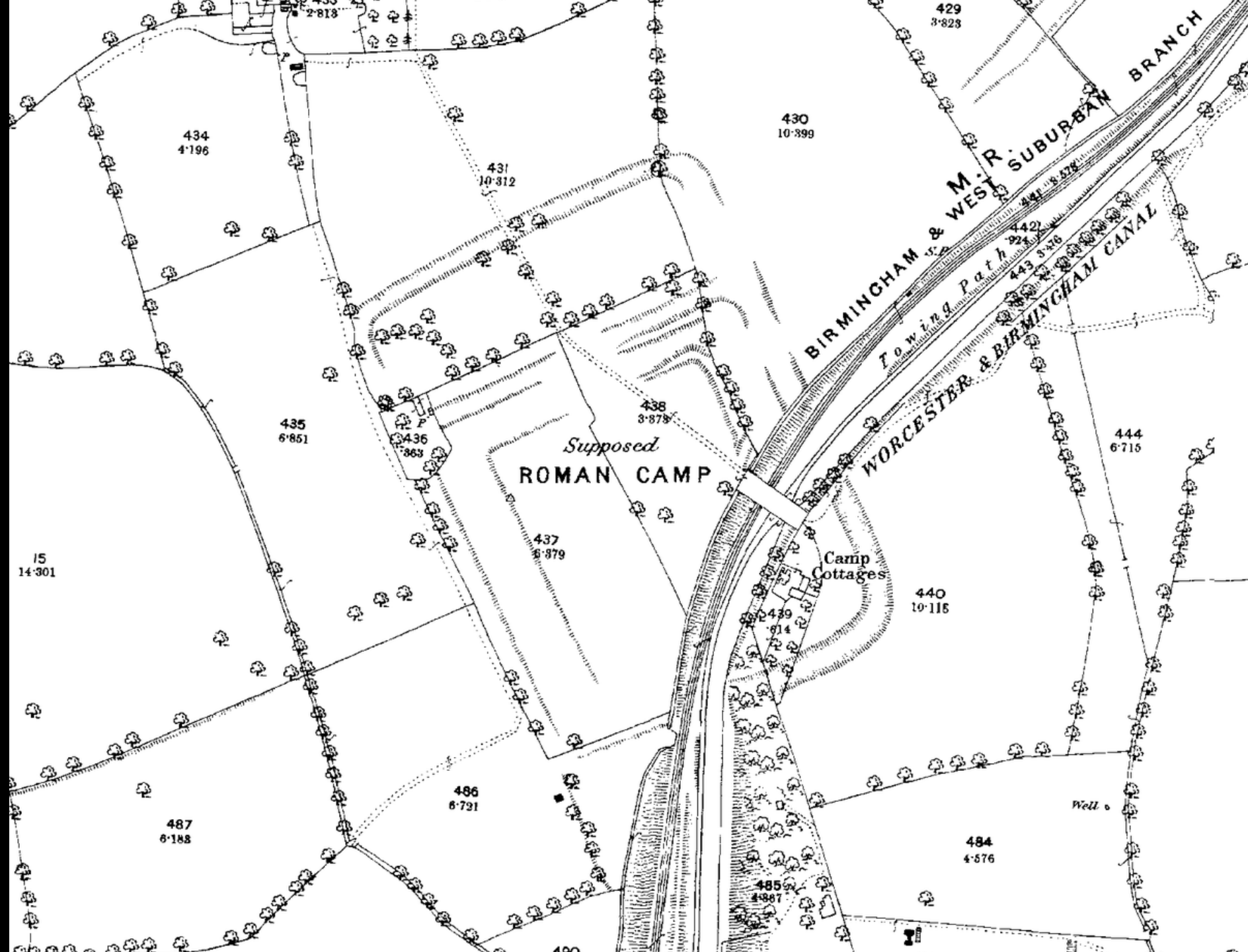











# University station – Our collaborative partnership



BRITISH RAIL  
STATION

PERRY BARR

Birmingham  
ageUK

0121 437 0181  
www.ageukbirmingham.org.uk

One Stop  
Shopping Centre  
Car Park

One Stop  
Shopping Centre  
U.C.E.

PRINCESS

HAIR & BEAUTY  
SALON

Mobile Tech

Welcome to  
Perry Barr

Birmingham

platform 1

Walsall

platform 2

Way in

0121 437 0181





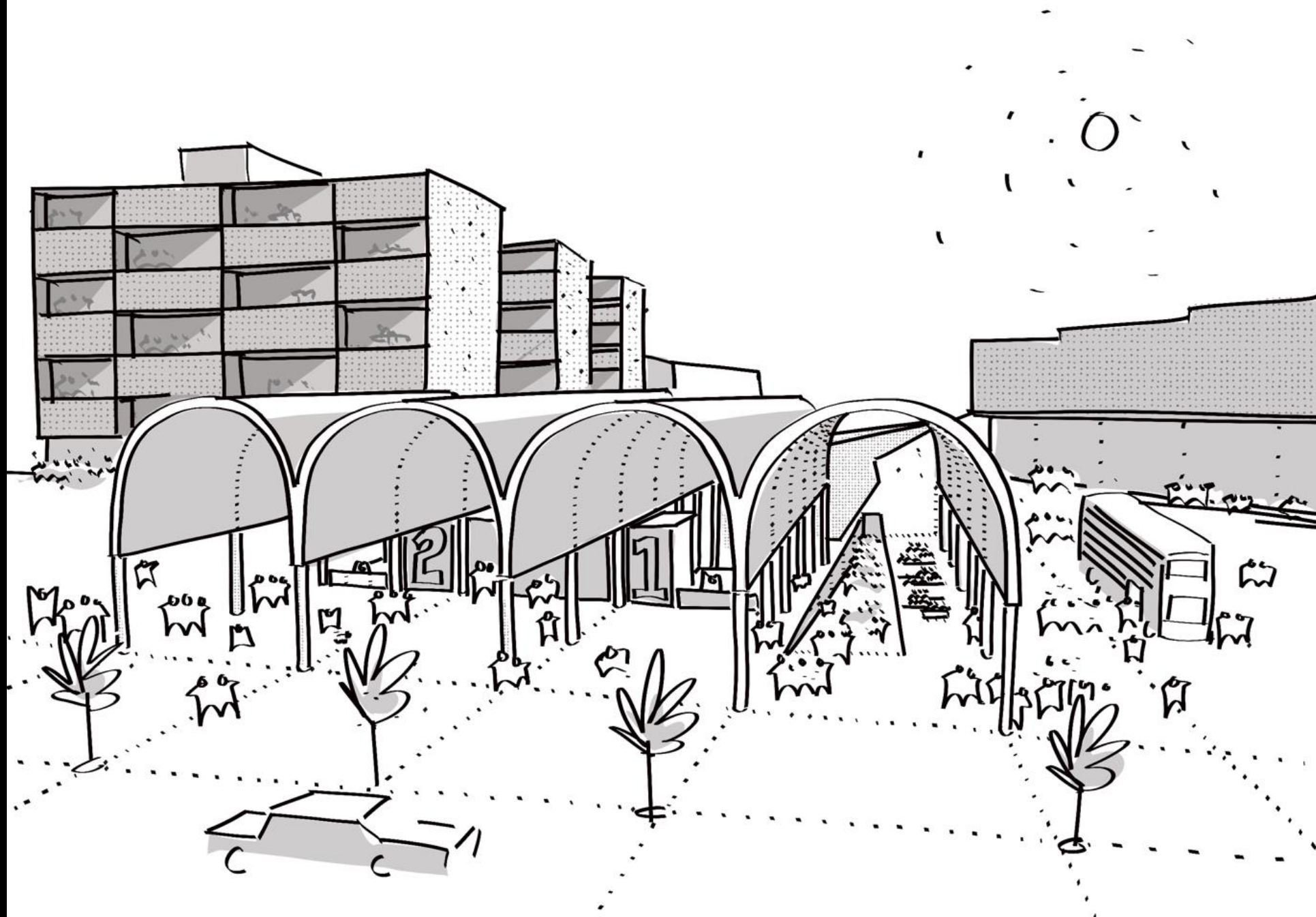



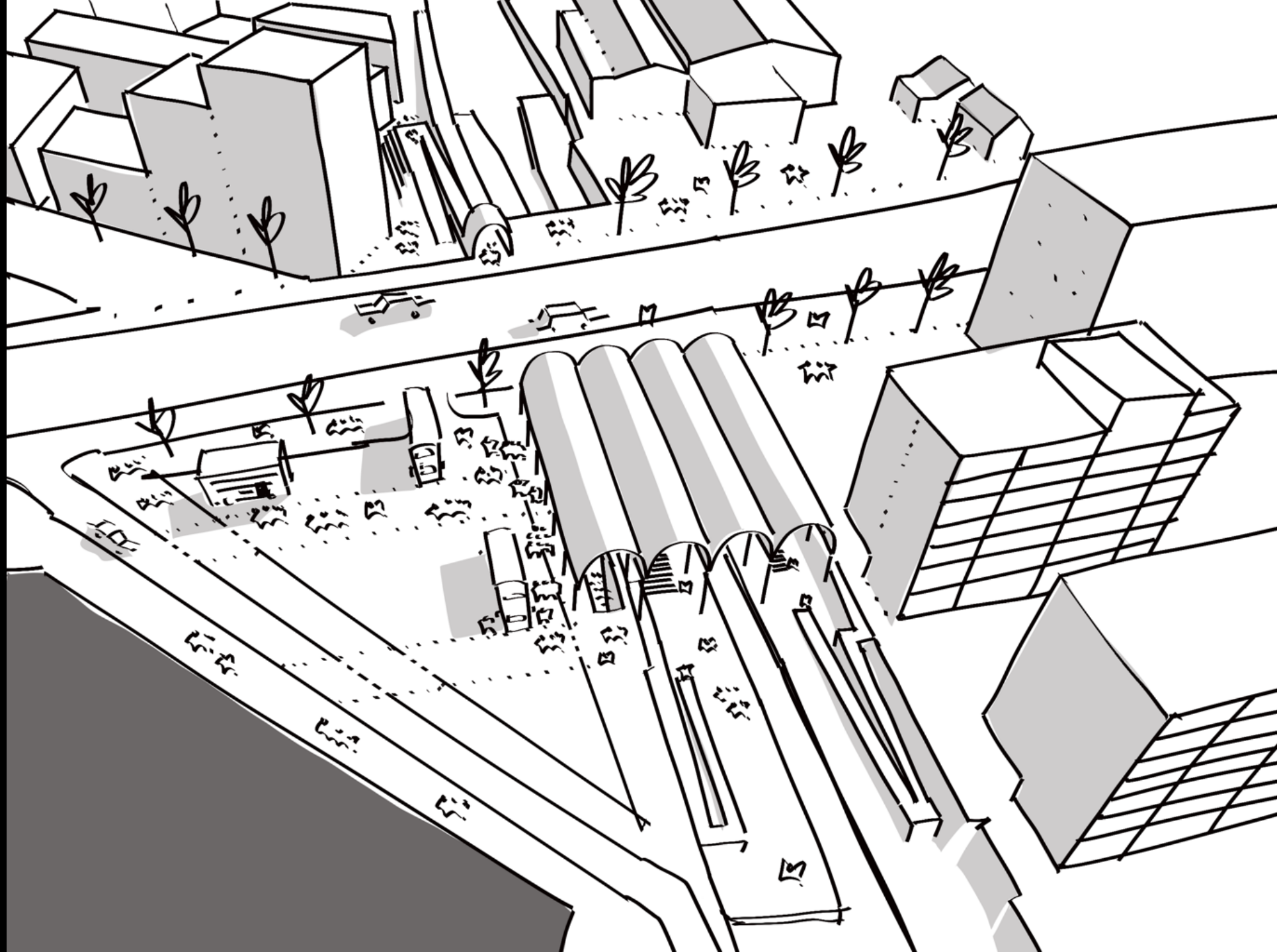

# Moor Street Station

- Major interchange with Curzon Street
- Will be at capacity in the next few years
- Substantial intervention required
- Initial concept study undertaken
- Includes 'One Station'
- Development funds required





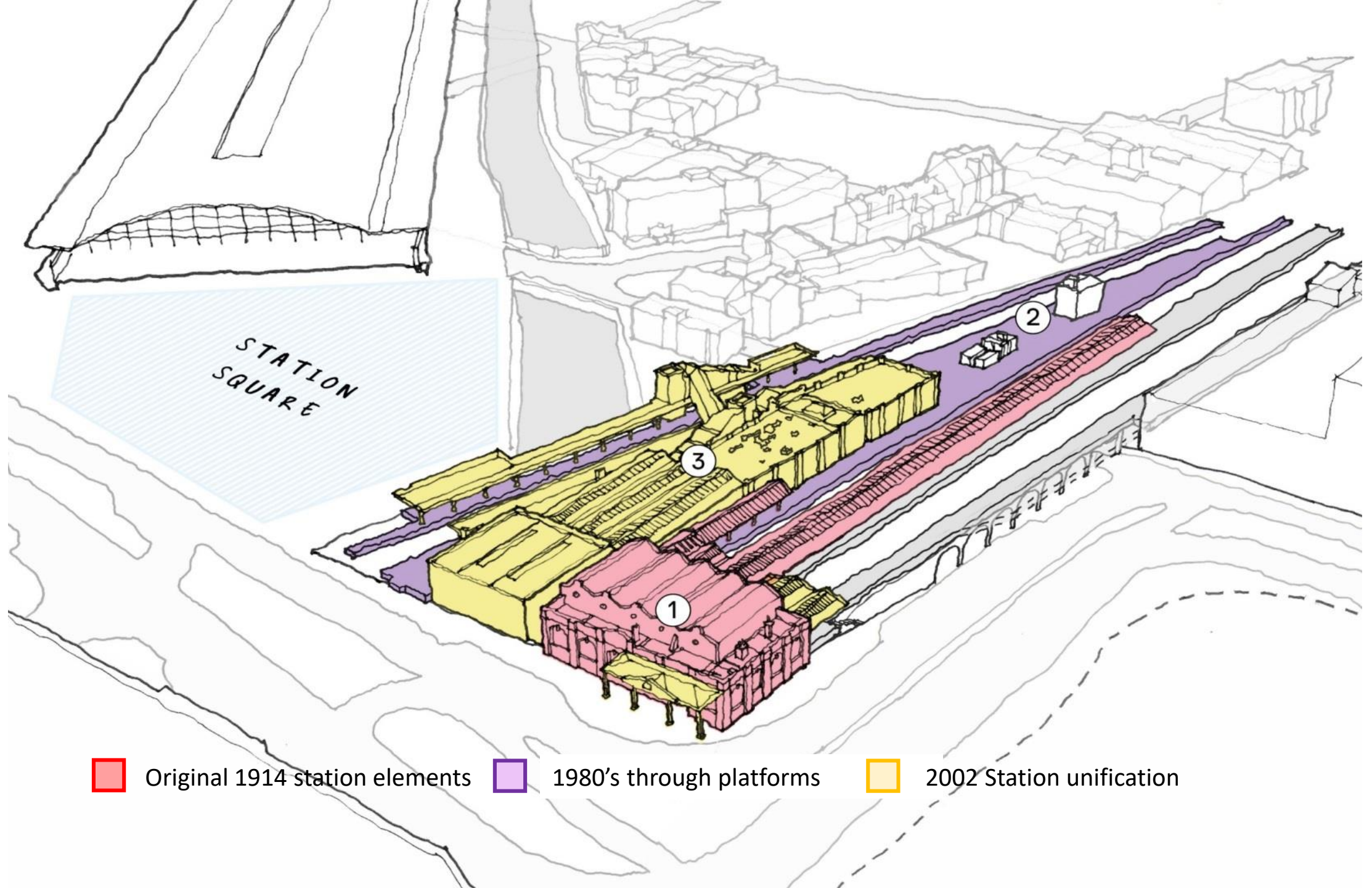





























# WMRE Strategic Focus

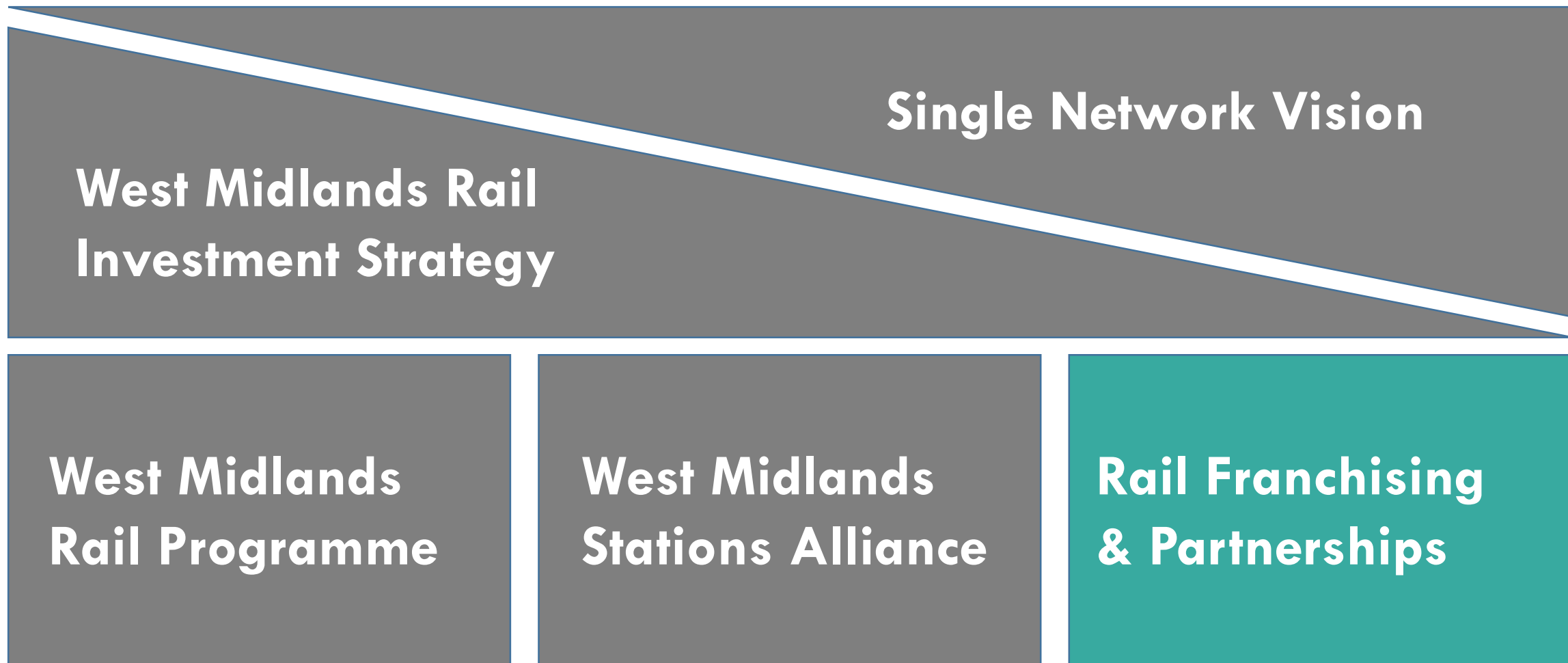





← Platforms 6 to 12  
← Yellow Lounge  
← Red Lounge

Platforms 1 to 5 →  
Blue Lounge →  
Red Lounge →

Tickets

Arrivals



# Separable Business Units







**West  
Midlands**  
Railway









# In Summary

- An exciting time for rail in the region
- Unprecedented investment
- Never before had such influence over our network







[wmre.org.uk](http://wmre.org.uk)  
[malcolm.holmes@wmre.org.uk](mailto:malcolm.holmes@wmre.org.uk)