

**BIRMINGHAM CITY COUNCIL****PUBLIC REPORT**

<b>Report to:</b>	<b>Licensing Sub Committee C</b>
<b>Report of:</b>	<b>Acting Director of Regulation &amp; Enforcement</b>
<b>Date of Meeting:</b>	<b>Wednesday 5<sup>th</sup> December 2018</b>
<b>Subject:</b>	<b>Licensing Act 2003 Premises Licence – Variation</b>
<b>Premises:</b>	<b>The Botanist, Cheltenham House, 14-16 Temple Street, Birmingham, B2 5BG</b>
<b>Ward affected:</b>	<b>Ladywood</b>
<b>Contact Officer:</b>	<b>Bhupinder Nandhra, Senior Licensing Officer, 0121 303 9896 <a href="mailto:licensing@birmingham.gov.uk">licensing@birmingham.gov.uk</a></b>

**1. Purpose of report:**

To consider relevant representations that have been made in respect of an application to vary the Premises Licence which seeks to extend the hours for the Sale of Alcohol (for consumption both on and off the premises) to operate from 09:00am until 01:00am (Sunday to Wednesday) and 09:00am until 02:00am (Thursday to Saturday).

To extend the hours for the provision of Regulated Entertainment consisting of live music and recorded music to operate indoors only from 09:00am until 01:00am (Sunday to Wednesday) and 09:00am until 02:00am (Thursday to Saturday).

To extend the hours for the provision of late night refreshment from 11:00pm until 01:30am (Sunday to Wednesday) and 11:00pm until 02:30am (Thursday to Saturday).

Premises to remain open to the public from 09:00am until 01:30am (Sunday to Wednesday) and 09:00am until 02:30am (Thursday to Saturday).

Other dates and times as specified in the application form.

**2. Recommendation:**

To consider the representations that have been made and to determine the application.

**3. Brief Summary of Report:**

Variation application received on 15<sup>th</sup> October 2018 in respect of The Botanist, Cheltenham House, 14-16 Temple Street, Birmingham, B2 5BG.

Representations have been received from West Midlands Police and Environmental Health, as responsible authorities.

<b>4. Compliance Issues:</b>
<b>4.1 Consistency with relevant Council Policies, Plans or Strategies:</b>
<p>The report complies with the City Council's Statement of Licensing Policy and the Council's Corporate Plan to improve the standard of all licensed persons, premises and vehicles in the City.</p>
<b>5. Relevant background/chronology of key events:</b>
<p>New World Trading Company (UK) Limited applied on 15<sup>th</sup> October 2018 to vary the Premises Licence for The Botanist, Cheltenham House, 14-16 Temple Street, Birmingham, B2 5BG.</p> <p>Representations have been received from West Midlands Police and Environmental Health, as responsible authorities. See Appendices 1 - 2.</p> <p>The application is attached at Appendix 3.</p> <p>The current Premises Licence is attached at Appendix 4.</p> <p>Site Location Plans at Appendix 5.</p> <p>When carrying out its licensing functions, a licensing authority must have regard to Birmingham City Council's Statement of Licensing Policy and the Guidance issued by the Secretary of State under s182 of the Licensing Act 2003. The Licensing Authority is also required to take such steps as it considers appropriate for the promotion of the licensing objectives, which are:-</p> <ul style="list-style-type: none"> <li>a. The prevention of crime and disorder;</li> <li>b. Public safety;</li> <li>c. The prevention of public nuisance; and</li> <li>d. The protection of children from harm.</li> </ul>
<b>6. List of background documents:</b>
<p>Copies of the representations are detailed in Appendices 1 – 2</p> <p>Application Form, Appendix 3</p> <p>Current Premises Licence, Appendix 4</p> <p>Site Location Plans, Appendix 5</p>
<b>7. Options available</b>
<p>To grant the variation application</p> <p>To refuse the whole or part of the application</p> <p>To modify the conditions of the Licence</p>

---

**From:** bw licensing  
**Sent:** 16 October 2018 09:22  
**To:** Licensing Online  
**Subject:** RE: Online Variation - The Botanist Ref 697933

Dear Licensing,

West Midlands Police had been consulted prior to this application going in, and had indicated to the solicitors that any such application would likely attract an objection from us.

West Midlands Police do object to this application on the following grounds, the city centre entertainment area has expanded rapidly over the last 12-18 months, and covers an area from Temple Street, Temple Row West, Colmore Row. In this time there has been an number of new licensed premises to the area all of which are similar in style in that they are bar/restaurant set ups.

This area currently requires little policing and causes little issues mainly due to the operating hours of the majority of premises in the locality. When applications have been coming in we have endorsed a closing time of 1am, which has been accepted. With a 1am closing time the nature of the clientele that frequents the area is significantly different to that of the two more recognised night time economy areas in Birmingham City Centre. This has even been recognised by other venues within the other entertainment areas that the city centre venues attract a better clientele due to the hours.

This application seeks to change these hours to hours that we would class as a greater risk and attract a different clientele. As indicated currently the area and this premises does not cause us any concern for which we do not need to do a Policing plan for, there are residential units very close by for which we do not receive any complaints. In our professional opinion as experts in managing the night time economy, this application would change the situation in this area, it would encourage a level of ASB and crime and disorder that is not witnessed currently.

West Midlands Police therefore request a hearing for this application to be considered

Kind regards

**Abs Rohomon**

**PC 4075 Rohomon  
BW Licensing  
Police headquarters  
Lloyd House  
Colmore Circus  
Birmingham  
B4 6NQ**

**Follow us on Twitter - @brumcopslicensing**

**West Midlands Police**

**Website:** [www.west-midlands.police.uk](http://www.west-midlands.police.uk)  
**Twitter:** [www.twitter.com/brumpolice](https://www.twitter.com/brumpolice)  
**Facebook:** [www.facebook.com/westmidlandspolice](https://www.facebook.com/westmidlandspolice)  
**YouTube:** [www.youtube.com/westmidlandspolice](https://www.youtube.com/westmidlandspolice)

**Vision statement - Serving our communities, protecting them from harm**

---

**From:** Paul R Samms  
**Sent:** 12 November 2018 17:02  
**To:** Licensing  
**Cc:** '  
**Subject:** FW: Online Variation - The Botanist Ref 697933  
**Attachments:** birmingham-697933-The Botanist Birmingham Variation.pdf

I, Paul R Samms, as a representative of Environmental Health, formally raise a representation on the above application.

My representation(s) concern the likely effect of the grant of the licence on the promotion of the following licensing objective: **the prevention of public nuisance**

I am concerned that the grant of the licence would undermine the licence objective for the prevention of public nuisance.

I am liaising with the applicant to try to seek a way to address the issue. I will be in contact with you in the week or so with further information about my representation.

Regards,

Paul Samms  
Environmental Protection Officer

Environmental Protection Unit  
Environmental Health  
Manor House  
40 Moat Lane  
Digbeth  
Birmingham  
B5 5BD

Environmental Health, Regulation & Enforcement, Birmingham City Council, PO BOX 15908, Birmingham, B2 2UD

Website: <http://www.birmingham.gov.uk/eh>  
Facebook: <http://www.facebook.com/ehbham>  
Twitter: <http://www.twitter.com/ehbham>  
Flickr: <http://www.flickr.com/photos/envhbham>

"Locally accountable and responsive fair regulation for all - achieving a safe, healthy, clean, green and fair trading city for residents, business and visitors"

108384  
15/10/18 - 12/11/18



**Birmingham**  
**Application to vary a premises licence**  
**Licensing Act 2003**

For help contact  
[licensingonline@birmingham.gov.uk](mailto:licensingonline@birmingham.gov.uk)  
Telephone: 0121 303 9896

\* required information

**Section 1 of 18**

You can save the form at any time and resume it later. You do not need to be logged in when you resume.

System reference  This is the unique reference for this application generated by the system.

Your reference  You can put what you want here to help you track applications if you make lots of them. It is passed to the authority.

Are you an agent acting on behalf of the applicant?

☒ Yes ☐ No

**Applicant Details**

\* First name

\* Family name

\* E-mail

Main telephone number

Other telephone number

☐ Indicate here if the applicant would prefer not to be contacted by telephone

Is the applicant:

☒ Applying as a business or organisation, including as a sole trader

☐ Applying as an individual

Put "no" if you are applying on your own behalf or on behalf of a business you own or work for.

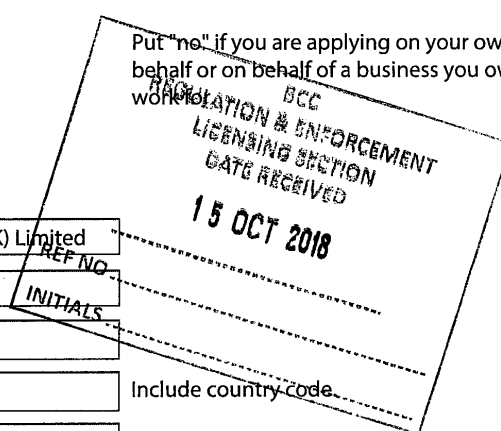

Include country code

**Applicant Business**

Is the applicant's business registered in the UK with Companies House? ☒ Yes ☐ No

Note: completing the Applicant Business section is optional in this form.

Registration number

Business name

If the applicant's business is registered, use its registered name.

VAT number

Put "none" if the applicant is not registered for VAT.

Legal status

**Continued from previous page...**

Applicant's position in the business

Home country

The country where the applicant's headquarters are.

**Registered Address**

Address registered with Companies House.

Building number or name

Street

District

City or town

County or administrative area

Postcode

Country

**Agent Details**

\* First name

\* Family name

\* E-mail

Main telephone number

Include country code.

Other telephone number

☐ Indicate here if you would prefer not to be contacted by telephone

Are you:

☒ An agent that is a business or organisation, including a sole trader

A sole trader is a business owned by one person without any special legal structure.

☐ A private individual acting as an agent

**Agent Business**

Is your business registered in the UK with Companies House? ☒ Yes ☐ No

Note: completing the Applicant Business section is optional in this form.

Registration number

Business name

If your business is registered, use its registered name.

VAT number

Put "none" if you are not registered for VAT.

Legal status

*Continued from previous page...*

Your position in the business

Home country

The country where the headquarters of your business is located.

**Agent Registered Address**

Address registered with Companies House.

Building number or name

Street

District

City or town

County or administrative area

Postcode

Country

**Section 2 of 18**

**APPLICATION DETAILS**

**This application cannot be used to vary the licence so as to extend the period for which the licence has effect or to vary substantially the premises to which it relates. If you wish to make that type of change to the premises licence, you should make a new premises licence application under section 17 of the Licensing Act 2003.**

I/we, as named in section 1, being the premises licence holder, apply to vary a premises licence under section 34 of the Licensing Act 2003 for the premises described in section 2 below.

\* Premises Licence Number

Are you able to provide a postal address, OS map reference or description of the premises?

☒ Address ☐ OS map reference ☐ Description

**Postal Address Of Premises**

Building number or name

Street

District

City or town

County or administrative area

Postcode

Country

**Premises Contact Details**

Telephone number

<b>Continued from previous page...</b>	
Non-domestic rateable value of premises (£)	<input style="width: 100%;" type="text"/>
<b>Section 3 of 18</b>	
<b>VARIATION</b>	
<p>Do you want the proposed variation to have effect as soon as possible?      <input checked="" type="radio"/> Yes      <input type="radio"/> No</p> <p>Do you want the proposed variation to have effect in relation to the introduction of the late night levy?      <input type="radio"/> Yes      <input checked="" type="radio"/> No</p> <p style="text-align: right; margin-top: 10px;">You do not have to pay a fee if the only purpose of the variation for which you are applying is to avoid becoming liable to the late night levy.</p> <p>If your proposed variation would mean that 5,000 or more people are expected to attend the premises at any one time, state the number expected to attend      <input style="width: 100px;" type="text"/></p> <p><b>Describe Briefly The Nature Of The Proposed Variation</b></p> <p>Describe the premises. For example the type of premises, its general situation and layout and any other information which could be relevant to the licensing objectives. Where your application includes off-supplies of alcohol and you intend to provide a place for consumption of these off-supplies, you must include a description of where the place will be and its proximity to the premises.</p> <div style="border: 1px solid black; padding: 5px; min-height: 40px;"> <p>The purpose of this application is to extend the hours for licensable activities and opening by 1 hour daily, and in light of this extension to add non-standard timings for BST.</p> </div>	
<b>Section 4 of 18</b>	
<b>PROVISION OF PLAYS</b>	
<p>See guidance on regulated entertainment</p> <p>Will the schedule to provide plays be subject to change if this application to vary is successful?      <input type="radio"/> Yes      <input checked="" type="radio"/> No</p>	
<b>Section 5 of 18</b>	
<b>PROVISION OF FILMS</b>	
<p>See guidance on regulated entertainment</p> <p>Will the schedule to provide films be subject to change if this application to vary is successful?      <input type="radio"/> Yes      <input checked="" type="radio"/> No</p>	
<b>Section 6 of 18</b>	
<b>PROVISION OF INDOOR SPORTING EVENTS</b>	



Continued from previous page...

See guidance on regulated entertainment

Will the schedule to provide indoor sporting events be subject to change if this application to vary is successful?

☐ Yes

☒ No

#### Section 7 of 18

##### PROVISION OF BOXING OR WRESTLING ENTERTAINMENTS

See guidance on regulated entertainment

Will the schedule to provide boxing or wrestling entertainments be subject to change if this application to vary is successful?

☐ Yes

☒ No

#### Section 8 of 18

##### PROVISION OF LIVE MUSIC

See guidance on regulated entertainment

Will the schedule to provide live music be subject to change if this application to vary is successful?

☒ Yes

☐ No

##### Standard Days And Timings

###### MONDAY

Start

End

Start

End

###### TUESDAY

Start

End

Start

End

###### WEDNESDAY

Start

End

Start

End

###### THURSDAY

Start

End

Start

End

###### FRIDAY

Start

End

Start

End

###### SATURDAY

Start

End

Start

End

Provide timings in 24 hour clock (e.g., 16:00) and only give details for the days of the week when you intend the premises to be used for the activity.

Continued from previous page...

SUNDAY

Start 09:00

End 01:00

Start

End

Will the performance of live music take place indoors or outdoors or both?

☒ Indoors

☐ Outdoors

☐ Both

Where taking place in a building or other structure select as appropriate. Indoors may include a tent.

State type of activity to be authorised, if not already stated, and give relevant further details, for example (but not exclusively) whether or not music will be amplified or unamplified.

State any seasonal variations for the performance of live music

For example (but not exclusively) where the activity will occur on additional days during the summer months.

Non-standard timings. Where the premises will be used for the performance of live music at different times from those listed, above below.

For example (but not exclusively), where you wish the activity to go on longer on a particular day e.g. Christmas Eve.

From the start time on New Year's Eve to the terminal hour for New Year's Day.

On the day that British Summer Time commences, one additional hour to disapply its effect.

## Section 9 of 18

### PROVISION OF RECORDED MUSIC

See guidance on regulated entertainment

Will the schedule to provide recorded music be subject to change if this application to vary is successful?

☒ Yes

☐ No

#### Standard Days And Timings

MONDAY

Start 09:00

End 01:00

Start

End

Provide timings in 24 hour clock (e.g., 16:00) and only give details for the days of the week when you intend the premises to be used for the activity.

TUESDAY

Start 09:00

End 01:00

Start

End

*Continued from previous page...*

WEDNESDAY

Start

End

Start

End

THURSDAY

Start

End

Start

End

FRIDAY

Start

End

Start

End

SATURDAY

Start

End

Start

End

SUNDAY

Start

End

Start

End

Will the playing of recorded music take place indoors or outdoors or both?



Indoors



Outdoors



Both

Where taking place in a building or other structure select as appropriate. Indoors may include a tent.

State type of activity to be authorised, if not already stated, and give relevant further details, for example (but not exclusively) whether or not music will be amplified or unamplified.

State any seasonal variations for playing recorded music.

For example (but not exclusively) where the activity will occur on additional days during the summer months.

Non-standard timings. Where the premises will be used for the playing of recorded music at different times from those listed above, list below.

For example (but not exclusively), where you wish the activity to go on longer on a particular day e.g. Christmas Eve.

From the start time on New Year's Eve to the terminal hour for New Year's Day.

On the day that British Summer Time commences, one additional hour to disapply its effect.

Continued from previous page...

**Section 10 of 18**

**PROVISION OF PERFORMANCES OF DANCE**

See guidance on regulated entertainment

Will the schedule to provide performances of dance be subject to change if this application to vary is successful?

☐ Yes

☒ No

**Section 11 of 18**

**PROVISION OF ANYTHING OF A SIMILAR DESCRIPTION TO LIVE MUSIC, RECORDED MUSIC OR PERFORMANCES OF DANCE**

See guidance on regulated entertainment

Will the schedule to provide anything similar to live music, recorded music or performances of dance be subject to change if this application to vary is successful?

☐ Yes

☒ No

**Section 12 of 18**

**PROVISION OF LATE NIGHT REFRESHMENT**

Will the schedule to provide late night refreshment be subject to change if this application to vary is successful?

☒ Yes

☐ No

**Standard Days And Timings**

**MONDAY**

Start 23:00

End 01:30

Start

End

**TUESDAY**

Start 23:00

End 01:30

Start

End

**WEDNESDAY**

Start 23:00

End 01:30

Start

End

**THURSDAY**

Start 23:00

End 02:30

Start

End

**FRIDAY**

Start 23:00

End 02:30

Start

End

Provide timings in 24 hour clock (e.g., 16:00) and only give details for the days of the week when you intend the premises to be used for the activity.

*Continued from previous page...*

SATURDAY

Start

End

Start

End

SUNDAY

Start

End

Start

End

Will the provision of late night refreshment take place indoors or outdoors or both?

☒ Indoors

☐ Outdoors

☐ Both

Where taking place in a building or other structure select as appropriate. Indoors may include a tent.

State type of activity to be authorised, if not already stated, and give relevant further details, for example (but not exclusively) whether or not music will be amplified or unamplified.

State any seasonal variations.

For example (but not exclusively) where the activity will occur on additional days during the summer months.

Non standard timings. Where the premises will be used for the provision of late night refreshment at different times from those listed above, list below.

For example (but not exclusively), where you wish the activity to go on longer on a particular day e.g. Christmas Eve.

From the start time on New Year's Eve to the terminal hour for New Year's Day.

On the day that British Summer Time commences, one additional hour to disapply its effect.

### Section 13 of 18

#### SUPPLY OF ALCOHOL

Will the schedule to supply alcohol be subject to change if this application to vary is successful?

☒ Yes

☐ No

#### Standard Days And Timings

Continued from previous page...

MONDAY

Start 09:00

End 01:00

Start

End

Provide timings in 24 hour clock (e.g., 16:00) and only give details for the days of the week when you intend the premises to be used for the activity.

TUESDAY

Start 09:00

End 01:00

Start

End

WEDNESDAY

Start 09:00

End 01:00

Start

End

THURSDAY

Start 09:00

End 02:00

Start

End

FRIDAY

Start 09:00

End 02:00

Start

End

SATURDAY

Start 09:00

End 02:00

Start

End

SUNDAY

Start 09:00

End 01:00

Start

End

Will the sale of alcohol be for consumption?

☐ On the premises ☐ Off the premises ☒ Both

If the sale of alcohol is for consumption on the premises select on, if the sale of alcohol is for consumption away from the premises select off. If the sale of alcohol is for consumption on the premises and away from the premises select both.

State any seasonal variations.

For example (but not exclusively) where the activity will occur on additional days during the summer months.

*Continued from previous page...*

Non-standard timings. Where the premises will be used for the supply of alcohol at different times from those listed above, list below.

For example (but not exclusively), where you wish the activity to go on longer on a particular day e.g. Christmas Eve.

From the start time on New Year's Eve to the terminal hour for New Year's Day.

On the day that British Summer Time commences, one additional hour to disapply its effect.

#### Section 14 of 18

##### ADULT ENTERTAINMENT

Highlight any adult entertainment or services, activities, or other entertainment or matters ancillary to the use of the premises that may give rise to concern in respect of children.

Provide information about anything intended to occur at the premises or ancillary to the use of the premises which may give rise to concern in respect of children, regardless of whether you intend children to have access to the premises, for example (but not exclusively) nudity or semi-nudity, films for restricted age groups etc gambling machines etc.

n/a

#### Section 15 of 18

##### HOURS PREMISES ARE OPEN TO THE PUBLIC

###### Standard Days And Timings

###### MONDAY

Start 09:00

End 01:30

Start

End

Provide timings in 24 hour clock (e.g., 16:00) and only give details for the days of the week when you intend the premises to be used for the activity.

###### TUESDAY

Start 09:00

End 01:30

Start

End

###### WEDNESDAY

Start 09:00

End 01:30

Start

End

###### THURSDAY

Start 09:00

End 02:30

Start

End

###### FRIDAY

Start 09:00

End 02:30

Start

End

*Continued from previous page...*

SATURDAY

Start

End

Start

End

SUNDAY

Start

End

Start

End

State any seasonal variations.

For example (but not exclusively) where the activity will occur on additional days during the summer months.

--------------

Non standard timings. Where you intend to use the premises to be open to the members and guests at different times from those listed above, list below.

For example (but not exclusively), where you wish the activity to go on longer on a particular day e.g. Christmas Eve.

From the start time on New Year's Eve to the terminal hour for New Year's Day.

On the day that British Summer Time commences, one additional hour to disapply its effect.

Identify those conditions currently imposed on the licence which you believe could be removed as a consequence of the proposed variation you are seeking.

--------------

☒ I have enclosed the premises licence

☐ I have enclosed the relevant part of the premises licence

Reasons why I have failed to enclose the premises licence or relevant part of premises licence.

--------------

#### Section 16 of 18

#### LICENSING OBJECTIVES

Describe the steps you intend to take to promote the four licensing objectives:

a) General – all four licensing objectives (b,c,d,e)

List here steps you will take to promote all four licensing objectives together.



<b>Continued from previous page...</b>
<p>Please see conditions attached to existing premises licence.</p>
<p>b) The prevention of crime and disorder</p> <p>Please see conditions attached to existing premises licence.</p>
<p>c) Public safety</p> <p>Please see conditions attached to existing premises licence.</p>
<p>d) The prevention of public nuisance</p> <p>Please see conditions attached to existing premises licence.</p>
<p>e) The protection of children from harm</p> <p>Please see conditions attached to existing premises licence.</p>
<b>Section 17 of 18</b>
<b>NOTES ON REGULATED ENTERTAINMENT</b>

*Continued from previous page...*

In terms of specific **regulated entertainments** please note that:

- Plays: no licence is required for performances between 08:00 and 23:00 on any day, provided that the audience does not exceed 500.
- Films: no licence is required for 'not-for-profit' film exhibition held in community premises between 08:00 and 23:00 on any day provided that the audience does not exceed 500 and the organiser (a) gets consent to the screening from a person who is responsible for the premises; and (b) ensures that each such screening abides by age classification ratings.
- Indoor sporting events: no licence is required for performances between 08:00 and 23:00 on any day, provided that the audience does not exceed 1000.
- Boxing or Wrestling Entertainment: no licence is required for a contest, exhibition or display of Greco-Roman wrestling, or freestyle wrestling between 08:00 and 23:00 on any day, provided that the audience does not exceed 1000. Combined fighting sports – defined as a contest, exhibition or display which combines boxing or wrestling with one or more martial arts – are licensable as a boxing or wrestling entertainment rather than an indoor sporting event.
- Live music: no licence permission is required for:
  - o a performance of unamplified live music between 08:00 and 23:00 on any day, on any premises.
  - o a performance of amplified live music between 08:00 and 23:00 on any day on premises authorised to sell alcohol for consumption on those premises, provided that the audience does not exceed 500.
  - o a performance of amplified live music between 08:00 and 23:00 on any day, in a workplace that is not licensed to sell alcohol on those premises, provided that the audience does not exceed 500.
  - o a performance of amplified live music between 08:00 and 23:00 on any day, in a church hall, village hall, community hall, or other similar community premises, that is not licensed by a premises licence to sell alcohol, provided that (a) the audience does not exceed 500, and (b) the organiser gets consent for the performance from a person who is responsible for the premises.
  - o a performance of amplified live music between 08:00 and 23:00 on any day, at the non-residential premises of (i) a local authority, or (ii) a school, or (iii) a hospital, provided that (a) the audience does not exceed 500, and (b) the organiser gets consent for the performance on the relevant premises from: (i) the local authority concerned, or (ii) the school or (iii) the health care provider for the hospital.
- Recorded Music: no licence permission is required for:
  - o any playing of recorded music between 08:00 and 23:00 on any day on premises authorised to sell alcohol for consumption on those premises, provided that the audience does not exceed 500.
  - o any playing of recorded music between 08:00 and 23:00 on any day, in a church hall, village hall, community hall, or other similar community premises, that is not licensed by a premises licence to sell alcohol, provided that (a) the audience does not exceed 500, and (b) the organiser gets consent for the performance from a person who is responsible for the premises.
  - o any playing of recorded music between 08:00 and 23:00 on any day, at the non-residential premises of (i) a local authority, or (ii) a school, or (iii) a hospital, provided that (a) the audience does not exceed 500, and (b) the organiser gets consent for the performance on the relevant premises from: (i) the local authority concerned, or (ii) the school proprietor or (iii) the health care provider for the hospital.

*Continued from previous page...*

- Dance: no licence is required for performances between 08.00 and 23.00 on any day, provided that the audience does not exceed 500. However, a performance which amounts to adult entertainment remains licensable.
- Cross activity exemptions: no licence is required between 08.00 and 23.00 on any day, with no limit on audience size for:
  - o any entertainment taking place on the premises of the local authority where the entertainment is provided by or on behalf of the local authority;
  - o any entertainment taking place on the hospital premises of the health care provider where the entertainment is provided by or on behalf of the health care provider;
  - o any entertainment taking place on the premises of the school where the entertainment is provided by or on behalf of the school proprietor; and
  - o any entertainment (excluding films and a boxing or wrestling entertainment) taking place at a travelling circus, provided that (a) it takes place within a moveable structure that accommodates the audience, and (b) that the travelling circus has not been located on the same site for more than 28 consecutive days.

#### **Section 18 of 18**

#### **PAYMENT DETAILS**

This fee must be paid to the authority. If you complete the application online, you must pay it by debit or credit card.

Premises Licence Fees are determined by the non domestic rateable value of the premises.

To find out a premises non domestic rateable value go to the Valuation Office Agency site at <https://www.tax.service.gov.uk/business-rates-find/search>

Band A - No RV to £4300 - £100.00

Band B - £4301 to £33000 - £190.00

Band C - £33001 to £87000 - £315.00

Band D - £87001 to £125000 - £450.00\*

Band E - £125001 and over - £635.00\*

\*If the premises rateable value is in Bands D or E and the premises is primarily used for the consumption of alcohol on the premises then you are required to pay a higher fee

Band D - £87001 to £125000 - £900.00

Band E - £125001 and over - £1,905.00

There is an exemption from the payment of fees in relation to the provision of regulated entertainment at church halls, chapel halls or premises of a similar nature, village halls, parish or community halls, or other premises of a similar nature. The costs associated with these licences will be met by central Government. If, however, the licence also authorises the use of the premises for the supply of alcohol or the provision of late night refreshment, a fee will be required.

Schools and sixth form colleges are exempt from the fees associated with the authorisation of regulated entertainment where the entertainment is provided by and at the school or college and for the purposes of the school or college.

If you operate a large event you are subject to ADDITIONAL fees based upon the number in attendance at any one time

Capacity 5000-9999 - £1,000.00

Capacity 10000-14999 - £2,000.00

Capacity 15000-19999 - £4,000.00

Capacity 20000-29999 - £8,000.00

Capacity 30000-39999 - £16,000.00

Capacity 40000-49999 - £24,000.00

Capacity 50000-59999 - £32,000.00

Capacity 60000-69999 - £40,000.00

Capacity 70000-79999 - £48,000.00

Capacity 80000-89999 - £56,000.00

Capacity 90000 and over - £64,000.00

\* Fee amount (£)

100.00

#### **DECLARATION**

1

**Continued from previous page...**

I/WE UNDERSTAND THAT IT IS AN OFFENCE, UNDER SECTION 158 OF THE LICENSING ACT 2003, TO MAKE A FALSE  
\* STATEMENT IN OR IN CONNECTION WITH THIS APPLICATION. THOSE WHO MAKE A FALSE STATEMENT MAY BE LIABLE ON  
SUMMARY CONVICTION TO A FINE OF ANY AMOUNT.

☒ Ticking this box indicates you have read and understood the above declaration

This section should be completed by the applicant, unless you answered "Yes" to the question "Are you an agent acting on behalf of the applicant?"

\* Full name   
\* Capacity   
\* Date  /  /   
dd mm yyyy

Once you're finished you need to do the following:

1. Save this form to your computer by clicking file/save as...
2. Go back to <https://www.gov.uk/apply-for-a-licence/premises-licence/birmingham/change-1> to upload this file and continue with your application.

Don't forget to make sure you have all your supporting documentation to hand.

**IT IS AN OFFENCE, UNDER SECTION 158 OF THE LICENSING ACT 2003, TO MAKE A FALSE STATEMENT IN OR IN CONNECTION WITH THIS APPLICATION. THOSE WHO MAKE A FALSE STATEMENT MAY BE LIABLE ON SUMMARY CONVICTION TO A FINE OF ANY AMOUNT.**

**OFFICE USE ONLY**

Applicant reference number   
Fee paid   
Payment provider reference   
ELMS Payment Reference   
Payment status   
Payment authorisation code   
Payment authorisation date   
Date and time submitted   
Approval deadline   
Error message   
Is Digitally signed ☐

1 2 3 4 5 6 7 8 9 10 11 12 13 14 15 16 17 18 Next >

## BIRMINGHAM CITY COUNCIL

LICENSING ACT 2003PREMISES LICENCE

Premises Licence Number:

4166 / 2

**Part 1 - Premises details:****Postal address of premises, or if none, ordnance survey map reference or description**

The Botanist  
Cheltenham House  
14-16 Temple Street

**Post town:**

Birmingham

**Post Code:**

B2 5BG

**Telephone Number:**

Not Specified

**Where the licence is time limited the dates**

N/A

**Licensable activities authorised by the licence**

E	Live music
F	Recorded music
L	Late night refreshment
M3	Sale of alcohol by retail (both on & off the premises)

**The times the licence authorises the carrying out of licensable activities**

Sunday - Wednesday	09:00	-	00:00	E ,F ,M3
	23:00	-	00:00	L
Thursday - Saturday	09:00	-	01:00	E ,F ,M3
	23:00	-	01:00	L

From the end of permitted hours on New Year's Eve to the start of permitted hours on New Year's Day.

**The opening hours of the premises**

Sunday - Wednesday	09:00	-	00:30
Thursday - Saturday	09:00	-	01:30

From the end of permitted hours on New Year's Eve to the start of permitted hours on New Year's Day.

**Where the licence authorises supplies of alcohol whether these are on and/or off supplies**

On and Off Supplies

BIRMINGHAM CITY COUNCIL

Part 2

<b>Name, (registered) address, telephone number and email (where relevant) of holder of premises licence</b> New World Trading Company (UK) Limited 2 Malt Street Knutsford	
<b>Post town:</b> Cheshire	<b>Post Code:</b> WA16 6ES
<b>Telephone Number:</b>	
<b>Email</b>	

<b>Registered number of holder for example company number or charity number (where applicable)</b> 07685158
--

<b>Name, address, telephone number of designated premises supervisor where the premises licence authorises for the supply of alcohol</b> Gemma Meah	
<b>Post town:</b>	<b>Post Code:</b>
<b>Telephone Number:</b> N/A	

<b>Personal licence number and issuing authority of personal licence held by designated premises supervisor where the premises licence authorises for the supply of alcohol</b>	
<b>Licence Number</b> PA/08/0019	<b>Issuing Authority</b> TAMWORTH BOROUGH COUNCIL

Dated 19/02/2016

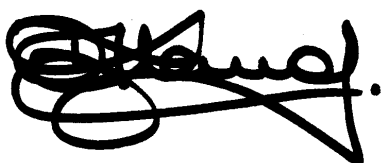

David Kennedy  
Principal Licensing Officer  
For Director of Regulation and Enforcement

## BIRMINGHAM CITY COUNCIL

### Annex 1 – Mandatory Conditions

No supply of alcohol may be made under the premises licence (a) at a time when there is no designated premises supervisor in respect of the premises licence, or (b) at a time when the designated premises supervisor does not hold a personal licence or his personal licence is suspended.

Every retail sale or supply of alcohol made under this licence must be made or authorised by a person who holds a personal licence.

The responsible person must ensure that staff on relevant premises do not carry out, arrange or participate in any irresponsible promotions in relation to the premises. In this paragraph, an irresponsible promotion means any one or more of the following activities, or substantially similar activities, carried on for the purpose of encouraging the sale or supply of alcohol for consumption on the premises— (a) games or other activities which require or encourage, or are designed to require or encourage, individuals to— (i) drink a quantity of alcohol within a time limit (other than to drink alcohol sold or supplied on the premises before the cessation of the period in which the responsible person is authorised to sell or supply alcohol), or (ii) drink as much alcohol as possible (whether within a time limit or otherwise); (b) provision of unlimited or unspecified quantities of alcohol free or for a fixed or discounted fee to the public or to a group defined by a particular characteristic in a manner which carries a significant risk of undermining a licensing objective; (c) provision of free or discounted alcohol or any other thing as a prize to encourage or reward the purchase and consumption of alcohol over a period of 24 hours or less in a manner which carries a significant risk of undermining a licensing objective; (d) selling or supplying alcohol in association with promotional posters or flyers on, or in the vicinity of, the premises which can reasonably be considered to condone, encourage or glamorise anti-social behaviour or to refer to the effects of drunkenness in any favourable manner; (e) dispensing alcohol directly by one person into the mouth of another (other than where that other person is unable to drink without assistance by reason of disability).

The responsible person must ensure that free potable water is provided on request to customers where it is reasonably available.

The premises licence holder or club premises certificate holder must ensure that an age verification policy is adopted in respect of the premises in relation to the sale or supply of alcohol. The designated premises supervisor in relation to the premises licence must ensure that the supply of alcohol at the premises is carried on in accordance with the age verification policy. The policy must require individuals who appear to the responsible person to be under 18 years of age (or such older age as may be specified in the policy) to produce on request, before being served alcohol, identification bearing their photograph, date of birth and either— (a) a holographic mark, or (b) an ultraviolet feature.

The responsible person must ensure that— (a) where any of the following alcoholic drinks is sold or supplied for consumption on the premises (other than alcoholic drinks sold or supplied having been made up in advance ready for sale or supply in a securely closed container) it is available to customers in the following measures— (i) beer or cider: ½ pint; (ii) gin, rum, vodka or whisky: 25 ml or 35 ml; and (iii) still wine in a glass: 125 ml; (b) these measures are displayed in a menu, price list or other printed material which is available to customers on the premises; and (c) where a customer does not in relation to a sale of alcohol specify the quantity of alcohol to be sold, the customer is made aware that these measures are available."

(1) A relevant person shall ensure that no alcohol is sold or supplied for consumption on or off the premises for a price which is less than the permitted price. (2) In this condition:— (a) "permitted price" is the price found by applying the formula  $P = D + (D \times V)$ , where— (i) P is the permitted price, (ii) D is the amount of duty chargeable in relation to the alcohol as if the duty were charged on the date of the sale or supply of the alcohol, and (iii) V is the rate of value added tax chargeable in relation to the alcohol as if the value added tax were charged on the date of the sale or supply of the alcohol; (b) "duty" is to be construed in accordance with the Alcoholic Liquor Duties Act 1979; (c) "relevant person" means, in relation to premises in respect of which there is in force a premises licence— (i) the holder of the premises licence, (ii) the designated premises supervisor (if any) in respect of such a licence, or (iii) the personal licence holder who makes or authorises a supply of alcohol under such a licence; (d) "relevant person" means, in relation to premises in respect of which there is in force a club premises certificate, any member or officer of the club present on the premises in a capacity which enables the member or officer to prevent the supply in question; and (e) "value added tax" means value added tax charged in accordance with the Value Added Tax Act 1994. (3) Where

**BIRMINGHAM CITY COUNCIL**

the permitted price would not be a whole number of pennies, the permitted price shall be taken to be the price rounded up to the nearest penny. (4) Where the permitted price on a day ("the first day") would be different from the permitted price on the next day ("the second day") as a result of a change to the rate of duty or value added tax, the permitted price which would apply on the first day applies to sales or supplies of alcohol which take place before the expiry of the period of 14 days beginning on the second day.

Each individual assigned to carrying out a security activity must be licensed by the Security Industry Agency.



## **BIRMINGHAM CITY COUNCIL**

### **Annex 2 – Conditions consistent with operating schedule**

#### **2a) General conditions consistent with the operating schedule**

Staff shall be trained in the requirements of the Licensing Act 2003 with regard to the Licensing Objectives.

#### **2b) Conditions consistent with, and to promote the prevention of crime and disorder**

A full CCTV system shall be maintained and operated at the premises with cameras positioned both internally and externally. The system shall record images of sufficient quality to allow facial recognition of customers as they enter.

Recorded CCTV images will be maintained and stored for a period of twenty-eight days and shall be produced to the Police or Licensing Authority upon request.

CCTV will be in operation at any time a person is in the premises. Where CCTV is recorded onto a hard drive system, any DVDs subsequently produced will be in a format so it can be played back on a standard PC or DVD player.

Any person left in charge of the premises must be trained in the use of any such CCTV equipment, and be able to produce CCTV images to an officer from a responsible authority upon request.

A risk assessment shall be carried out by the premises licence with regards the provision of SIA registered door staff. They shall be employed at such times and in such numbers as that risk assessment deems appropriate.

When employed, a register of those door staff employed shall be maintained at the premises and shall include:

- (i) the number of door staff on duty;
- (ii) the identity of each member of door staff;
- (iii) the times the door staff are on duty.

Open containers of alcohol shall not be removed from the premises, save for consumption in any delineated external area under the control of the premises licence holder.

A refusals book will be maintained at the premises, and made available to an officer of a responsible authority upon request.

#### **2c) Conditions consistent with, and to promote, public safety**

The premises shall maintain an Incident Log and public liability insurance.

#### **2d) Conditions consistent with, and to promote the prevention of public nuisance**

Noise from amplified music or voices shall not be such as to cause a noise nuisance to occupants of nearby premises.

The exterior of the building shall be cleared of litter at regular intervals.

Notices will be positioned at the exits to the building requesting customers to leave in a quiet manner.

The concertina windows shall only be open between 9am and midnight daily.

The delivery of goods to or from the premises shall not take place outside the hours of 9am to 9pm daily.

No noise shall emanate from the premises nor vibration be transmitted through the structure of the premises which gives rise to a nuisance.

**BIRMINGHAM CITY COUNCIL**

**2e) Conditions consistent with, and to promote the protection of children from harm**

A "Challenge 21" Policy shall be implemented and appropriate identification sought from any person who appears to be under the age of 18. The only acceptable photographic driving licences, passports, HM forces cards, or a form of identification with the "PASS" hologram.

Staff will be trained in the laws relating to under age sales, and that training shall be documented and repeated at 6 monthly intervals.

**BIRMINGHAM CITY COUNCIL**

**Annex 3 – Conditions attached after hearing by licensing authority**

**3a) General committee conditions**

N/A

**3b) Committee conditions to promote the prevention of crime and disorder**

N/A

**3c) Committee conditions to promote public safety**

N/A

**3d) Committee conditions to promote the prevention of public nuisance**

N/A

**3e) Committee conditions to promote the protection of children from harm**

N/A

[illegible]

**BIRMINGHAM CITY COUNCIL**

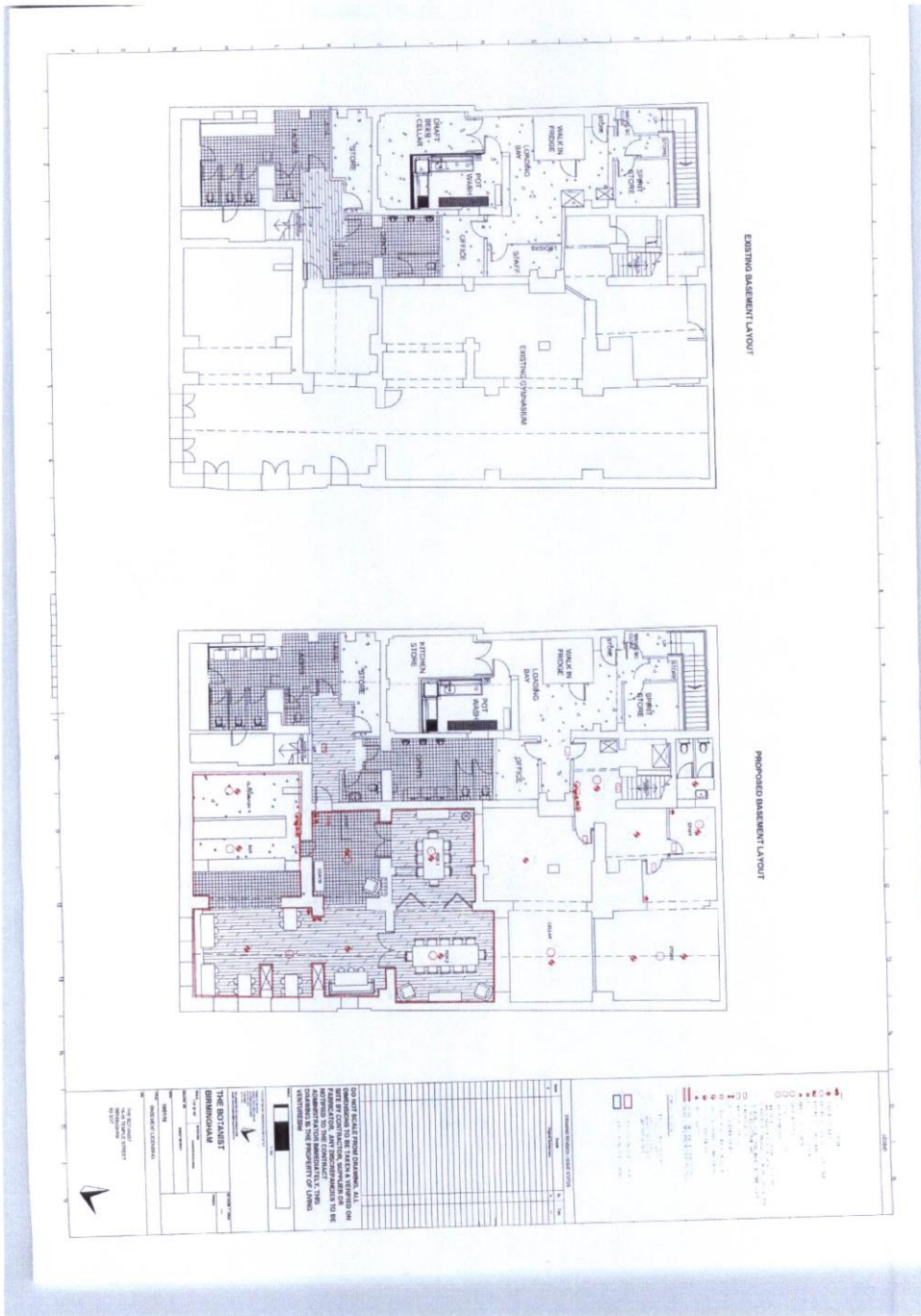

Birmingham City Council, Licensing Section, P.O. Box 17013, Birmingham, B6 9ES



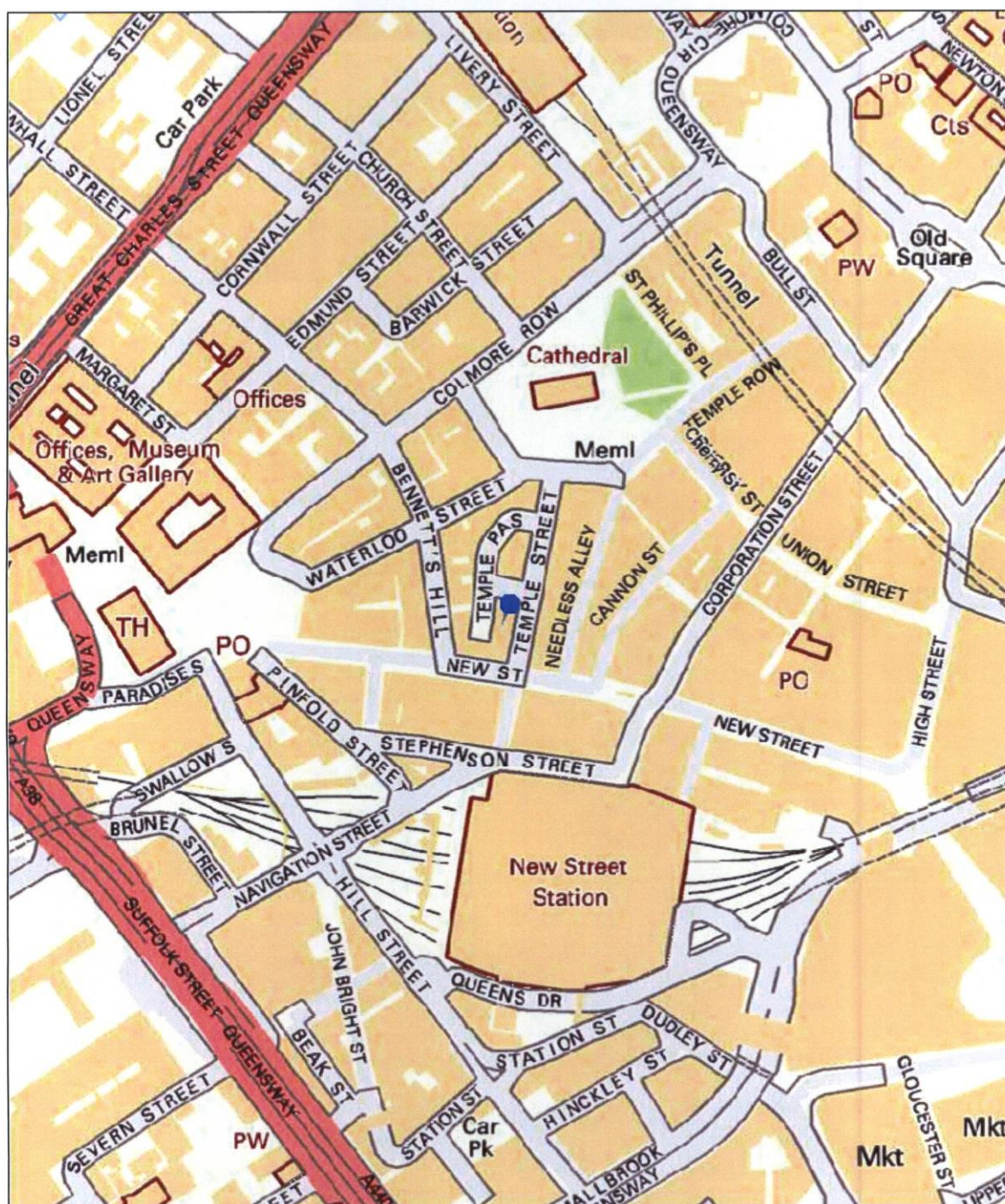

**Birmingham City Council** Map Created By:

Date of Map Creation: 21/11/2018

Notes



Scale:  
1:4,000

(c) Crown copyright. All rights reserved. Birmingham City Council 100021326 (2016).

You are not permitted to copy, sub-licence, distribute or sell any of this data to third parties in any form.

(c) GeoPerspectives, supplied by Bluesky International Ltd

Cities Revealed® copyright by The GeoInformation® Group 2014 and Crown Copyright © All right reserved



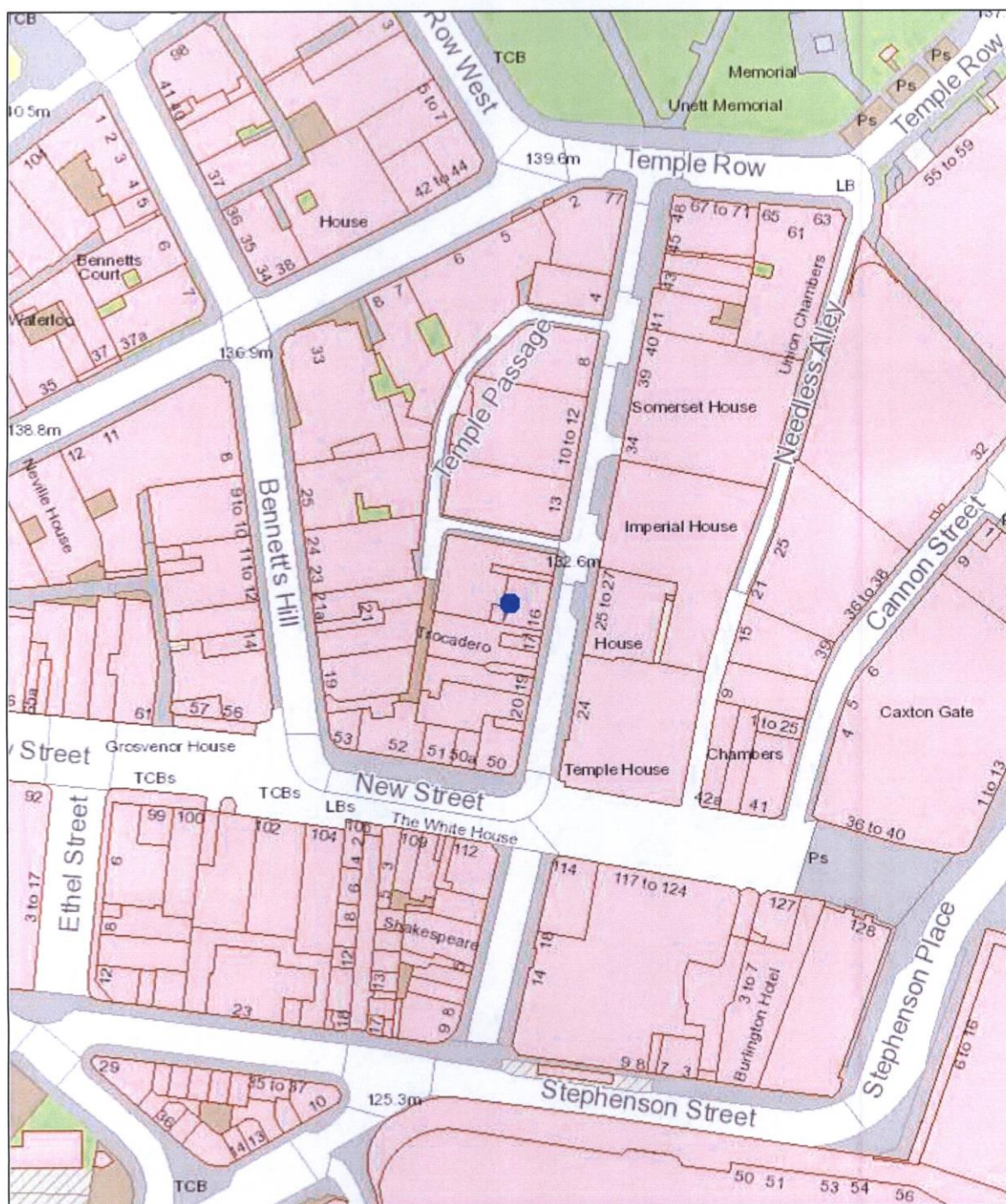

**Birmingham City Council**

Map Created By:

Date of Map Creation: 21/11/2018

**Notes**

(c) Crown copyright. All rights reserved. Birmingham City Council 100021326 (2016).  
You are not permitted to copy, sub-licence, distribute or sell any of this data to third parties in any form.

(c) GeoPerspectives, supplied by Bluesky International Ltd

Cities Revealed® copyright by The GeoInformation® Group, 2014 and Crown Copyright © All right reserved



Scale:  
1:1,250