

Appendix H – Typical Highway Cross-Section with asset maintenance responsibilities indicated.

Typical Highway Cross-Section

Not to scale

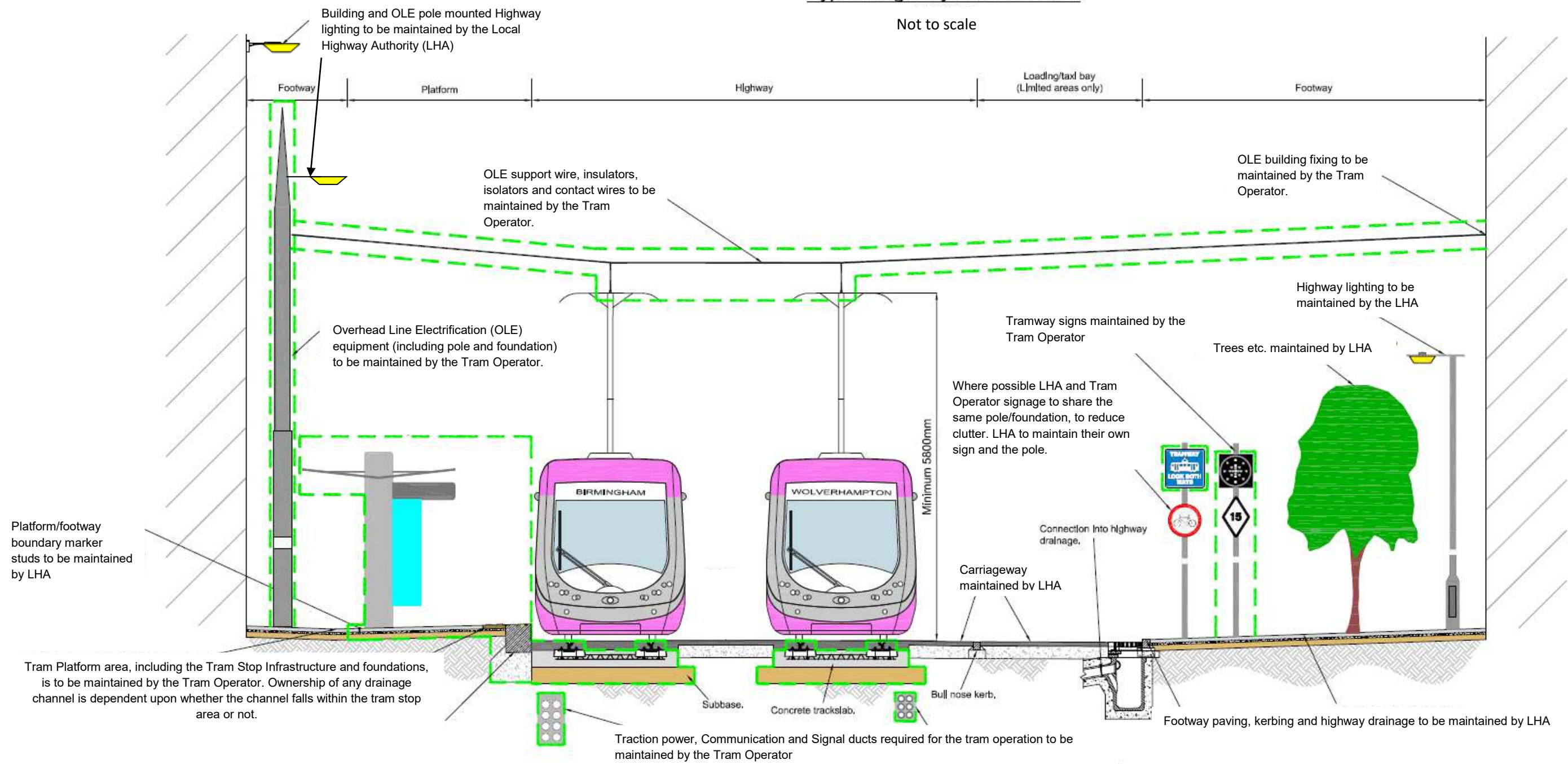

Note:

This image has been created using an extract from Mott MacDonald drawing number 244702-BC11-SL49-SK016 (Rev P1) and is provided to give an indicative understanding of how the maintenance of assets created by the Metro works will be shared between the Local Highway Authority (LHA, Birmingham City Council) and the Tram Operator (Midland Metro Ltd., on behalf of the West Midlands Combined Authority). Principles for collaborative working between the LHA and the Tram Operator are set out in the Highways Interface Document.