

# BIRMINGHAM CITY COUNCIL

## PUBLIC REPORT

<b>Report to:</b>	<b>Licensing Sub Committee B</b>
<b>Report of:</b>	<b>Interim Assistant Director of Regulation &amp; Enforcement</b>
<b>Date of Meeting:</b>	<b>Tuesday 4<sup>th</sup> August 2020</b>
<b>Subject:</b>	<b>Licensing Act 2003 Premises Licence – Variation</b>
<b>Premises:</b>	<b>Eden Manna Supermarket, 122 Frances Road, Cotteridge, Birmingham, B30 3DX</b>
<b>Ward affected:</b>	<b>Stirchley</b>
<b>Contact Officer:</b>	<b>David Kennedy, Principal Licensing Officer, <a href="mailto:licensing@birmingham.gov.uk">licensing@birmingham.gov.uk</a></b>

### **1. Purpose of report:**

To consider relevant representations that have been made in respect of an application to vary the Premises Licence which seeks to extend the hours for the Sale of Alcohol (for consumption off the premises), to operate from 6:00am until 12:00midnight (Monday to Sunday).

Premises to remain open to the public from 6:00am until 12:00midnight (Monday to Sunday).

### **2. Recommendation:**

To consider the representations that have been made and to determine the application.

### **3. Brief Summary of Report:**

Variation application received on 10<sup>th</sup> June 2020 in respect of Eden Manna Supermarket, 122 Frances Road, Cotteridge, Birmingham, B30 3DX.

Representations have been received from West Midlands Police, as a responsible authority, and from other persons.

### **4. Compliance Issues:**

#### **4.1 Consistency with relevant Council Policies, Plans or Strategies:**

The report complies with the City Council's Statement of Licensing Policy and the Council's Corporate Plan to improve the standard of all licensed persons, premises and vehicles in the City.

## **5. Relevant background/chronology of key events:**

Eden Manna Supermarket Ltd applied on 10<sup>th</sup> June 2020 to vary the Premises Licence for Eden Manna Supermarket, 122 Frances Road, Cotteridge, Birmingham, B30 3DX.

A representation has been received from West Midlands Police as a responsible authority. See Appendix 1.

A representation has been received from other persons. See Appendix 2.

The application is attached at Appendix 3.

The current Premises Licence is attached at Appendix 4.

Site Location Plans at Appendix 5.

When carrying out its licensing functions, a licensing authority must have regard to Birmingham City Council's Statement of Licensing Policy and the Guidance issued by the Secretary of State under s182 of the Licensing Act 2003. The Licensing Authority is also required to take such steps as it considers appropriate for the promotion of the licensing objectives, which are:-

- a. The prevention of crime and disorder;
- b. Public safety;
- c. The prevention of public nuisance; and
- d. The protection of children from harm.

## **6. List of background documents:**

Copies of the representations are detailed in Appendices 1 & 2  
Application Form, Appendix 3  
Current Premises Licence, Appendix 4  
Site Location Plans, Appendix 5

## **7. Options available**

To grant the variation application  
To refuse the whole or part of the application  
To modify the conditions of the Licence

**From:** Christopher Jones  
**Sent:** 23 June 2020 09:41  
**To:** Licensing  
**Cc:**  
**Subject:** variation Eden Manna Supermarket - Frances Rd Cotteridge

Good Morning Licensing,

West Midlands Police object to the variation application from Eden Manna Supermarket, 122 Frances Road, Cotteridge. B30 3DX to extend it's licensable hours commencing at 06.00hrs daily. The objection is made under the prevention of crime & disorder and the protection of children from harm licensing objectives.

The premises first applied for a premise licence in January 2019. In this application the premises applied for the sale of alcohol for consumption off the premises from the hours of 11:00 am, this application was objected to by local interested parties and heard at a licensing subcommittee on 19.03.19.

Licensing sub-committee B on 19<sup>th</sup> March 2019 stated in their decision notice –*‘the head teacher of Cotteridge Primary School had concerns about the sale of alcohol before 17:30 hours, a time when primary aged children stayed on site. The head teacher described some parents present on site to collect their children were intoxicated, and feared the situation would increase in the summer months as a result of the off-licence in such close proximity to the school. Further the school was surrounded by a few local businesses whose retail nature was considered to be un-healthy for young children.’*

The committee did grant the licence but imposed new conditions and reduced the licensable hours that they could sell alcohol during the week.

It is noted that this variation has applied for hours from 06:00, which is considerably early than the hours originally applied for. The original hours of 11am would not have impacted on children going to school, this variation application would do so. The exposure of children to alcohol is a concern highlighted in the original decision notice.

This variation application has been made by the same agent on behalf of the same operator that applied for the original grant in 2019. West Midlands Police note with some concern that the variation application has not explained or negated the concerns raised by the licensing committee in March 2019.

The variation application has added additional operating conditions. Although when these are scrutinised against the operating conditions already on the current licence it shows the below:

- An additional condition under “Safety” stating “CCTV will be operational in all public areas including entrance and exits”
  - To West Midlands Police this adds little to the CCTV condition already on the current licence
- An additional condition under “Safety” stating “external lighting will be on during operational hours”
  - This adds nothing to negate the concerns around children being exposed to alcohol or people under the influence of alcohol
- An additional two conditions under “Child” – “there will be no advertisements for alcohol outside the premises, or in the windows facing out, and all spirits will be kept behind the counter”
  - Again West Midlands Police cannot see how this addresses any concerns expressed by the licensing committee, and there is no explanation as to why the applicant feels it would.

As a result of the variation application, on Friday 12<sup>th</sup> June at approximately 11.50hrs officers from West Midlands Police Central Licensing Team visited the premises. There were two people in the premises, one transpired to be the PLH and DPS, and the other was a member of staff.

It was immediately noted that the premises was in breach of a committee imposed condition of; *'The licence holder shall ensure that at times when the premises are open but alcohol is not for sale that alcohol is not on view and is covered by lockable blinds or shutters.'*

Alcohol was openly on display behind the sales counter in an open fridge and on shelving units and could be seen from the public footpath. (Photographs were taken by the officers and can be produced.)

The DPS and applicant for the current variation (Mr Boniface Nyepango Lumumba) was spoken with by officers. He stated that he was aware of his licence conditions and knew he was in breach of them by displaying alcohol in the premises outside his licensable hours.

Mr Lumumba stated that he had no choice as the shop was too small to store the amount of alcohol at the premises and it was impracticable to keep removing it on and off display.

The longer officers spoke with Mr Lumumba the more defensive he became saying he was being victimised for trying to do the right thing (submitting the variation) that the police had received no complaints about the premises and it was unfair.

Officers had concerns that as alcohol was seemingly being offered for sale outside the licensable hours that the premises had been carrying out licensable activity outside its licenced hours. Although there were signs in the premises stating that alcohol could only be sold between the hours stated on the premises licence.

Officers requested to review the CCTV in the premises. Mr Lumumba stated this could not be done as the 'system had rebooted and he didn't have the password'

This is a breach of the operating condition around CCTV, which clearly states

- *The images recorded by the CCTV system must be retained in unedited form for a period of not less than 31 days and will be downloaded and made available to any Responsible Authority upon request*
- *The CCTV system will display the correct date and time on all recordings (taking account of GMT and BST).*
- *The premises licence holder will ensure a member of staff trained person in the use of and operation of the CCTV system will be present at the premises at all times when it is open to members of the public.*
- *This person will be able to fully operate the CCTV system and will be able to download any images requested by any Responsible Authority. The premises licence holder will maintain an incident recording system and will record any incidents occurring inside, or immediately outside the premises which they believe negatively impacts on any of the licensing objectives.*

Mr Lumumba was informed that officers would return on Monday 15<sup>th</sup> June 2020 to review the CCTV once he had been able to source a CCTV engineer.

Officers again attend the premises on 15<sup>th</sup> June at approximately 13.00hrs and again Mr Lumumba was at the premises.

The CCTV was now working with a new hard drive fitted on Saturday 13<sup>th</sup> June, officers were shown the invoice for system fitted. Mr Lumumba was asked for the old hard drive as officers were still concerned about the sale of alcohol outside the licensable hours.

He stated that the CCTV engineer had taken it with him. Mr Lumumba was requested to either recover the hard drive from the engineer or obtain a written report from him stating why the old hard drive was no longer available. Officers have given a date of 22<sup>nd</sup> June 2020 for the hard drive or engineer report to be made available to them.

Of note on this visit the alcohol in the premises was covered, with the signs still on display regarding the licensable hours, albeit not to the fullness of the premises operating condition of being '*covered by lockable blinds or shutters.*'

On Sunday 21<sup>st</sup> June 2020 West Midlands Police Central Licensing Team received an email from Mr Lumumba stating:

*'At your request, we have searched for a copy of the previous CCTV, it is however with regret that we write to inform you that we have not been able to locate the same. As previously stated, we have had to replace the CCTV in the store as we had been unable to review the old CCTV due to technical issues. Several attempts were made to contact the company who had install the CCTV in order to resolve this issue, however this was unsuccessful, and we were not able to get this resolved. Therefore, we have had to replace the CCTV and it appear the old one has been misplaced and we cannot locate it. However, should we have sight of this, we will of course revert back to you.'*

West Midlands Police are disappointed that the old hard drive cannot be located as the request for it was made only 48 hours after the new system had been installed. This obviously does nothing to allay West Midlands Police concerns regarding the premises carrying out licensable activity outside their permitted hours.

The fact that – 1) this application does not address the concerns raised by the licensing committee on 19<sup>th</sup> March 2019 - 2) the hours and conditions were imposed by the licensing committee – 3) Licensing breaches already identified – 4) The PLH/DPS knew he was in breach of his premises licence and still considered it acceptable to trade West Midlands Police have no alternative other than to object to this application.

Regards

Chris Jones 55410

Birmingham Central Licensing Team West Midlands Police

Preventing crime, protecting the public and helping those in need.

**From:** Councillor Mary Locke  
**Sent:** 17 June 2020 12:54  
**To:** Licensing; Paul Lankester; Emma Rohomon  
**Subject:** Licensing Application

I wish to register my objection to the application no 115516 Eden Manna Supermarket 122, Frances Road, Cotteridge, Birmingham B30 3DX.

These premises are opposite Cotteridge Primary School. The amended license was agreed in 2019. But, with amended opening hours. I feel that opening hours proposed are totally wrong with the school opposite. The amended hours were 5pm until Midnight. Then 11am until midnight Weekends and school holidays. I propose that this is a better way forward. There are a number of licensed premises close by also. In the area there is a single parents refuge too.

Councillor Mary Locke  
Stirchley Ward



**Birmingham**  
**Application to vary a premises licence**  
**Licensing Act 2003**

For help contact  
[licensingonline@birmingham.gov.uk](mailto:licensingonline@birmingham.gov.uk)  
 Telephone: 0121 303 9896

\* required information

**Section 1 of 18**

You can save the form at any time and resume it later. You do not need to be logged in when you resume.

System reference  This is the unique reference for this application generated by the system.

Your reference  You can put what you want here to help you track applications if you make lots of them. It is passed to the authority.

Are you an agent acting on behalf of the applicant?  
☒ Yes ☐ No Put "no" if you are applying on your own behalf or on behalf of a business you own or work for.

**Applicant Details**

\* First name

\* Family name

\* E-mail

Main telephone number  Include country code.

Other telephone number

☐ Indicate here if the applicant would prefer not to be contacted by telephone

Is the applicant:

- ☒ Applying as a business or organisation, including as a sole trader
- ☐ Applying as an individual
- A sole trader is a business owned by one person without any special legal structure. Applying as an individual means the applicant is applying so the applicant can be employed, or for some other personal reason, such as following a hobby.

**Applicant Business**

Is the applicant's business registered in the UK with Companies House? ☒ Yes ☐ No Note: completing the Applicant Business section is optional in this form.

Registration number

Business name  If the applicant's business is registered, use its registered name.

VAT number   Put "none" if the applicant is not registered for VAT.

Legal status

*Continued from previous page...*

Applicant's position in the business

Home country

The country where the applicant's headquarters are.

**Registered Address**

Address registered with Companies House.

Building number or name

Street

District

City or town

County or administrative area

Postcode

Country

**Agent Details**

\* First name

\* Family name

\* E-mail

Main telephone number

Include country code.

Other telephone number

☐ Indicate here if you would prefer not to be contacted by telephone

Are you:

☒ An agent that is a business or organisation, including a sole trader

A sole trader is a business owned by one person without any special legal structure.

☐ A private individual acting as an agent

**Agent Business**

Is your business registered in the UK with Companies House? ☒ Yes ☐ No

Note: completing the Applicant Business section is optional in this form.

Registration number

Business name

If your business is registered, use its registered name.

VAT number

Put "none" if you are not registered for VAT.

Legal status



*Continued from previous page...*

Your position in the business

Home country

The country where the headquarters of your business is located.

**Agent Registered Address**

Address registered with Companies House.

Building number or name

Street

District

City or town

County or administrative area

Postcode

Country

**Section 2 of 18**

**APPLICATION DETAILS**

**This application cannot be used to vary the licence so as to extend the period for which the licence has effect or to vary substantially the premises to which it relates. If you wish to make that type of change to the premises licence, you should make a new premises licence application under section 17 of the Licensing Act 2003.**

I/we, as named in section 1, being the premises licence holder, apply to vary a premises licence under section 34 of the Licensing Act 2003 for the premises described in section 2 below.

\* Premises Licence Number

Are you able to provide a postal address, OS map reference or description of the premises?

☒ Address ☐ OS map reference ☐ Description

**Postal Address Of Premises**

Building number or name

Street

District

City or town

County or administrative area

Postcode

Country

**Premises Contact Details**

Telephone number

Continued from previous page...

Non-domestic rateable  
value of premises (£)

### Section 3 of 18

#### VARIATION

Do you want the proposed  
variation to have effect as  
soon as possible?

☒ Yes

☐ No

Do you want the proposed variation to have effect in relation to the  
introduction of the late night levy?

☐ Yes

☒ No

You do not have to pay a fee if the only  
purpose of the variation for which you are  
applying is to avoid becoming liable to the  
late night levy.

If your proposed variation  
would mean that 5,000 or  
more people are expected to  
attend the premises at any  
one time, state the number  
expected to attend

#### Describe Briefly The Nature Of The Proposed Variation

Describe the premises. For example the type of premises, its general situation and layout and any other information which could be relevant to the licensing objectives. Where your application includes off-supplies of alcohol and you intend to provide a place for consumption of these off-supplies, you must include a description of where the place will be and its proximity to the premises.

We are applying to extend the permitted hours for the supply of alcohol for consumption off the premises from: Monday-Sunday 6am-12am.

### Section 4 of 18

#### PROVISION OF PLAYS

[See guidance on regulated entertainment](#)

Will the schedule to provide plays be subject to change if this application to  
vary is successful?

☐ Yes

☒ No

### Section 5 of 18

#### PROVISION OF FILMS

[See guidance on regulated entertainment](#)

Will the schedule to provide films be subject to change if this application to  
vary is successful?

☐ Yes

☒ No

### Section 6 of 18

#### PROVISION OF INDOOR SPORTING EVENTS

Continued from previous page...	<a href="#">See guidance on regulated entertainment</a>
<p>Will the schedule to provide indoor sporting events be subject to change if this application to vary is successful?</p> <p><input type="radio"/> Yes <input checked="" type="radio"/> No</p>	
<b>Section 7 of 18</b>	
<b>PROVISION OF BOXING OR WRESTLING ENTERTAINMENTS</b>	
<p><a href="#">See guidance on regulated entertainment</a></p> <p>Will the schedule to provide boxing or wrestling entertainments be subject to change if this application to vary is successful?</p> <p><input type="radio"/> Yes <input checked="" type="radio"/> No</p>	
<b>Section 8 of 18</b>	
<b>PROVISION OF LIVE MUSIC</b>	
<p><a href="#">See guidance on regulated entertainment</a></p> <p>Will the schedule to provide live music be subject to change if this application to vary is successful?</p> <p><input type="radio"/> Yes <input checked="" type="radio"/> No</p>	
<b>Section 9 of 18</b>	
<b>PROVISION OF RECORDED MUSIC</b>	
<p><a href="#">See guidance on regulated entertainment</a></p> <p>Will the schedule to provide recorded music be subject to change if this application to vary is successful?</p> <p><input type="radio"/> Yes <input checked="" type="radio"/> No</p>	
<b>Section 10 of 18</b>	
<b>PROVISION OF PERFORMANCES OF DANCE</b>	
<p><a href="#">See guidance on regulated entertainment</a></p> <p>Will the schedule to provide performances of dance be subject to change if this application to vary is successful?</p> <p><input type="radio"/> Yes <input checked="" type="radio"/> No</p>	
<b>Section 11 of 18</b>	
<b>PROVISION OF ANYTHING OF A SIMILAR DESCRIPTION TO LIVE MUSIC, RECORDED MUSIC OR PERFORMANCES OF DANCE</b>	
<p><a href="#">See guidance on regulated entertainment</a></p> <p>Will the schedule to provide anything similar to live music, recorded music or performances of dance be subject to change if this application to vary is successful?</p> <p><input type="radio"/> Yes <input checked="" type="radio"/> No</p>	
<b>Section 12 of 18</b>	
<b>PROVISION OF LATE NIGHT REFRESHMENT</b>	

Continued from previous page...

Will the schedule to provide late night refreshment be subject to change if this application to vary is successful?

☐ Yes ☒ No

### Section 13 of 18

#### SUPPLY OF ALCOHOL

Will the schedule to supply alcohol be subject to change if this application to vary is successful?

☒ Yes ☐ No

#### Standard Days And Timings

MONDAY

Start 06:00

End 00:00

Start

End

Provide timings in 24 hour clock (e.g., 16:00) and only give details for the days of the week when you intend the premises to be used for the activity.

TUESDAY

Start 06:00

End 00:00

Start

End

WEDNESDAY

Start 06:00

End 00:00

Start

End

THURSDAY

Start 06:00

End 00:00

Start

End

FRIDAY

Start 06:00

End 00:00

Start

End

SATURDAY

Start 06:00

End 00:00

Start

End

SUNDAY

Start 06:00

End 00:00

Start

End

Continued from previous page...

Will the sale of alcohol be for consumption?

☐ On the premises ☒ Off the premises ☐ Both

If the sale of alcohol is for consumption on the premises select on, if the sale of alcohol is for consumption away from the premises select off. If the sale of alcohol is for consumption on the premises and away from the premises select both.

State any seasonal variations.

For example (but not exclusively) where the activity will occur on additional days during the summer months.

Non-standard timings. Where the premises will be used for the supply of alcohol at different times from those listed above, list below.

For example (but not exclusively), where you wish the activity to go on longer on a particular day e.g. Christmas Eve.

#### Section 14 of 18

##### ADULT ENTERTAINMENT

Highlight any adult entertainment or services, activities, or other entertainment or matters ancillary to the use of the premises that may give rise to concern in respect of children.

Provide information about anything intended to occur at the premises or ancillary to the use of the premises which may give rise to concern in respect of children, regardless of whether you intend children to have access to the premises, for example (but not exclusively) nudity or semi-nudity, films for restricted age groups etc gambling machines etc.

NONE

#### Section 15 of 18

##### HOURS PREMISES ARE OPEN TO THE PUBLIC

###### Standard Days And Timings

MONDAY

Start

End

Start

End

TUESDAY

Start

End

Start

End

Provide timings in 24 hour clock (e.g., 16:00) and only give details for the days of the week when you intend the premises to be used for the activity.

Continued from previous page...

WEDNESDAY

Start 06:00

End 00:00

Start

End

THURSDAY

Start 06:00

End 00:00

Start

End

FRIDAY

Start 06:00

End 00:00

Start

End

SATURDAY

Start 06:00

End 00:00

Start

End

SUNDAY

Start 06:00

End 00:00

Start

End

State any seasonal variations.

For example (but not exclusively) where the activity will occur on additional days during the summer months.

Non standard timings. Where you intend to use the premises to be open to the members and guests at different times from those listed above, list below.

For example (but not exclusively), where you wish the activity to go on longer on a particular day e.g. Christmas Eve.

Identify those conditions currently imposed on the licence which you believe could be removed as a consequence of the proposed variation you are seeking.

☒ I have enclosed the premises licence

*Continued from previous page...*

- ☐ I have enclosed the relevant part of the premises licence

Reasons why I have failed to enclose the premises licence or relevant part of premises licence.

------------------

#### **Section 16 of 18**

#### **LICENSING OBJECTIVES**

Describe the steps you intend to take to promote the four licensing objectives:

a) General – all four licensing objectives (b,c,d,e)

List here steps you will take to promote all four licensing objectives together.

EFFECTIVE ONGOING TRAINING OF ALL MEMBERS OF STAFF TO UNDERSTAND AND PROMOTE THE LICENSING OBJECTIVES AND WORK WITH IN THE CONDITIONS SET BY THE PREMISES LICENCE.
--

b) The prevention of crime and disorder

CCTV WILL BE IN OPERATION IN ALL AREAS OF THE SHOP. THE CCTV SYSTEM WILL RECORD AT ALL TIMES THAT THE PREMISES ARE OPEN FOR LICENSABLE ACTIVITIES. RECORDINGS WILL BE STORED FOR A MINIMUM OF 31 DAYS AND IMAGES WILL BE PROVIDED TO THE POLICE UPON REQUEST WITH THE MINIMUM OF DELAY. THERE WILL ALWAYS BE A MEMBER OF STAFF PRESENT WHILST THE PREMISES IS OPEN TO THE PUBLIC WHO IS CONVERSANT WITH THE CCTV SYSTEM AND ABLE TO DOWNLOAD IMAGES ON REQUEST FOR THE POLICE. AN INCIDENT LOG WILL BE KEPT AT THE PREMISES AND WILL RECORD ANY INCIDENTS OF CRIME OR DISORDER. THIS LOG WILL ALSO RECORD ANY REFUSALS OF SALE. THE LOG WILL BE AVAILABLE FOR INSPECTION ON REQUEST BY A POLICE OFFICER OR OTHER RESPONSIBLE AUTHORITY.
--

c) Public safety

CCTV WILL BE IN OPERATION IN ALL PUBLIC AREAS INC ENTRANCES AND EXITS EXTERNAL LIGHTING WILL BE ON DURING OPERATIONAL HOURS
--

d) The prevention of public nuisance

STAFF WILL ENSURE NO CUSTOMERS LOITER OUTSIDE OF THE PREMISES
---

e) The protection of children from harm

A CHALLENGE 25 PROOF OF AGE SCHEME WILL BE IN OPERATION AT THE PREMISES WHERE THE ONLY FORMS OF ACCEPTABLE ID WILL BE A PASSPORT, PHOTO DRIVING LICENCE OR PROOF OF AGE CARD WITH THE HOLOGRAPHIC LOGO. THERE WILL BE A "No ID, No Sale" POLICY AT ALL TIMES FOR PEOPLE WHO LOOK UNDER 25. ALL STAFF WILL RECEIVE TRAINING ON THIS POLICY AND TRAINING RECORDS WILL BE KEPT FOR INSPECTION IF REQUESTED BY THE POLICE OR OTHER RESPONSIBLE AUTHORITY THERE WILL BE NO ADVERTISEMENTS FOR ALCOHOL OUTSIDE THE PREMISES OR IN THE WINDOWS FACING OUT ALL SPIRITS WILL BE KEPT BEHIND THE COUNTER STAFF WILL ENSURE NO CUSTOMERS LOITER OUTSIDE OF THE PREMISES
---



## Section 17 of 18

## NOTES ON REGULATED ENTERTAINMENT

In terms of specific **regulated entertainments** please note that:

- Plays: no licence is required for performances between 08.00 and 23.00 on any day, provided that the audience does not exceed 500.
- Films: no licence is required for 'not-for-profit' film exhibition held in community premises between 08.00 and 23.00 on any day provided that the audience does not exceed 500 and the organiser (a) gets consent to the screening from a person who is responsible for the premises; and (b) ensures that each such screening abides by age classification ratings.
- Indoor sporting events: no licence is required for performances between 08.00 and 23.00 on any day, provided that the audience does not exceed 1000.
- Boxing or Wrestling Entertainment: no licence is required for a contest, exhibition or display of Greco-Roman wrestling, or freestyle wrestling between 08.00 and 23.00 on any day, provided that the audience does not exceed 1000. Combined fighting sports – defined as a contest, exhibition or display which combines boxing or wrestling with one or more martial arts – are licensable as a boxing or wrestling entertainment rather than an indoor sporting event.
- Live music: no licence permission is required for:
  - o a performance of unamplified live music between 08.00 and 23.00 on any day, on any premises.
  - o a performance of amplified live music between 08.00 and 23.00 on any day on premises authorised to sell alcohol for consumption on those premises, provided that the audience does not exceed 500.
  - o a performance of amplified live music between 08.00 and 23.00 on any day, in a workplace that is not licensed to sell alcohol on those premises, provided that the audience does not exceed 500.
  - o a performance of amplified live music between 08.00 and 23.00 on any day, in a church hall, village hall, community hall, or other similar community premises, that is not licensed by a premises licence to sell alcohol, provided that (a) the audience does not exceed 500, and (b) the organiser gets consent for the performance from a person who is responsible for the premises.
  - o a performance of amplified live music between 08.00 and 23.00 on any day, at the non-residential premises of (i) a local authority, or (ii) a school, or (iii) a hospital, provided that (a) the audience does not exceed 500, and (b) the organiser gets consent for the performance on the relevant premises from: (i) the local authority concerned, or (ii) the school or (iii) the health care provider for the hospital.
- Recorded Music: no licence permission is required for:
  - o any playing of recorded music between 08.00 and 23.00 on any day on premises authorised to sell alcohol for consumption on those premises, provided that the audience does not exceed 500.
  - o any playing of recorded music between 08.00 and 23.00 on any day, in a church hall, village hall, community hall, or other similar community premises, that is not licensed by a premises licence to sell alcohol, provided that (a) the audience does not exceed 500, and (b) the organiser gets consent for the performance from a person who is responsible for the premises.
  - o any playing of recorded music between 08.00 and 23.00 on any day, at the non-residential premises of (i) a local authority, or (ii) a school, or (iii) a hospital, provided that (a) the audience does not exceed 500, and (b) the organiser gets consent for the performance on the relevant premises from: (i) the local authority concerned, or (ii) the school proprietor or (iii) the health care provider for the hospital.



Continued from previous page...

- Dance: no licence is required for performances between 08.00 and 23.00 on any day, provided that the audience does not exceed 500. However, a performance which amounts to adult entertainment remains licensable.
- Cross activity exemptions: no licence is required between 08.00 and 23.00 on any day, with no limit on audience size for:
  - o any entertainment taking place on the premises of the local authority where the entertainment is provided by or on behalf of the local authority;
  - o any entertainment taking place on the hospital premises of the health care provider where the entertainment is provided by or on behalf of the health care provider;
  - o any entertainment taking place on the premises of the school where the entertainment is provided by or on behalf of the school proprietor; and
  - o any entertainment (excluding films and a boxing or wrestling entertainment) taking place at a travelling circus, provided that (a) it takes place within a moveable structure that accommodates the audience, and (b) that the travelling circus has not been located on the same site for more than 28 consecutive days.

## Section 18 of 18

### PAYMENT DETAILS

This fee must be paid to the authority. If you complete the application online, you must pay it by debit or credit card.

Premises Licence Fees are determined by the non domestic rateable value of the premises.

To find out a premises non domestic rateable value go to the Valuation Office Agency site at <https://www.tax.service.gov.uk/business-rates-find/search>

Band A - No RV to £4300 - £100.00

Band B - £4301 to £33000 - £190.00

Band C - £33001 to £87000 - £315.00

Band D - £87001 to £125000 - £450.00\*

Band E - £125001 and over - £635.00\*

\*If the premises rateable value is in Bands D or E and the premises is primarily used for the consumption of alcohol on the premises then you are required to pay a higher fee

Band D - £87001 to £125000 - £900.00

Band E - £125001 and over - £1,905.00

There is an exemption from the payment of fees in relation to the provision of regulated entertainment at church halls, chapel halls or premises of a similar nature, village halls, parish or community halls, or other premises of a similar nature. The costs associated with these licences will be met by central Government. If, however, the licence also authorises the use of the premises for the supply of alcohol or the provision of late night refreshment, a fee will be required.

Schools and sixth form colleges are exempt from the fees associated with the authorisation of regulated entertainment where the entertainment is provided by and at the school or college and for the purposes of the school or college.

If you operate a large event you are subject to ADDITIONAL fees based upon the number in attendance at any one time

Capacity 5000-9999 - £1,000.00

Capacity 10000-14999 - £2,000.00

Capacity 15000-19999 - £4,000.00

Capacity 20000-29999 - £8,000.00

Capacity 30000-39999 - £16,000.00

Capacity 40000-49999 - £24,000.00

Capacity 50000-59999 - £32,000.00

Capacity 60000-69999 - £40,000.00

Capacity 70000-79999 - £48,000.00

Capacity 80000-89999 - £56,000.00

Capacity 90000 and over - £64,000.00

\* Fee amount (£)

190.00

### DECLARATION

Continued from previous page...

I/WE UNDERSTAND THAT IT IS AN OFFENCE, UNDER SECTION 158 OF THE LICENSING ACT 2003, TO MAKE A FALSE STATEMENT IN OR IN CONNECTION WITH THIS APPLICATION. THOSE WHO MAKE A FALSE STATEMENT MAY BE LIABLE ON SUMMARY CONVICTION TO A FINE OF ANY AMOUNT.

☒ Ticking this box indicates you have read and understood the above declaration

This section should be completed by the applicant, unless you answered "Yes" to the question "Are you an agent acting on behalf of the applicant?"

\* Full name   
\* Capacity   
\* Date  /  /   
dd mm yyyy

[Add another signatory](#)

Once you're finished you need to do the following:

1. Save this form to your computer by clicking file/save as...
  2. Go back to <https://www.gov.uk/apply-for-a-licence/premises-licence/birmingham/change-1> to upload this file and continue with your application.
- Don't forget to make sure you have all your supporting documentation to hand.

**IT IS AN OFFENCE, UNDER SECTION 158 OF THE LICENSING ACT 2003, TO MAKE A FALSE STATEMENT IN OR IN CONNECTION WITH THIS APPLICATION. THOSE WHO MAKE A FALSE STATEMENT MAY BE LIABLE ON SUMMARY CONVICTION TO A FINE OF ANY AMOUNT.**

#### OFFICE USE ONLY

Applicant reference number   
Fee paid   
Payment provider reference   
ELMS Payment Reference   
Payment status   
Payment authorisation code   
Payment authorisation date   
Date and time submitted   
Approval deadline   
Error message   
Is Digitally signed ☐

[1](#) [2](#) [3](#) [4](#) [5](#) [6](#) [7](#) [8](#) [9](#) [10](#) [11](#) [12](#) [13](#) [14](#) [15](#) [16](#) [17](#) [18](#) [Next >](#)

**LICENSING ACT 2003****PREMISES LICENCE****Premises Licence Number:**

5026 / 1

**Part 1 - Premises details:**

<b>Postal address of premises, or if none, ordnance survey map reference or description</b> Eden Manna Supermarket 122 Frances Road Cotteridge	
<b>Post town:</b> Birmingham	<b>Post Code:</b> B30 3DX
<b>Telephone Number:</b> Not Specified	

<b>Where the licence is time limited the dates</b> N/A
---

<b>Licensable activities authorised by the licence</b> M2      Sale of alcohol by retail (off the premises)
--

<b>The times the licence authorises the carrying out of licensable activities</b>			
Monday - Friday	17:30	-	00:00    M2
Saturday - Sunday	11:00	-	00:00    M2

<b>The opening hours of the premises</b>			
Monday - Sunday	06:00	-	00:00

<b>Where the licence authorises supplies of alcohol whether these are on and/or off supplies</b> Off Supplies Only
---

**Part 2**

<b>Name, (registered) address, telephone number and email (where relevant) of holder of premises licence</b> Eden Manna Supermarket Ltd 122 Frances Road Cotteridge	
<b>Post town:</b> Birmingham	<b>Post Code:</b> B30 3DX
<b>Telephone Number:</b> Not Specified	
<b>Email</b> Not Specified	

<b>Registered number of holder for example company number or charity number (where applicable)</b> 10889489
--

<b>Name, address, telephone number of designated premises supervisor where the premises licence authorises for the supply of alcohol</b> Mr Boniface Nyepango Lumumba	
<b>Post town:</b>	<b>Post Code:</b>
<b>Telephone Number:</b>	

<b>Personal licence number and issuing authority of personal licence held by designated premises supervisor where the premises licence authorises for the supply of alcohol</b>	
<b>Licence Number</b> 10853	<b>Issuing Authority</b> BIRMINGHAM CITY COUNCIL

*Dated 21/03/2019*

Bhapinder Nandhra  
Senior Licensing Officer  
For Director of Regulation and Enforcement

## Annex 1 – Mandatory Conditions

No supply of alcohol may be made under the premises licence (a) at a time when there is no designated premises supervisor in respect of the premises licence, or (b) at a time when the designated premises supervisor does not hold a personal licence or his personal licence is suspended.

Every retail sale or supply of alcohol made under this licence must be made or authorised by a person who holds a personal licence.

The premises licence holder or club premises certificate holder must ensure that an age verification policy is adopted in respect of the premises in relation to the sale or supply of alcohol. The designated premises supervisor in relation to the premises licence must ensure that the supply of alcohol at the premises is carried on in accordance with the age verification policy. The policy must require individuals who appear to the responsible person to be under 18 years of age (or such older age as may be specified in the policy) to produce on request, before being served alcohol, identification bearing their photograph, date of birth and either— (a) a holographic mark, or (b) an ultraviolet feature.

(1) A relevant person shall ensure that no alcohol is sold or supplied for consumption on or off the premises for a price which is less than the permitted price. (2) In this condition:— (a) “permitted price” is the price found by applying the formula  $P = D + (D \times V)$ , where— (i) P is the permitted price, (ii) D is the amount of duty chargeable in relation to the alcohol as if the duty were charged on the date of the sale or supply of the alcohol, and (iii) V is the rate of value added tax chargeable in relation to the alcohol as if the value added tax were charged on the date of the sale or supply of the alcohol; (b) “duty” is to be construed in accordance with the Alcoholic Liquor Duties Act 1979; (c) “relevant person” means, in relation to premises in respect of which there is in force a premises licence— (i) the holder of the premises licence, (ii) the designated premises supervisor (if any) in respect of such a licence, or (iii) the personal licence holder who makes or authorises a supply of alcohol under such a licence; (d) “relevant person” means, in relation to premises in respect of which there is in force a club premises certificate, any member or officer of the club present on the premises in a capacity which enables the member or officer to prevent the supply in question; and (e) “value added tax” means value added tax charged in accordance with the Value Added Tax Act 1994. (3) Where the permitted price would not be a whole number of pennies, the permitted price shall be taken to be the price rounded up to the nearest penny. (4) Where the permitted price on a day (“the first day”) would be different from the permitted price on the next day (“the second day”) as a result of a change to the rate of duty or value added tax, the permitted price which would apply on the first day applies to sales or supplies of alcohol which take place before the expiry of the period of 14 days beginning on the second day.

## **Annex 2 – Conditions consistent with operating schedule**

### **2a) General conditions consistent with the operating schedule**

The premises licence holder will ensure all members of staff with the exception of personal licence holders receive training regarding the:-

- Four licensing principles contained in the Licensing Act 2003;
- The law regarding sales of alcohol;
- Protection of children from harm and this must include
  - Challenge 25 and how to competently check customers' identification where necessary.

Training records must be maintained at the premises for each member of staff evidencing the training provided and made available for inspection by any Responsible Authority on request.

No members of staff will be permitted to sell alcohol until such time as they have successfully completed the required training.

The premises licence holder will ensure that ongoing staff refresher training is conducted every six months highlighting the importance of making sure people under 18 years are not able to obtain access to alcohol.

All spirits exposed for sale with the exception of spirit mixtures must be displayed behind the counter and supervised at all times

No alcohol will be displayed in the vicinity of the entrance door and all alcohol displayed for sale must be displayed in an area which is clearly visible to members of staff standing behind the counter.

The premises licence holder will not display any posters to promote or advertise alcohol sales in the premises window on Pershore Road (opposite Cotteridge Primary School).

The premises licence holder will not use any 'A' boards or similar street signage to advertise alcohol.

### **2b) Conditions consistent with, and to promote the prevention of crime and disorder**

A CCTV system will be operational in the premises and will record at all times when the premises are open to members of the public.

The images recorded by the CCTV system must be retained in unedited form for a period of not less than 31 days and will be downloaded and made available to any Responsible Authority upon request

The CCTV system will display the correct date and time on all recordings (taking account of GMT and BST).

The premises licence holder will ensure a member of staff trained person in the use of and operation of the CCTV system will be present at the premises at all times when it is open to members of the public. This person will be able to fully operate the CCTV system and will be able to download any images requested by any Responsible Authority.

The premises licence holder will maintain an incident recording system and will record any incidents occurring inside, or immediately outside the premises which they believe negatively impacts on any of the licensing objectives.

### **2c) Conditions consistent with, and to promote, public safety**

No enforceable conditions identified from operating schedule.

### **2d) Conditions consistent with, and to promote the prevention of public nuisance**

A notice must be prominently displayed in the premises requesting that customers respect the needs of local residents and other businesses in the vicinity and to leave the premises quietly.

The premises licence holder will maintain the area outside the premises in a clean and tidy manner.

## **2e) Conditions consistent with, and to promote the protection of children from harm**

The premises will operate a strict Challenge 25 age verification policy – **No ID - No Sale**

The premises licence holder will implement and operate a Challenge 25 age verification policy to prevent the sale or supply of alcohol to persons under 18 years of age. The policy must specify the only accepted forms of identification shall be a:-

- photographic driving licence;
- valid passport;
- military identification;
- other recognised forms of photographic identification incorporating the PASS logo; or
- any other form of identification approved by the Secretary of State

A copy of a written age verification policy (challenge 25) must be signed by all members of staff to confirm they have read and understand the policy. The signed copy must be maintained at the premises and available for inspection by any Responsible Authority on request.

The premises licence holder will maintain a refusals book (or refusal button on EPOS – Electronic Point of Sale) on the premises and ensure it is completed whenever a sale is refused to a person who cannot prove they are over the age of 18. The refusal book or record of till recorded refusals must be made available to any Responsible Authority on request.

Notices must be displayed at the premises and clearly visible to customers informing them that a Challenge 25 age verification policy is in operation at the premises.

The premises licence holder will maintain a refusals register (or refusal button on EPOS – Electronic Point of Sale) on the premises and ensure it is completed whenever a sale is refused to a person who cannot prove they are over the age of 18.

The refusal register or record of till recorded refusals must be maintained at the premises and made available for inspection by any Responsible Authority on request.

## **Annex 3 – Conditions attached after hearing by licensing authority**

### **3a) General committee conditions**

Licensing Sub Committee Resolved to GRANT the licence on Tuesday 19th March 2019 subject to the modification of hours and additional condition as below:

Modification of hours Alcohol:

The hours for the sale of alcohol (for consumption off the premises) shall apply as follows:

17.30 hours until 12:00 midnight (Monday to Friday)

11:00 hours until 12:00 midnight (Saturday to Sunday)

The premises to remain open to the public as follows: 06:00 hours until 12:00 midnight (Monday to Sunday)

The licence holder shall ensure that at times when the premises are open but alcohol is not for sale that alcohol is not on view and is covered by lockable blinds or shutters

### **3b) Committee conditions to promote the prevention of crime and disorder**

N/A

### **3c) Committee conditions to promote public safety**

N/A

### **3d) Committee conditions to promote the prevention of public nuisance**

N/A

### **3e) Committee conditions to promote the protection of children from harm**

N/A



## Annex 4 – Plans

**Notes:**  
This drawings have been produced to the standards set out within the Licensing Act 2003.

No deviation may be made from the details shown on this drawing without prior written permission of UK Surveyors. Any discrepancy found between this drawing and any other document should be referred immediately to UK Surveyors.

**IF IN ANY DOUBT PLEASE ASK.**

All rights described in chapter IV of copyright, design and Patents Act 1988 have been generally asserted.

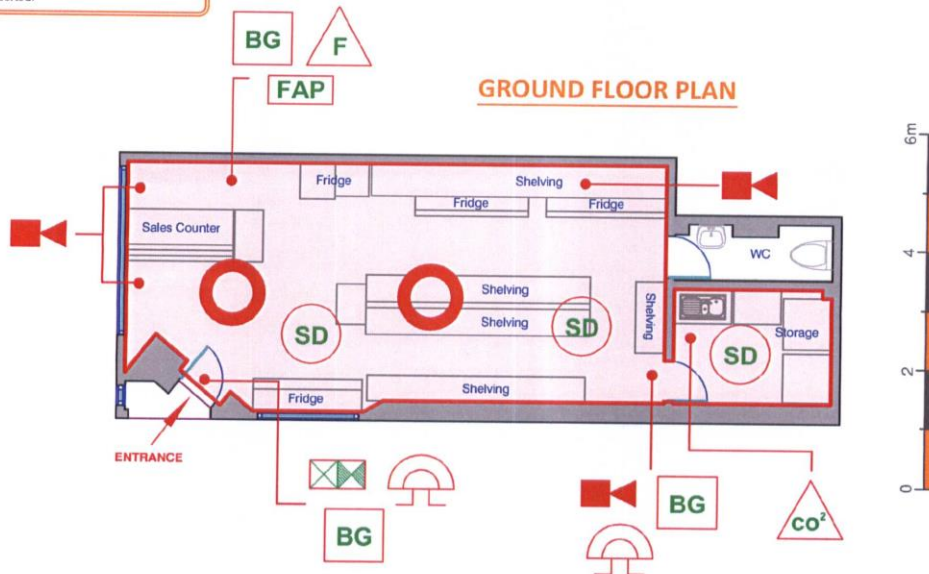

### SYMBOLS KEY:

	: Emergency Lighting Point		: Fire Extinguisher - Foam
	: Exit Sign Internally, Illuminated		: Sounder
	: Smoke Detector		: Fire Alarm Panel
	: CCTV		: Break Glass
	: Fire Extinguisher - CO2		: Licensed Area

**Licensed Floor Area**  
Licensed Ground Floor Area: 41.41ms

**Total Licensed Floor Area: 41.41ms**

<b>Drawing No:</b> 004110	<b>Drawing Title:</b> Ground Floor Plan	<b>Property:</b> 122 Frances Road, Birmingham, B30 3DX	<b>Date:</b> 15/01/2019	<b>Sheet:</b> 1 of 1
<b>UK Surveyors Ltd</b> <small>CAD Drafting - Planning - Building Regulations - Building Surveying - Alcohol Licensing</small>			<b>Freephone:</b> 0808 168 9059 <b>Head Office:</b> 01889 220 880 <b>enquiries@uksurveyors.net</b> <b>www.uksurveyors.net</b>	
			<b>Drawn By:</b> OH <b>Scale:</b> 1:100 @ A4	



**Birmingham City Council** Map Created By:

Notes

Date of Map Creation: 11/02/2019



Scale:  
1:4,000

(c) Crown copyright. All rights reserved. Birmingham City Council 100021326 (2016).  
You are not permitted to copy, sub-licence, distribute or sell any of this data to third parties in any form.  
(c) GeoPerspectives, supplied by Bluesky International Ltd  
Cities Revealed® copyright by The GeoInformation® Group, 2014 and Crown Copyright © All right reserved



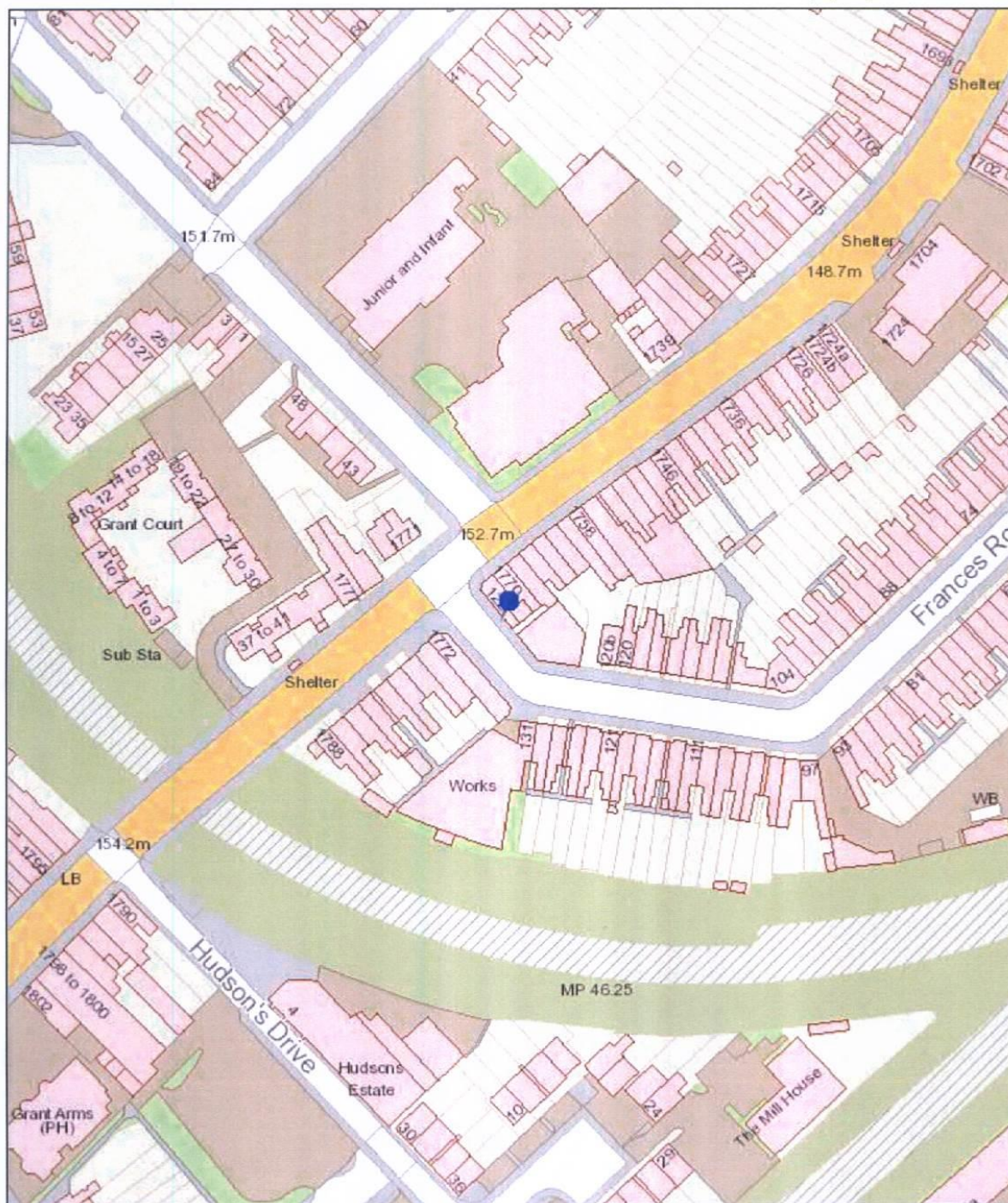

**Birmingham City Council** Map Created By:

Date of Map Creation: 11/02/2019

**Notes**

(c) Crown copyright. All rights reserved. Birmingham City Council 100021326 (2016).  
 You are not permitted to copy, sub-licence, distribute or sell any of this data to third parties in any form.  
 (c) GeoPerspectives, supplied by Bluesky International Ltd  
 Cities Revealed® copyright by The GeoInformation® Group, 2014 and Crown Copyright © All right reserved



Scale:  
1:1,250